

EOG Resources, Inc.

Weld County, CO (NAD 27)

Sec. 16-T11N-R64W

Lion Creek 04-16H

Plan #1

Survey: Sperry MWD Survey

Sperry Drilling Services Standard Report

14 March, 2011

Well Coordinates: 577,606.93 N, 2,264,543.78 E (40° 54' 54.03" N, 104° 32' 34.38" W)
Ground Level: 5,440.00 ft

Local Coordinate Origin:	Centered on Well Lion Creek 04-16H
Viewing Datum:	RKB 21' @ 5461.00ft (SST 56)
TVDs to System:	N
North Reference:	True
Unit System:	API - US Survey Feet - Custom

Geodetic Scale Factor Applied
Version: 2003.16 Build: 431

HALLIBURTON

Survey Report for Lion Creek 04-16H - Sperry MWD Survey

Measured Depth (ft)	Inclination (°)	Azimuth (°)	Vertical Depth (ft)	+N/-S (ft)	+E/-W (ft)	Vertical Section (ft)	Dogleg Rate (°/100ft)
1,657.00	0.00	0.00	1,657.00	0.00	0.00	0.00	0.00
Tie-on to Surface Casing (assume vertical)							
1,749.00	0.52	143.01	1,749.00	-0.33	0.25	-0.41	0.57
First Sperry MWD Survey							
2,034.00	0.11	179.96	2,033.99	-1.64	1.03	-1.89	0.15
2,319.00	0.33	135.97	2,318.99	-2.50	1.60	-2.91	0.09
2,604.00	0.46	191.50	2,603.99	-4.21	1.94	-4.38	0.14
2,889.00	0.46	165.58	2,888.98	-6.44	2.00	-6.02	0.07
3,173.00	0.48	144.47	3,172.97	-8.52	2.97	-8.19	0.06
3,458.00	0.62	112.72	3,457.96	-10.08	5.09	-10.79	0.12
3,744.00	0.81	127.99	3,743.93	-11.93	8.11	-14.21	0.09
4,029.00	0.42	97.45	4,028.92	-13.30	10.73	-17.02	0.17
4,314.00	0.53	98.78	4,313.91	-13.64	13.07	-18.89	0.04
4,598.00	0.98	129.75	4,597.88	-15.39	16.24	-22.35	0.21
4,883.00	0.85	128.87	4,882.85	-18.28	19.76	-26.87	0.05
5,168.00	0.89	135.25	5,167.81	-21.17	22.96	-31.18	0.04
5,453.00	0.47	149.28	5,452.79	-23.75	25.12	-34.54	0.16
5,738.00	0.57	163.68	5,737.78	-26.12	26.11	-36.93	0.06
6,023.00	0.46	163.48	6,022.77	-28.57	26.84	-39.20	0.04
6,309.00	1.37	157.37	6,308.73	-32.83	28.48	-43.40	0.32
6,594.00	0.94	158.39	6,593.67	-38.15	30.65	-48.73	0.15
6,879.00	0.47	133.23	6,878.65	-41.12	32.36	-52.06	0.19
7,165.00	0.44	177.80	7,164.64	-43.02	33.26	-54.05	0.12
7,196.00	0.46	152.00	7,195.64	-43.25	33.32	-54.25	0.65
7,228.00	0.34	81.90	7,227.64	-43.35	33.48	-54.43	1.47
7,260.00	0.60	7.05	7,259.64	-43.17	33.59	-54.38	1.90
7,291.00	1.97	350.20	7,290.63	-42.49	33.52	-53.84	4.54
7,323.00	4.01	339.28	7,322.59	-40.90	33.03	-52.36	6.59
7,355.00	6.41	339.34	7,354.45	-38.18	32.01	-49.69	7.50
7,387.00	6.87	345.35	7,386.24	-34.66	30.89	-46.39	2.60
7,418.00	9.02	346.26	7,416.94	-30.50	29.85	-42.67	6.95
7,450.00	13.82	345.60	7,448.29	-24.36	28.30	-37.18	15.01
7,482.00	19.03	346.77	7,478.98	-15.57	26.15	-29.38	16.31
7,513.00	24.41	348.28	7,507.77	-4.37	23.69	-19.62	17.45
7,545.00	26.69	345.06	7,536.64	9.05	20.50	-7.75	8.34
7,576.00	29.73	341.52	7,563.95	23.07	16.26	5.27	11.19
7,608.00	34.83	340.58	7,591.00	39.22	10.71	20.74	16.01
7,639.00	39.44	341.72	7,615.71	56.93	4.67	37.66	15.04
7,671.00	43.90	342.64	7,639.60	77.18	-1.83	56.73	14.07
7,703.00	48.31	343.64	7,661.79	99.25	-8.51	77.23	13.96
7,734.00	52.86	344.63	7,681.46	122.28	-15.05	98.33	14.88
7,766.00	57.32	345.66	7,699.77	147.64	-21.77	121.23	14.18
7,799.00	61.80	345.45	7,716.49	175.18	-28.87	145.95	13.59
7,830.00	66.40	343.29	7,730.03	202.03	-36.39	170.47	16.11
7,862.00	71.30	340.56	7,741.57	230.38	-45.65	197.29	17.25
7,893.00	76.43	338.13	7,750.18	258.23	-56.16	224.61	18.18
7,925.00	79.17	337.57	7,756.95	287.20	-67.95	253.63	8.73
7,957.00	80.02	337.03	7,762.73	316.23	-80.10	282.94	3.13
7,988.00	84.81	337.26	7,766.82	344.54	-92.03	311.58	15.47
8,052.00	91.98	336.86	7,768.61	403.42	-116.95	371.21	11.22

Survey Report for Lion Creek 04-16H - Sperry MWD Survey

Measured Depth (ft)	Inclination (°)	Azimuth (°)	Vertical Depth (ft)	+N/-S (ft)	+E/-W (ft)	Vertical Section (ft)	Dogleg Rate (°/100ft)
8,083.00	92.88	337.35	7,767.29	431.95	-129.00	400.10	3.30
8,115.00	92.53	337.45	7,765.78	461.46	-141.28	429.84	1.14
8,146.00	92.00	337.31	7,764.56	490.05	-153.20	458.67	1.77
8,178.00	91.29	337.58	7,763.64	519.59	-165.46	488.43	2.37
8,209.00	90.03	337.71	7,763.28	548.26	-177.25	517.23	4.09
8,241.00	90.28	337.94	7,763.20	577.89	-189.33	546.92	1.06
8,272.00	89.45	337.23	7,763.27	606.55	-201.15	575.74	3.52
8,304.00	88.12	337.83	7,763.95	636.11	-213.38	605.48	4.56
8,336.00	88.03	337.53	7,765.02	665.70	-225.53	635.19	0.98
8,367.00	88.21	337.92	7,766.04	694.37	-237.27	663.96	1.38
8,398.00	88.54	336.42	7,766.92	722.93	-249.29	692.84	4.95
8,430.00	89.08	337.61	7,767.58	752.38	-261.79	722.69	4.08
8,462.00	88.83	337.35	7,768.17	781.94	-274.04	752.45	1.13
8,494.00	89.72	336.72	7,768.57	811.40	-286.52	782.30	3.41
8,525.00	89.85	335.99	7,768.69	839.80	-298.96	811.36	2.39
8,557.00	90.00	334.24	7,768.73	868.82	-312.42	841.58	5.49
8,589.00	89.91	333.17	7,768.75	897.51	-326.60	872.05	3.36
8,620.00	89.54	332.43	7,768.90	925.08	-340.77	901.72	2.67
8,652.00	89.26	331.36	7,769.24	953.31	-355.84	932.48	3.46
8,683.00	89.32	329.68	7,769.62	980.29	-371.10	962.48	5.42
8,715.00	89.38	327.79	7,769.99	1,007.64	-387.70	993.68	5.91
8,746.00	89.91	326.83	7,770.18	1,033.73	-404.44	1,024.07	3.54
8,778.00	90.49	324.91	7,770.07	1,060.22	-422.40	1,055.59	6.27
8,810.00	90.62	323.23	7,769.76	1,086.13	-441.17	1,087.27	5.27
8,841.00	90.55	322.22	7,769.44	1,110.79	-459.95	1,118.05	3.27
8,873.00	89.72	321.41	7,769.36	1,135.94	-479.73	1,149.88	3.62
8,905.00	88.77	320.34	7,769.79	1,160.77	-499.92	1,181.75	4.47
8,937.00	90.00	321.45	7,770.13	1,185.60	-520.10	1,213.63	5.18
8,969.00	89.97	320.30	7,770.14	1,210.42	-540.29	1,245.51	3.59
9,001.00	88.77	319.13	7,770.49	1,234.83	-560.98	1,277.44	5.24
9,033.00	89.82	318.79	7,770.88	1,258.96	-581.99	1,309.39	3.45
9,064.00	90.46	317.52	7,770.81	1,282.06	-602.67	1,340.37	4.59
9,096.00	89.29	315.43	7,770.88	1,305.26	-624.71	1,372.36	7.48
9,128.00	89.60	314.33	7,771.19	1,327.83	-647.38	1,404.36	3.57
9,159.00	89.72	314.21	7,771.37	1,349.47	-669.58	1,435.34	0.55
9,191.00	89.88	313.37	7,771.48	1,371.62	-692.68	1,467.32	2.67
9,223.00	89.41	311.93	7,771.68	1,393.30	-716.21	1,499.27	4.73
9,254.00	89.75	311.00	7,771.91	1,413.82	-739.44	1,530.17	3.19
9,286.00	90.22	311.47	7,771.92	1,434.92	-763.51	1,562.06	2.08
9,317.00	89.60	310.39	7,771.97	1,455.23	-786.93	1,592.94	4.02
9,349.00	88.74	309.06	7,772.43	1,475.67	-811.53	1,624.75	4.95
9,381.00	88.86	308.61	7,773.10	1,495.74	-836.46	1,656.50	1.46
9,413.00	88.86	308.53	7,773.74	1,515.68	-861.47	1,688.23	0.25
9,444.00	89.10	307.94	7,774.29	1,534.87	-885.82	1,718.94	2.05
9,475.00	89.69	309.31	7,774.62	1,554.21	-910.03	1,749.69	4.81
9,507.00	90.12	309.92	7,774.67	1,574.62	-934.68	1,781.49	2.33
9,539.00	88.93	310.02	7,774.93	1,595.17	-959.21	1,813.32	3.73
9,571.00	89.51	310.32	7,775.37	1,615.81	-983.66	1,845.15	2.04
9,603.00	89.35	311.13	7,775.69	1,636.69	-1,007.91	1,877.02	2.58
9,634.00	89.60	310.90	7,775.97	1,657.03	-1,031.29	1,907.91	1.10
9,666.00	88.72	312.01	7,776.44	1,678.22	-1,055.28	1,939.80	4.43

Survey Report for Lion Creek 04-16H - Sperry MWD Survey

Measured Depth (ft)	Inclination (°)	Azimuth (°)	Vertical Depth (ft)	+N/-S (ft)	+E/-W (ft)	Vertical Section (ft)	Dogleg Rate (°/100ft)
9,697.00	89.85	311.84	7,776.83	1,698.93	-1,078.34	1,970.72	3.69
9,729.00	90.06	311.86	7,776.85	1,720.28	-1,102.17	2,002.64	0.66
9,761.00	89.97	311.62	7,776.84	1,741.58	-1,126.05	2,034.56	0.80
9,793.00	88.98	310.44	7,777.14	1,762.58	-1,150.19	2,066.44	4.81
9,825.00	89.85	310.28	7,777.46	1,783.31	-1,174.57	2,098.28	2.76
9,857.00	90.74	310.60	7,777.30	1,804.06	-1,198.93	2,130.14	2.96
9,888.00	89.88	310.43	7,777.13	1,824.20	-1,222.49	2,161.00	2.83
9,920.00	90.06	310.66	7,777.15	1,845.00	-1,246.81	2,192.86	0.91
9,952.00	88.98	310.75	7,777.42	1,865.87	-1,271.07	2,224.72	3.39
9,983.00	89.10	310.61	7,777.94	1,886.08	-1,294.57	2,255.59	0.59
10,015.00	89.26	310.55	7,778.39	1,906.89	-1,318.87	2,287.44	0.53
10,047.00	89.01	310.53	7,778.88	1,927.69	-1,343.19	2,319.30	0.78
10,078.00	90.03	310.66	7,779.14	1,947.86	-1,366.73	2,350.16	3.32
10,110.00	89.72	311.62	7,779.21	1,968.91	-1,390.83	2,382.05	3.15
10,141.00	89.10	311.60	7,779.53	1,989.49	-1,414.00	2,412.96	2.00
10,173.00	90.25	311.60	7,779.71	2,010.74	-1,437.93	2,444.87	3.59
10,205.00	89.44	310.90	7,779.79	2,031.84	-1,461.99	2,476.76	3.35
10,237.00	88.12	311.20	7,780.48	2,052.85	-1,486.12	2,508.63	4.23
10,269.00	88.00	311.55	7,781.56	2,073.99	-1,510.12	2,540.51	1.16
10,301.00	88.27	311.24	7,782.60	2,095.14	-1,534.11	2,572.40	1.28
10,332.00	88.30	311.26	7,783.53	2,115.57	-1,557.41	2,603.28	0.12
10,364.00	89.57	310.66	7,784.12	2,136.54	-1,581.57	2,635.15	4.39
10,395.00	89.78	310.31	7,784.30	2,156.67	-1,605.14	2,666.01	1.32
10,427.00	89.94	310.23	7,784.38	2,177.35	-1,629.56	2,697.86	0.56
10,459.00	90.80	310.23	7,784.17	2,198.02	-1,653.99	2,729.70	2.69
10,490.00	88.96	309.22	7,784.23	2,217.83	-1,677.83	2,760.51	6.77
10,522.00	89.41	308.71	7,784.69	2,237.95	-1,702.71	2,792.27	2.13
10,554.00	89.88	309.29	7,784.89	2,258.09	-1,727.58	2,824.04	2.33
10,585.00	88.61	309.29	7,785.30	2,277.71	-1,751.57	2,854.83	4.10
10,617.00	89.20	309.67	7,785.91	2,298.06	-1,776.26	2,886.62	2.19
10,648.00	88.75	311.21	7,786.46	2,318.16	-1,799.85	2,917.47	5.17
10,680.00	88.49	311.08	7,787.23	2,339.21	-1,823.94	2,949.35	0.91
10,711.00	86.82	310.73	7,788.50	2,359.49	-1,847.35	2,980.20	5.50
10,743.00	86.57	311.11	7,790.35	2,380.42	-1,871.49	3,012.03	1.42
10,774.00	86.43	310.96	7,792.24	2,400.73	-1,894.83	3,042.86	0.66
10,806.00	87.25	310.16	7,794.00	2,421.51	-1,919.10	3,074.67	3.58
10,837.00	87.63	310.59	7,795.39	2,441.57	-1,942.70	3,105.49	1.85
10,869.00	88.25	310.98	7,796.54	2,462.46	-1,966.91	3,137.34	2.29
10,900.00	89.07	311.12	7,797.26	2,482.81	-1,990.28	3,168.22	2.68
10,932.00	88.77	310.95	7,797.87	2,503.81	-2,014.41	3,200.09	1.08
10,964.00	89.60	311.15	7,798.32	2,524.83	-2,038.54	3,231.97	2.67
10,995.00	90.09	310.87	7,798.41	2,545.17	-2,061.94	3,262.86	1.82
11,026.00	90.19	309.61	7,798.33	2,565.19	-2,085.60	3,293.71	4.08
11,058.00	91.45	310.64	7,797.87	2,585.81	-2,110.07	3,325.54	5.09
11,090.00	91.43	310.78	7,797.07	2,606.68	-2,134.31	3,357.39	0.44
11,121.00	91.91	310.78	7,796.16	2,626.92	-2,157.78	3,388.26	1.55
11,153.00	92.25	310.68	7,795.00	2,647.78	-2,182.01	3,420.10	1.11
11,184.00	91.11	310.56	7,794.09	2,667.96	-2,205.53	3,450.96	3.70
11,216.00	90.89	310.50	7,793.54	2,688.75	-2,229.85	3,482.81	0.71
11,247.00	90.06	310.84	7,793.28	2,708.95	-2,253.36	3,513.68	2.89
11,279.00	90.80	311.14	7,793.04	2,729.94	-2,277.51	3,545.56	2.50

Survey Report for Lion Creek 04-16H - Sperry MWD Survey

Measured Depth (ft)	Inclination (°)	Azimuth (°)	Vertical Depth (ft)	+N/-S (ft)	+E/-W (ft)	Vertical Section (ft)	Dogleg Rate (°/100ft)
11,310.00	89.75	310.68	7,792.89	2,750.24	-2,300.94	3,576.44	3.70
11,342.00	88.71	309.54	7,793.32	2,770.85	-2,325.41	3,608.27	4.82
11,374.00	89.32	310.06	7,793.87	2,791.33	-2,349.99	3,640.08	2.50
11,406.00	90.56	309.89	7,793.90	2,811.89	-2,374.52	3,671.91	3.91
11,438.00	91.30	309.97	7,793.38	2,832.43	-2,399.05	3,703.72	2.33
11,470.00	91.54	309.74	7,792.59	2,852.93	-2,423.61	3,735.54	1.04
11,501.00	92.10	310.06	7,791.61	2,872.80	-2,447.38	3,766.35	2.08
11,533.00	92.00	309.29	7,790.46	2,893.22	-2,471.99	3,798.14	2.42
11,565.00	90.65	308.79	7,789.72	2,913.37	-2,496.84	3,829.90	4.50
11,596.00	89.60	308.43	7,789.65	2,932.71	-2,521.06	3,860.64	3.58
11,628.00	90.19	308.01	7,789.71	2,952.51	-2,546.20	3,892.35	2.26
11,659.00	90.40	308.04	7,789.55	2,971.61	-2,570.62	3,923.06	0.68
11,691.00	89.97	307.55	7,789.45	2,991.22	-2,595.91	3,954.73	2.04
11,723.00	89.85	307.51	7,789.50	3,010.71	-2,621.29	3,986.39	0.40
11,755.00	90.28	307.94	7,789.46	3,030.29	-2,646.60	4,018.06	1.90
11,786.00	90.28	308.10	7,789.31	3,049.39	-2,671.02	4,048.77	0.52
11,849.00	90.06	308.08	7,789.12	3,088.25	-2,720.60	4,111.18	0.35
11,913.00	90.65	308.65	7,788.73	3,127.97	-2,770.78	4,174.62	1.28
11,945.00	90.40	308.23	7,788.44	3,147.87	-2,795.84	4,206.34	1.53
11,976.00	89.54	309.12	7,788.45	3,167.24	-2,820.05	4,237.09	3.99
12,008.00	89.23	308.92	7,788.79	3,187.38	-2,844.91	4,268.86	1.15
12,040.00	89.88	309.04	7,789.04	3,207.51	-2,869.78	4,300.62	2.07
12,072.00	90.22	308.85	7,789.02	3,227.63	-2,894.67	4,332.38	1.22
12,103.00	89.97	308.54	7,788.96	3,247.01	-2,918.86	4,363.14	1.28
12,135.00	88.52	308.51	7,789.39	3,266.94	-2,943.90	4,394.86	4.53
12,167.00	87.97	308.56	7,790.37	3,286.86	-2,968.92	4,426.58	1.73
12,198.00	88.12	308.20	7,791.42	3,306.10	-2,993.20	4,457.30	1.26
12,230.00	88.49	308.20	7,792.37	3,325.88	-3,018.34	4,488.99	1.16
12,261.00	88.52	307.58	7,793.18	3,344.91	-3,042.80	4,519.68	2.00
12,293.00	88.71	307.90	7,793.95	3,364.49	-3,068.09	4,551.34	1.16
12,325.00	88.74	307.90	7,794.66	3,384.14	-3,093.34	4,583.02	0.09
12,356.00	89.60	308.26	7,795.11	3,403.26	-3,117.74	4,613.72	3.01
12,388.00	89.88	308.46	7,795.26	3,423.12	-3,142.83	4,645.44	1.08
12,419.00	90.00	308.73	7,795.29	3,442.46	-3,167.06	4,676.19	0.95
12,482.00	89.69	308.70	7,795.46	3,481.86	-3,216.21	4,738.69	0.49
12,545.00	89.97	308.99	7,795.65	3,521.37	-3,265.28	4,801.21	0.64
12,608.00	89.78	309.20	7,795.79	3,561.10	-3,314.17	4,863.76	0.45
12,672.00	89.97	309.31	7,795.93	3,601.60	-3,363.73	4,927.32	0.34
12,736.00	89.97	309.68	7,795.96	3,642.31	-3,413.12	4,990.92	0.58
12,799.00	90.43	309.80	7,795.74	3,682.58	-3,461.56	5,053.55	0.75
12,863.00	90.84	309.71	7,795.03	3,723.51	-3,510.76	5,117.18	0.66
12,927.00	91.39	309.56	7,793.78	3,764.32	-3,560.04	5,180.78	0.89
12,958.00	91.91	309.07	7,792.89	3,783.96	-3,584.01	5,211.56	2.30
12,990.00	92.04	309.17	7,791.79	3,804.14	-3,608.83	5,243.31	0.51
13,022.00	89.44	308.17	7,791.38	3,824.13	-3,633.81	5,275.05	8.71
13,054.00	89.23	307.73	7,791.75	3,843.80	-3,659.04	5,306.74	1.52
13,086.00	89.69	308.01	7,792.05	3,863.45	-3,684.30	5,338.42	1.68
13,118.00	90.46	307.96	7,792.01	3,883.14	-3,709.52	5,370.11	2.41
13,149.00	89.78	306.62	7,791.94	3,901.92	-3,734.18	5,400.76	4.85
13,181.00	90.25	306.51	7,791.93	3,920.99	-3,759.88	5,432.33	1.51

Survey Report for Lion Creek 04-16H - Sperry MWD Survey

Measured Depth (ft)	Inclination (°)	Azimuth (°)	Vertical Depth (ft)	+N/-S (ft)	+E/-W (ft)	Vertical Section (ft)	Dogleg Rate (°/100ft)
13,213.00	89.88	305.13	7,791.90	3,939.71	-3,785.83	5,463.83	4.46
13,245.00	90.31	305.14	7,791.84	3,958.13	-3,812.00	5,495.26	1.34
13,276.00	90.18	304.44	7,791.71	3,975.82	-3,837.46	5,525.68	2.30
13,308.00	90.34	303.64	7,791.57	3,993.73	-3,863.97	5,556.99	2.55
13,340.00	90.40	303.12	7,791.36	4,011.33	-3,890.69	5,588.23	1.64
13,371.00	90.49	302.70	7,791.12	4,028.18	-3,916.72	5,618.43	1.39
13,398.00	90.74	302.20	7,790.83	4,042.66	-3,939.50	5,644.68	2.07
Final Sperry MWD Survey							
13,450.00	90.74	302.20	7,790.16	4,070.37	-3,983.50	5,695.19	0.00
Straight Line Projection to TD							

Survey Annotations

Measured Depth (ft)	Vertical Depth (ft)	Local Coordinates		Comment
		+N/-S (ft)	+E/-W (ft)	
1,657.00	1,657.00	0.00	0.00	Tie-on to Surface Casing (assume vertical)
1,749.00	1,749.00	-0.33	0.25	First Sperry MWD Survey
13,398.00	7,790.83	4,042.66	-3,939.50	Final Sperry MWD Survey
13,450.00	7,790.16	4,070.37	-3,983.50	Straight Line Projection to TD

Vertical Section Information

Angle Type	Target	Azimuth (°)	Origin Type	Origin		Start TVD (ft)
				+N/-S (ft)	+E/-W (ft)	
Target	Lion Creek 04-16H Plan #1 BH Tgt	315.94	Slot	0.00	0.00	0.00

Survey tool program

From (ft)	To (ft)	Survey/Plan	Survey Tool
1,749.00	13,450.00	Sperry MWD Survey	MWD

Targets

Target Name - hit/miss target - Shape	Dip Angle (°)	Dip Dir. (°)	TVD (ft)	+N/-S (ft)	+E/-W (ft)	Northing (ft)	Easting (ft)	Latitude	Longitude
Lion Creek 04-16H E - survey misses target center by 1657.00ft at 1657.00ft MD (1657.00 TVD, 0.00 N, 0.00 E) - Polygon	0.00	0.00	0.00	0.00	0.00	577,606.93	2,264,543.78	40.915008	-104.542883
Lion Creek 04-16H E - survey misses target center by 1657.00ft at 1657.00ft MD (1657.00 TVD, 0.00 N, 0.00 E) - Polygon	0.00	0.00	0.00	0.00	0.00	577,606.93	2,264,543.78	40.915008	-104.542883
Lion Creek 04-16H F - survey misses target center by 95.76ft at 13450.00ft MD (7790.16 TVD, 4070.37 N, -3983.50 E) - Point	0.00	0.00	7,748.00	4,149.79	-4,016.45	581,713.22	2,260,482.68	40.926397	-104.557417

North Reference Sheet for Sec. 16-T11N-R64W - Lion Creek 04-16H - Plan #1

All data is in US Feet unless otherwise stated. Directions and Coordinates are relative to True North Reference.

Vertical Depths are relative to RKB 21' @ 5461.00ft (SST 56). Northing and Easting are relative to Lion Creek 04-16H

Coordinate System is US State Plane 1927 (Exact solution), Colorado North 501 using datum NAD 1927 (NADCON CONUS), ellipsoid Clarke 1866

Projection method is Lambert Conformal Conic (2 parallel)

Central Meridian is -105.500000°, Longitude Origin:0.000000°, Latitude Origin:40.783333°

False Easting: 2,000,000.00ft, False Northing: 0.00ft, Scale Reduction: 1.00002402

Grid Coordinates of Well: 577,606.93 ft N, 2,264,543.78 ft E

Geographical Coordinates of Well: 40° 54' 54.03" N, 104° 32' 34.38" W

Grid Convergence at Surface is: 0.62°

Based upon Minimum Curvature type calculations, at a Measured Depth of 13,450.00ft
the Bottom Hole Displacement is 5,695.28ft in the Direction of 315.62° (True).

Magnetic Convergence at surface is: -8.22° (29 September 2010, , BGGM2010)

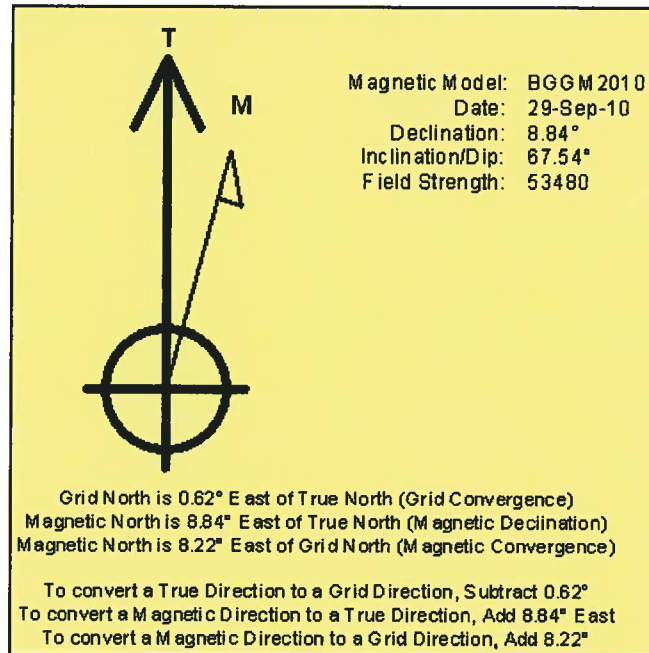

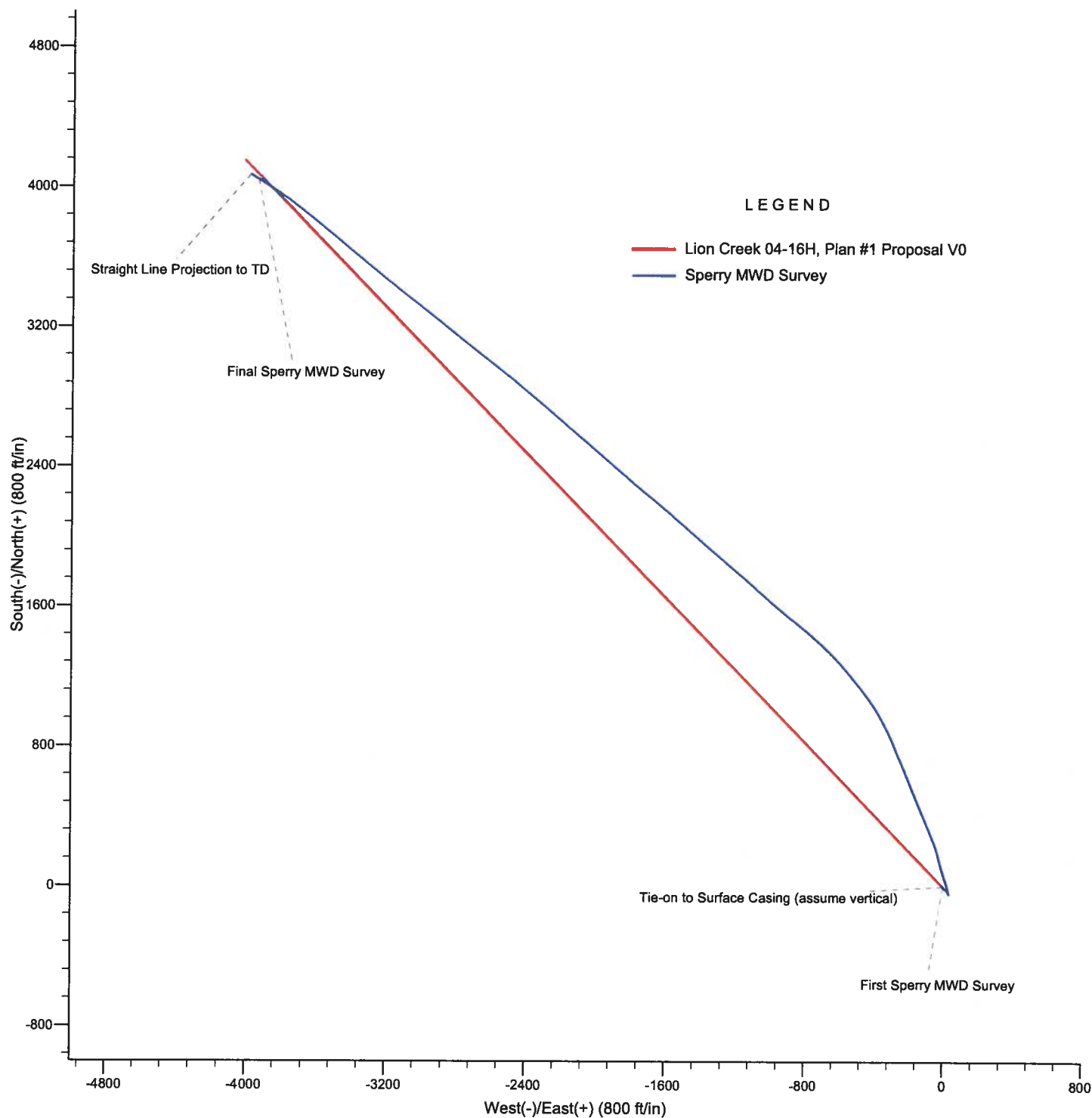

Project: Weld County, CO (NAD 27)
Site: Sec. 16-T11N-R64W
Well: Lion Creek 04-16H

EOG Resources, Inc.

HALLIBURTON
Sperry Drilling

