

Location Drawing

WALTERS 21-18

Multi Well Pad

SW¼ NE¼ SECTION 18, TOWNSHIP 2 NORTH, RANGE 65 WEST OF THE 6TH PRINCIPAL MERIDIAN

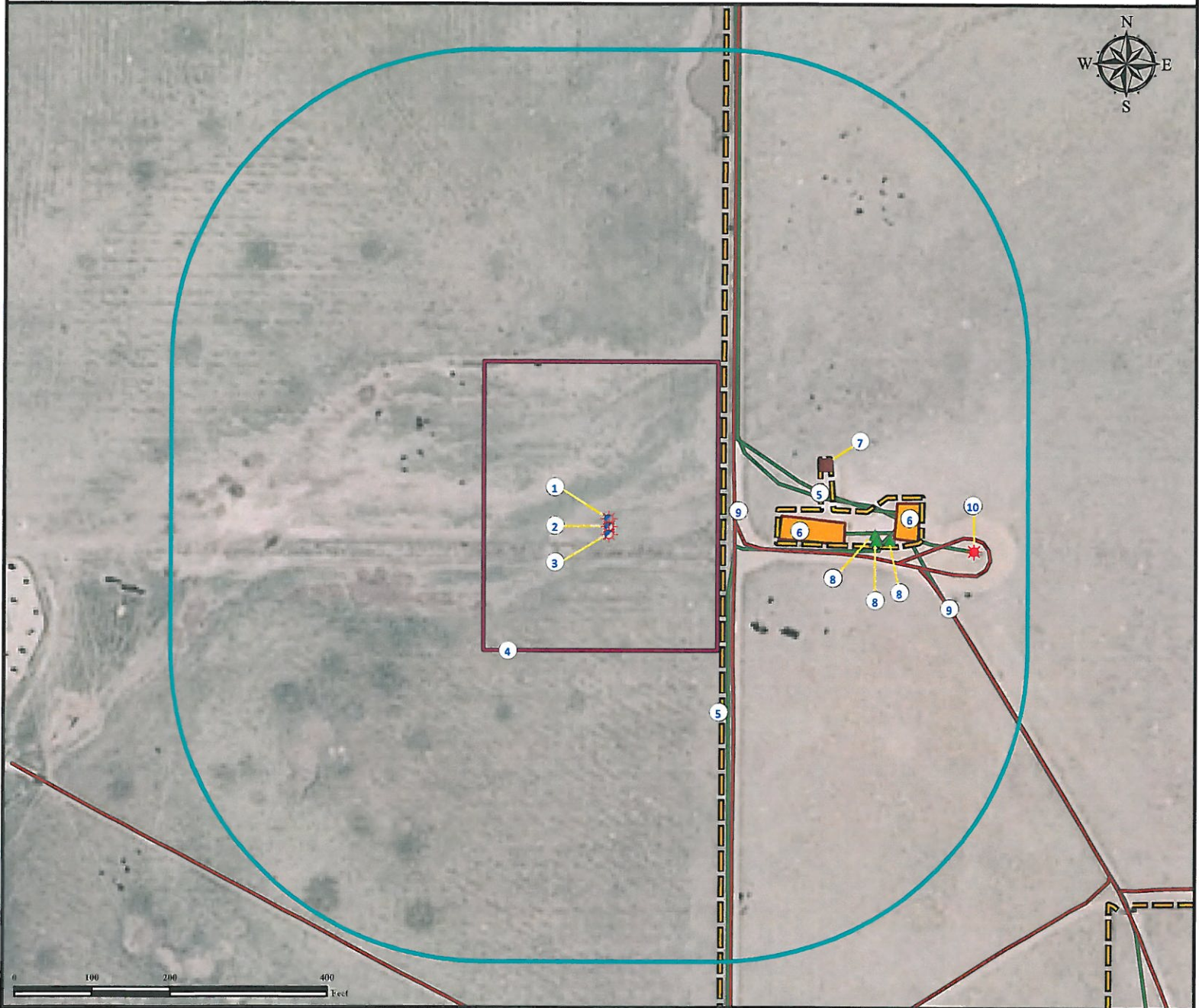

1. Proposed well WALTERS 28-18.
2. Proposed well WALTERS 21-18.
3. Proposed well WALTERS 25-18.
4. Operational Disturbance Area.

5. Fences are $\pm 143'$ E and $\pm 220'$ E.
6. Facilities are $\pm 220'$ E and $\pm 377'$ E.
7. Emissions control device is $\pm 290'$ NE.
8. Electronic Flowmeters are $\pm 341'$ E, $\pm 342'$ E and $\pm 361'$ E.

9. Private roads are $\pm 160'$ E and $\pm 404'$ E.
10. Existing well MUSE #1 $\pm 470'$ E.

Legend

- | | | |
|---------------|----------------------|----------------------|
| Proposed Well | Facilities Enclosure | Fence |
| Existing Well | Disturbance Area | Private Road |
| EFM | ECD | Underground Pipeline |
| | 400' Radius | |

Reference Location

** All Measurements are Made from

Reference Well WALTERS 21-18 **

Lat: 40.142043° Long: -104.702609° (NAD83)

Elevation: 4963 Feet

Surface Use: Dryland Crop



Use our resources to find yours!
www.petro-fs.com
 (303) 928-7128

Field Date: 12/14/2010
 Drafting Date: 12/17/2010
 Drafter: DMM
 Checked By: BHF

Data Sources:
 - Aerial courtesy of NAIP (2009)

Prepared for:
KERR-MCGEE OIL & GAS ONSHORE LP