

FORM  
4  
Rev 12/05

## State of Colorado

## Oil and Gas Conservation Commission

1120 Lincoln Street, Suite 801, Denver, Colorado 80203 Phone: (303)894-2100 Fax: (303)894-2109



## SUNDRY NOTICE

Submit original plus one copy. This form is to be used for general, technical and environmental sundry information. For proposed or completed operations, describe in full on Technical Information Page (Page 2 of this form.) Identify well or other facility by API Number or by OGCC Facility ID. Operator shall send an informational copy of all sundry notices for wells located in High Density Areas to the Local Government Designee (Rule 603b.)

1. OGCC Operator Number: 10071	4. Contact Name Mary Pobuda	Complete the Attachment Checklist  OP OGCC
2. Name of Operator: Bill Barrett Corporation	Phone: 303-312-8531	
3. Address: 1099 18th Street, Suite 2300 City: Denver State: Co Zip: 80202	Fax: 303-291-0420	
5. API Number 05-045-19656-00	OGCC Facility ID Number 413830	Survey Plat
6. Well/Facility Name: Kaufman	7. Well/Facility Number 12A-25-692	Directional Survey
8. Location (Qtr/Qtr, Sec, Twp, Rng, Meridian): NESW, Sec. 25, T6S, 92W, 6th PM		Surface Eqpm Diagram
9. County: Garfield	10. Field Name: 52500	Technical Info Page <input checked="" type="checkbox"/>
11. Federal, Indian or State Lease Number:		Other Location Layout <input checked="" type="checkbox"/>

## General Notice

<input type="checkbox"/> CHANGE OF LOCATION: Attach New Survey Plat (a change of surface qtr/qtr is substantive and requires a new permit)	
Change of Surface Footage from Exterior Section Lines:	<input type="checkbox"/> FNL/FSL <input type="checkbox"/> FEL/FWL
Change of Surface Footage to Exterior Section Lines:	<input type="checkbox"/> <input type="checkbox"/>
Change of Bottomhole Footage from Exterior Section Lines:	<input type="checkbox"/> <input type="checkbox"/>
Change of Bottomhole Footage to Exterior Section Lines:	<input type="checkbox"/> <input type="checkbox"/> attach directional survey
Bottomhole location Qtr/Qtr, Sec, Twp, Rng, Mer	
Latitude	Distance to nearest property line Distance to nearest bldg, public rd, utility or RR
Longitude	Distance to nearest lease line Is location in a High Density Area (rule 603b)? Yes/No <input type="checkbox"/>
Ground Elevation	Distance to nearest well same formation Surface owner consultation date:
GPS DATA: Date of Measurement PDOP Reading Instrument Operator's Name	
<input type="checkbox"/> CHANGE SPACING UNIT	<input type="checkbox"/> Remove from surface bond
Formation Formation Code Spacing order number Unit Acreage Unit configuration	Signed surface use agreement attached
<input type="checkbox"/> CHANGE OF OPERATOR (prior to drilling): Effective Date: Plugging Bond: <input type="checkbox"/> Blanket <input type="checkbox"/> Individual	<input type="checkbox"/> CHANGE WELL NAME NUMBER From: To: Effective Date:
<input type="checkbox"/> ABANDONED LOCATION: Was location ever built? <input type="checkbox"/> Yes <input type="checkbox"/> No Is site ready for inspection? <input type="checkbox"/> Yes <input type="checkbox"/> No Date Ready for inspection:	<input type="checkbox"/> NOTICE OF CONTINUED SHUT IN STATUS Date well shut in or temporarily abandoned: Has Production Equipment been removed from site? <input type="checkbox"/> Yes <input type="checkbox"/> No MIT required if shut in longer than two years. Date of last MIT
<input type="checkbox"/> SPUD DATE:	<input type="checkbox"/> REQUEST FOR CONFIDENTIAL STATUS (6 mos from date casing set)
<input type="checkbox"/> SUBSEQUENT REPORT OF STAGE, SQUEEZE OR REMEDIAL CEMENT WORK *submit cbl and cement job summaries	
Method used Cementing tool setting/perf depth Cement volume Cement lop Cement bottom Date	
<input type="checkbox"/> RECLAMATION: Attach technical page describing final reclamation procedures per Rule 1004. Final reclamation will commence on approximately Final reclamation is completed and site is ready for inspection.	

## Technical Engineering/Environmental Notice

<input type="checkbox"/> Notice of Intent Approximate Start Date:	<input type="checkbox"/> Report of Work Done Date Work Completed:	
Details of work must be described in full on Technical Information Page (Page 2 must be submitted.)		
<input type="checkbox"/> Intent to Recomplete (submit form 2)	<input type="checkbox"/> Request to Vent or Flare	<input type="checkbox"/> E&P Waste Disposal
<input type="checkbox"/> Change Drilling Plans	<input type="checkbox"/> Repair Well	<input type="checkbox"/> Beneficial Reuse of E&P Waste
<input type="checkbox"/> Gross Interval Changed?	<input type="checkbox"/> Rule 502 variance requested	<input type="checkbox"/> Status Update/Change of Remediation Plans
<input type="checkbox"/> Casing/Cementing Program Change	<input checked="" type="checkbox"/> Other: 2A Facilities Change	for Spills and Releases

I hereby certify that the statements made in this form are, to the best of my knowledge, true, correct and complete.

Signed: Mary Pobuda Date: 05/06/2011 Email: mpobuda@billbarrettcorp.com  
Print Name: Mary Pobuda Title: Permit Analyst

COGCC Approved: \_\_\_\_\_ Title: \_\_\_\_\_ Date: \_\_\_\_\_  
CONDITIONS OF APPROVAL, IF ANY: \_\_\_\_\_

TECHNICAL INFORMATION PAGE



FOR OGCC USE ONLY

1. OGCC Operator Number: 10071 API Number: 05-045-19656-00
2. Name of Operator: Bill Barrett Corporation OGCC Facility ID # \_\_\_\_\_
3. Well/Facility Name: Kaufman Well/Facility Number: 12A-25-692
4. Location (QtrQtr, Sec, Twp, Rng, Meridian): NESW, Sec. 25, T6S, R92W, 6th PM

This form is to be completed whenever a Sundry Notice is submitted requiring detailed report of work to be performed or completed. This form shall be transmitted within 30 days of work completed as a "subsequent" report and must accompany Form 4, page 1.

5. DESCRIBE PROPOSED OR COMPLETED OPERATIONS

This sundry is being submitted to update the approved Form 2A (approved 6/27/10) for the Kaufman Pad #1 location (doc #400055906). The existing 2A allow indicated our need for temporary frac tanks but omitted BBC's two proposed drilling pits, one (105' x 25' x 20', capacity of 1500 c.y.) to be utilized as a cuttings trench to store surface hole cuttings and one (263' x 67' x 15', capacity of 40,071 bbls) to be utilized as a completion pit. The trench and pit will be constructed and closed according to OGCC regulations.

If you have any questions, please contact Tracey Fallang at 303-312-8134.

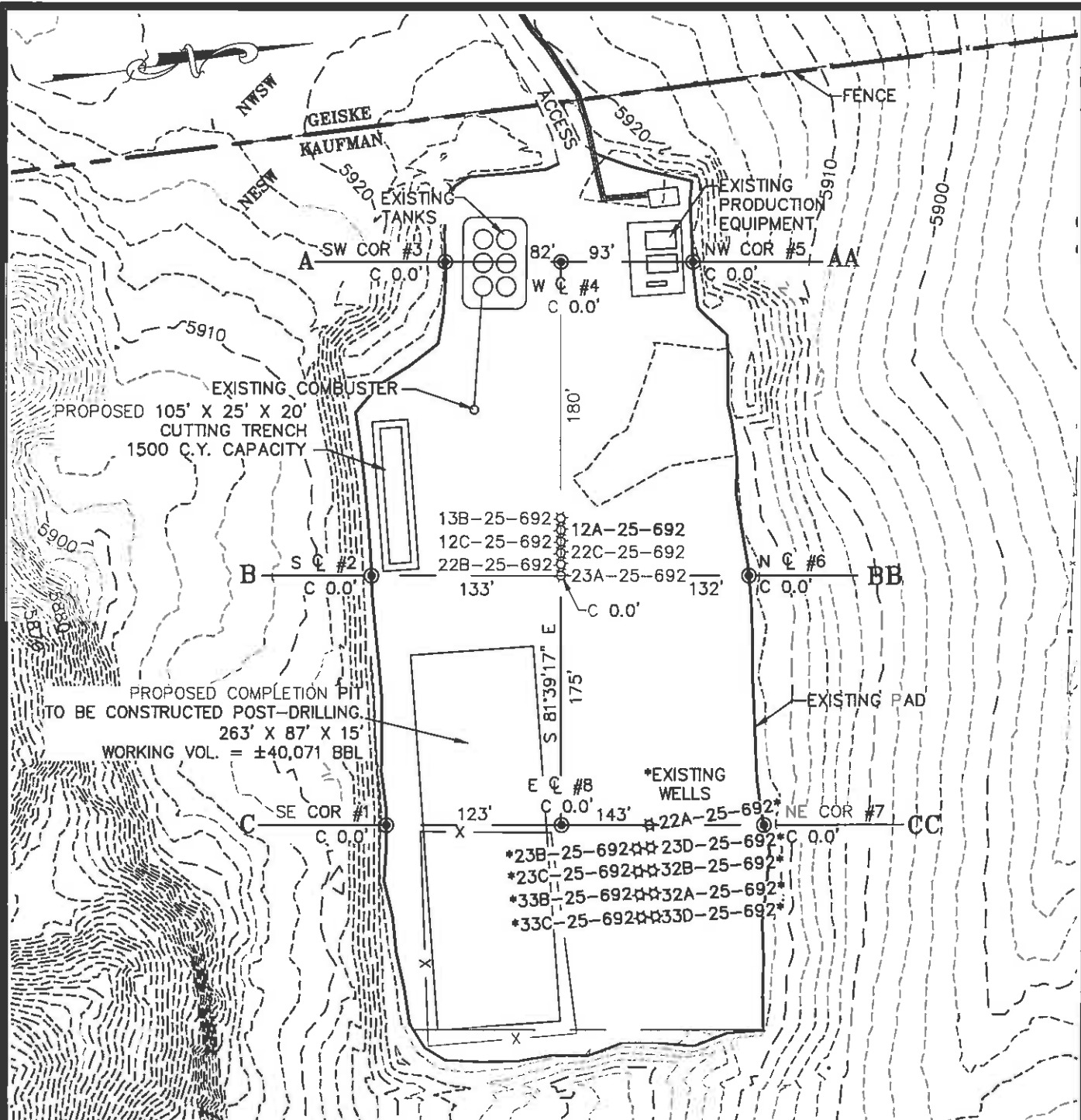

#### ESTIMATED DIRT QUANTITIES

ITEM	CUT	FILL	TOPSOIL	EXCESS
PAD	0	0	0	0
TOTALS	0	0	0	0

#### NOTES:

- 1) NO ADDITIONAL PAD EXCAVATION WILL BE DONE FOR PHASE II WELLS.
- 2) WELL SPACING IS 8 FT.
- 3) CUTTINGS TRENCH VOLUME IS BASED ON 250 C.Y. PER WELL.



**ECLIPSE**  
surveying

111 E. THIRD ST., SUITE 208, RIFLE, CO 81650  
(970) 625-3048

REV. DATE: 5/03/11  
SCALE: 1" = 100'  
DATE: 03/15/10  
SHEET: 1 OF 7  
PROJECT: KAUF1  
DFT: JAK

**B** Bill Barrett Corporation

**KAUFMAN PAD 1 PHASE II**  
**GRADING PLAN & PAD LAYOUT**

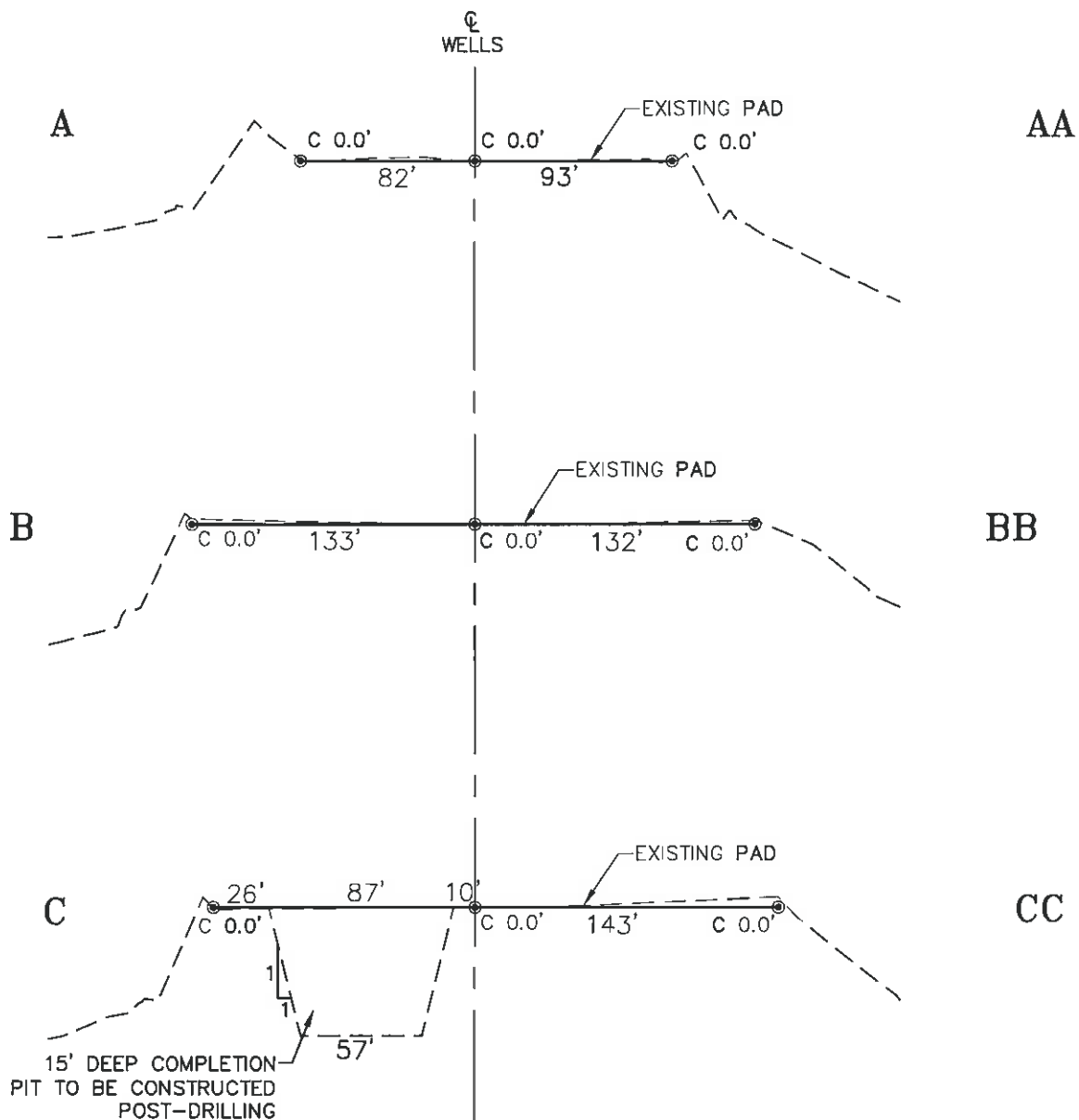

SCALE: Horiz.: 1" = 80'  
Vert. : 1" = 20'

NOTE:  
ALL PROPOSED CUT AND FILL  
SIDE SLOPES ARE AT 1.5:1  
UNLESS OTHERWISE NOTED.



**ECLIPSE**  
surveying

111 E. THIRD ST., SUITE 208, RIFLE, CO 81650  
(970) 625-3048

REV. DATE: 4/22/11  
SCALE: AS NOTED  
DATE: 03/15/10  
SHEET: 2 OF 7  
PROJECT: KAUF1  
DFT: JAK

**B** Bill Barrett Corporation

**KAUFMAN PAD 1 PHASE II  
DRILL PAD CROSS SECTIONS**