

EOG RESOURCES, INC.  
GEARY CREEK #06-10H & #03-10H  
SECTION 10, T10N, R63W, 6<sup>th</sup> P.M.

PROCEED IN A SOUTHEASTERLY DIRECTION FROM GROVER, COLORADO ALONG COUNTY ROAD 390 APPROXIMATELY 0.3 MILES TO THE JUNCTION OF THIS ROAD AND COUNTY ROAD 120 3/4 TO THE WEST; TURN RIGHT AND PROCEED IN A WESTERLY DIRECTION APPROXIMATELY 0.8 MILES TO THE JUNCTION OF THIS ROAD AND COUNTY ROAD 87 TO THE SOUTH; TURN LEFT AND PROCEED IN A SOUTHERLY DIRECTION APPROXIMATELY 0.8 MILES TO THE JUNCTION OF THIS ROAD AND COUNTY ROAD 120 TO THE WEST; TURN RIGHT AND PROCEED A WESTERLY DIRECTION APPROXIMATELY 9.9 MILES TO THE BEGINNING OF THE PROPOSED ACCESS ROAD TO THE SOUTH; FOLLOW ROAD FLAGS IN A SOUTHERLY, THEN SOUTHEASTERLY DIRECTION APPROXIMATELY 624' TO THE PROPOSED LOCATION.

TOTAL DISTANCE FROM GROVER, COLORADO TO THE PROPOSED WELL LOCATION IS APPROXIMATELY 11.9 MILES.

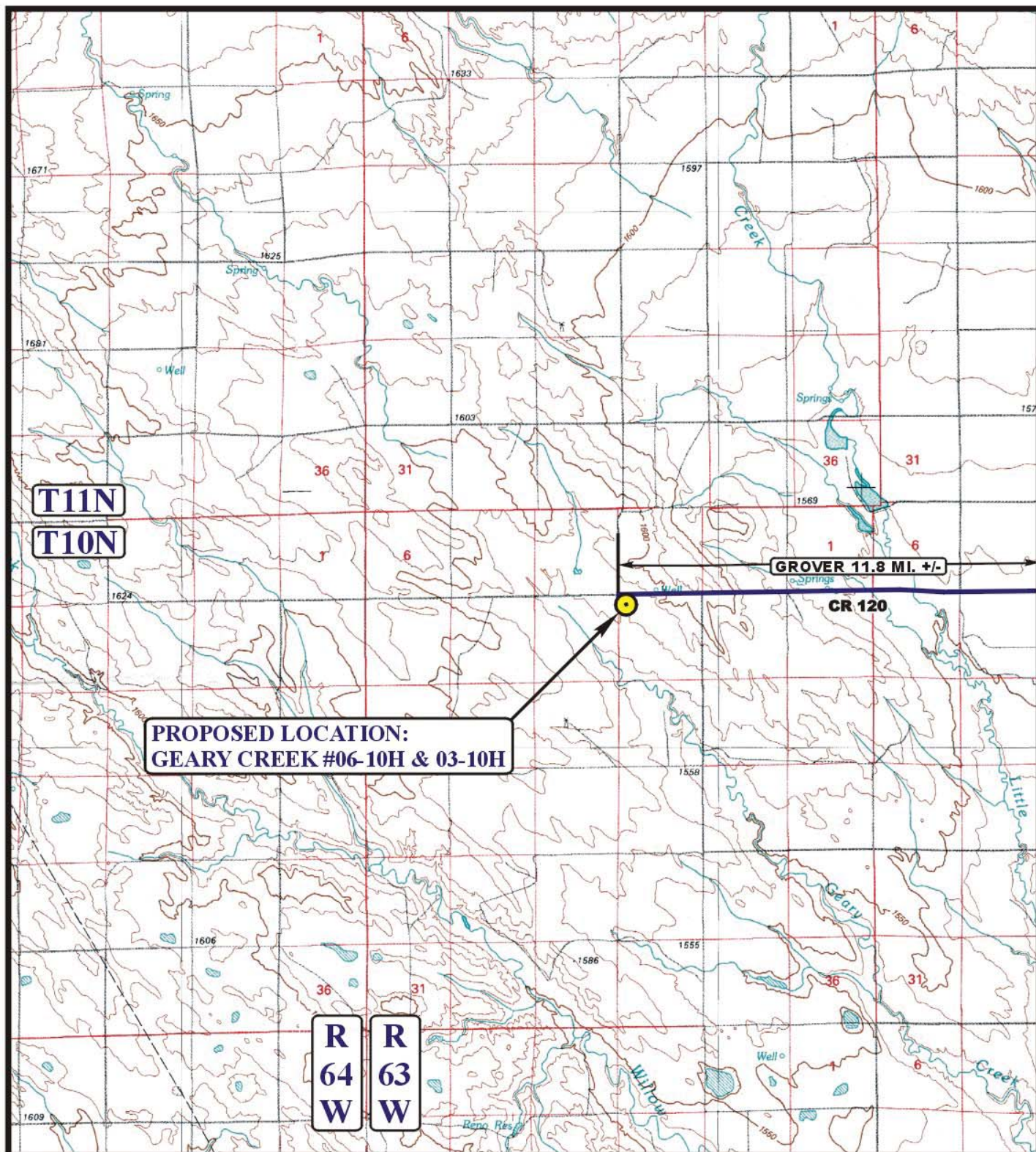

**LEGEND:**

 PROPOSED LOCATION



**EOG RESOURCES, INC.**

**GEARY CREEK #06-10H & #03-10H  
SECTION 10, T10N, R63W, 6th P.M.  
NW 1/4 NW 1/4**



**Uintah Engineering & Land Surveying**  
85 South 200 East Vernal, Utah 84078  
(435) 789-1017 \* FAX (435) 789-1813

**ACCESS ROAD  
MAP**

**01 20 11**  
MONTH DAY YEAR

SCALE: 1:100,000 DRAWN BY: S.F. REVISED: 00-00-00





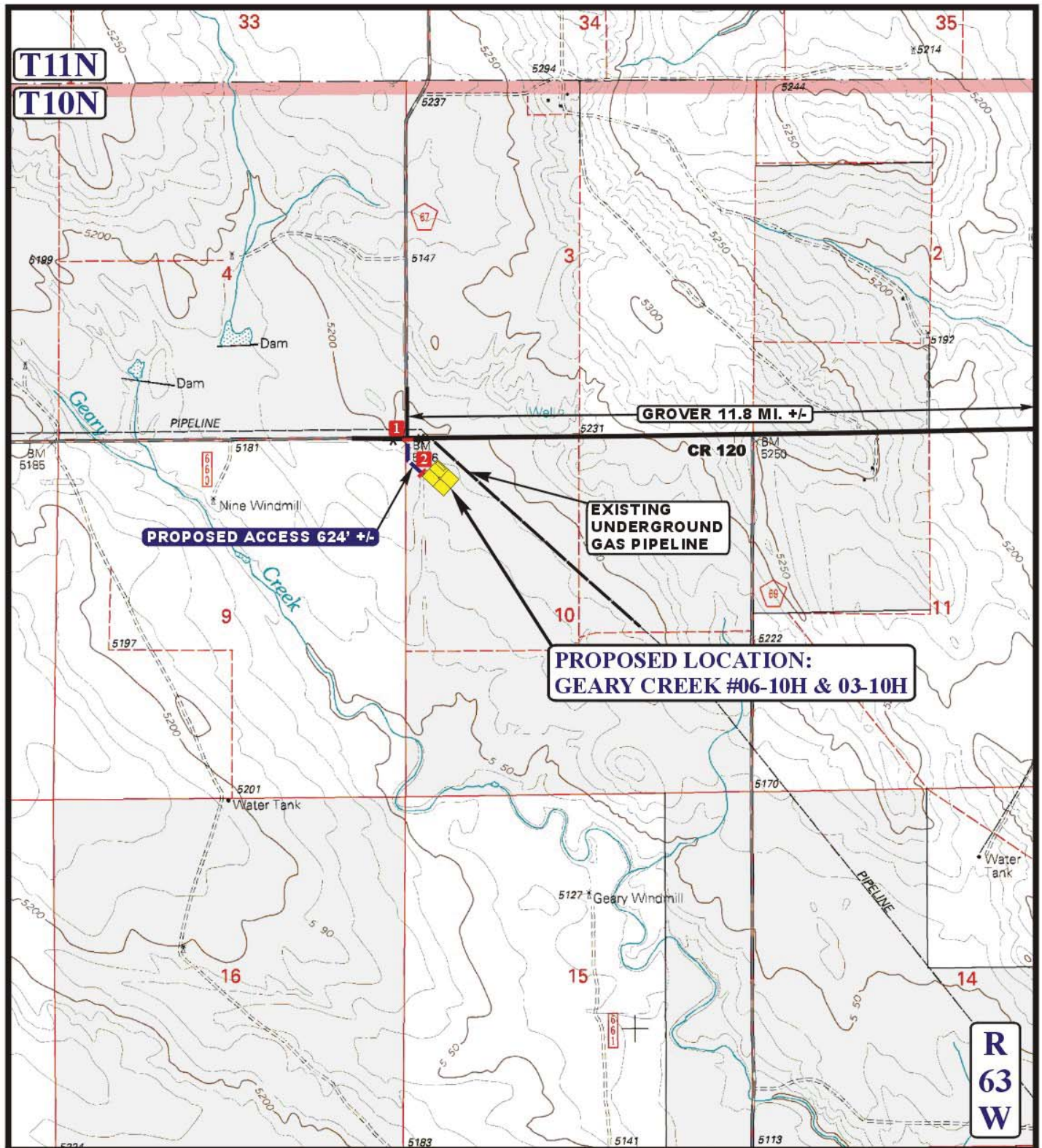

# **LEGEND:**

- EXISTING ROAD
- PROPOSED ACCESS ROAD
- EXISTING FENCE
- EXISTING PIPELINE
- 1 INSTALL CATTLE GUARD
- 2 LOW WATER CROSSING REQUIRED



**Uintah Engineering & Land Surveying**  
85 South 200 East Vernal, Utah 84078  
(435) 789-1017 \* FAX (435) 789-1813



**EOG RESOURCES, INC.**

**GEARY CREEK #06-10H & #03-10H**  
**SECTION 10, T10N, R63W, 6th P.M.**  
**NW 1/4 NW 1/4**

**ACCESS ROAD**  
**MAP**

**01 20 11**  
MONTH DAY YEAR

**SCALE: 1" = 2000'** **DRAWN BY: S.F.** **REVISED: 00-00-00**

**B**  
**TOPO**