

WELL LOCATION CERTIFICATE: GUERRERO 33-7

SECTION 7, TOWNSHIP 2 NORTH, RANGE 65 WEST, 6TH P.M.

N 88°11'57" E 5242.75'

NW SEC. 7
2" ALUM. CAP
LS 23027

NE SEC. 7
2" ALUM. CAP
LS 25937

NOTES:

THIS IS A DIRECTIONAL WELL.
BH LOCATION TO BE 1320' FSL & 50' FWL
BH LOCATION PROVIDED BY CLIENT.
LAND SURFACE USE-OPEN FIELD
TWINNING PROPOSED WELL GUERRERO 13-7
TO BE 16' E
PROPOSED WELL GUERRERO 13-7
TO BE 519' FSL & 526' FWL
SEE ATTACHED MAP FOR ADDITIONAL
IMPROVEMENTS WITHIN 400'.

(BASIS OF BEARINGS) SEE NOTE 3
N 00°34'14" W 5199.34'

S 00°01'02" W 5296.29'

7

SURFACE LOCATION

GROUND ELEVATION= 4985'
NAD83
LATITUDE= 40.147332°
LONGITUDE= 104.714003°

BOTTOM HOLE LOCATION

NAD83
LATITUDE= 40.149526°
LONGITUDE= 104.715651°

PDOP= 1.78
GPS OPERATOR: CHRIS PEARSON

BH- 1320' FSL
50' FWL

GUERRERO 33-7

GUERRERO 13-7

S 1/4 SEC. 7
2 1/2" ALUM. CAP
LS 23027

SW SEC. 7
2 1/2" ALUM. CAP
ILLEGIBLE

SE SEC. 7
2 1/2" ALUM. CAP
LS 23027

S 89°14'40" W 2541.41' S 89°15'47" W 2645.83'

WELL GUERRERO 33-7 TO BE LOCATED 519' FSL AND 510' FWL, SECTION 7, T2N, R65W OF THE 6th P.M.

LEGEND

⊕ = EXISTING MONUMENT ⊕ = BOTTOM HOLE BH = BOTTOM HOLE
● = PROPOSED WELL ◆ = EXISTING WELL

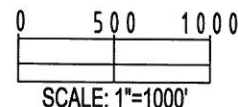

NOTES:

- THIS SURVEY WAS DONE BY GPS METHODS AND CONFORMS TO THE MINIMUM STANDARDS SET BY THE C.O.G.C.C., RULE NO. 215
- ELEVATIONS SHOWN AT THE WELL HEAD, AS WELL AS HORIZONTAL CONTROL, ARE BASED ON GPS-RTK VALUES DERIVED FROM DOING 2-HOUR STATIC GPS SESSIONS AND REDUCTIONS USING O.P.U.S. SOLUTIONS.
VERTICAL = NAVD88; HORIZONTAL = NAD83/92
- THE BEARINGS SHOWN HEREON ARE BASED ON GPS OBSERVATIONS BETWEEN THE MONUMENTS SHOWN HEREON AS FOUND ON THE FIELD DATE BELOW.
- DISTANCES SHOWN ARE AT GROUND LEVEL, AS MEASURED IN THE FIELD, WITH TIES TO WELLS MEASURED AT A PERPENDICULAR TO SECTION LINES.

I, JERRY F. HARCEK JR., A LICENSED PROFESSIONAL LAND SURVEYOR IN THE STATE OF COLORADO DO HEREBY CERTIFY TO **KERR-MCGEE OIL & GAS ONSHORE LP**, THAT THE SURVEY AND WELL LOCATION CERTIFICATE SHOWN HEREON WERE DONE BY ME OR UNDER MY DIRECT SUPERVISION AND THAT THE DRAWING SHOWN HEREON ACCURATELY DEPICTS THE PROPOSED LOCATION OF THE WELL **GUERRERO 33-7**. THIS CERTIFICATE DOES NOT REPRESENT A LAND SURVEY PLAT OR IMPROVEMENT SURVEY PLAT AS DEFINED BY C.R.S. 38-51-102 AND CANNOT BE RELIED UPON TO DETERMINE OWNERSHIP.

JERRY F. HARCEK JR., PLS 34997
COLORADO LICENSED PROFESSIONAL LAND SURVEYOR
FOR AND ON BEHALF OF P.F.S., LLC

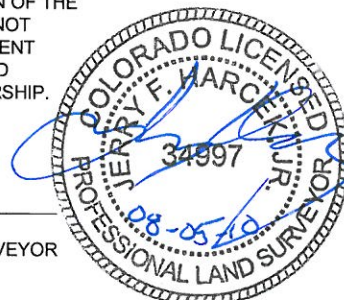

PREPARED BY:



FIELD DATE:
07-29-10

DRAWING DATE:
08-03-10
BY:
SMF

WELL NAME:
GUERRERO 33-7

SURFACE LOCATION:
WELD COUNTY, COLORADO
SW 1/4 SW 1/4, SEC. 7, T2N, R65W

NOTICE: ACCORDING TO COLORADO LAW YOU MUST COMMENCE ANY LEGAL ACTION BASED UPON ANY DEFECT IN THIS SURVEY WITHIN THREE YEARS AFTER YOU FIRST DISCOVER SUCH DEFECT. IN NO EVENT MAY ANY ACTION BASED UPON ANY DEFECT IN THIS SURVEY BE COMMENCED MORE THAN TEN YEARS FROM THIS SAID DATE OF THIS CERTIFICATION SHOWN HEREON.