

EOG RESOURCES, INC.

ADDENDUM TO LEGAL PLAT FOR
FISCUS MESA #14-15H
SECTION 15, T9N, R58W, 6th. P.M.
501' FNL 2434' FEL

SCALE: 1" = 200'
DATE: 11-9-10
DRAWN BY: J.I.



400' Offset
from Edge of
Disturbance

Well Head FISCUS MESA #14-15H
(NAD 83)
Lat: 40.757275°
Long: 103.849575°

400'

Existing
Fence

Topsail
Stockpile

S89°W 16.09'

S89°W 205.29'

400'

Reserve Pit Backfill
& Spoils Stockpile

Pit

400'

Proposed
Access Road

Existing
Fence

EOG RESOURCES, INC.

CONSTRUCTION LAYOUT FOR

FISCUS MESA #14-15H
SECTION 15, T9N, R58W, 6th. P.M.
501' FNL 2434' FEL

FIGURE #1

SCALE: 1" = 60'

DATE: 11-9-10

DRAWN BY: J.I.

REV.: 11-19-10 J.I.

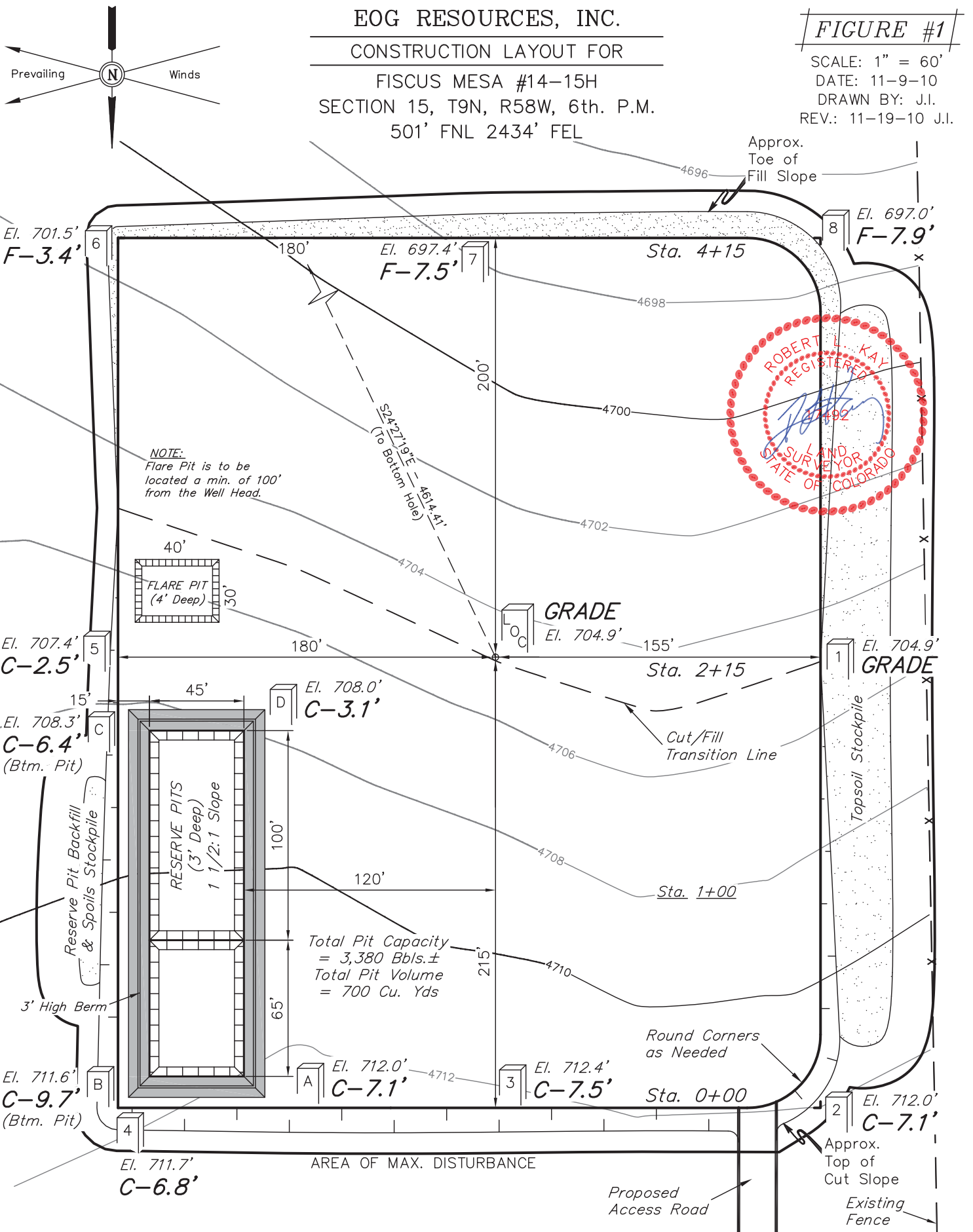

NOTE:
Flare Pit is to be
located a min. of 100'
from the Well Head.

Total Pit Capacity
= 3,380 Bbls.±
Total Pit Volume
= 700 Cu. Yds

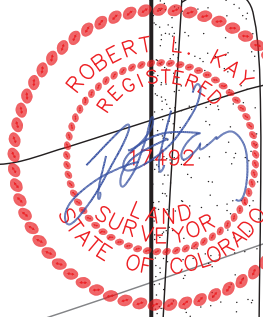

Elev. Ungraded Ground At Loc. Stake = 4704.9'
FINISHED GRADE ELEV. AT LOC. STAKE = 4704.9'

UINTAH ENGINEERING & LAND SURVEYING
85 So. 200 East * Vernal, Utah 84078 * (435) 789-1017

EOG RESOURCES, INC.

FIGURE #2

CONSTRUCTION LAYOUT CROSS SECTIONS FOR
 FISCUS MESA #14-15H
 SECTION 15, T9N, R58W, 6th. P.M.
 501' FNL 2434' FEL

X-Section Scale
 1" = 100'
 DATE: 11-9-10
 DRAWN BY: J.I.

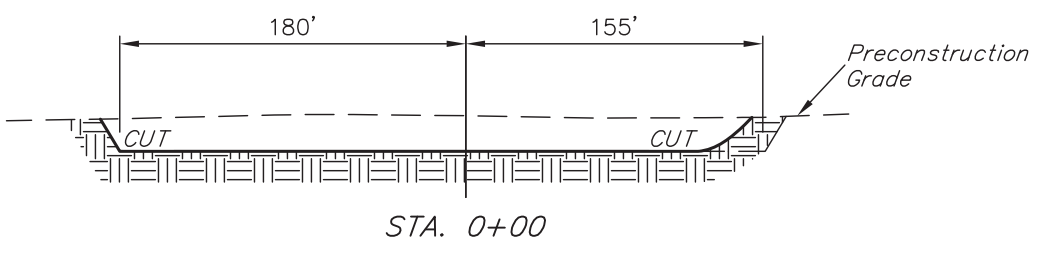
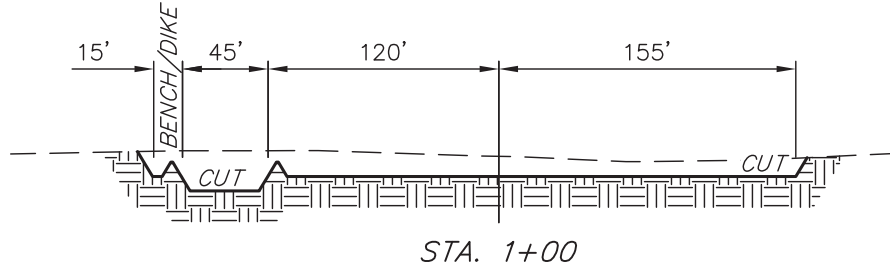
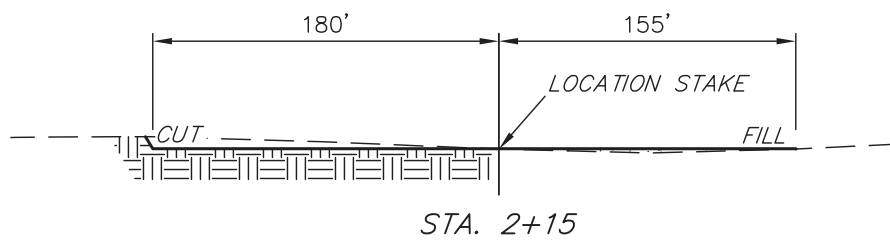
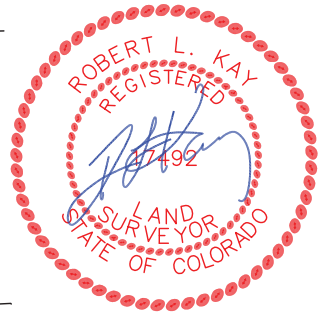
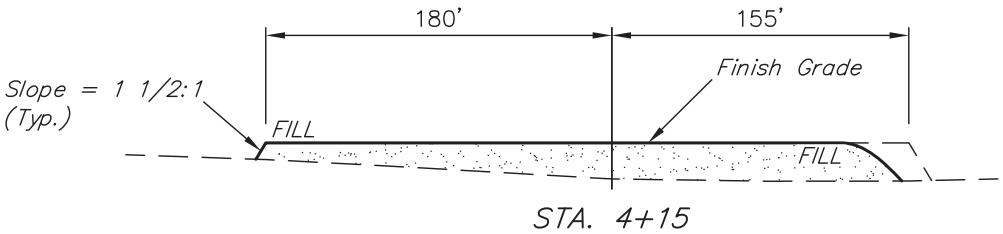

NOTE:
 Topsoil should not be Stripped Below Finished Grade on Substructure Area.

APPROXIMATE ACREAGES
 WELL SITE DISTURBANCE = ± 4.201 ACRES
 ACCESS ROAD DISTURBANCE = ± 1.223 ACRES
 TOTAL = ± 5.424 ACRES

* NOTE:
 FILL QUANTITY INCLUDES 5% FOR COMPACTION

APPROXIMATE YARDAGES

(6") Topsoil Stripping	=	2,840 Cu. Yds.
Remaining Location	=	10,560 Cu. Yds.
TOTAL CUT	=	13,400 CU.YDS.
FILL	=	10,210 CU.YDS.

EXCESS MATERIAL	=	3,190 Cu. Yds.
Topsoil & Pit Backfill (1/2 Pit Vol.)	=	3,190 Cu. Yds.
EXCESS UNBALANCE (After Interim Rehabilitation)	=	0 Cu. Yds.

UINTAH ENGINEERING & LAND SURVEYING
 85 So. 200 East * Vernal, Utah 84078 * (435) 789-1017

EOG RESOURCES, INC.

TYPICAL RIG LAYOUT FOR

FISCUS MESA #14-15H
SECTION 15, T9N, R58W, 6th. P.M.
501' FNL 2434' FEL

FIGURE #3

SCALE: 1" = 60'

DATE: 11-9-10

DRAWN BY: J.I.

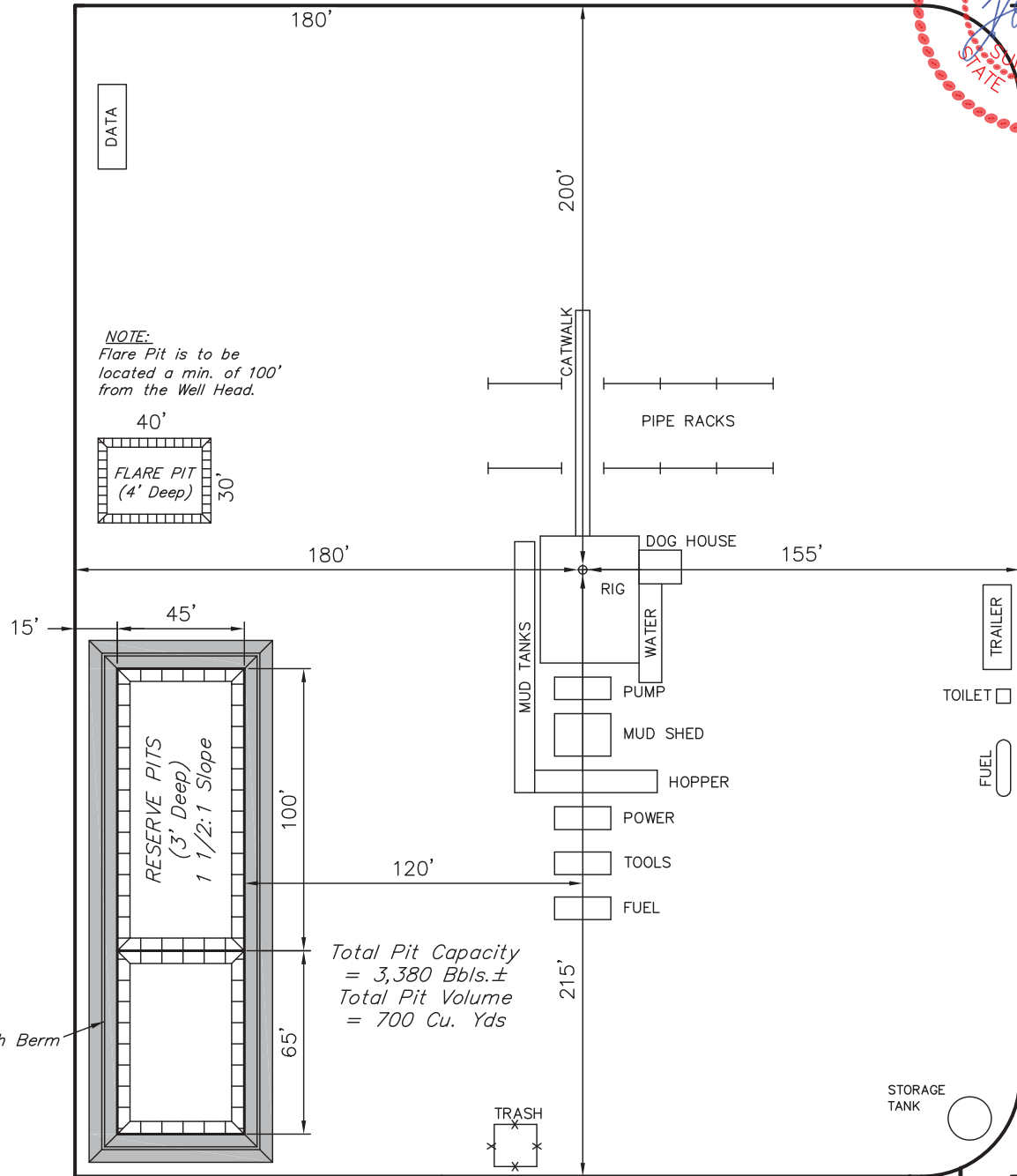
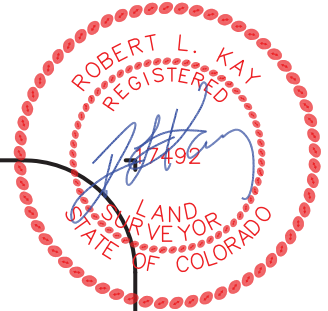

Total Pit Capacity = 3,380 Bbls.±
Total Pit Volume = 700 Cu. Yds

Proposed Access Road

EOG RESOURCES, INC.
RECLAMATION DIAGRAM FOR
FISCUS MESA #14-15H
SECTION 15, T9N, R58W, 6th. P.M.
501' FNL 2434' FEL

FIGURE #4

SCALE: 1" = 60'
DATE: 11-9-10
DRAWN BY: J.I.

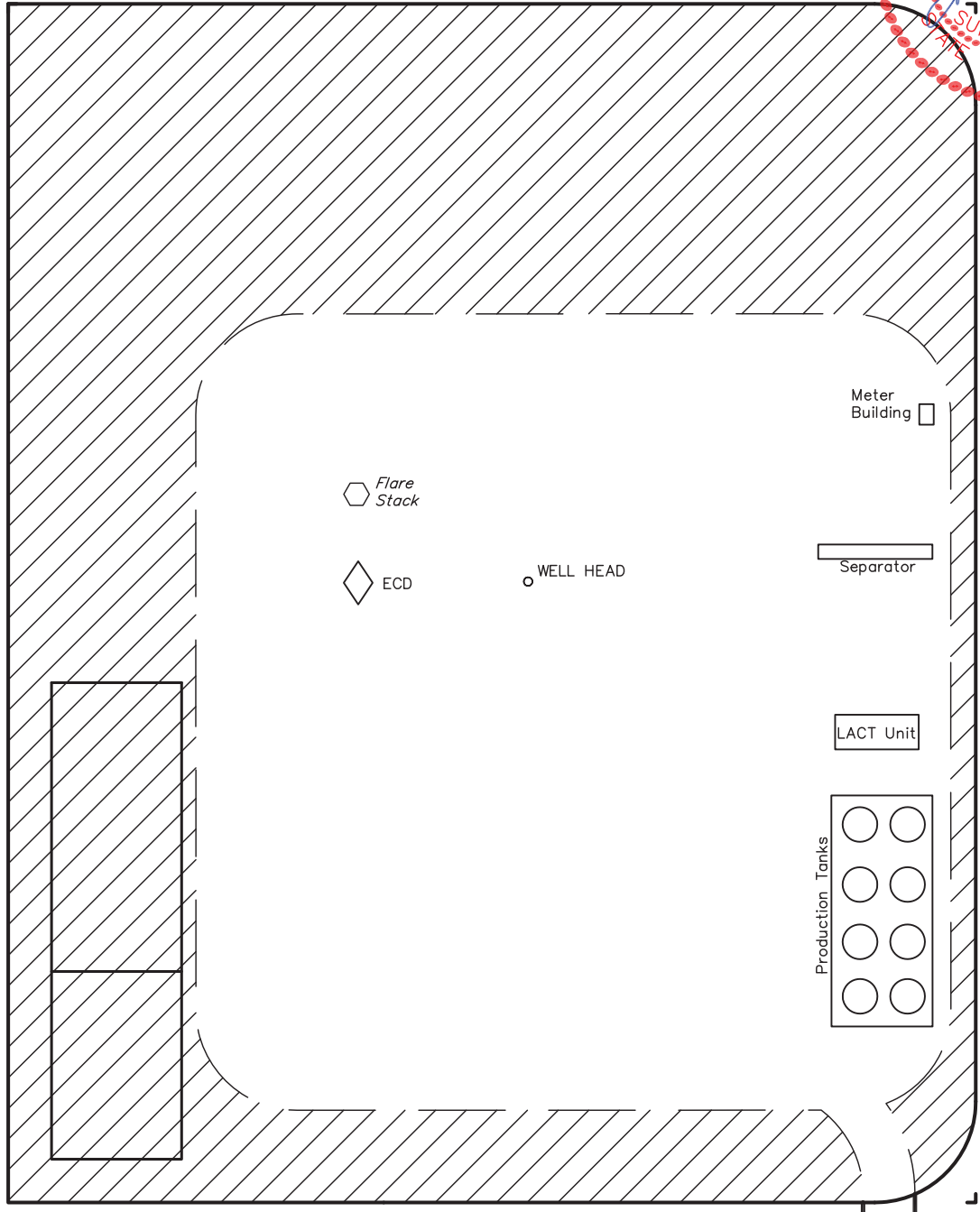

APPROXIMATE ACREAGES
UN-RECLAIMED = ± 1.645 ACRES

Access Road

 RECLAIMED AREA

EOG RESOURCES, INC.

FIGURE #5

LOCATION DRAWING FOR
 FISCUS MESA #14-15H
 SECTION 15, T9N, R58W, 6th. P.M.
 501' FNL 2434' FEL

NW Cor. Sec. 15
 Set UELS Alum.
 Cap, 1.0' Below
 Road
 Lat: 40.758581°
 Long: 103.859856°
 N89°29'51"E
 2634.21' (Meas.)

1918 Brass Cap,
 1.0' High, N/S
 Fence
 Lat: 40.758647°
 Long: 103.850350°

1918 Brass Cap,
 0.9' Below Ground
 Lat: 40.758700°
 Long: 103.840822°

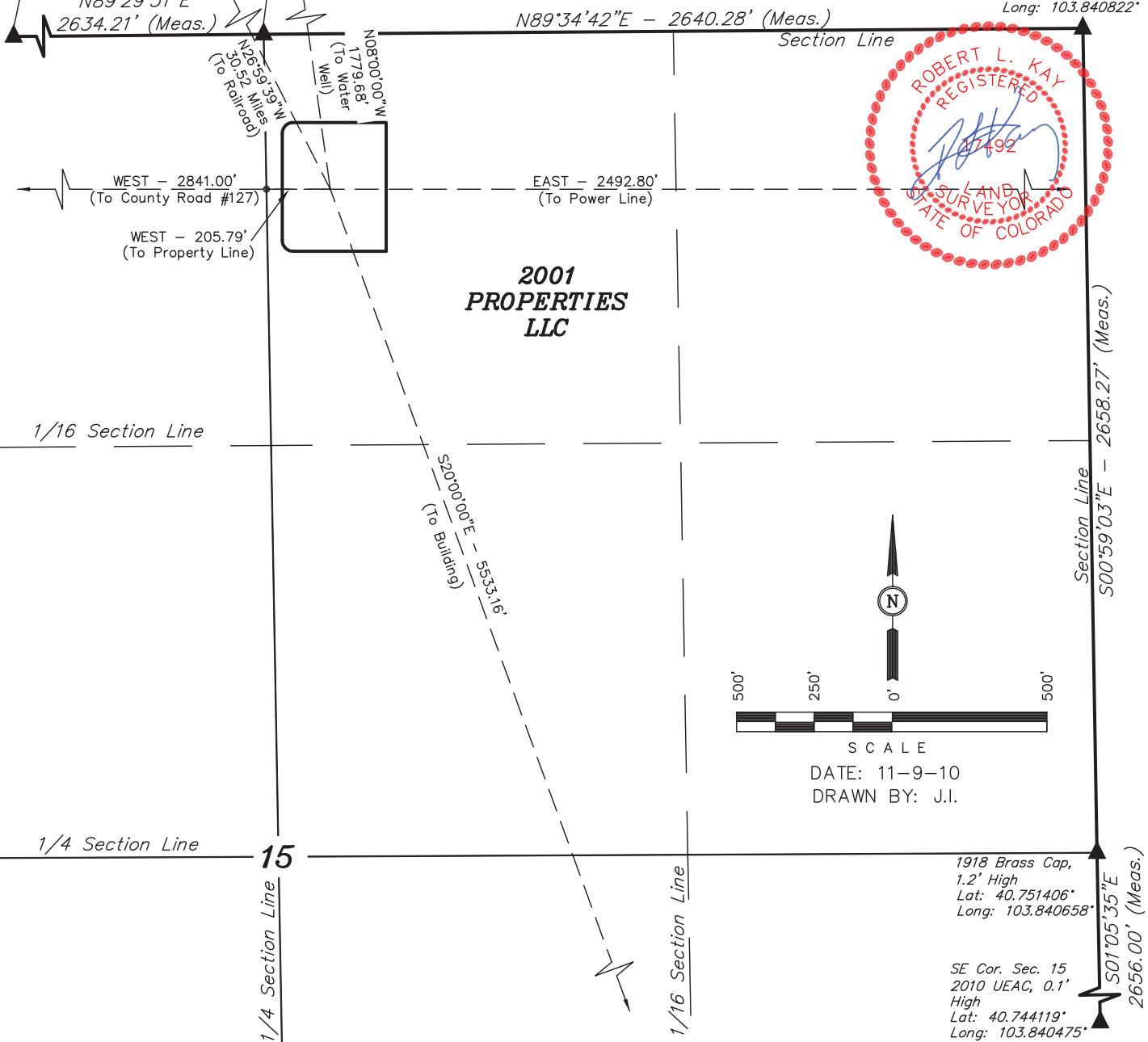

**2001
 PROPERTIES
 LLC**

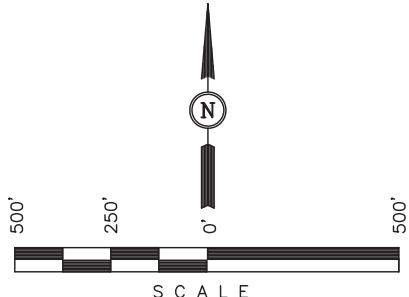
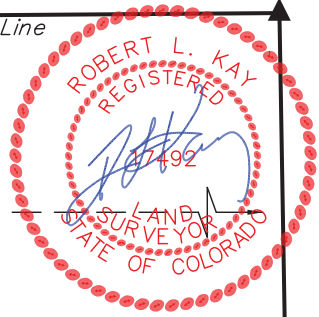

SCALE
 DATE: 11-9-10
 DRAWN BY: J.I.

PLANT COMMUNITY	
<input type="checkbox"/>	DISTURBED GRASSLAND
<input type="checkbox"/>	NATIVE GRASSLAND
<input type="checkbox"/>	SHRUB LAND
<input type="checkbox"/>	PLAINS RIPARIAN
<input type="checkbox"/>	MOUNTAIN RIPARIAN
<input type="checkbox"/>	FOREST LAND
<input type="checkbox"/>	WETLANDS AQUATIC
<input type="checkbox"/>	ALPINE
<input type="checkbox"/>	OTHER (Describe): _____

CURRENT LAND USE	
CROP LAND:	<input type="checkbox"/> IRRIGATED <input type="checkbox"/> DRY LAND <input type="checkbox"/> IMPROVED PASTURE <input type="checkbox"/> HAY MEADOW <input type="checkbox"/> CRP
NON-CROP LAND:	<input type="checkbox"/> RANGELAND <input type="checkbox"/> TIMBER <input type="checkbox"/> RECREATIONAL <input type="checkbox"/> OTHER (Describe) _____
SUBDIVIDED:	<input type="checkbox"/> INDUSTRIAL <input type="checkbox"/> COMMERCIAL <input type="checkbox"/> RESIDENTIAL _____

FUTURE LAND USE	
CROP LAND:	<input type="checkbox"/> IRRIGATED <input type="checkbox"/> DRY LAND <input type="checkbox"/> IMPROVED PASTURE <input type="checkbox"/> HAY MEADOW <input type="checkbox"/> CRP
NON-CROP LAND:	<input type="checkbox"/> RANGELAND <input type="checkbox"/> TIMBER <input type="checkbox"/> RECREATIONAL <input type="checkbox"/> OTHER (Describe) _____
SUBDIVIDED:	<input type="checkbox"/> INDUSTRIAL <input type="checkbox"/> COMMERCIAL <input type="checkbox"/> RESIDENTIAL _____