

**PROPOSED PIPELINE ROUTE**  
**SOUTHWESTERN ENERGY VENTURES COMPANY, LLC**  
**THOMAS #5** 3,173' FSL, 847' FEL  
**SECTION 4, T-9-S, R-104-W, 6TH P.M.,**  
**MESA COUNTY COLORADO**

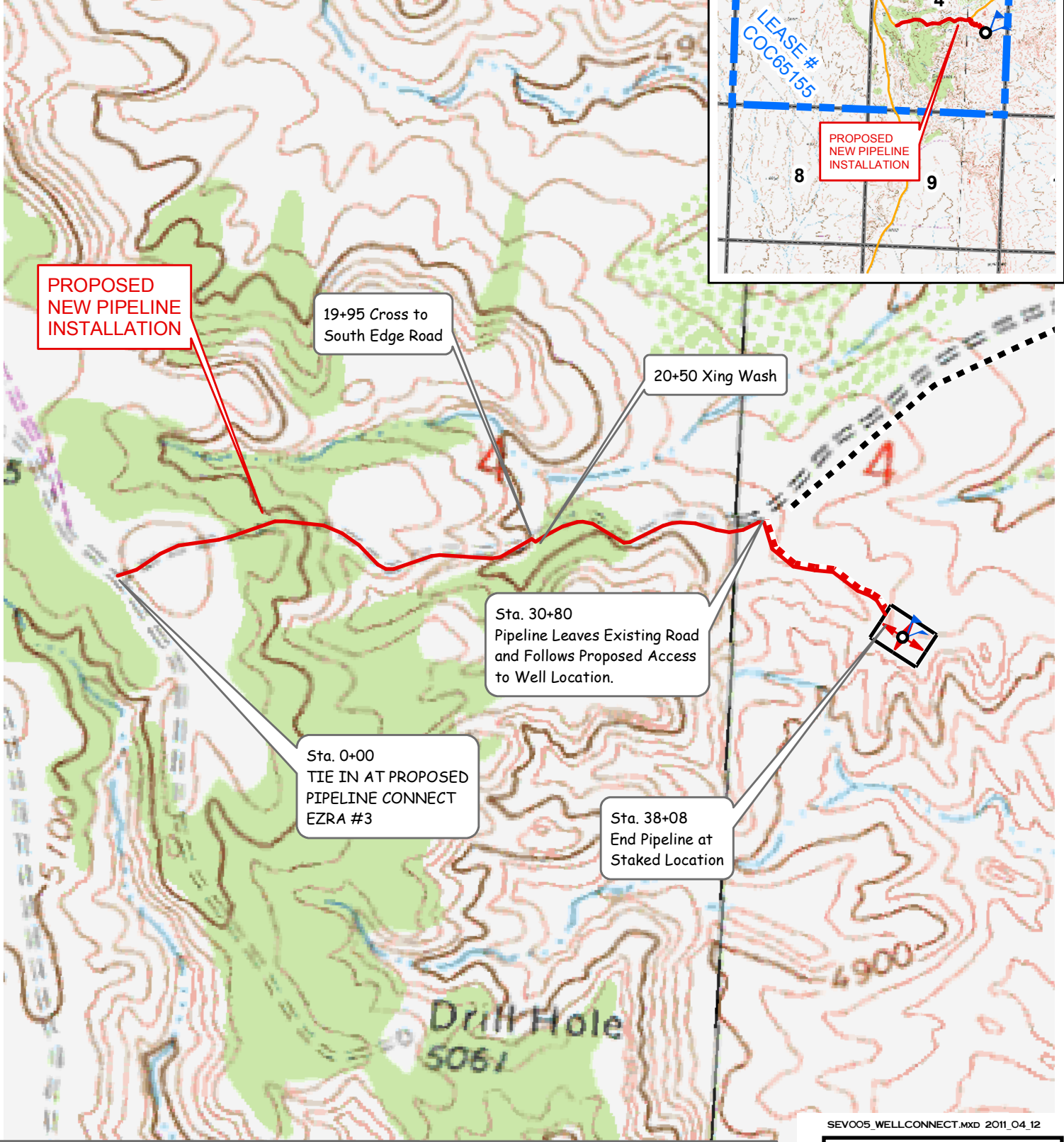
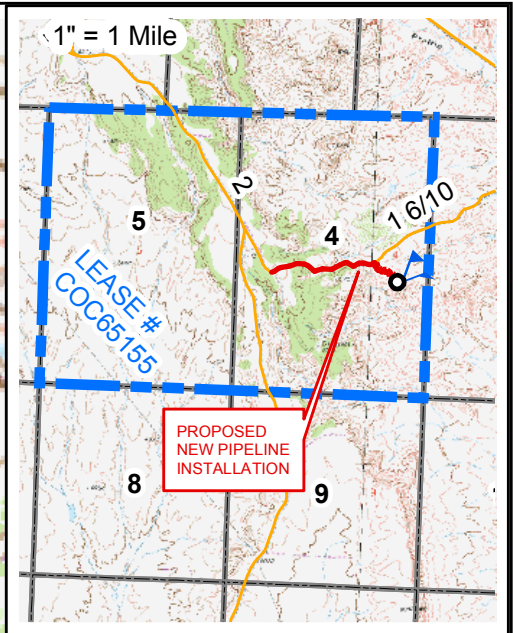

**PROPOSED  
 NEW PIPELINE  
 INSTALLATION**

19+95 Cross to  
 South Edge Road

20+50 Xing Wash

Sta. 30+80  
 Pipeline Leaves Existing Road  
 and Follows Proposed Access  
 to Well Location.

Sta. 0+00  
 TIE IN AT PROPOSED  
 PIPELINE CONNECT  
 EZRA #3

Sta. 38+08  
 End Pipeline at  
 Staked Location

Drill Hole  
 5061

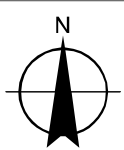
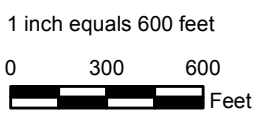

**APPROX. TOTAL PIPELINE  
 LENGTH = 3,808'**  
 (Follows Proposed and  
 Existing road)

SEVO05\_WELLCONNECT.MXD 2011\_04\_12

**JMAS**  
 JOHNSON MAPPING  
 AND SURVEYING, LLC  
 PO BOX 2174,  
 FARMINGTON NM 87499-2174  
 505-360-8029  
 ALEX@JOHNSONMAPPING.BIZ