

Well Details: CC 697-05-63A

TVD Reference: GL 8629' & RKB 30' @ 8659.00ft (H&P) Ground Level: 8629.00

| | | | | | | |
|-------|-------|-----------|------------|------------------|-------------------|------|
| +N/-S | +E/-W | Northing | Easting | Latitude | Longitude | Slot |
| 0.00 | 0.00 | 636336.12 | 1230390.83 | 39° 32' 55.752 N | 108° 13' 46.415 W | N |

T M Azimuths to True North
Magnetic North: 10.47°



Magnetic Field
Strength: 52282.7snT
Dip Angle: 65.76°
Date: 2011/03/23
Model: IGRF2005-10

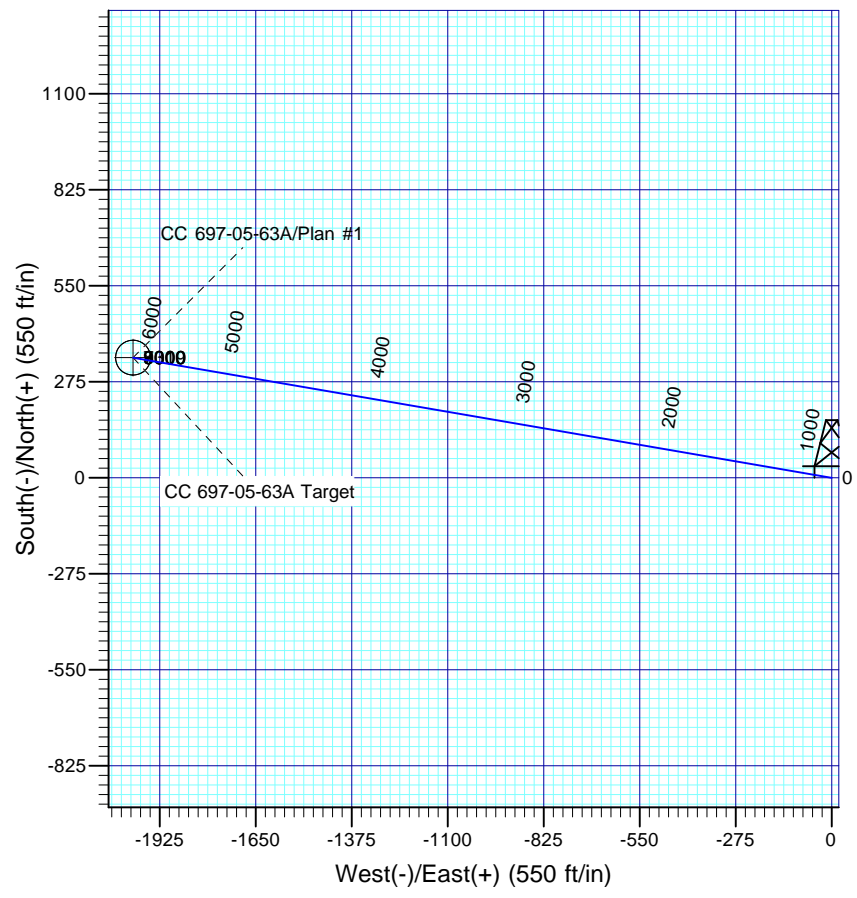
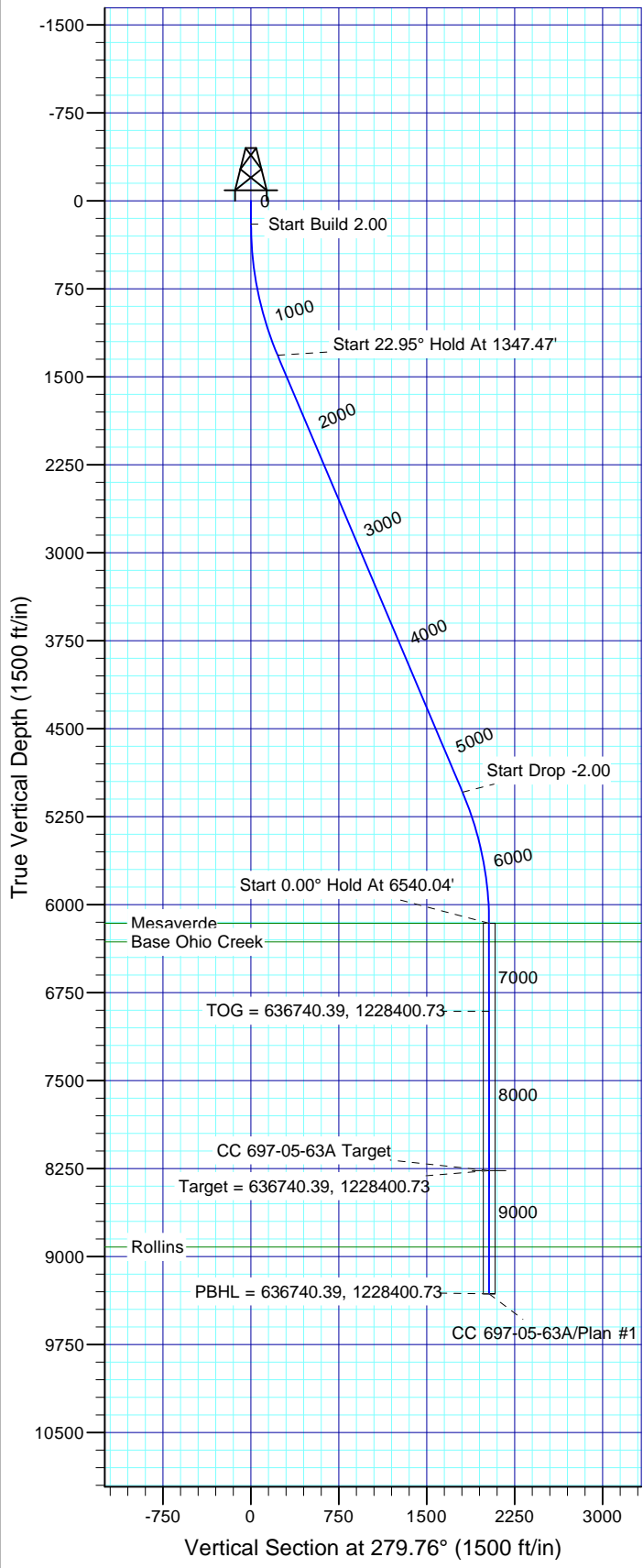

| FORMATION TOP DETAILS | | | | Plan: Plan #1 | |
|-----------------------|---------|-----------------|--|---|--|
| TVDPath | MDPath | Formation | | 15:44, March 29 2011 | |
| 6159.00 | 6540.04 | Mesaverde | | Created By: Rex Hall | |
| 6319.00 | 6700.04 | Base Ohio Creek | | PROJECT DETAILS: Garfield County, CO NAD27 | |
| 8919.00 | 9300.04 | Rollins | | Geodetic System: US State Plane 1927 (Exact solution) | |
| | | | | Datum: NAD 1927 (NADCON CONUS) | |
| | | | | Ellipsoid: Clarke 1866 | |
| | | | | Zone: Colorado Central 502 | |
| | | | | System Datum: Mean Sea Level | |

| SECTION DETAILS | | | | | | | | | | |
|-----------------|---------|-------|--------|---------|--------|----------|------|--------|---------|----------------------|
| Sec | MD | Inc | Azi | TVD | +N/-S | +E/-W | Dleg | TFace | VSect | Target |
| 1 | 0.00 | 0.00 | 0.00 | 0.00 | 0.00 | 0.00 | 0.00 | 0.00 | 0.00 | |
| 2 | 200.00 | 0.00 | 0.00 | 200.00 | 0.00 | 0.00 | 0.00 | 0.00 | 0.00 | |
| 3 | 1347.47 | 22.95 | 279.76 | 1317.03 | 38.44 | -223.47 | 2.00 | 279.76 | 226.75 | |
| 4 | 5392.58 | 22.95 | 279.76 | 5041.97 | 305.86 | -1777.89 | 0.00 | 0.00 | 1804.01 | |
| 5 | 6540.04 | 0.00 | 0.00 | 6159.00 | 344.31 | -2001.35 | 2.00 | 180.00 | 2030.75 | |
| 6 | 8650.04 | 0.00 | 0.00 | 8269.00 | 344.31 | -2001.35 | 0.00 | 0.00 | 2030.75 | CC 697-05-63A Target |
| 7 | 9700.04 | 0.00 | 0.00 | 9319.00 | 344.31 | -2001.35 | 0.00 | 0.00 | 2030.75 | |

OXY USA RMAT

**Garfield County, CO NAD27
Cascade Creek 697-04D Pad
CC 697-05-63A - Slot N**

OH

Plan: Plan #1

Standard Planning Report

29 March, 2011

Scientific Drilling International

Planning Report

| | | | |
|------------------|---------------------------|-------------------------------------|--------------------------------------|
| Database: | EDM-RexH-Local | Local Co-ordinate Reference: | Well CC 697-05-63A - Slot N |
| Company: | OXY USA RMAT | TVD Reference: | GL 8629' & RKB 30' @ 8659.00ft (H&P) |
| Project: | Garfield County, CO NAD27 | MD Reference: | GL 8629' & RKB 30' @ 8659.00ft (H&P) |
| Site: | Cascade Creek 697-04D Pad | North Reference: | True |
| Well: | CC 697-05-63A | Survey Calculation Method: | Minimum Curvature |
| Wellbore: | OH | | |
| Design: | Plan #1 | | |

| | | | |
|--------------------|--------------------------------------|----------------------|----------------|
| Project | Garfield County, CO NAD27 | | |
| Map System: | US State Plane 1927 (Exact solution) | System Datum: | Mean Sea Level |
| Geo Datum: | NAD 1927 (NADCON CONUS) | | |
| Map Zone: | Colorado Central 502 | | |

| | | | | | |
|------------------------------|---------------------------|---------------------|-------------------|--------------------------|---------|
| Site | Cascade Creek 697-04D Pad | | | | |
| Site Position: | Northing: | 635,530.62 usft | Latitude: | 39° 32' 47.760 N | |
| From: Map | Easting: | 1,230,276.10 usft | Longitude: | 108° 13' 47.570 W | |
| Position Uncertainty: | 0.00 ft | Slot Radius: | 13.200 in | Grid Convergence: | -1.72 ° |

| | | | | |
|-----------------------------|------------------------|-----------|----------------------------|----------------------|
| Well | CC 697-05-63A - Slot N | | | |
| Well Position | +N/-S | 808.59 ft | Northing: | 636,336.12 usft |
| | +E/-W | 90.48 ft | Easting: | 1,230,390.83 usft |
| Position Uncertainty | | 0.00 ft | Wellhead Elevation: | Ground Level: |
| | | | | 8,629.00 ft |

| | | | | | |
|------------------|-------------------|--------------------|------------------------|----------------------|----------------------------|
| Wellbore | OH | | | | |
| Magnetics | Model Name | Sample Date | Declination (°) | Dip Angle (°) | Field Strength (nT) |
| | IGRF2005-10 | 2011/03/23 | 10.47 | 65.76 | 52,283 |

| | | | | |
|--------------------------|------------------------------|-------------------|----------------------|----------------------|
| Design | Plan #1 | | | |
| Audit Notes: | | | | |
| Version: | Phase: | PLAN | Tie On Depth: | 0.00 |
| Vertical Section: | Depth From (TVD) (ft) | +N/-S (ft) | +E/-W (ft) | Direction (°) |
| | 0.00 | 0.00 | 0.00 | 279.76 |

| Plan Sections | | | | | | | | | | |
|----------------------|-----------------|-------------|---------------------|------------|------------|-----------------------|----------------------|---------------------|---------|----------------------|
| Measured Depth (ft) | Inclination (°) | Azimuth (°) | Vertical Depth (ft) | +N/-S (ft) | +E/-W (ft) | Dogleg Rate (°/100ft) | Build Rate (°/100ft) | Turn Rate (°/100ft) | TFO (°) | Target |
| 0.00 | 0.00 | 0.00 | 0.00 | 0.00 | 0.00 | 0.00 | 0.00 | 0.00 | 0.00 | |
| 200.00 | 0.00 | 0.00 | 200.00 | 0.00 | 0.00 | 0.00 | 0.00 | 0.00 | 0.00 | |
| 1,347.47 | 22.95 | 279.76 | 1,317.03 | 38.44 | -223.47 | 2.00 | 2.00 | 0.00 | 279.76 | |
| 5,392.58 | 22.95 | 279.76 | 5,041.97 | 305.86 | -1,777.89 | 0.00 | 0.00 | 0.00 | 0.00 | |
| 6,540.04 | 0.00 | 0.00 | 6,159.00 | 344.31 | -2,001.35 | 2.00 | -2.00 | 0.00 | 180.00 | |
| 8,650.04 | 0.00 | 0.00 | 8,269.00 | 344.31 | -2,001.35 | 0.00 | 0.00 | 0.00 | 0.00 | CC 697-05-63A Target |
| 9,700.04 | 0.00 | 0.00 | 9,319.00 | 344.31 | -2,001.35 | 0.00 | 0.00 | 0.00 | 0.00 | |

Scientific Drilling International

Planning Report

| | | | |
|------------------|---------------------------|-------------------------------------|--------------------------------------|
| Database: | EDM-RexH-Local | Local Co-ordinate Reference: | Well CC 697-05-63A - Slot N |
| Company: | OXY USA RMAT | TVD Reference: | GL 8629' & RKB 30' @ 8659.00ft (H&P) |
| Project: | Garfield County, CO NAD27 | MD Reference: | GL 8629' & RKB 30' @ 8659.00ft (H&P) |
| Site: | Cascade Creek 697-04D Pad | North Reference: | True |
| Well: | CC 697-05-63A | Survey Calculation Method: | Minimum Curvature |
| Wellbore: | OH | | |
| Design: | Plan #1 | | |

| Planned Survey | | | | | | | | | | |
|--------------------------------------|-----------------|-------------|---------------------|------------|------------|-----------------------|-----------------------|----------------------|---------------------|------|
| Measured Depth (ft) | Inclination (°) | Azimuth (°) | Vertical Depth (ft) | +N/-S (ft) | +E/-W (ft) | Vertical Section (ft) | Dogleg Rate (°/100ft) | Build Rate (°/100ft) | Turn Rate (°/100ft) | |
| 0.00 | 0.00 | 0.00 | 0.00 | 0.00 | 0.00 | 0.00 | 0.00 | 0.00 | 0.00 | 0.00 |
| 100.00 | 0.00 | 0.00 | 100.00 | 0.00 | 0.00 | 0.00 | 0.00 | 0.00 | 0.00 | 0.00 |
| 200.00 | 0.00 | 0.00 | 200.00 | 0.00 | 0.00 | 0.00 | 0.00 | 0.00 | 0.00 | 0.00 |
| Start Build 2.00 | | | | | | | | | | |
| 300.00 | 2.00 | 279.76 | 299.98 | 0.30 | -1.72 | 1.75 | 2.00 | 2.00 | 2.00 | 0.00 |
| 400.00 | 4.00 | 279.76 | 399.84 | 1.18 | -6.88 | 6.98 | 2.00 | 2.00 | 2.00 | 0.00 |
| 500.00 | 6.00 | 279.76 | 499.45 | 2.66 | -15.47 | 15.69 | 2.00 | 2.00 | 2.00 | 0.00 |
| 600.00 | 8.00 | 279.76 | 598.70 | 4.73 | -27.48 | 27.88 | 2.00 | 2.00 | 2.00 | 0.00 |
| 700.00 | 10.00 | 279.76 | 697.47 | 7.38 | -42.89 | 43.52 | 2.00 | 2.00 | 2.00 | 0.00 |
| 800.00 | 12.00 | 279.76 | 795.62 | 10.61 | -61.70 | 62.60 | 2.00 | 2.00 | 2.00 | 0.00 |
| 900.00 | 14.00 | 279.76 | 893.06 | 14.43 | -83.86 | 85.10 | 2.00 | 2.00 | 2.00 | 0.00 |
| 1,000.00 | 16.00 | 279.76 | 989.64 | 18.82 | -109.37 | 110.98 | 2.00 | 2.00 | 2.00 | 0.00 |
| 1,100.00 | 18.00 | 279.76 | 1,085.27 | 23.77 | -138.18 | 140.21 | 2.00 | 2.00 | 2.00 | 0.00 |
| 1,200.00 | 20.00 | 279.76 | 1,179.82 | 29.29 | -170.27 | 172.77 | 2.00 | 2.00 | 2.00 | 0.00 |
| 1,300.00 | 22.00 | 279.76 | 1,273.17 | 35.37 | -205.58 | 208.60 | 2.00 | 2.00 | 2.00 | 0.00 |
| 1,347.47 | 22.95 | 279.76 | 1,317.03 | 38.44 | -223.47 | 226.75 | 2.00 | 2.00 | 2.00 | 0.00 |
| Start 22.95° Hold At 1347.47' | | | | | | | | | | |
| 1,400.00 | 22.95 | 279.76 | 1,365.41 | 41.92 | -243.65 | 247.23 | 0.00 | 0.00 | 0.00 | 0.00 |
| 1,500.00 | 22.95 | 279.76 | 1,457.49 | 48.53 | -282.08 | 286.22 | 0.00 | 0.00 | 0.00 | 0.00 |
| 1,600.00 | 22.95 | 279.76 | 1,549.58 | 55.14 | -320.51 | 325.22 | 0.00 | 0.00 | 0.00 | 0.00 |
| 1,700.00 | 22.95 | 279.76 | 1,641.66 | 61.75 | -358.93 | 364.21 | 0.00 | 0.00 | 0.00 | 0.00 |
| 1,800.00 | 22.95 | 279.76 | 1,733.75 | 68.36 | -397.36 | 403.20 | 0.00 | 0.00 | 0.00 | 0.00 |
| 1,900.00 | 22.95 | 279.76 | 1,825.83 | 74.97 | -435.79 | 442.19 | 0.00 | 0.00 | 0.00 | 0.00 |
| 2,000.00 | 22.95 | 279.76 | 1,917.92 | 81.58 | -474.22 | 481.18 | 0.00 | 0.00 | 0.00 | 0.00 |
| 2,100.00 | 22.95 | 279.76 | 2,010.00 | 88.19 | -512.64 | 520.17 | 0.00 | 0.00 | 0.00 | 0.00 |
| 2,200.00 | 22.95 | 279.76 | 2,102.09 | 94.80 | -551.07 | 559.17 | 0.00 | 0.00 | 0.00 | 0.00 |
| 2,300.00 | 22.95 | 279.76 | 2,194.17 | 101.42 | -589.50 | 598.16 | 0.00 | 0.00 | 0.00 | 0.00 |
| 2,400.00 | 22.95 | 279.76 | 2,286.26 | 108.03 | -627.92 | 637.15 | 0.00 | 0.00 | 0.00 | 0.00 |
| 2,500.00 | 22.95 | 279.76 | 2,378.34 | 114.64 | -666.35 | 676.14 | 0.00 | 0.00 | 0.00 | 0.00 |
| 2,600.00 | 22.95 | 279.76 | 2,470.43 | 121.25 | -704.78 | 715.13 | 0.00 | 0.00 | 0.00 | 0.00 |
| 2,700.00 | 22.95 | 279.76 | 2,562.51 | 127.86 | -743.21 | 754.12 | 0.00 | 0.00 | 0.00 | 0.00 |
| 2,800.00 | 22.95 | 279.76 | 2,654.60 | 134.47 | -781.63 | 793.12 | 0.00 | 0.00 | 0.00 | 0.00 |
| 2,900.00 | 22.95 | 279.76 | 2,746.68 | 141.08 | -820.06 | 832.11 | 0.00 | 0.00 | 0.00 | 0.00 |
| 3,000.00 | 22.95 | 279.76 | 2,838.77 | 147.69 | -858.49 | 871.10 | 0.00 | 0.00 | 0.00 | 0.00 |
| 3,100.00 | 22.95 | 279.76 | 2,930.85 | 154.30 | -896.91 | 910.09 | 0.00 | 0.00 | 0.00 | 0.00 |
| 3,200.00 | 22.95 | 279.76 | 3,022.94 | 160.91 | -935.34 | 949.08 | 0.00 | 0.00 | 0.00 | 0.00 |
| 3,300.00 | 22.95 | 279.76 | 3,115.02 | 167.52 | -973.77 | 988.07 | 0.00 | 0.00 | 0.00 | 0.00 |
| 3,400.00 | 22.95 | 279.76 | 3,207.11 | 174.13 | -1,012.20 | 1,027.07 | 0.00 | 0.00 | 0.00 | 0.00 |
| 3,500.00 | 22.95 | 279.76 | 3,299.19 | 180.75 | -1,050.62 | 1,066.06 | 0.00 | 0.00 | 0.00 | 0.00 |
| 3,600.00 | 22.95 | 279.76 | 3,391.28 | 187.36 | -1,089.05 | 1,105.05 | 0.00 | 0.00 | 0.00 | 0.00 |
| 3,700.00 | 22.95 | 279.76 | 3,483.36 | 193.97 | -1,127.48 | 1,144.04 | 0.00 | 0.00 | 0.00 | 0.00 |
| 3,800.00 | 22.95 | 279.76 | 3,575.45 | 200.58 | -1,165.90 | 1,183.03 | 0.00 | 0.00 | 0.00 | 0.00 |
| 3,900.00 | 22.95 | 279.76 | 3,667.53 | 207.19 | -1,204.33 | 1,222.02 | 0.00 | 0.00 | 0.00 | 0.00 |
| 4,000.00 | 22.95 | 279.76 | 3,759.62 | 213.80 | -1,242.76 | 1,261.02 | 0.00 | 0.00 | 0.00 | 0.00 |
| 4,100.00 | 22.95 | 279.76 | 3,851.70 | 220.41 | -1,281.19 | 1,300.01 | 0.00 | 0.00 | 0.00 | 0.00 |
| 4,200.00 | 22.95 | 279.76 | 3,943.79 | 227.02 | -1,319.61 | 1,339.00 | 0.00 | 0.00 | 0.00 | 0.00 |
| 4,300.00 | 22.95 | 279.76 | 4,035.87 | 233.63 | -1,358.04 | 1,377.99 | 0.00 | 0.00 | 0.00 | 0.00 |
| 4,400.00 | 22.95 | 279.76 | 4,127.96 | 240.24 | -1,396.47 | 1,416.98 | 0.00 | 0.00 | 0.00 | 0.00 |
| 4,500.00 | 22.95 | 279.76 | 4,220.04 | 246.85 | -1,434.89 | 1,455.97 | 0.00 | 0.00 | 0.00 | 0.00 |
| 4,600.00 | 22.95 | 279.76 | 4,312.13 | 253.47 | -1,473.32 | 1,494.97 | 0.00 | 0.00 | 0.00 | 0.00 |
| 4,700.00 | 22.95 | 279.76 | 4,404.21 | 260.08 | -1,511.75 | 1,533.96 | 0.00 | 0.00 | 0.00 | 0.00 |
| 4,800.00 | 22.95 | 279.76 | 4,496.30 | 266.69 | -1,550.18 | 1,572.95 | 0.00 | 0.00 | 0.00 | 0.00 |
| 4,900.00 | 22.95 | 279.76 | 4,588.38 | 273.30 | -1,588.60 | 1,611.94 | 0.00 | 0.00 | 0.00 | 0.00 |
| 5,000.00 | 22.95 | 279.76 | 4,680.47 | 279.91 | -1,627.03 | 1,650.93 | 0.00 | 0.00 | 0.00 | 0.00 |

Scientific Drilling International

Planning Report

| | | | |
|------------------|---------------------------|-------------------------------------|--------------------------------------|
| Database: | EDM-RexH-Local | Local Co-ordinate Reference: | Well CC 697-05-63A - Slot N |
| Company: | OXY USA RMAT | TVD Reference: | GL 8629' & RKB 30' @ 8659.00ft (H&P) |
| Project: | Garfield County, CO NAD27 | MD Reference: | GL 8629' & RKB 30' @ 8659.00ft (H&P) |
| Site: | Cascade Creek 697-04D Pad | North Reference: | True |
| Well: | CC 697-05-63A | Survey Calculation Method: | Minimum Curvature |
| Wellbore: | OH | | |
| Design: | Plan #1 | | |

| Planned Survey | | | | | | | | | | |
|---|-----------------|-------------|---------------------|------------|------------|-----------------------|-----------------------|----------------------|---------------------|--|
| Measured Depth (ft) | Inclination (°) | Azimuth (°) | Vertical Depth (ft) | +N/-S (ft) | +E/-W (ft) | Vertical Section (ft) | Dogleg Rate (°/100ft) | Build Rate (°/100ft) | Turn Rate (°/100ft) | |
| 5,100.00 | 22.95 | 279.76 | 4,772.55 | 286.52 | -1,665.46 | 1,689.92 | 0.00 | 0.00 | 0.00 | |
| 5,200.00 | 22.95 | 279.76 | 4,864.64 | 293.13 | -1,703.89 | 1,728.92 | 0.00 | 0.00 | 0.00 | |
| 5,300.00 | 22.95 | 279.76 | 4,956.72 | 299.74 | -1,742.31 | 1,767.91 | 0.00 | 0.00 | 0.00 | |
| 5,392.58 | 22.95 | 279.76 | 5,041.97 | 305.86 | -1,777.89 | 1,804.01 | 0.00 | 0.00 | 0.00 | |
| Start Drop -2.00 | | | | | | | | | | |
| 5,400.00 | 22.80 | 279.76 | 5,048.81 | 306.35 | -1,780.73 | 1,806.89 | 2.00 | -2.00 | 0.00 | |
| 5,500.00 | 20.80 | 279.76 | 5,141.65 | 312.65 | -1,817.33 | 1,844.03 | 2.00 | -2.00 | 0.00 | |
| 5,600.00 | 18.80 | 279.76 | 5,235.74 | 318.39 | -1,850.71 | 1,877.90 | 2.00 | -2.00 | 0.00 | |
| 5,700.00 | 16.80 | 279.76 | 5,330.94 | 323.57 | -1,880.84 | 1,908.47 | 2.00 | -2.00 | 0.00 | |
| 5,800.00 | 14.80 | 279.76 | 5,427.16 | 328.19 | -1,907.67 | 1,935.70 | 2.00 | -2.00 | 0.00 | |
| 5,900.00 | 12.80 | 279.76 | 5,524.27 | 332.23 | -1,931.18 | 1,959.55 | 2.00 | -2.00 | 0.00 | |
| 6,000.00 | 10.80 | 279.76 | 5,622.15 | 335.70 | -1,951.34 | 1,980.00 | 2.00 | -2.00 | 0.00 | |
| 6,100.00 | 8.80 | 279.76 | 5,720.68 | 338.59 | -1,968.11 | 1,997.02 | 2.00 | -2.00 | 0.00 | |
| 6,200.00 | 6.80 | 279.76 | 5,819.75 | 340.89 | -1,981.49 | 2,010.60 | 2.00 | -2.00 | 0.00 | |
| 6,300.00 | 4.80 | 279.76 | 5,919.24 | 342.60 | -1,991.45 | 2,020.70 | 2.00 | -2.00 | 0.00 | |
| 6,400.00 | 2.80 | 279.76 | 6,019.01 | 343.73 | -1,997.98 | 2,027.33 | 2.00 | -2.00 | 0.00 | |
| 6,500.00 | 0.80 | 279.76 | 6,118.96 | 344.26 | -2,001.08 | 2,030.47 | 2.00 | -2.00 | 0.00 | |
| 6,540.04 | 0.00 | 0.00 | 6,159.00 | 344.31 | -2,001.35 | 2,030.75 | 2.00 | -2.00 | 200.38 | |
| Start 0.00° Hold At 6540.04' - Mesaverde | | | | | | | | | | |
| 6,600.00 | 0.00 | 0.00 | 6,218.96 | 344.31 | -2,001.35 | 2,030.75 | 0.00 | 0.00 | 0.00 | |
| 6,700.00 | 0.00 | 0.00 | 6,318.96 | 344.31 | -2,001.35 | 2,030.75 | 0.00 | 0.00 | 0.00 | |
| 6,700.04 | 0.00 | 0.00 | 6,319.00 | 344.31 | -2,001.35 | 2,030.75 | 0.00 | 0.00 | 0.00 | |
| Base Ohio Creek | | | | | | | | | | |
| 6,800.00 | 0.00 | 0.00 | 6,418.96 | 344.31 | -2,001.35 | 2,030.75 | 0.00 | 0.00 | 0.00 | |
| 6,900.00 | 0.00 | 0.00 | 6,518.96 | 344.31 | -2,001.35 | 2,030.75 | 0.00 | 0.00 | 0.00 | |
| 7,000.00 | 0.00 | 0.00 | 6,618.96 | 344.31 | -2,001.35 | 2,030.75 | 0.00 | 0.00 | 0.00 | |
| 7,100.00 | 0.00 | 0.00 | 6,718.96 | 344.31 | -2,001.35 | 2,030.75 | 0.00 | 0.00 | 0.00 | |
| 7,200.00 | 0.00 | 0.00 | 6,818.96 | 344.31 | -2,001.35 | 2,030.75 | 0.00 | 0.00 | 0.00 | |
| 7,290.04 | 0.00 | 0.00 | 6,909.00 | 344.31 | -2,001.35 | 2,030.75 | 0.00 | 0.00 | 0.00 | |
| TOG = 636740.39, 1228400.73 | | | | | | | | | | |
| 7,300.00 | 0.00 | 0.00 | 6,918.96 | 344.31 | -2,001.35 | 2,030.75 | 0.00 | 0.00 | 0.00 | |
| 7,400.00 | 0.00 | 0.00 | 7,018.96 | 344.31 | -2,001.35 | 2,030.75 | 0.00 | 0.00 | 0.00 | |
| 7,500.00 | 0.00 | 0.00 | 7,118.96 | 344.31 | -2,001.35 | 2,030.75 | 0.00 | 0.00 | 0.00 | |
| 7,600.00 | 0.00 | 0.00 | 7,218.96 | 344.31 | -2,001.35 | 2,030.75 | 0.00 | 0.00 | 0.00 | |
| 7,700.00 | 0.00 | 0.00 | 7,318.96 | 344.31 | -2,001.35 | 2,030.75 | 0.00 | 0.00 | 0.00 | |
| 7,800.00 | 0.00 | 0.00 | 7,418.96 | 344.31 | -2,001.35 | 2,030.75 | 0.00 | 0.00 | 0.00 | |
| 7,900.00 | 0.00 | 0.00 | 7,518.96 | 344.31 | -2,001.35 | 2,030.75 | 0.00 | 0.00 | 0.00 | |
| 8,000.00 | 0.00 | 0.00 | 7,618.96 | 344.31 | -2,001.35 | 2,030.75 | 0.00 | 0.00 | 0.00 | |
| 8,100.00 | 0.00 | 0.00 | 7,718.96 | 344.31 | -2,001.35 | 2,030.75 | 0.00 | 0.00 | 0.00 | |
| 8,200.00 | 0.00 | 0.00 | 7,818.96 | 344.31 | -2,001.35 | 2,030.75 | 0.00 | 0.00 | 0.00 | |
| 8,300.00 | 0.00 | 0.00 | 7,918.96 | 344.31 | -2,001.35 | 2,030.75 | 0.00 | 0.00 | 0.00 | |
| 8,400.00 | 0.00 | 0.00 | 8,018.96 | 344.31 | -2,001.35 | 2,030.75 | 0.00 | 0.00 | 0.00 | |
| 8,500.00 | 0.00 | 0.00 | 8,118.96 | 344.31 | -2,001.35 | 2,030.75 | 0.00 | 0.00 | 0.00 | |
| 8,600.00 | 0.00 | 0.00 | 8,218.96 | 344.31 | -2,001.35 | 2,030.75 | 0.00 | 0.00 | 0.00 | |
| 8,650.04 | 0.00 | 0.00 | 8,269.00 | 344.31 | -2,001.35 | 2,030.75 | 0.00 | 0.00 | 0.00 | |
| Target = 636740.39, 1228400.73 | | | | | | | | | | |
| 8,700.00 | 0.00 | 0.00 | 8,318.96 | 344.31 | -2,001.35 | 2,030.75 | 0.00 | 0.00 | 0.00 | |
| 8,800.00 | 0.00 | 0.00 | 8,418.96 | 344.31 | -2,001.35 | 2,030.75 | 0.00 | 0.00 | 0.00 | |
| 8,900.00 | 0.00 | 0.00 | 8,518.96 | 344.31 | -2,001.35 | 2,030.75 | 0.00 | 0.00 | 0.00 | |
| 9,000.00 | 0.00 | 0.00 | 8,618.96 | 344.31 | -2,001.35 | 2,030.75 | 0.00 | 0.00 | 0.00 | |
| 9,100.00 | 0.00 | 0.00 | 8,718.96 | 344.31 | -2,001.35 | 2,030.75 | 0.00 | 0.00 | 0.00 | |
| 9,200.00 | 0.00 | 0.00 | 8,818.96 | 344.31 | -2,001.35 | 2,030.75 | 0.00 | 0.00 | 0.00 | |
| 9,300.00 | 0.00 | 0.00 | 8,918.96 | 344.31 | -2,001.35 | 2,030.75 | 0.00 | 0.00 | 0.00 | |

Scientific Drilling International

Planning Report

| | | | |
|------------------|---------------------------|-------------------------------------|--------------------------------------|
| Database: | EDM-RexH-Local | Local Co-ordinate Reference: | Well CC 697-05-63A - Slot N |
| Company: | OXY USA RMAT | TVD Reference: | GL 8629' & RKB 30' @ 8659.00ft (H&P) |
| Project: | Garfield County, CO NAD27 | MD Reference: | GL 8629' & RKB 30' @ 8659.00ft (H&P) |
| Site: | Cascade Creek 697-04D Pad | North Reference: | True |
| Well: | CC 697-05-63A | Survey Calculation Method: | Minimum Curvature |
| Wellbore: | OH | | |
| Design: | Plan #1 | | |

| Planned Survey | | | | | | | | | |
|-------------------------------------|-----------------|-------------|---------------------|------------|------------|-----------------------|-----------------------|----------------------|---------------------|
| Measured Depth (ft) | Inclination (°) | Azimuth (°) | Vertical Depth (ft) | +N/-S (ft) | +E/-W (ft) | Vertical Section (ft) | Dogleg Rate (°/100ft) | Build Rate (°/100ft) | Turn Rate (°/100ft) |
| 9,300.04 | 0.00 | 0.00 | 8,919.00 | 344.31 | -2,001.35 | 2,030.75 | 0.00 | 0.00 | 0.00 |
| Rollins | | | | | | | | | |
| 9,400.00 | 0.00 | 0.00 | 9,018.96 | 344.31 | -2,001.35 | 2,030.75 | 0.00 | 0.00 | 0.00 |
| 9,500.00 | 0.00 | 0.00 | 9,118.96 | 344.31 | -2,001.35 | 2,030.75 | 0.00 | 0.00 | 0.00 |
| 9,600.00 | 0.00 | 0.00 | 9,218.96 | 344.31 | -2,001.35 | 2,030.75 | 0.00 | 0.00 | 0.00 |
| 9,700.00 | 0.00 | 0.00 | 9,318.96 | 344.31 | -2,001.35 | 2,030.75 | 0.00 | 0.00 | 0.00 |
| 9,700.04 | 0.00 | 0.00 | 9,319.00 | 344.31 | -2,001.35 | 2,030.75 | 0.00 | 0.00 | 0.00 |
| PBHL = 636740.39, 1228400.73 | | | | | | | | | |

| Design Targets | | | | | | | | | |
|--|---------------|--------------|----------|------------|------------|-----------------|----------------|------------------|-------------------|
| Target Name - hit/miss target - Shape | Dip Angle (°) | Dip Dir. (°) | TVD (ft) | +N/-S (ft) | +E/-W (ft) | Northing (usft) | Easting (usft) | Latitude | Longitude |
| CC 697-05-63A Target - plan hits target center - Circle (radius 50.00) | 0.00 | 0.00 | 8,269.00 | 344.31 | -2,001.35 | 636,740.40 | 1,228,400.73 | 39° 32' 59.154 N | 108° 14' 11.965 W |

| Formations | | | | | | |
|---------------------|---------------------|-----------------|-----------|---------|-------------------|--|
| Measured Depth (ft) | Vertical Depth (ft) | Name | Lithology | Dip (°) | Dip Direction (°) | |
| 6,540.04 | 6,159.00 | Mesaverde | | 0.00 | | |
| 6,700.04 | 6,319.00 | Base Ohio Creek | | 0.00 | | |
| 9,300.04 | 8,919.00 | Rollins | | 0.00 | | |

| Plan Annotations | | | | |
|---------------------|---------------------|------------|------------|--------------------------------|
| Measured Depth (ft) | Vertical Depth (ft) | +N/-S (ft) | +E/-W (ft) | Comment |
| 200.00 | 200.00 | 0.00 | 0.00 | Start Build 2.00 |
| 1,347.47 | 1,317.03 | 38.44 | -223.47 | Start 22.95° Hold At 1347.47' |
| 5,392.58 | 5,041.97 | 305.86 | -1,777.89 | Start Drop -2.00 |
| 6,540.04 | 6,159.00 | 344.31 | -2,001.35 | Start 0.00° Hold At 6540.04' |
| 7,290.04 | 6,909.00 | 344.31 | -2,001.35 | TOG = 636740.39, 1228400.73 |
| 8,650.04 | 8,269.00 | 344.31 | -2,001.35 | Target = 636740.39, 1228400.73 |
| 9,700.04 | 9,319.00 | 344.31 | -2,001.35 | PBHL = 636740.39, 1228400.73 |