

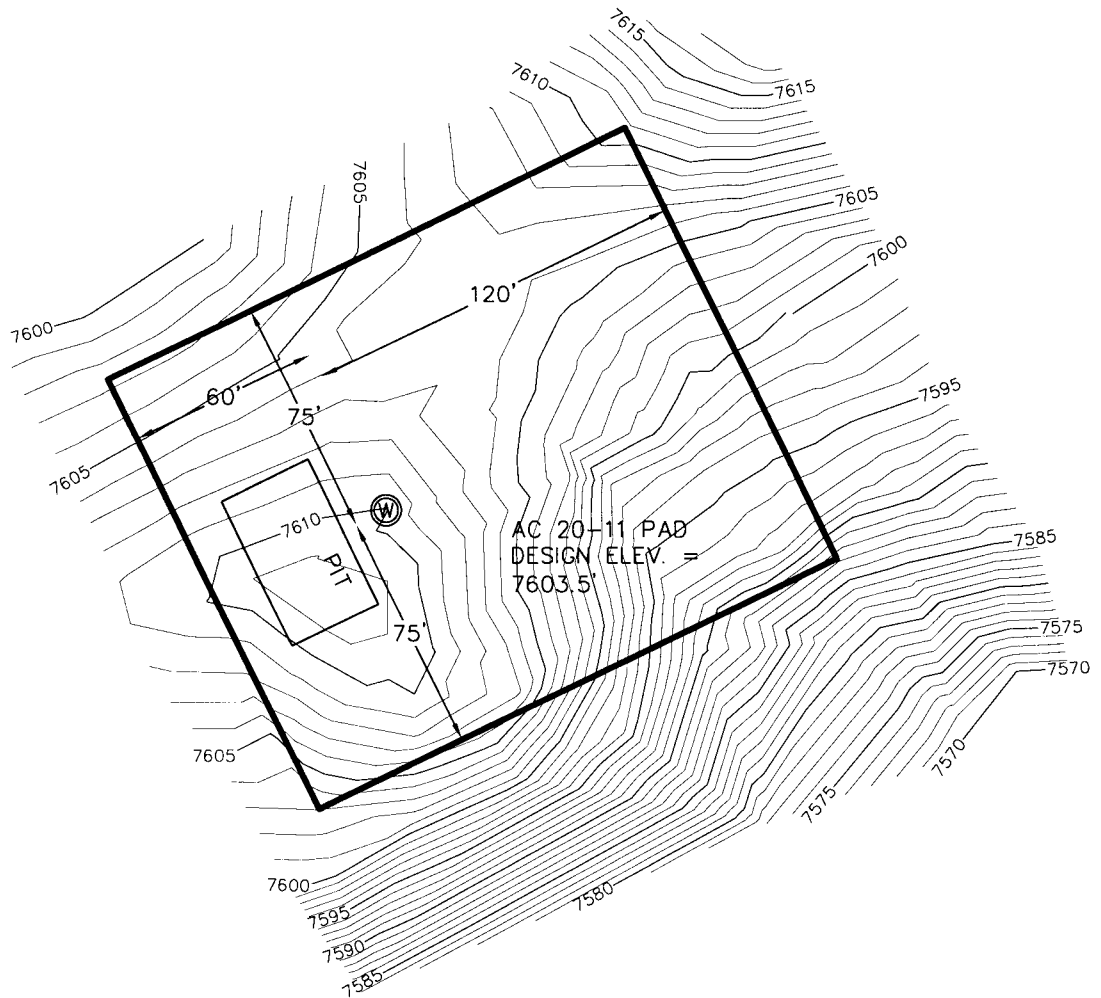

SCALE: 1" = 60'

CONSTRUCTION LAYOUT DRAWING

AC 20-11



NOTES:

1. UNGRADED ELEVATION AT WELLHEAD: 7610'
2. GRADED ELEVATION AT WELLHEAD: 7603.5'



DRAWN BY: NLE
DATE: 02/02/2011
AC 20-11 - CONST
DRAWING NAME:

APACHE CANYON 20-11
WELL PAD PLAN
XTO ENERGY INC.
LAS ANIMAS COUNTY, COLORADO

PAGE
1/4
REV
A



SCALE: 1" = 60'

CONSTRUCTION LAYOUT DRAWING

AC 20-11

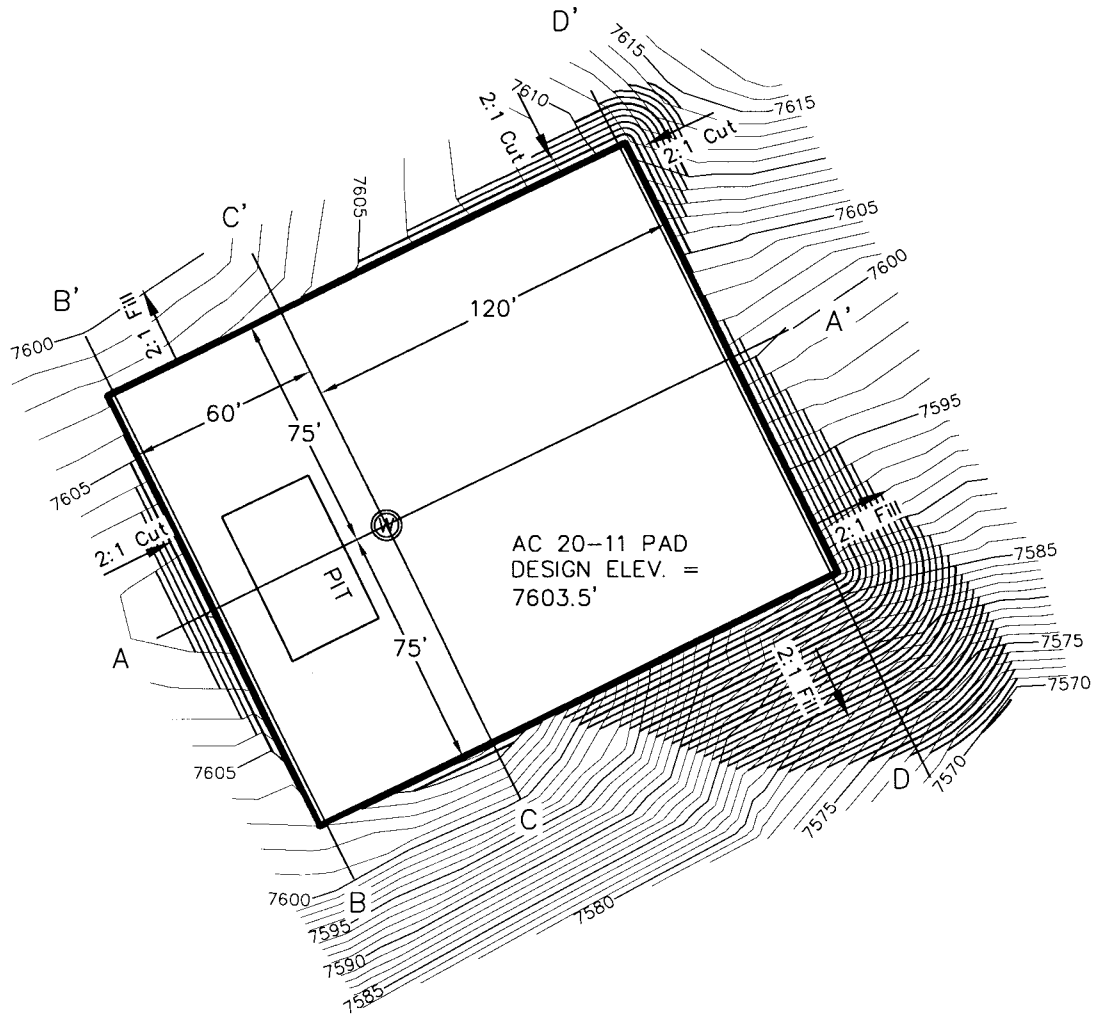

NOTES:

1. UNGRADED ELEVATION AT WELLHEAD: 7610'
2. GRADED ELEVATION AT WELLHEAD: 7603.5'



DRAWN BY: NLE
DATE: 02/02/2011
AC 20-11 -CONST
DRAWING NAME:

APACHE CANYON 20-11
WELL PAD PLAN
XTO ENERGY INC.
LAS ANIMAS COUNTY, COLORADO

PAGE
2/4
REV
A



SCALE: 1" = 60'

CONSTRUCTION LAYOUT DRAWING

AC 20-11

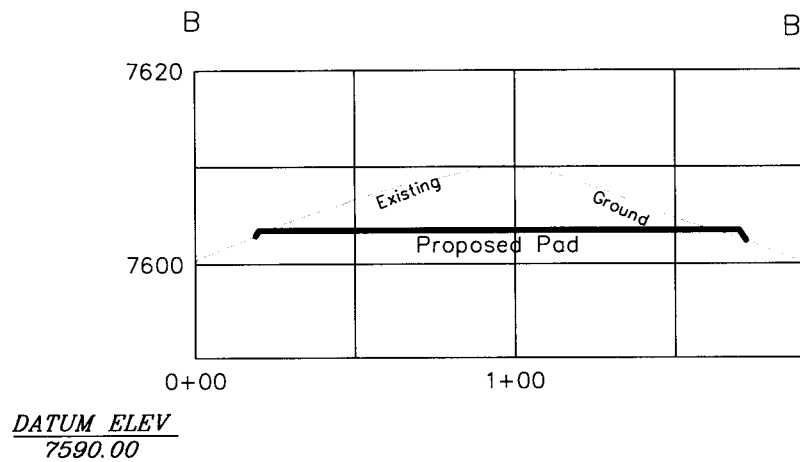
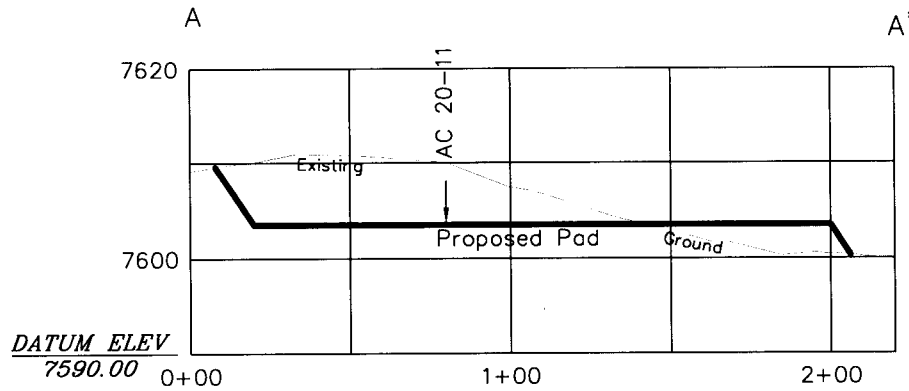

HORIZONTAL SCALE: 1" = 60'
VERTICAL SCALE: 1" = 20'



DRAWN BY: NLE
DATE: 02/02/2011
AC 20-11 -CONST
DRAWING NAME:

APACHE CANYON 20-11
WELL PAD PLAN
XTO ENERGY INC.
LAS ANIMAS COUNTY, COLORADO

PAGE
3/4

REV
A



SCALE: 1" = 60'

CONSTRUCTION LAYOUT DRAWING

AC 20-11

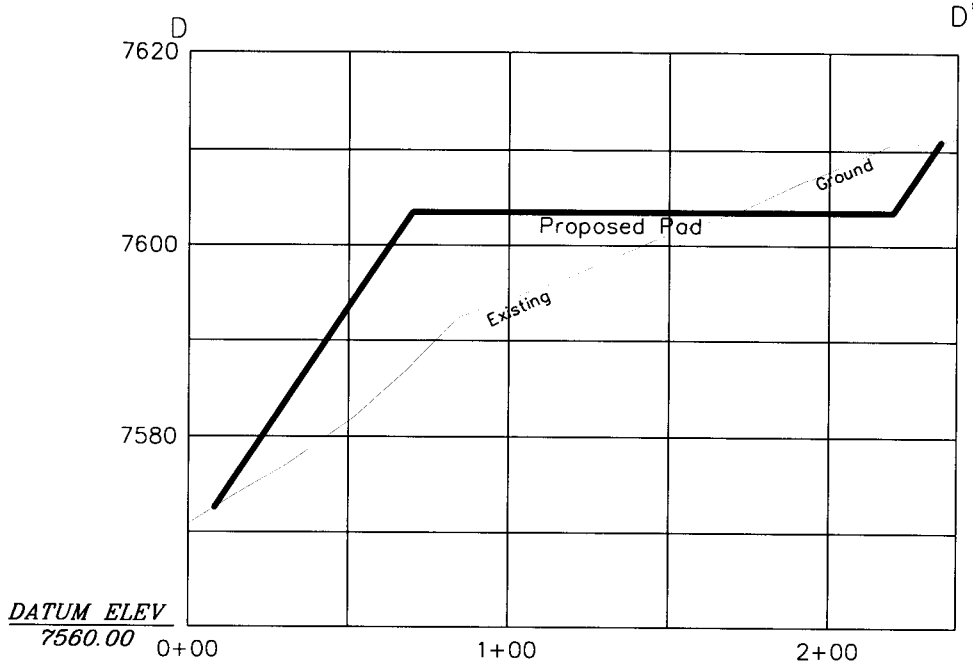
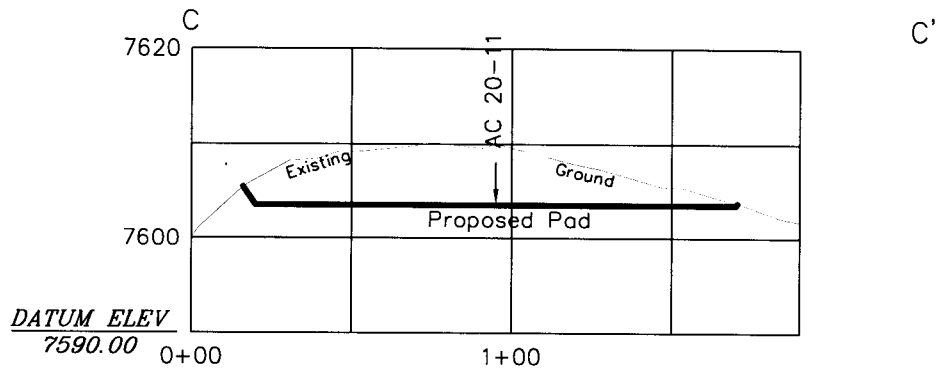

HORIZONTAL SCALE: 1" = 60'
VERTICAL SCALE: 1" = 20'



DRAWN BY: NLE
DATE: 02/02/2011
AC 20-11-CONST
DRAWING NAME:

APACHE CANYON 20-11
WELL PAD PLAN
XTO ENERGY INC.
LAS ANIMAS COUNTY, COLORADO

PAGE
4/4
REV
A