

WILLIAMS PRODUCTION RMT COMPANY

SG 43-27

LOCATED IN GARFIELD COUNTY, COLORADO
SECTION 27, T7S, R96W, 6th P.M.

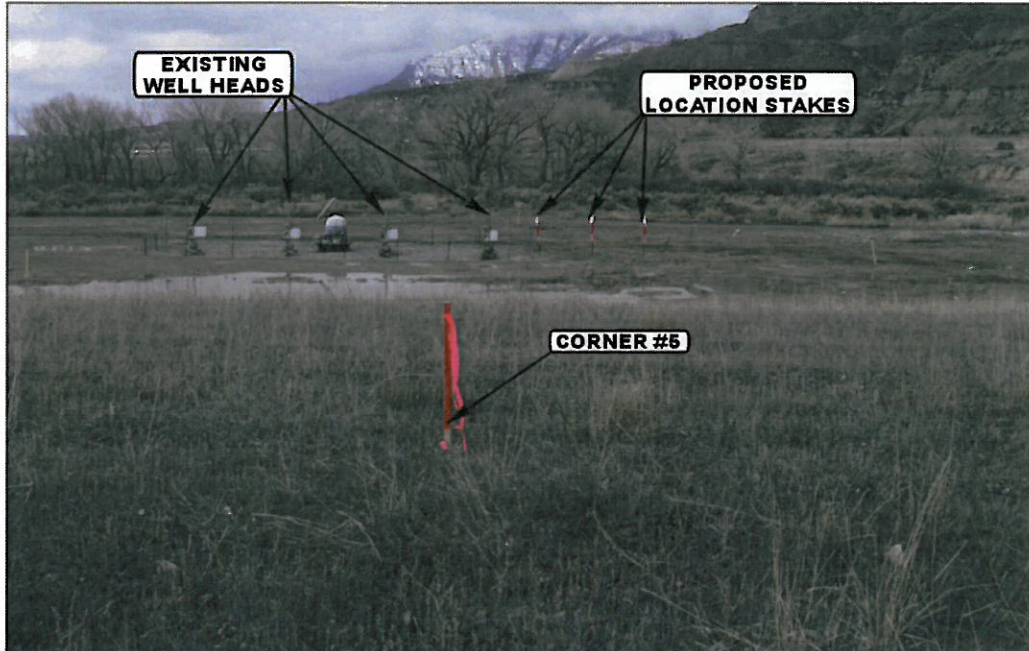

PHOTO: VIEW FROM CORNER #5 TO LOCATION STAKE

CAMERA ANGLE: WESTERLY



PHOTO: VIEW FROM BEGINNING OF PROPOSED ACCESS

CAMERA ANGLE: NORTHERLY



- Since 1964 -

**U
E
L
S**

Uintah Engineering & Land Surveying
85 South 200 East Vernal, Utah 84078
(435) 789-1017 * FAX (435) 789-1813

LOCATION PHOTOS

03 **13** **10**
MONTH DAY YEAR

TAKEN BY: B.H.

DRAWN BY: J.H.

REVISED: 00-00-00

PHOTO

P1

WILLIAMS PRODUCTION RMT COMPANY

SG 43-27

LOCATED IN GARFIELD COUNTY, COLORADO
SECTION 27, T7S, R96W, 6th P.M.



PHOTO: VIEW OF LOCATION STAKES

CAMERA ANGLE: NORTHERLY



PHOTO: VIEW OF LOCATION STAKES

CAMERA ANGLE: EASTERLY



- Since 1964 -

Uintah Engineering & Land Surveying
85 South 200 East Vernal, Utah 84078
(435) 789-1017 * FAX (435) 789-1813

LOCATION PHOTOS

03 13 10
MONTH DAY YEAR

PHOTO

P2

TAKEN BY: B.H.

DRAWN BY: J.H.

REVISED: 00-00-00

WILLIAMS PRODUCTION RMT COMPANY

SG 43-27

LOCATED IN GARFIELD COUNTY, COLORADO

SECTION 27, T7S, R96W, 6th P.M.



PHOTO: VIEW OF LOCATION STAKES

CAMERA ANGLE: SOUTHERLY



PHOTO: VIEW OF LOCATION STAKES

CAMERA ANGLE: WESTERLY



**U
E
L
S**

Uintah Engineering & Land Surveying
85 South 200 East Vernal, Utah 84078
(435) 789-1017 * FAX (435) 789-1813

LOCATION PHOTOS

03 13 10
MONTH DAY YEAR

PHOTO

P3

TAKEN BY: B.H.

DRAWN BY: J.H.

REVISED: 00-00-00