

Steil Surveying Services, LLC

1102 West 19th Street P.O. BOX 2073

Cheyenne, Wyoming 82001

# LOCATION DRAWING

DATE: 01/07/2011

THIS MAP DOES NOT REPRESENT A BOUNDARY SURVEY

SECTION 16  
TOWNSHIP 6 NORTH  
RANGE 63 WEST

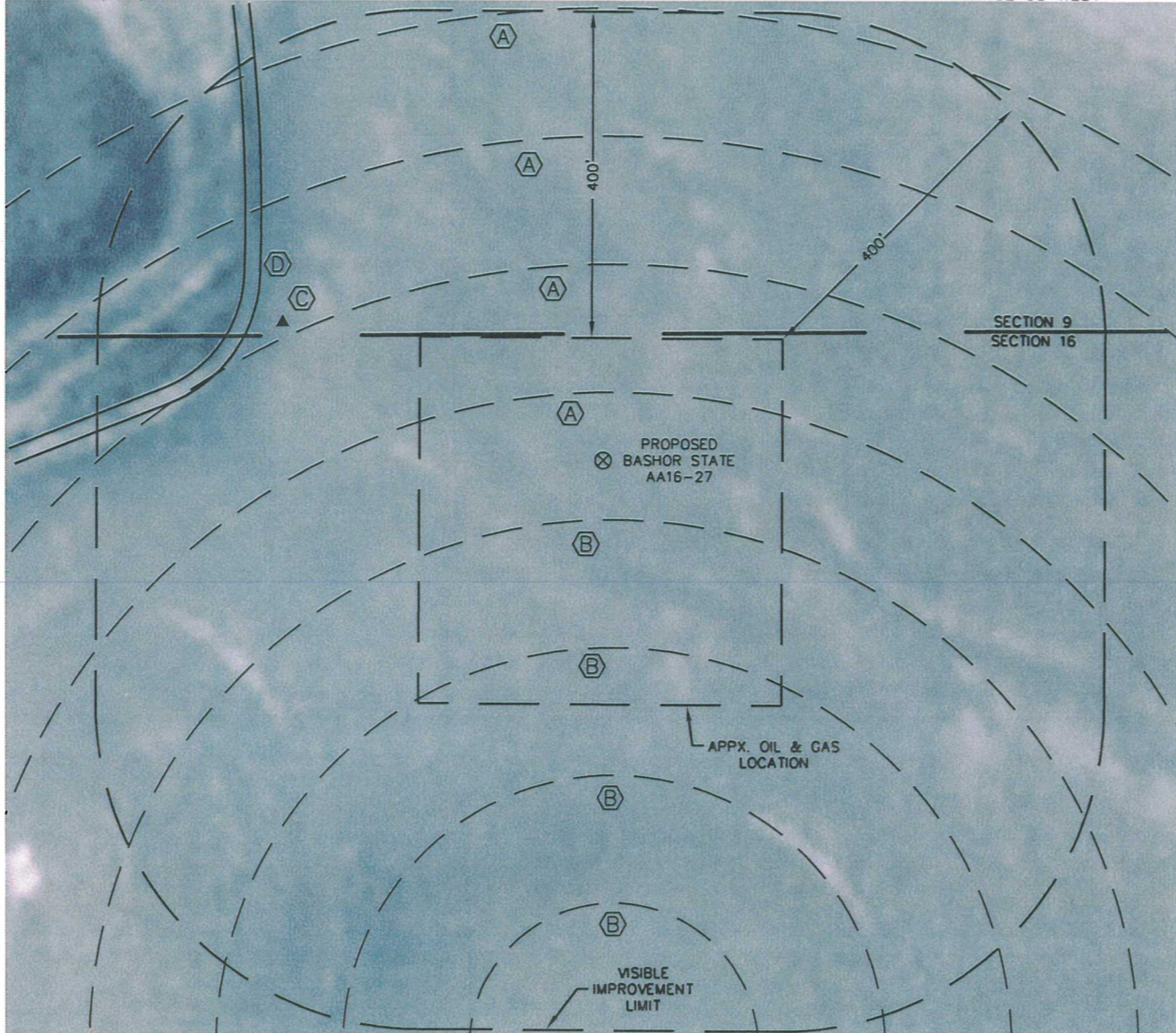

## IMPROVEMENTS:

- (A) IRRIGATION WHEEL TRACKS - 83', 240', 397' & 555' NORTH
- (B) IRRIGATION WHEEL TRACKS - 73', 230', 387' & 544' SOUTH
- (C) IRRIGATION WELL - 432' NORTHWEST
- (D) DIRT ROAD - 450' +/- NORTHWEST

THE NEAREST OVERHEAD POWER LINE IS 1263' WEST.

NOTE: The orientation of the oil & gas location as shown was determined by Noble Energy.

NOTICE: According to Colorado law you MUST commence any legal action based upon any defect in this W.L.C. within three years after you first discover such defect. In no event may any action based upon any defect in this W.L.C. be commenced more than ten years from this sold date of the certification shown hereon.

## NEW WELL DATA

ELEV = 4691', PDOP: 1.8

NW¼NE¼ SEC 16

155' FNL, 1330' FEL

LAT: N 40.49348

LONG: W 104.43730

NEAREST PROP LINE: 155' NORTH

NEAREST RAILROAD: MORE THAN ONE MILE AWAY

NEAREST BUILDING: 1670' NORTHEAST

GRAVEL COUNTY ROAD NO. 67: 1300' EAST



0 200

Scale: 1" = 200'