

Hydrology Map

CALVARY 18-33 FACILITY

NW¼ SE¼ SECTION 18, TOWNSHIP 7 NORTH, RANGE 65 WEST OF THE 6TH PRINCIPAL MERIDIAN

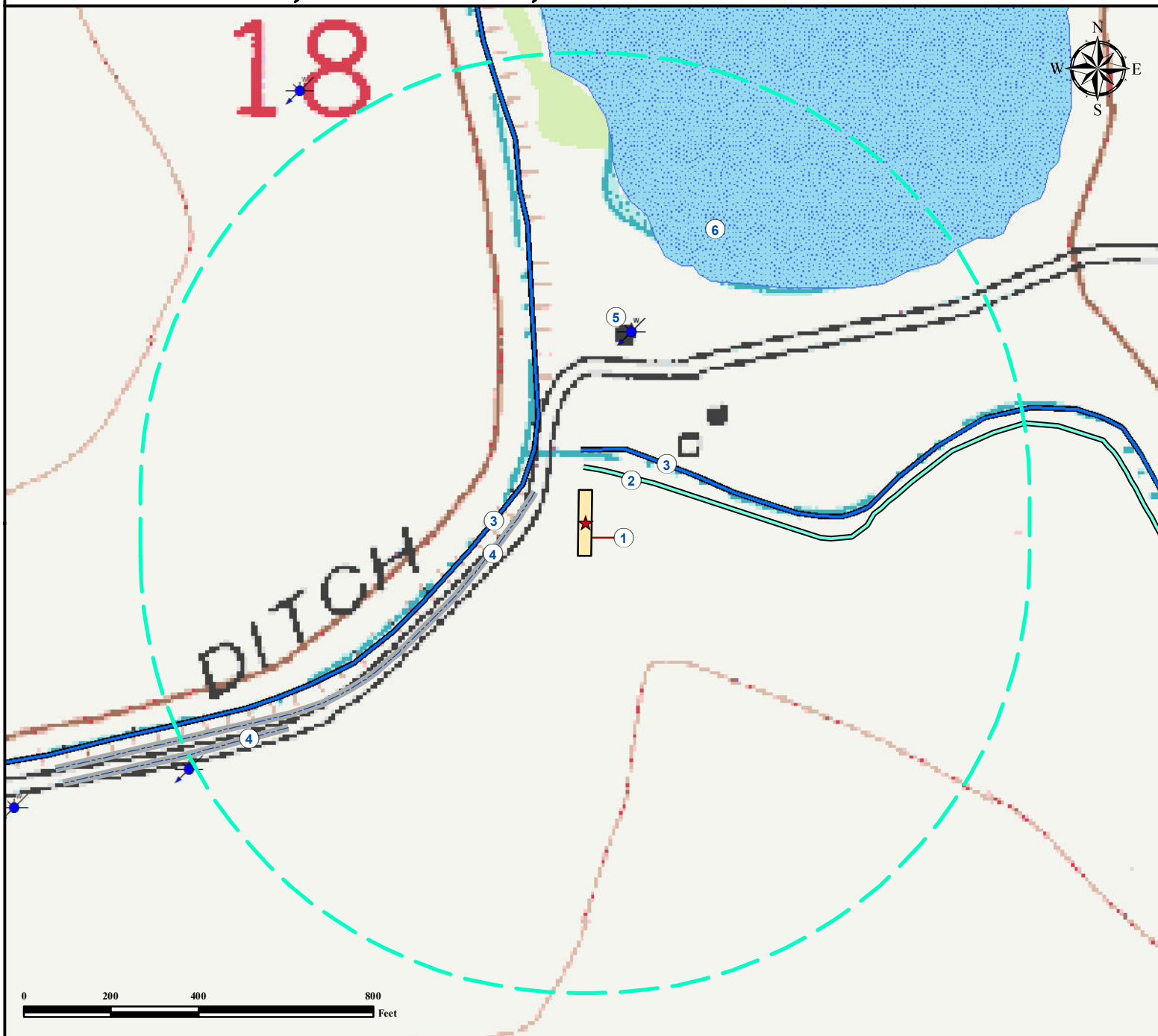

1. Proposed CALVARY 18-33 FACILITY.

2. Dirt Ditch is $\pm 126'$ N.

3. Canals are $\pm 166'$ N and $\pm 168'$ NW

4. Concrete ditches are $\pm 134'$ NW and $\pm 822'$ SW.

5. Water well (#274495) is $\pm 449'$ NE.
Feature not in this location per field verify.

6. Lake is $\pm 622'$ NE.

Legend

★ Reference Point

Concrete Ditch

Dirt Ditch

Water Well

Lake

Canal

Proposed Facility

1000' Radius

Reference Location

** All Measurements are Made from Reference Point **

Lat: 40.572522° Long: -104.703795° (NAD 83)
Elevation: 4896 Feet



Use our resources to find yours!
www.petro-fs.com
(303) 928-7128

Field Date: 03/16/2011
Drafting Date: 03/30/2011
Drafter: DMM
Checked By: BHF

Data Sources:

- Aerial courtesy of NAIP (2009)
- Water wells courtesy CDOWR

Prepared for: ORR ENERGY LLC

