

**EOG RESOURCES, INC.**  
**DUTCH LAKE #08-10H**  
LOCATED IN WELD COUNTY, COLORADO  
SECTION 10, T6N, R62W, 6th P.M.

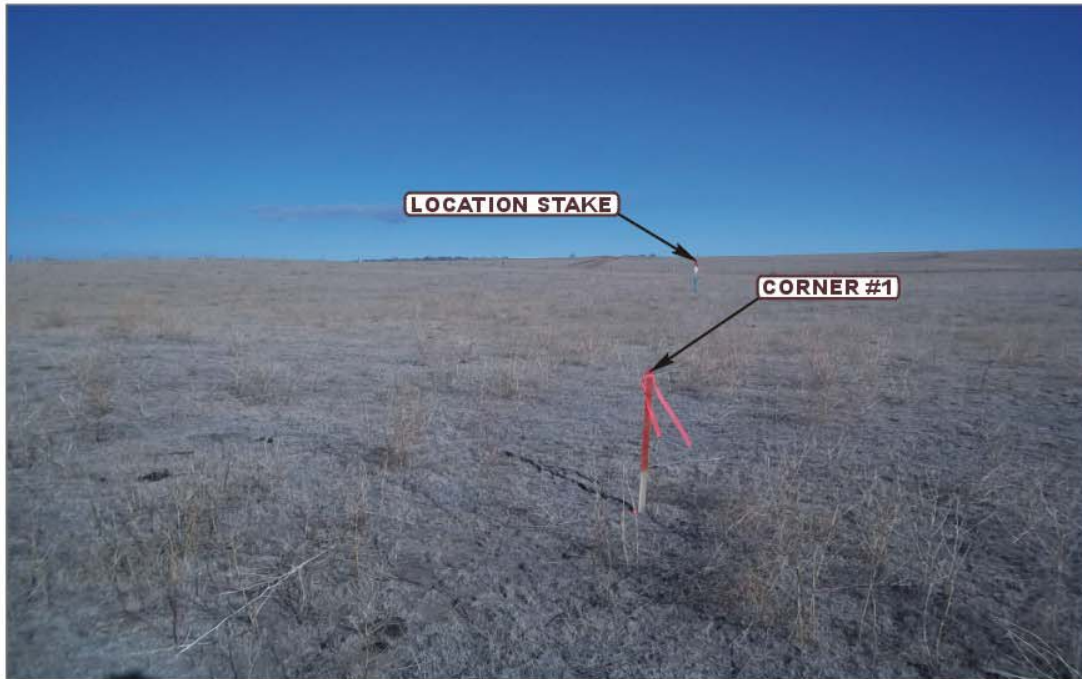

PHOTO: VIEW FROM CORNER #1 TO LOCATION STAKE

CAMERA ANGLE: NORTHERLY



PHOTO: VIEW FROM BEGINNING OF PROPOSED ACCESS

CAMERA ANGLE: SOUTHWESTERLY



- Since 1964 -



Uintah Engineering & Land Surveying  
85 South 200 East Vernal, Utah 84078  
(435) 789-1017 \* FAX (435) 789-1813

LOCATION PHOTOS

02 04 11  
MONTH DAY YEAR

PHOTO  
P1

TAKEN BY: R.P.

DRAWN BY: S.F.

REVISED: 00-00-00

**EOG RESOURCES, INC.**  
**DUTCH LAKE #08-10H**  
**LOCATED IN WELD COUNTY, COLORADO**  
**SECTION 10, T6N, R62W, 6th P.M.**

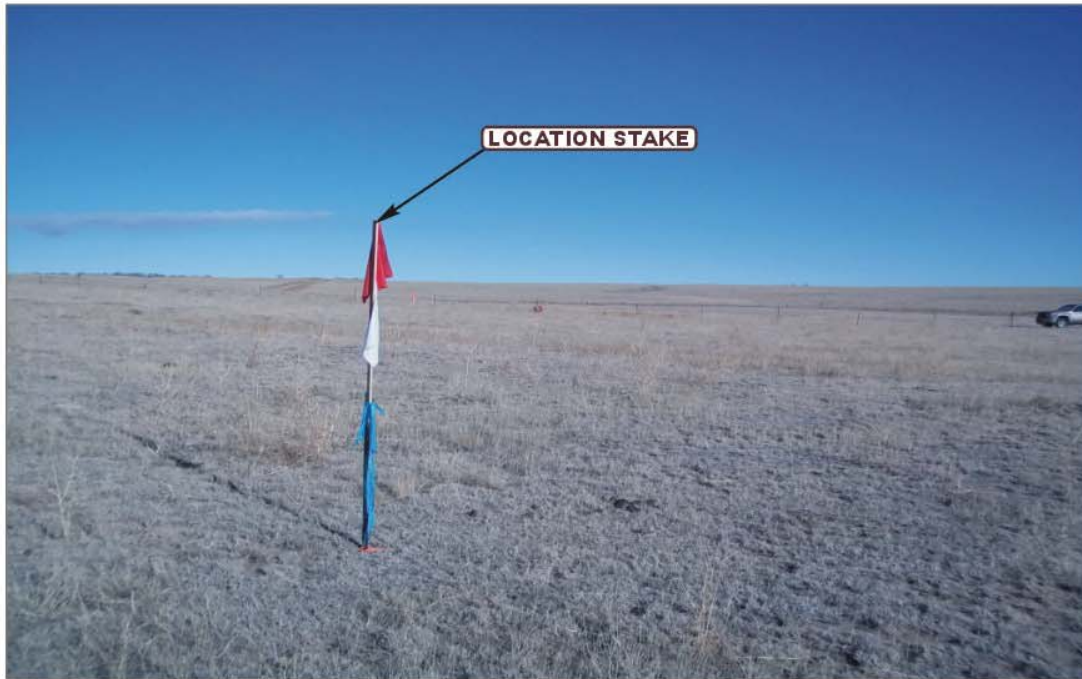

PHOTO: VIEW OF LOCATION STAKE

CAMERA ANGLE: NORTHERLY



PHOTO: VIEW OF LOCATION STAKE

CAMERA ANGLE: EASTERLY



- Since 1964 -



Uintah Engineering & Land Surveying  
85 South 200 East Vernal, Utah 84078  
(435) 789-1017 \* FAX (435) 789-1813

**LOCATION PHOTOS**

**02** **04** **11**  
MONTH DAY YEAR

TAKEN BY: R.P.

DRAWN BY: S.F.

REVISED: 00-00-00

PHOTO  
**P2**



**EOG RESOURCES, INC.**  
**DUTCH LAKE #08-10H**  
**LOCATED IN WELD COUNTY, COLORADO**  
**SECTION 10, T6N, R62W, 6th P.M.**



PHOTO: VIEW OF LOCATION STAKE

CAMERA ANGLE: SOUTHERLY



PHOTO: VIEW OF LOCATION STAKE

CAMERA ANGLE: WESTERLY



- Since 1964 -



Uintah Engineering & Land Surveying  
85 South 200 East Vernal, Utah 84078  
(435) 789-1017 \* FAX (435) 789-1813

**LOCATION PHOTOS**

**02** **04** **11**  
MONTH DAY YEAR

PHOTO  
**P3**

TAKEN BY: R.P.

DRAWN BY: S.F.

REVISED: 00-00-00