

EOG RESOURCES, INC.
HORSE DITCH #05-10H
 LOCATED IN WELD COUNTY, COLORADO
 SECTION 10, T8N, R59W, 6th P.M.

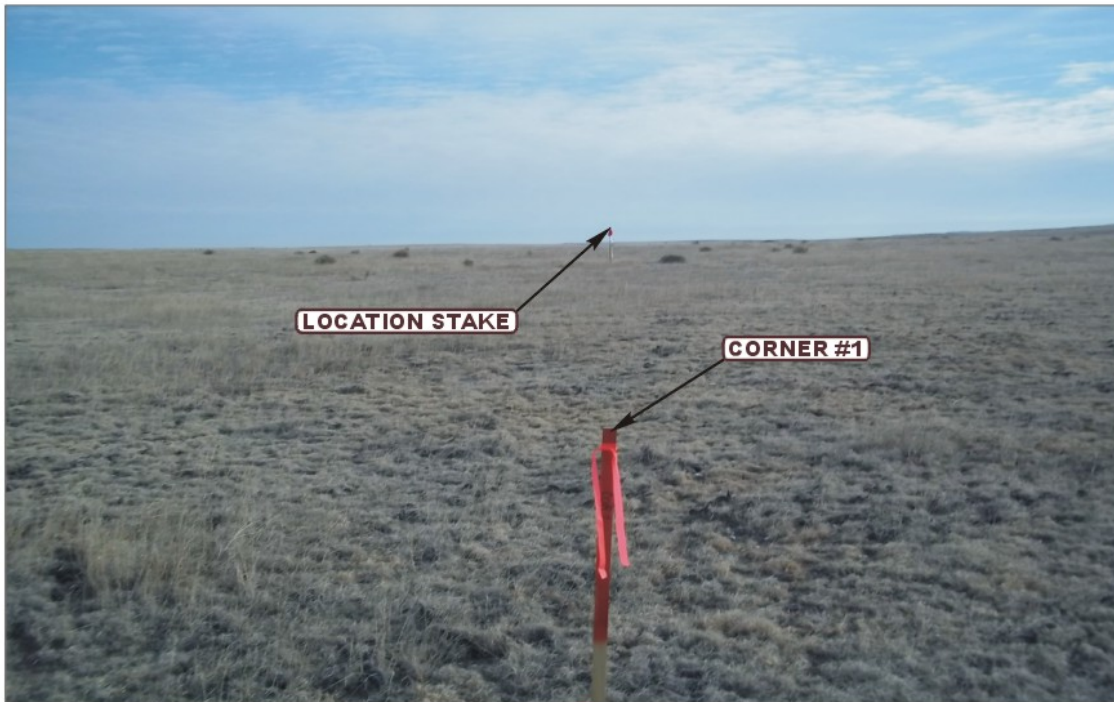

PHOTO: VIEW FROM CORNER #1 TO LOCATION STAKE

CAMERA ANGLE: EASTERLY



PHOTO: VIEW FROM BEGINNING OF PROPOSED ACCESS

CAMERA ANGLE: EASTERLY



UELS Uintah Engineering & Land Surveying
 85 South 200 East Vernal, Utah 84078
 (435) 789-1017 * FAX (435) 789-1813

| | | | | | | |
|------------------------|----------------|-------------------|-----------|-----------|-----------|---------------------|
| LOCATION PHOTOS | | | 01 | 21 | 11 | PHOTO P1 |
| | | | MONTH | DAY | YEAR | |
| TAKEN BY: R.P. | DRAWN BY: S.F. | REVISED: 00-00-00 | | | | |

EOG RESOURCES, INC.
HORSE DITCH #05-10H
 LOCATED IN WELD COUNTY, COLORADO
 SECTION 10, T8N, R59W, 6th P.M.



PHOTO: VIEW OF LOCATION STAKE

CAMERA ANGLE: NORTHERLY



PHOTO: VIEW OF LOCATION STAKE

CAMERA ANGLE: EASTERLY



UELS Uintah Engineering & Land Surveying
 85 South 200 East Vernal, Utah 84078
 (435) 789-1017 * FAX (435) 789-1813

| | | | | | | |
|------------------------|----------------|-------------------|-----------|-----------|-----------|---------------------|
| LOCATION PHOTOS | | | 01 | 21 | 11 | PHOTO P2 |
| | | | MONTH | DAY | YEAR | |
| TAKEN BY: R.P. | DRAWN BY: S.F. | REVISED: 00-00-00 | | | | |

EOG RESOURCES, INC.
HORSE DITCH #05-10H
 LOCATED IN WELD COUNTY, COLORADO
 SECTION 10, T8N, R59W, 6th P.M.



PHOTO: VIEW OF LOCATION STAKE

CAMERA ANGLE: SOUTHERLY



PHOTO: VIEW OF LOCATION STAKE

CAMERA ANGLE: WESTERLY



UELS Uintah Engineering & Land Surveying
 85 South 200 East Vernal, Utah 84078
 (435) 789-1017 * FAX (435) 789-1813

| | | | | | | |
|------------------------|----------------|-------------------|-----------|-----------|-----------|---------------------|
| LOCATION PHOTOS | | | 01 | 21 | 11 | PHOTO P3 |
| | | | MONTH | DAY | YEAR | |
| TAKEN BY: R.P. | DRAWN BY: S.F. | REVISED: 00-00-00 | | | | |