

EOG RESOURCES, INC.
ELK CREEK #13-21H
LOCATED IN WELD COUNTY, COLORADO
SECTION 21, T10N, R62W, 6th P.M.

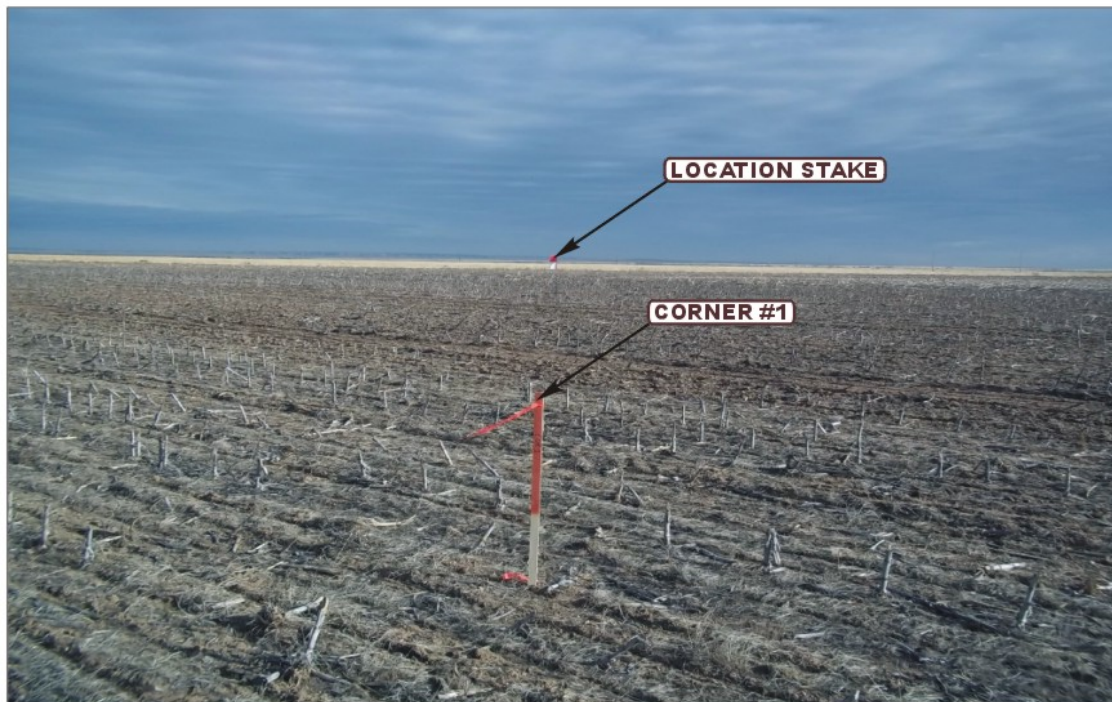

PHOTO: VIEW FROM CORNER #1 TO LOCATION STAKE

CAMERA ANGLE: EASTERLY



PHOTO: VIEW FROM BEGINNING OF PROPOSED ACCESS

CAMERA ANGLE: NORTHERLY



U E L S Uintah Engineering & Land Surveying
85 South 200 East Vernal, Utah 84078
(435) 789-1017 * FAX (435) 789-1813

LOCATION PHOTOS

01 14 11
MONTH DAY YEAR

PHOTO
P1

TAKEN BY: R.P.

DRAWN BY: J.J.

REVISED: 00-00-00

EOG RESOURCES, INC.
ELK CREEK #13-21H
LOCATED IN WELD COUNTY, COLORADO
SECTION 21, T10N, R62W, 6th P.M.



PHOTO: VIEW OF LOCATION STAKE

CAMERA ANGLE: NORTHERLY



PHOTO: VIEW OF LOCATION STAKE

CAMERA ANGLE: EASTERLY



UELS Uintah Engineering & Land Surveying
85 South 200 East Vernal, Utah 84078
(435) 789-1017 * FAX (435) 789-1813

LOCATION PHOTOS

01 14 11
MONTH DAY YEAR

PHOTO
P2

TAKEN BY: R.P.

DRAWN BY: J.J.

REVISED: 00-00-00

EOG RESOURCES, INC.
ELK CREEK #13-21H
LOCATED IN WELD COUNTY, COLORADO
SECTION 21, T10N, R62W, 6th P.M.



PHOTO: VIEW OF LOCATION STAKE

CAMERA ANGLE: SOUTHERLY



PHOTO: VIEW OF LOCATION STAKE

CAMERA ANGLE: WESTERLY



UELS Uintah Engineering & Land Surveying
85 South 200 East Vernal, Utah 84078
(435) 789-1017 * FAX (435) 789-1813

LOCATION PHOTOS

01 14 11
MONTH DAY YEAR

PHOTO
P3

TAKEN BY: R.P.

DRAWN BY: J.J.

REVISED: 00-00-00