

Lion Creek 12-05H

Section 5 T11N R64W

Weld County, CO

Surface Location

NAD 1927 (NADCON CONUS) Colorado North 501
 Ground Elevation: 5488.00 RIG @ 5510.00ft (TBD)
 Northing Easting Latitude Longitude
 587875.71 2258823.19 40° 56' 36.089 N 104° 33' 47.470 W

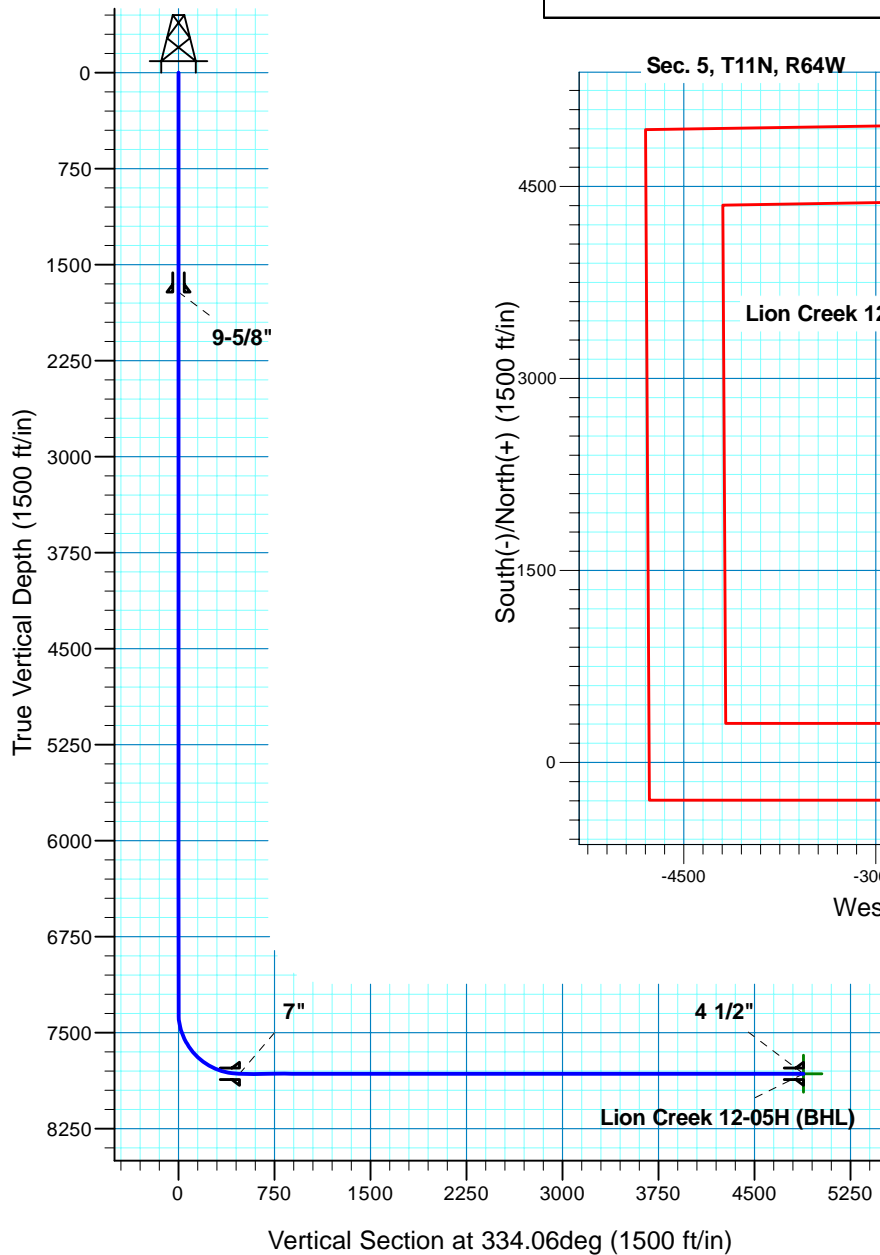

T M
 Azimuths to True North
 Magnetic North: 8.79°
 Magnetic Field
 Strength: 53478.9nT
 Dip Angle: 67.54°
 Date: 3/9/2011
 Model: IGRF200510

Project: DJ - Hereford Ranch
 Site: Lion Creek 12-05H
 Well: Lion Creek 12-05H
 Plan: APD Directional Plan

SECTION DETAILS

Sec	MD	Inc	Azi	TVD	+N/-S	+E/-W	DLeg	TFace	VSec	Target
1	0.00	0.00	0.00	0.00	0.00	0.00	0.00	0.00	0.00	
2	7343.53	0.00	0.00	7343.53	0.00	0.00	0.00	0.00	0.00	
3	8093.54	90.00	334.06	7821.00	429.37	-208.85	12.00	334.06	477.47	
4	12498.44	90.00	334.06	7821.00	4390.54	-2135.58	0.00	0.00	4882.37	Lion Creek 12-05H (BHL)

TARGET DETAILS

Name	TVD	+N/-S	+E/-W	Northing	Easting	Latitude	Longitude	Shape
Lion Creek 12-05H (BHL)	7821.00	4390.54	-2135.58	592243.44	2256641.35	40° 57' 19.469 N	104° 34' 15.301 W	Point

Denver Division- Colorado

DJ - Hereford Ranch

Lion Creek 12-05H

Lion Creek 12-05H

Original Wellbore

Plan: APD Directional Plan

Standard Planning Report

09 March, 2011

EOG Resources Inc

Planning Report

Database:	EDM	Local Co-ordinate Reference:	Site Lion Creek 12-05H
Company:	Denver Division- Colorado	TVD Reference:	RIG @ 5510.00ft (TBD)
Project:	DJ - Hereford Ranch	MD Reference:	RIG @ 5510.00ft (TBD)
Site:	Lion Creek 12-05H	North Reference:	True
Well:	Lion Creek 12-05H	Survey Calculation Method:	Minimum Curvature
Wellbore:	Original Wellbore		
Design:	APD Directional Plan		

Project	DJ - Hereford Ranch, Weld County		
Map System:	US State Plane 1927 (Exact solution)	System Datum:	Mean Sea Level
Geo Datum:	NAD 1927 (NADCON CONUS)		
Map Zone:	Colorado North 501		

Site	Lion Creek 12-05H		
Site Position:		Northing:	587,875.71 ft
From:	Lat/Long	Easting:	2,258,823.19 ft
Position Uncertainty:	0.00 ft	Slot Radius:	"
		Latitude:	40° 56' 36.089 N
		Longitude:	104° 33' 47.470 W
		Grid Convergence:	0.61 deg

Well	Lion Creek 12-05H		
Well Position	+N/-S	0.00 ft	Northing:
	+E/-W	0.00 ft	Easting:
Position Uncertainty	0.00 ft		Wellhead Elevation:
			Latitude:
			Longitude:
			Ground Level:

Wellbore	Original Wellbore				
Magnetics	Model Name	Sample Date	Declination (deg)	Dip Angle (deg)	Field Strength (nT)
	IGRF200510	3/9/2011	8.79	67.54	53,479

Design	APD Directional Plan			
Audit Notes:				
Version:	Phase:	PROTOTYPE	Tie On Depth:	0.00
Vertical Section:	Depth From (TVD) (ft)	+N/-S (ft)	+E/-W (ft)	Direction (deg)
	0.00	0.00	0.00	334.06

Plan Sections										
Measured Depth (ft)	Inclination (deg)	Azimuth (deg)	Vertical Depth (ft)	+N/-S (ft)	+E/-W (ft)	Dogleg Rate (?/100ft)	Build Rate (?/100ft)	Turn Rate (?/100ft)	TFO (deg)	Target
0.00	0.00	0.00	0.00	0.00	0.00	0.00	0.00	0.00	0.00	
7,343.53	0.00	0.00	7,343.53	0.00	0.00	0.00	0.00	0.00	0.00	
8,093.54	90.00	334.06	7,821.00	429.37	-208.85	12.00	12.00	0.00	334.06	
12,498.44	90.00	334.06	7,821.00	4,390.54	-2,135.58	0.00	0.00	0.00	0.00	Lion Creek 12-05H

EOG Resources Inc

Planning Report

Database:	EDM	Local Co-ordinate Reference:	Site Lion Creek 12-05H
Company:	Denver Division- Colorado	TVD Reference:	RIG @ 5510.00ft (TBD)
Project:	DJ - Hereford Ranch	MD Reference:	RIG @ 5510.00ft (TBD)
Site:	Lion Creek 12-05H	North Reference:	True
Well:	Lion Creek 12-05H	Survey Calculation Method:	Minimum Curvature
Wellbore:	Original Wellbore		
Design:	APD Directional Plan		

Planned Survey

Measured Depth (ft)	Inclination (deg)	Azimuth (deg)	Vertical Depth (ft)	+N/-S (ft)	+E/-W (ft)	Vertical Section (ft)	Dogleg Rate (?/100ft)	Build Rate (?/100ft)	Turn Rate (?/100ft)
0.00	0.00	0.00	0.00	0.00	0.00	0.00	0.00	0.00	0.00
100.00	0.00	0.00	100.00	0.00	0.00	0.00	0.00	0.00	0.00
200.00	0.00	0.00	200.00	0.00	0.00	0.00	0.00	0.00	0.00
300.00	0.00	0.00	300.00	0.00	0.00	0.00	0.00	0.00	0.00
400.00	0.00	0.00	400.00	0.00	0.00	0.00	0.00	0.00	0.00
500.00	0.00	0.00	500.00	0.00	0.00	0.00	0.00	0.00	0.00
600.00	0.00	0.00	600.00	0.00	0.00	0.00	0.00	0.00	0.00
700.00	0.00	0.00	700.00	0.00	0.00	0.00	0.00	0.00	0.00
800.00	0.00	0.00	800.00	0.00	0.00	0.00	0.00	0.00	0.00
900.00	0.00	0.00	900.00	0.00	0.00	0.00	0.00	0.00	0.00
1,000.00	0.00	0.00	1,000.00	0.00	0.00	0.00	0.00	0.00	0.00
1,100.00	0.00	0.00	1,100.00	0.00	0.00	0.00	0.00	0.00	0.00
1,200.00	0.00	0.00	1,200.00	0.00	0.00	0.00	0.00	0.00	0.00
1,300.00	0.00	0.00	1,300.00	0.00	0.00	0.00	0.00	0.00	0.00
1,400.00	0.00	0.00	1,400.00	0.00	0.00	0.00	0.00	0.00	0.00
1,500.00	0.00	0.00	1,500.00	0.00	0.00	0.00	0.00	0.00	0.00
1,600.00	0.00	0.00	1,600.00	0.00	0.00	0.00	0.00	0.00	0.00
1,700.00	0.00	0.00	1,700.00	0.00	0.00	0.00	0.00	0.00	0.00
1,715.00	0.00	0.00	1,715.00	0.00	0.00	0.00	0.00	0.00	0.00
9-5/8"									
1,800.00	0.00	0.00	1,800.00	0.00	0.00	0.00	0.00	0.00	0.00
1,900.00	0.00	0.00	1,900.00	0.00	0.00	0.00	0.00	0.00	0.00
2,000.00	0.00	0.00	2,000.00	0.00	0.00	0.00	0.00	0.00	0.00
2,100.00	0.00	0.00	2,100.00	0.00	0.00	0.00	0.00	0.00	0.00
2,200.00	0.00	0.00	2,200.00	0.00	0.00	0.00	0.00	0.00	0.00
2,300.00	0.00	0.00	2,300.00	0.00	0.00	0.00	0.00	0.00	0.00
2,400.00	0.00	0.00	2,400.00	0.00	0.00	0.00	0.00	0.00	0.00
2,500.00	0.00	0.00	2,500.00	0.00	0.00	0.00	0.00	0.00	0.00
2,600.00	0.00	0.00	2,600.00	0.00	0.00	0.00	0.00	0.00	0.00
2,700.00	0.00	0.00	2,700.00	0.00	0.00	0.00	0.00	0.00	0.00
2,800.00	0.00	0.00	2,800.00	0.00	0.00	0.00	0.00	0.00	0.00
2,900.00	0.00	0.00	2,900.00	0.00	0.00	0.00	0.00	0.00	0.00
3,000.00	0.00	0.00	3,000.00	0.00	0.00	0.00	0.00	0.00	0.00
3,100.00	0.00	0.00	3,100.00	0.00	0.00	0.00	0.00	0.00	0.00
3,200.00	0.00	0.00	3,200.00	0.00	0.00	0.00	0.00	0.00	0.00
3,300.00	0.00	0.00	3,300.00	0.00	0.00	0.00	0.00	0.00	0.00
3,400.00	0.00	0.00	3,400.00	0.00	0.00	0.00	0.00	0.00	0.00
3,500.00	0.00	0.00	3,500.00	0.00	0.00	0.00	0.00	0.00	0.00
3,600.00	0.00	0.00	3,600.00	0.00	0.00	0.00	0.00	0.00	0.00
3,700.00	0.00	0.00	3,700.00	0.00	0.00	0.00	0.00	0.00	0.00
3,800.00	0.00	0.00	3,800.00	0.00	0.00	0.00	0.00	0.00	0.00
3,900.00	0.00	0.00	3,900.00	0.00	0.00	0.00	0.00	0.00	0.00
4,000.00	0.00	0.00	4,000.00	0.00	0.00	0.00	0.00	0.00	0.00
4,100.00	0.00	0.00	4,100.00	0.00	0.00	0.00	0.00	0.00	0.00
4,200.00	0.00	0.00	4,200.00	0.00	0.00	0.00	0.00	0.00	0.00
4,300.00	0.00	0.00	4,300.00	0.00	0.00	0.00	0.00	0.00	0.00
4,400.00	0.00	0.00	4,400.00	0.00	0.00	0.00	0.00	0.00	0.00
4,500.00	0.00	0.00	4,500.00	0.00	0.00	0.00	0.00	0.00	0.00
4,600.00	0.00	0.00	4,600.00	0.00	0.00	0.00	0.00	0.00	0.00
4,700.00	0.00	0.00	4,700.00	0.00	0.00	0.00	0.00	0.00	0.00
4,800.00	0.00	0.00	4,800.00	0.00	0.00	0.00	0.00	0.00	0.00
4,900.00	0.00	0.00	4,900.00	0.00	0.00	0.00	0.00	0.00	0.00
5,000.00	0.00	0.00	5,000.00	0.00	0.00	0.00	0.00	0.00	0.00

EOG Resources Inc

Planning Report

Database:	EDM	Local Co-ordinate Reference:	Site Lion Creek 12-05H
Company:	Denver Division- Colorado	TVD Reference:	RIG @ 5510.00ft (TBD)
Project:	DJ - Hereford Ranch	MD Reference:	RIG @ 5510.00ft (TBD)
Site:	Lion Creek 12-05H	North Reference:	True
Well:	Lion Creek 12-05H	Survey Calculation Method:	Minimum Curvature
Wellbore:	Original Wellbore		
Design:	APD Directional Plan		

Planned Survey

Measured Depth (ft)	Inclination (deg)	Azimuth (deg)	Vertical Depth (ft)	+N/-S (ft)	+E/-W (ft)	Vertical Section (ft)	Dogleg Rate (?/100ft)	Build Rate (?/100ft)	Turn Rate (?/100ft)
5,100.00	0.00	0.00	5,100.00	0.00	0.00	0.00	0.00	0.00	0.00
5,200.00	0.00	0.00	5,200.00	0.00	0.00	0.00	0.00	0.00	0.00
5,300.00	0.00	0.00	5,300.00	0.00	0.00	0.00	0.00	0.00	0.00
5,400.00	0.00	0.00	5,400.00	0.00	0.00	0.00	0.00	0.00	0.00
5,500.00	0.00	0.00	5,500.00	0.00	0.00	0.00	0.00	0.00	0.00
5,600.00	0.00	0.00	5,600.00	0.00	0.00	0.00	0.00	0.00	0.00
5,700.00	0.00	0.00	5,700.00	0.00	0.00	0.00	0.00	0.00	0.00
5,800.00	0.00	0.00	5,800.00	0.00	0.00	0.00	0.00	0.00	0.00
5,900.00	0.00	0.00	5,900.00	0.00	0.00	0.00	0.00	0.00	0.00
6,000.00	0.00	0.00	6,000.00	0.00	0.00	0.00	0.00	0.00	0.00
6,100.00	0.00	0.00	6,100.00	0.00	0.00	0.00	0.00	0.00	0.00
6,200.00	0.00	0.00	6,200.00	0.00	0.00	0.00	0.00	0.00	0.00
6,300.00	0.00	0.00	6,300.00	0.00	0.00	0.00	0.00	0.00	0.00
6,400.00	0.00	0.00	6,400.00	0.00	0.00	0.00	0.00	0.00	0.00
6,500.00	0.00	0.00	6,500.00	0.00	0.00	0.00	0.00	0.00	0.00
6,600.00	0.00	0.00	6,600.00	0.00	0.00	0.00	0.00	0.00	0.00
6,700.00	0.00	0.00	6,700.00	0.00	0.00	0.00	0.00	0.00	0.00
6,800.00	0.00	0.00	6,800.00	0.00	0.00	0.00	0.00	0.00	0.00
6,900.00	0.00	0.00	6,900.00	0.00	0.00	0.00	0.00	0.00	0.00
7,000.00	0.00	0.00	7,000.00	0.00	0.00	0.00	0.00	0.00	0.00
7,100.00	0.00	0.00	7,100.00	0.00	0.00	0.00	0.00	0.00	0.00
7,200.00	0.00	0.00	7,200.00	0.00	0.00	0.00	0.00	0.00	0.00
7,300.00	0.00	0.00	7,300.00	0.00	0.00	0.00	0.00	0.00	0.00
7,343.53	0.00	0.00	7,343.53	0.00	0.00	0.00	0.00	0.00	0.00
7,400.00	6.78	334.06	7,399.87	3.00	-1.46	3.33	12.00	12.00	0.00
7,500.00	18.78	334.06	7,497.21	22.85	-11.11	25.41	12.00	12.00	0.00
7,600.00	30.78	334.06	7,587.84	60.47	-29.41	67.24	12.00	12.00	0.00
7,700.00	42.78	334.06	7,667.80	114.20	-55.55	127.00	12.00	12.00	0.00
7,800.00	54.78	334.06	7,733.58	181.72	-88.39	202.07	12.00	12.00	0.00
7,900.00	66.78	334.06	7,782.31	260.05	-126.49	289.19	12.00	12.00	0.00
8,000.00	78.78	334.06	7,811.87	345.79	-168.19	384.53	12.00	12.00	0.00
8,093.54	90.00	334.06	7,821.00	429.37	-208.85	477.47	12.00	12.00	0.00
7"									
8,100.00	90.00	334.06	7,821.00	435.18	-211.67	483.93	0.00	0.00	0.00
8,200.00	90.00	334.06	7,821.00	525.11	-255.42	583.93	0.00	0.00	0.00
8,300.00	90.00	334.06	7,821.00	615.03	-299.16	683.93	0.00	0.00	0.00
8,400.00	90.00	334.06	7,821.00	704.96	-342.90	783.93	0.00	0.00	0.00
8,500.00	90.00	334.06	7,821.00	794.89	-386.64	883.93	0.00	0.00	0.00
8,600.00	90.00	334.06	7,821.00	884.81	-430.38	983.93	0.00	0.00	0.00
8,700.00	90.00	334.06	7,821.00	974.74	-474.12	1,083.93	0.00	0.00	0.00
8,800.00	90.00	334.06	7,821.00	1,064.67	-517.86	1,183.93	0.00	0.00	0.00
8,900.00	90.00	334.06	7,821.00	1,154.59	-561.60	1,283.93	0.00	0.00	0.00
9,000.00	90.00	334.06	7,821.00	1,244.52	-605.34	1,383.93	0.00	0.00	0.00
9,100.00	90.00	334.06	7,821.00	1,334.44	-649.08	1,483.93	0.00	0.00	0.00
9,200.00	90.00	334.06	7,821.00	1,424.37	-692.82	1,583.93	0.00	0.00	0.00
9,300.00	90.00	334.06	7,821.00	1,514.30	-736.56	1,683.93	0.00	0.00	0.00
9,400.00	90.00	334.06	7,821.00	1,604.22	-780.30	1,783.93	0.00	0.00	0.00
9,500.00	90.00	334.06	7,821.00	1,694.15	-824.04	1,883.93	0.00	0.00	0.00
9,600.00	90.00	334.06	7,821.00	1,784.08	-867.78	1,983.93	0.00	0.00	0.00
9,700.00	90.00	334.06	7,821.00	1,874.00	-911.53	2,083.93	0.00	0.00	0.00
9,800.00	90.00	334.06	7,821.00	1,963.93	-955.27	2,183.93	0.00	0.00	0.00
9,900.00	90.00	334.06	7,821.00	2,053.86	-999.01	2,283.93	0.00	0.00	0.00
10,000.00	90.00	334.06	7,821.00	2,143.78	-1,042.75	2,383.93	0.00	0.00	0.00

EOG Resources Inc

Planning Report

Database:	EDM	Local Co-ordinate Reference:	Site Lion Creek 12-05H
Company:	Denver Division- Colorado	TVD Reference:	RIG @ 5510.00ft (TBD)
Project:	DJ - Hereford Ranch	MD Reference:	RIG @ 5510.00ft (TBD)
Site:	Lion Creek 12-05H	North Reference:	True
Well:	Lion Creek 12-05H	Survey Calculation Method:	Minimum Curvature
Wellbore:	Original Wellbore		
Design:	APD Directional Plan		

Planned Survey

Measured Depth (ft)	Inclination (deg)	Azimuth (deg)	Vertical Depth (ft)	+N/-S (ft)	+E/-W (ft)	Vertical Section (ft)	Dogleg Rate (?/100ft)	Build Rate (?/100ft)	Turn Rate (?/100ft)
10,100.00	90.00	334.06	7,821.00	2,233.71	-1,086.49	2,483.93	0.00	0.00	0.00
10,200.00	90.00	334.06	7,821.00	2,323.63	-1,130.23	2,583.93	0.00	0.00	0.00
10,300.00	90.00	334.06	7,821.00	2,413.56	-1,173.97	2,683.93	0.00	0.00	0.00
10,400.00	90.00	334.06	7,821.00	2,503.49	-1,217.71	2,783.93	0.00	0.00	0.00
10,500.00	90.00	334.06	7,821.00	2,593.41	-1,261.45	2,883.93	0.00	0.00	0.00
10,600.00	90.00	334.06	7,821.00	2,683.34	-1,305.19	2,983.93	0.00	0.00	0.00
10,700.00	90.00	334.06	7,821.00	2,773.27	-1,348.93	3,083.93	0.00	0.00	0.00
10,800.00	90.00	334.06	7,821.00	2,863.19	-1,392.67	3,183.93	0.00	0.00	0.00
10,900.00	90.00	334.06	7,821.00	2,953.12	-1,436.41	3,283.93	0.00	0.00	0.00
11,000.00	90.00	334.06	7,821.00	3,043.05	-1,480.15	3,383.93	0.00	0.00	0.00
11,100.00	90.00	334.06	7,821.00	3,132.97	-1,523.90	3,483.93	0.00	0.00	0.00
11,200.00	90.00	334.06	7,821.00	3,222.90	-1,567.64	3,583.93	0.00	0.00	0.00
11,300.00	90.00	334.06	7,821.00	3,312.82	-1,611.38	3,683.93	0.00	0.00	0.00
11,400.00	90.00	334.06	7,821.00	3,402.75	-1,655.12	3,783.93	0.00	0.00	0.00
11,500.00	90.00	334.06	7,821.00	3,492.68	-1,698.86	3,883.93	0.00	0.00	0.00
11,600.00	90.00	334.06	7,821.00	3,582.60	-1,742.60	3,983.93	0.00	0.00	0.00
11,700.00	90.00	334.06	7,821.00	3,672.53	-1,786.34	4,083.93	0.00	0.00	0.00
11,800.00	90.00	334.06	7,821.00	3,762.46	-1,830.08	4,183.93	0.00	0.00	0.00
11,900.00	90.00	334.06	7,821.00	3,852.38	-1,873.82	4,283.93	0.00	0.00	0.00
12,000.00	90.00	334.06	7,821.00	3,942.31	-1,917.56	4,383.93	0.00	0.00	0.00
12,100.00	90.00	334.06	7,821.00	4,032.24	-1,961.30	4,483.93	0.00	0.00	0.00
12,200.00	90.00	334.06	7,821.00	4,122.16	-2,005.04	4,583.93	0.00	0.00	0.00
12,300.00	90.00	334.06	7,821.00	4,212.09	-2,048.78	4,683.93	0.00	0.00	0.00
12,400.00	90.00	334.06	7,821.00	4,302.01	-2,092.52	4,783.93	0.00	0.00	0.00
12,498.44	90.00	334.06	7,821.00	4,390.54	-2,135.58	4,882.37	0.00	0.00	0.00

4 1/2" - Lion Creek 12-05H (BHL)

Targets

Target Name

- hit/miss target	Dip Angle (deg)	Dip Dir. (deg)	TVD (ft)	+N/-S (ft)	+E/-W (ft)	Northing (ft)	Easting (ft)	Latitude	Longitude
- Shape									
Lion Creek 12-05H (B	0.00	0.00	7,821.00	4,390.54	-2,135.58	592,243.44	2,256,641.35	40° 57' 19.469 N	104° 34' 15.301 W
- plan hits target center									
- Point									

Casing Points

Measured Depth (ft)	Vertical Depth (ft)	Name	Casing Diameter (")	Hole Diameter (")
1,715.00	1,715.00	9-5/8"	9-5/8	13-1/2
8,093.54	7,821.00	7"	7	8-3/4
12,498.44	7,821.00	4 1/2"	4-1/2	6