

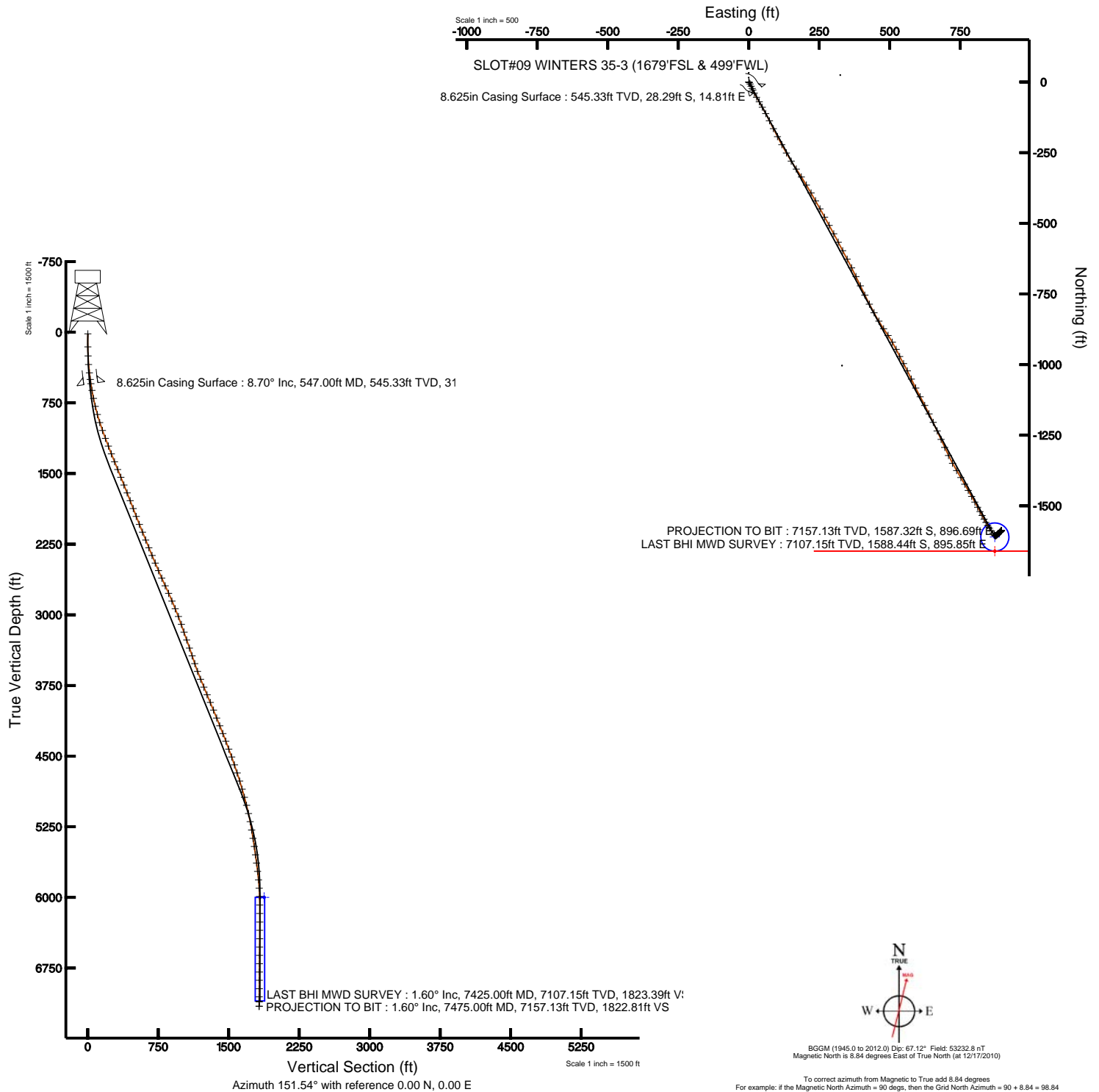

KERR MCGEE OIL & GAS ONSHORE LP

Location: COLORADO Slot: SLOT#09 WINTERS 35-3 (1679'FSL & 499'FWL)
Field: WELD COUNTY (KERR MCGEE) Well: WINTERS 35-3
Facility: SEC.03-T5N-R65W Wellbore: WINTERS 35-3 PWB

Plot reference wellpath is WINTERS 35-3 (REV-A-0) PWP	
True vertical depths are referenced to XTREME 6 (RKB)	Grid System: NAD83 / Lambert Colorado State Planes, Northern Zone (601), US feet
Measured depths are referenced to XTREME 6 (RKB)	North Reference: True north
XTREME 6 (RKB) to Mean Sea Level: 4648 feet	Scale: True distance
Mean Sea Level to Mud line (Facility: SEC.03-T5N-R65W): 0 feet	Depths are in feet
Coordinates are in feet referenced to Slot	Created by: cookdann on 2/3/2011





Actual Wellpath Report

WINTERS 35-3 AWP

Page 1 of 5



INTEQ

REFERENCE WELLPATH IDENTIFICATION

Operator	KERR MCGEE OIL & GAS ONSHORE LP	Slot	SLOT#09 WINTERS 35-3 (1679'FSL & 499'FWL)
Area	COLORADO	Well	WINTERS 35-3
Field	WELD COUNTY (KERR MCGEE)	Wellbore	WINTERS 35-3 AWB
Facility	SEC.03-T5N-R65W		

REPORT SETUP INFORMATION

Projection System	NAD83 / Lambert Colorado State Planes, Northern Zone (501), US feet	Software System	WellArchitect® 2.0
North Reference	True	User	Cookdanm
Scale	0.999961	Report Generated	2/3/2011 at 1:24:03 PM
Convergence at slot	0.54° East	Database/Source file	Denver Server/WINTERS_35-3_AWB.xml

WELLPATH LOCATION

	Local coordinates		Grid coordinates		Geographic coordinates	
	North[ft]	East[ft]	Easting[USft]	Northing[USft]	Latitude	Longitude
Slot Location	-1562.91	-43.71	3234664.87	1399019.22	40°25'32.333"N	104°39'25.549"W
Facility Reference Pt			3234693.72	1400582.41	40°25'47.777"N	104°39'24.984"W
Field Reference Pt			3197771.84	1268891.29	40°04'09.600"N	104°47'36.000"W

WELLPATH DATUM

Calculation method	Minimum curvature	XTREME 6 (RKB) to Facility Vertical Datum	4648.00ft
Horizontal Reference Pt	Slot	XTREME 6 (RKB) to Mean Sea Level	4648.00ft
Vertical Reference Pt	XTREME 6 (RKB)	Facility Vertical Datum to Mud Line (Facility)	0.00ft
MD Reference Pt	XTREME 6 (RKB)	Section Origin	N 0.00, E 0.00 ft
Field Vertical Reference	Mean Sea Level	Section Azimuth	151.54°



Actual Wellpath Report

WINTERS 35-3 AWP

Page 2 of 5



INTEQ

REFERENCE WELLPATH IDENTIFICATION

Operator	KERR MCGEE OIL & GAS ONSHORE LP	Slot	SLOT#09 WINTERS 35-3 (1679'FSL & 499'FWL)
Area	COLORADO	Well	WINTERS 35-3
Field	WELD COUNTY (KERR MCGEE)	Wellbore	WINTERS 35-3 AWB
Facility	SEC.03-T5N-R65W		

WELLPATH DATA (86 stations) † = interpolated/extrapolated station

MD [ft]	Inclination [°]	Azimuth [°]	TVD [ft]	Vert Sect [ft]	North [ft]	East [ft]	DLS [°/100ft]	Comments
0.00†	0.000	87.200	0.00	0.00	0.00	0.00	0.00	
16.00	0.000	87.200	16.00	0.00	0.00	0.00	0.00	
155.00	0.400	87.200	155.00	0.21	0.02	0.48	0.29	
251.00	2.400	145.600	250.97	2.35	-1.62	1.96	2.31	
342.00	4.600	153.700	341.79	7.90	-6.46	4.65	2.47	
431.00	6.700	156.500	430.36	16.64	-14.42	8.30	2.38	
502.00	7.700	154.000	500.80	25.52	-22.50	12.04	1.48	
619.00	10.300	155.800	616.34	43.78	-39.09	19.76	2.23	
706.00	11.600	148.400	701.76	60.27	-53.63	27.53	2.20	
793.00	13.400	149.500	786.70	79.08	-69.77	37.24	2.09	
882.00	15.400	151.600	872.90	101.21	-89.05	48.09	2.32	
971.00	17.800	151.600	958.18	126.63	-111.42	60.18	2.70	
1060.00	19.800	153.300	1042.43	155.31	-136.85	73.43	2.33	
1149.00	21.500	153.700	1125.71	186.67	-164.94	87.43	1.92	
1237.00	20.800	151.900	1207.78	218.41	-193.18	101.93	1.09	
1326.00	21.600	151.200	1290.76	250.60	-221.48	117.27	0.94	
1416.00	22.300	150.500	1374.23	284.23	-250.86	133.66	0.83	
1505.00	22.200	148.400	1456.61	317.91	-279.87	150.78	0.90	
1594.00	21.600	146.700	1539.19	351.02	-307.89	168.59	0.98	
1683.00	22.200	147.400	1621.76	384.11	-335.75	186.64	0.74	
1773.00	21.900	149.100	1705.18	417.84	-364.47	204.42	0.78	
1862.00	21.100	149.800	1787.99	450.44	-392.56	221.00	0.94	
1951.00	21.000	150.200	1871.05	482.39	-420.24	236.99	0.20	
2041.00	21.300	151.600	1954.99	514.86	-448.62	252.78	0.65	
2132.00	22.100	151.200	2039.54	548.51	-478.16	268.88	0.89	
2221.00	22.000	149.800	2122.03	581.91	-507.24	285.34	0.60	
2311.00	22.200	152.300	2205.42	615.76	-536.86	301.72	1.07	
2400.00	22.400	152.300	2287.76	649.53	-566.76	317.42	0.22	
2489.00	22.700	152.600	2369.96	683.66	-597.02	333.20	0.36	
2576.00	23.100	151.600	2450.10	717.51	-626.94	349.05	0.64	
2664.00	23.100	153.000	2531.04	752.03	-657.51	365.09	0.62	
2751.00	23.700	154.400	2610.89	786.55	-688.48	380.40	0.94	
2840.00	24.600	154.400	2692.10	822.92	-721.32	396.13	1.01	
2928.00	24.600	154.400	2772.11	859.51	-754.35	411.96	0.00	
3017.00	22.500	152.300	2853.70	895.04	-786.14	427.88	2.54	
3106.00	23.400	150.200	2935.65	929.74	-816.56	444.58	1.37	
3195.00	22.100	150.200	3017.73	964.15	-846.42	461.68	1.46	
3284.00	19.600	146.300	3100.90	995.76	-873.38	478.29	3.21	
3371.00	18.500	145.300	3183.13	1024.01	-896.86	494.25	1.32	
3460.00	18.800	149.800	3267.46	1052.38	-920.87	509.50	1.65	
3550.00	18.500	154.000	3352.74	1081.14	-946.24	523.05	1.53	
3638.00	19.000	153.300	3436.07	1109.41	-971.58	535.61	0.62	
3725.00	19.300	149.800	3518.26	1137.94	-996.66	549.21	1.36	
3812.00	19.800	154.700	3600.25	1167.02	-1022.41	562.74	1.97	
3902.00	22.400	153.700	3684.21	1199.38	-1051.57	576.85	2.92	



Actual Wellpath Report

WINTERS 35-3 AWP

Page 3 of 5



REFERENCE WELLPATH IDENTIFICATION

Operator	KERR MCGEE OIL & GAS ONSHORE LP	Slot	SLOT#09 WINTERS 35-3 (1679'FSL & 499'FWL)
Area	COLORADO	Well	WINTERS 35-3
Field	WELD COUNTY (KERR MCGEE)	Wellbore	WINTERS 35-3 AWB
Facility	SEC.03-T5N-R65W		

WELLPATH DATA (86 stations)

MD [ft]	Inclination [°]	Azimuth [°]	TVD [ft]	Vert Sect [ft]	North [ft]	East [ft]	DLS [°/100ft]	Comments
3993.00	22.900	153.300	3768.19	1234.41	-1082.93	592.49	0.57	
4081.00	23.600	152.600	3849.04	1269.13	-1113.87	608.29	0.86	
4169.00	22.900	152.600	3929.89	1303.87	-1144.71	624.27	0.80	
4257.00	21.800	153.000	4011.28	1337.32	-1174.47	639.57	1.26	
4348.00	21.500	154.700	4095.86	1370.86	-1204.60	654.37	0.76	
4437.00	22.600	155.400	4178.35	1404.21	-1234.90	668.46	1.27	
4526.00	21.200	155.100	4260.93	1437.34	-1265.04	682.35	1.58	
4613.00	20.500	156.100	4342.23	1468.22	-1293.24	695.15	0.90	
4703.00	21.000	153.300	4426.39	1500.05	-1322.06	708.78	1.23	
4792.00	19.800	151.900	4509.81	1531.07	-1349.60	723.05	1.46	
4881.00	18.900	149.100	4593.78	1560.54	-1375.27	737.55	1.45	
4971.00	18.500	148.800	4679.03	1589.37	-1399.99	752.43	0.46	
5062.00	16.400	150.500	4765.84	1616.64	-1423.52	766.24	2.37	
5152.00	16.300	150.500	4852.20	1641.97	-1445.57	778.71	0.11	
5241.00	15.600	150.200	4937.77	1666.42	-1466.83	790.81	0.79	
5329.00	14.800	151.200	5022.69	1689.49	-1486.95	802.11	0.96	
5419.00	12.000	151.200	5110.24	1710.34	-1505.22	812.15	3.11	
5507.00	10.600	151.900	5196.53	1727.59	-1520.38	820.37	1.60	
5597.00	9.500	151.200	5285.15	1743.29	-1534.19	827.85	1.23	
5687.00	9.300	150.500	5373.94	1757.99	-1547.03	835.01	0.26	
5774.00	8.500	151.600	5459.89	1771.45	-1558.80	841.53	0.94	
5863.00	7.700	148.400	5548.00	1783.98	-1569.67	847.78	1.03	
5951.00	7.400	145.600	5635.24	1795.50	-1579.36	854.07	0.54	
6041.00	7.100	143.800	5724.52	1806.78	-1588.63	860.63	0.42	
6131.00	5.700	145.600	5813.96	1816.74	-1596.81	866.44	1.57	
6220.00	3.400	143.100	5902.67	1823.74	-1602.57	870.53	2.59	
6308.00	1.800	133.300	5990.58	1827.64	-1605.60	873.10	1.88	
6399.00	0.800	94.400	6081.55	1829.34	-1606.63	874.77	1.41	
6489.00	1.200	69.000	6171.54	1829.80	-1606.34	876.28	0.65	
6580.00	1.300	51.700	6262.52	1829.75	-1605.36	877.98	0.43	
6668.00	1.800	47.200	6350.49	1829.24	-1603.80	879.78	0.58	
6757.00	1.800	45.600	6439.44	1828.51	-1601.88	881.80	0.06	
6846.00	2.000	48.200	6528.39	1827.77	-1599.86	883.96	0.24	
6933.00	1.800	48.900	6615.35	1827.12	-1597.95	886.12	0.23	
7022.00	1.800	48.200	6704.30	1826.49	-1596.10	888.21	0.02	
7111.00	1.500	42.200	6793.26	1825.78	-1594.31	890.04	0.39	
7198.00	1.100	55.600	6880.24	1825.32	-1592.99	891.49	0.57	
7288.00	1.700	46.100	6970.21	1824.87	-1591.58	893.17	0.71	
7375.00	1.800	38.400	7057.17	1823.99	-1589.61	894.94	0.29	
7425.00	1.600	37.000	7107.15	1823.39	-1588.44	895.85	0.41	LAST BHI MWD SURVEY
7475.00	1.600	37.000	7157.13	1822.81	-1587.32	896.69	0.00	PROJECTION TO BIT



Actual Wellpath Report

WINTERS 35-3 AWP

Page 4 of 5



INTEQ

REFERENCE WELLPATH IDENTIFICATION			
Operator	KERR MCGEE OIL & GAS ONSHORE LP	Slot	SLOT#09 WINTERS 35-3 (1679'FSL & 499'FWL)
Area	COLORADO	Well	WINTERS 35-3
Field	WELD COUNTY (KERR MCGEE)	Wellbore	WINTERS 35-3 AWP
Facility	SEC.03-T5N-R65W		

HOLE & CASING SECTIONS Ref Wellbore: WINTERS 35-3 AWP Ref Wellpath: WINTERS 35-3 AWP									
String/Diameter	Start MD [ft]	End MD [ft]	Interval [ft]	Start TVD [ft]	End TVD [ft]	Start N/S [ft]	Start E/W [ft]	End N/S [ft]	End E/W [ft]
12.25in Open Hole	16.00	557.00	541.00	16.00	555.22	0.00	0.00	-29.67	15.46
8.625in Casing Surface	16.00	547.00	531.00	16.00	545.33	0.00	0.00	-28.29	14.81
7.875in Open Hole	547.00	7475.00	6928.00	545.33	7157.13	-28.29	14.81	-1587.32	896.69

TARGETS									
Name	MD [ft]	TVD [ft]	North [ft]	East [ft]	Grid East [srv ft]	Grid North [srv ft]	Latitude	Longitude	Shape
WINTERS 35-3 GEO TARGET 50' RADIUS (50'FSL & 1400'FWL, REV-1)		6000.00	-1610.61	873.17	3235553.27	1397417.04	40°25'16.417"N	104°39'14.260"W	circle
WINTERS 35-3 HARDLINE 50'S OF GEO TARGET		6000.00	-1660.61	873.17	3235553.75	1397367.05	40°25'15.923"N	104°39'14.260"W	point

WELLPATH COMPOSITION Ref Wellbore: WINTERS 35-3 AWP Ref Wellpath: WINTERS 35-3 AWP				
Start MD [ft]	End MD [ft]	Positional Uncertainty Model	Log Name/Comment	Wellbore
16.00	502.00	NaviTrak (Standard)	BHI MWD SURVEY 12.25 HOLE <155-502>	WINTERS 35-3 AWP
502.00	7425.00	NaviTrak (Standard)	BHI MWD SURVEY 7.875 HOLE <619-7425>	WINTERS 35-3 AWP
7425.00	7475.00	Blind Drilling (std)	Projection to bit	WINTERS 35-3 AWP



Actual Wellpath Report

WINTERS 35-3 AWP

Page 5 of 5



INTEQ

REFERENCE WELLPATH IDENTIFICATION

Operator	KERR MCGEE OIL & GAS ONSHORE LP	Slot	SLOT#09 WINTERS 35-3 (1679'FSL & 499'FWL)
Area	COLORADO	Well	WINTERS 35-3
Field	WELD COUNTY (KERR MCGEE)	Wellbore	WINTERS 35-3 AWB
Facility	SEC.03-T5N-R65W		

WELLPATH COMMENTS

MD [ft]	Inclination [°]	Azimuth [°]	TVD [ft]	Comment
7425.00	1.600	37.000	7107.15	LAST BHI MWD SURVEY
7475.00	1.600	37.000	7157.13	PROJECTION TO BIT