

EOG RESOURCES, INC.  
CRITTER CREEK #33-15H  
SECTION 15, T11N, R63W, 6th P.M.

PROCEED IN A WESTERLY DIRECTION FROM HEREFORD, COLORADO ALONG COUNTY ROAD 136 APPROXIMATELY 1.5 MILES TO THE JUNCTION OF THIS ROAD AND HIGHWAY 77 TO THE SOUTH; TURN LEFT AND PROCEED IN A SOUTHERLY DIRECTION APPROXIMATELY 2.0 MILES TO THE JUNCTION OF THIS ROAD AND COUNTY ROAD 132 TO THE WEST; TURN RIGHT AND PROCEED IN A WESTERLY DIRECTION APPROXIMATELY 3.0 MILES TO THE JUNCTION OF THIS ROAD AND COUNTY ROAD 71 TO THE SOUTH; TURN LEFT AND PROCEED IN A SOUTHERLY DIRECTION APPROXIMATELY 1.0 MILES TO THE JUNCTION OF THIS ROAD AND COUNTY ROAD 130 TO THE WEST; TURN RIGHT AND PROCEED IN A WESTERLY DIRECTION APPROXIMATELY 1.0 MILES TO THE JUNCTION OF THIS ROAD AND AN EXISTING ROAD TO THE WEST; PROCEED IN A WESTERLY DIRECTION APPROXIMATELY 0.1 MILES TO THE BEGINNING OF THE PROPOSED ACCESS ROAD TO THE WEST; FOLLOW ROAD FLAGS IN A WESTERLY DIRECTION APPROXIMATELY 1,151' TO THE PROPOSED LOCATION.

TOTAL DISTANCE FROM HEREFORD, COLORADO TO THE PROPOSED LOCATION IS APPROXIMATELY 8.8 MILES.

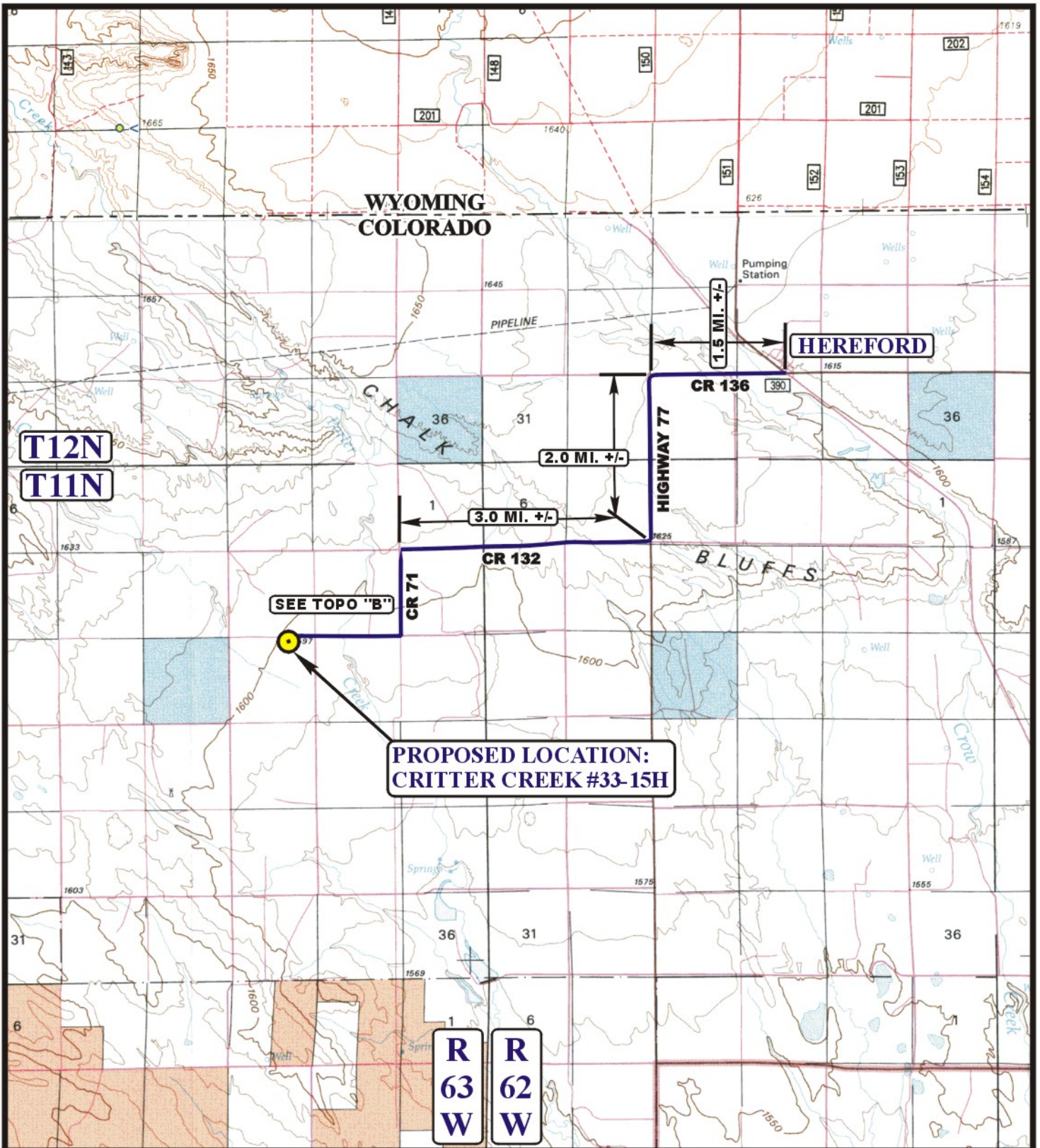

**LEGEND:**

 **PROPOSED LOCATION**



**EOG RESOURCES, INC.**

**CRITTER CREEK #33-15H**  
**SECTION 15, T11N, R63W, 6th P.M.**  
**301' FNL 1600' FEL**



Uintah Engineering & Land Surveying  
 85 South 200 East Vernal, Utah 84078  
 (435) 789-1017 \* FAX (435) 789-1813

**ACCESS ROAD**  
**MAP**

<b>01</b>	<b>31</b>	<b>11</b>
MONTH	DAY	YEAR

SCALE: 1:100,000

DRAWN BY: S.F.

REVISED: 00-00-00



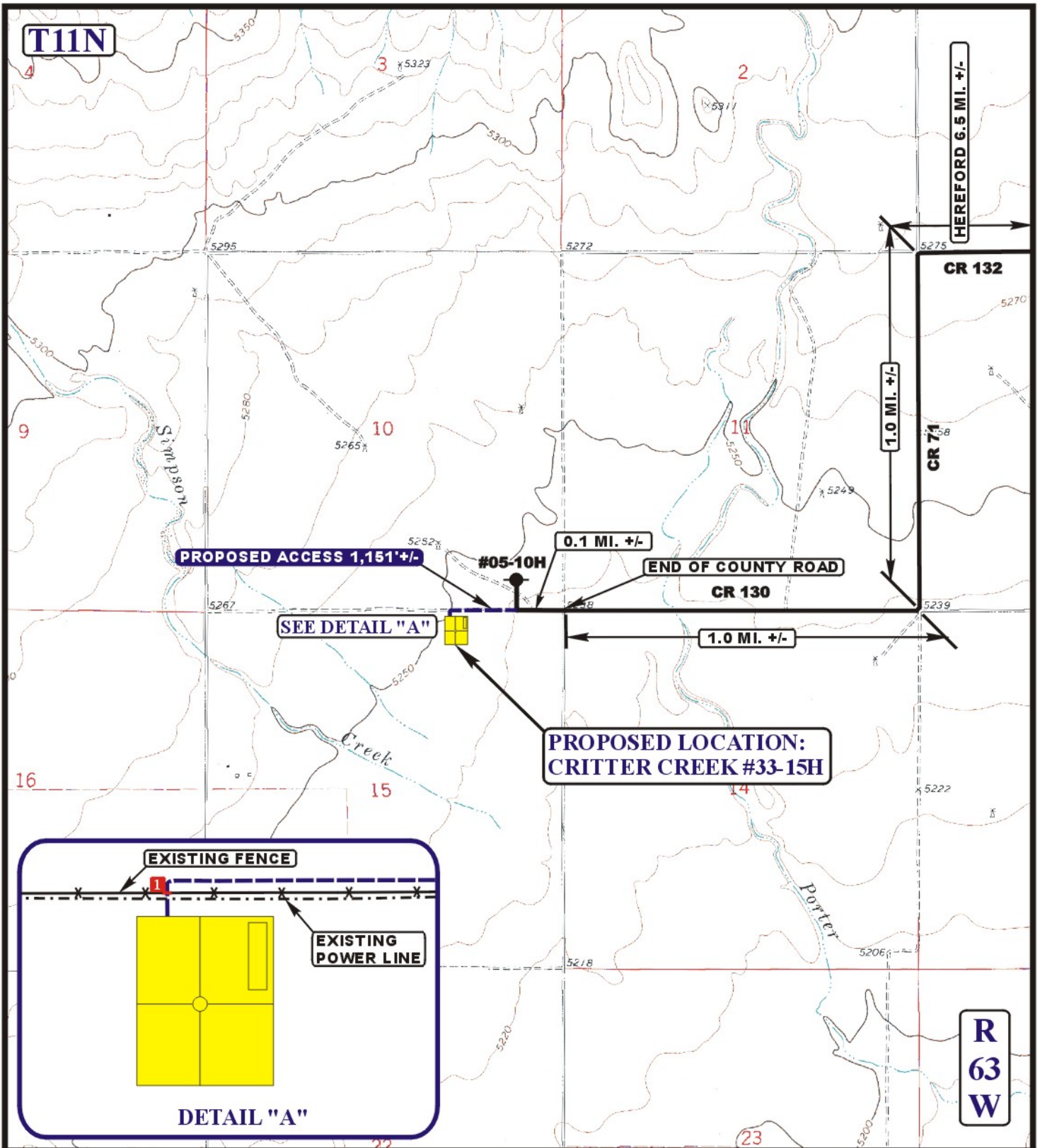

**LEGEND:**

- EXISTING ROAD
- PROPOSED ACCESS ROAD
- EXISTING FENCE
- EXISTING POWER LINE
- INSTALL CATTLE GUARD



**EOG RESOURCES, INC.**

**CRITTER CREEK #33-15H**  
**SECTION 15, T11N, R63W, 6th P.M.**  
**301' FNL 1600' FEL**



Uintah Engineering & Land Surveying  
 85 South 200 East Vernal, Utah 84078  
 (435) 789-1017 \* FAX (435) 789-1813

<b>ACCESS ROAD MAP</b>	<b>01</b>	<b>31</b>	<b>11</b>	<b>B TOPO</b>
	MONTH	DAY	YEAR	
SCALE: 1" = 2000'	DRAWN BY: S.F.		REVISED: 00-00-00	