

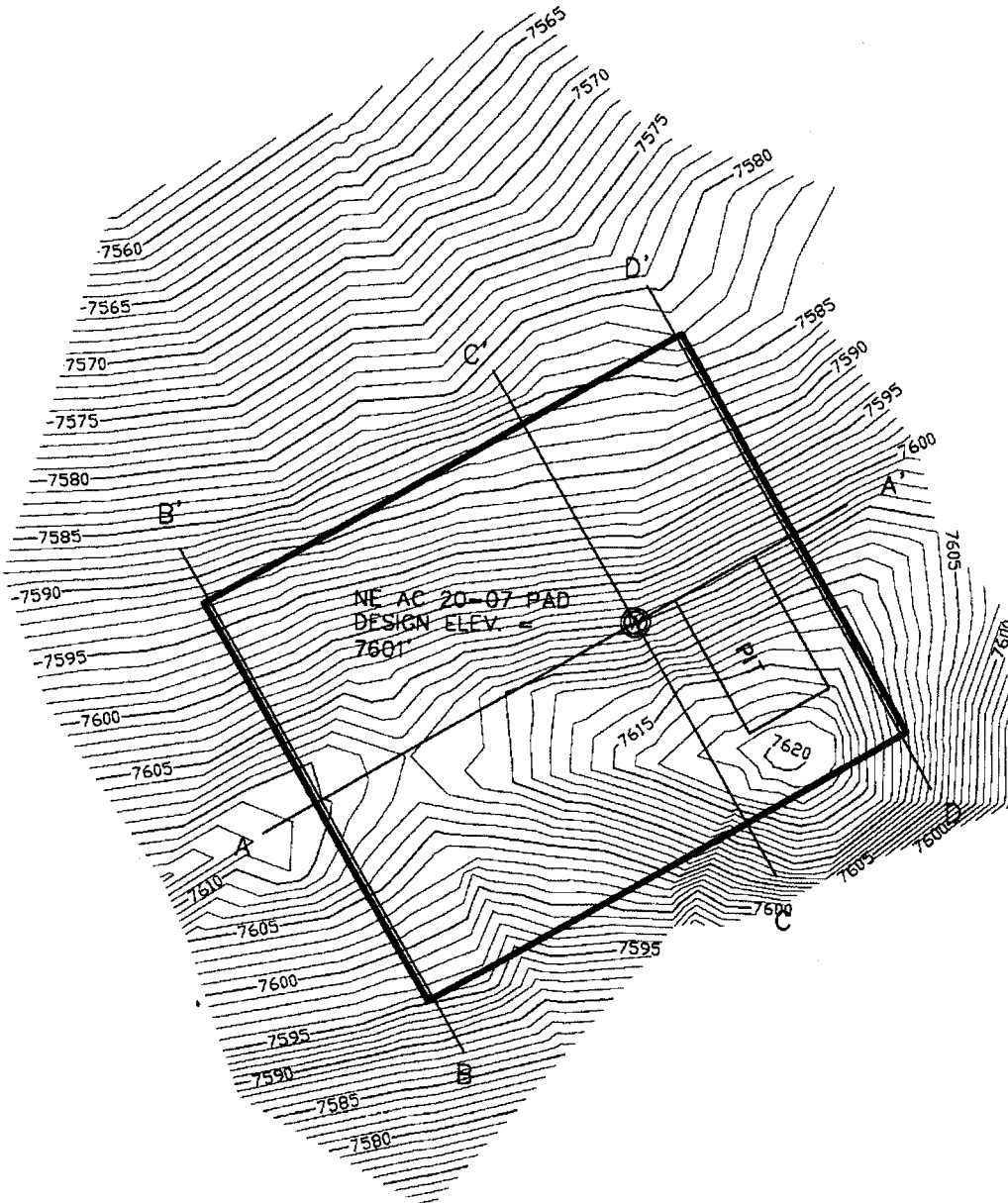

SCALE: 1" = 60'

CONSTRUCTION LAYOUT DRAWING

AC 20-07



NOTES:

- 1. UNGRADED ELEVATION AT WELLHEAD: 7605'
- 2. GRADED ELEVATION AT WELLHEAD: 7601'



DRAWN BY: NLE
DATE: 02/02/2011
AC 20-07 -CONST
DRAWING NAME:

APACHE CANYON 20-07
WELL PAD PLAN
XTO ENERGY INC.
LAS ANIMAS COUNTY, COLORADO

PAGE 1/4
REV A



CONSTRUCTION LAYOUT DRAWING

AC 20-07

SCALE: 1" = 60'

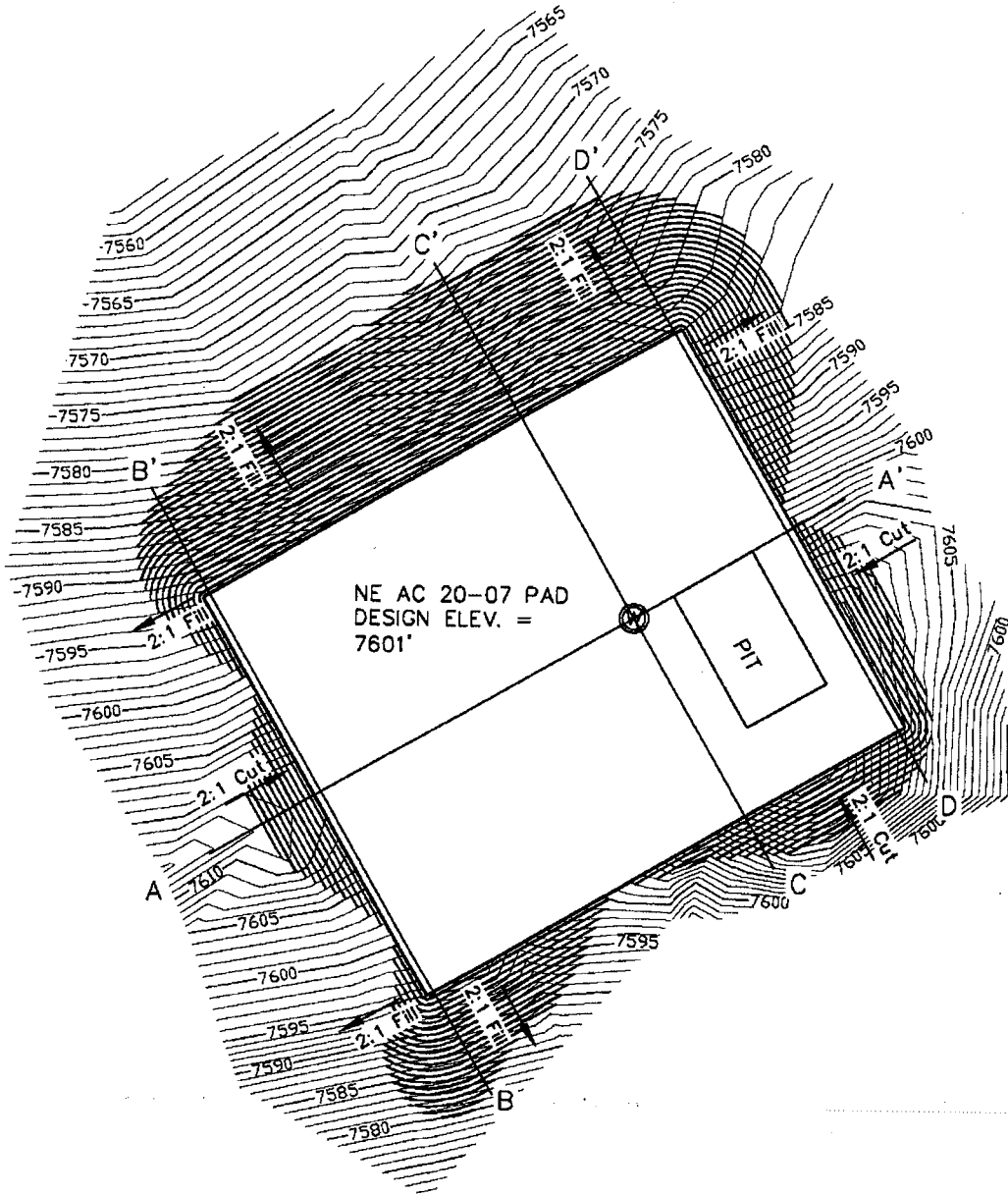

NOTES:

1. UNGRADED ELEVATION AT WELLHEAD: 7605'
2. GRADED ELEVATION AT WELLHEAD: 7601'



DRAWN BY: NLE
 DATE: 02/02/2011
 AC 20-07 -CONST
 DRAWING NAME:

APACHE CANYON 20-07
 WELL PAD PLAN
 XTO ENERGY INC.
 LAS ANIMAS COUNTY, COLORADO

PAGE 2/4
 REV A



CONSTRUCTION LAYOUT DRAWING

AC 20-07

SCALE: 1" = 60'

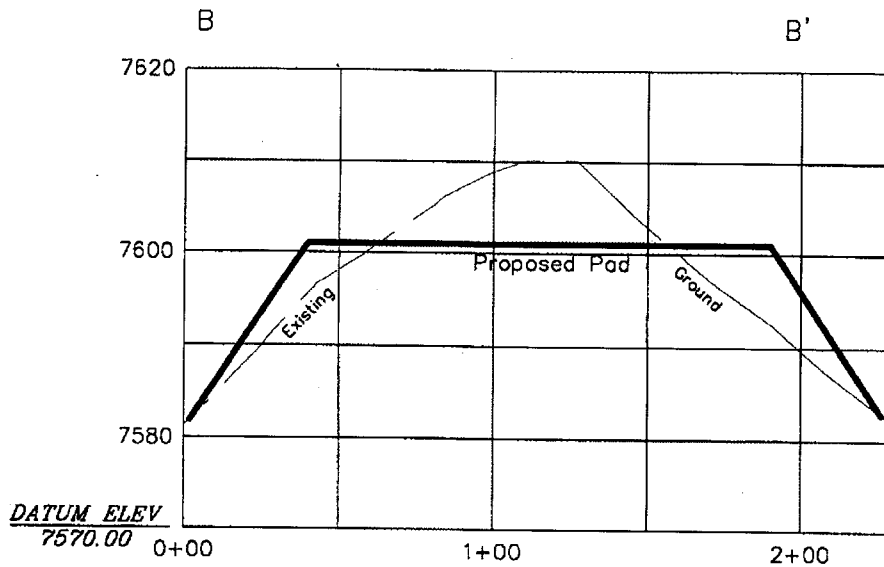
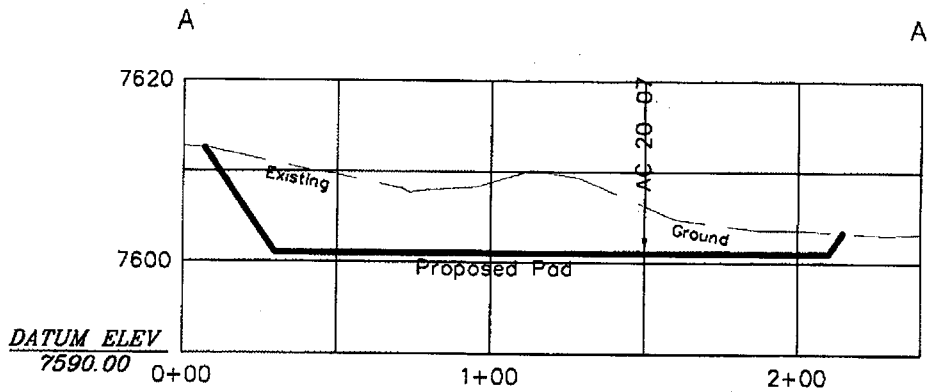

HORIZONTAL SCALE: 1" = 60'
VERTICAL SCALE: 1" = 20'



DRAWN BY: NLE
DATE: 02/02/2011
AC 20-07 -CONST
DRAWING NAME:

APACHE CANYON 20-07
WELL PAD PLAN
XTO ENERGY INC.
LAS ANIMAS COUNTY, COLORADO

PAGE
3/4
REV
A



SCALE: 1" = 60'

CONSTRUCTION LAYOUT DRAWING

AC 20-07

C

C'

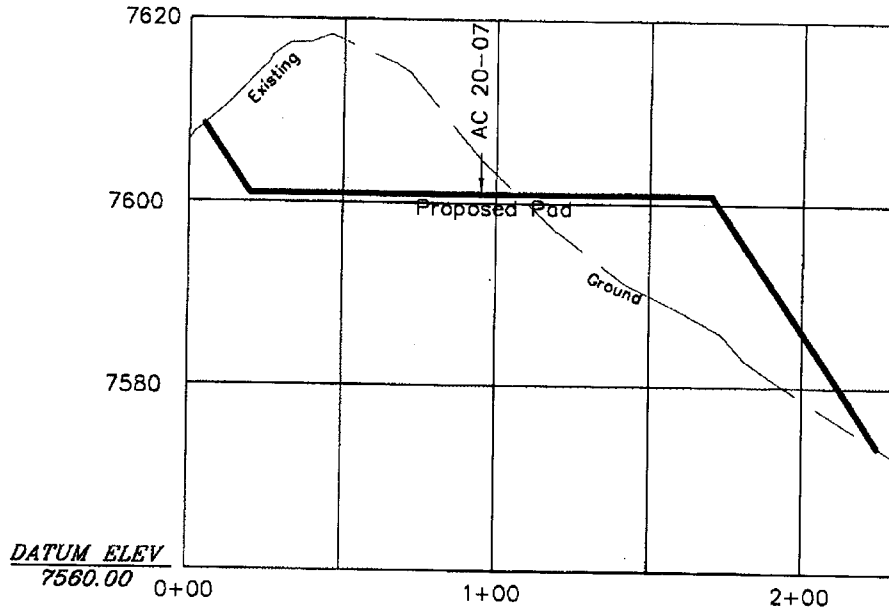

D

D'

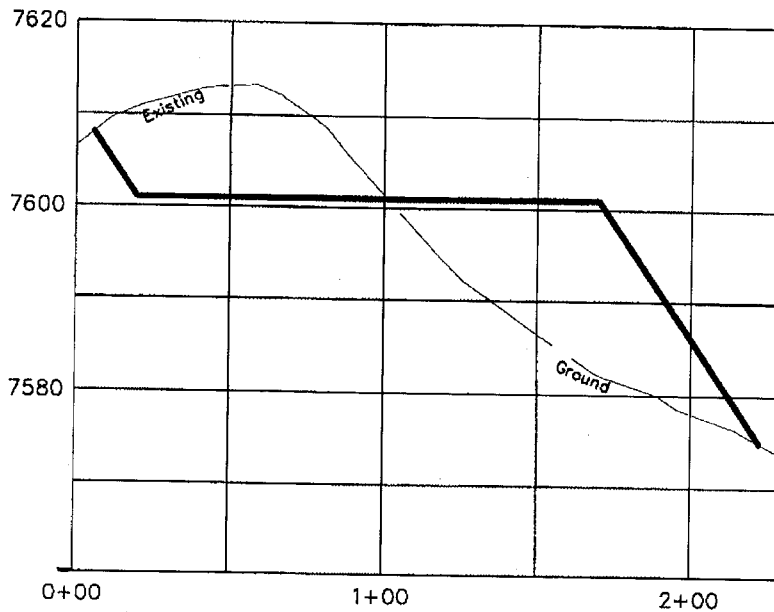

HORIZONTAL SCALE: 1" = 60'
VERTICAL SCALE: 1" = 20'



DRAWN BY:	NLE
DATE:	02/02/2011
DRAWING NAME:	AC 20-07-CONST

APACHE CANYON 20-07
WELL PAD PLAN
XTO ENERGY INC.
LAS ANIMAS COUNTY, COLORADO

PAGE	4/4
REV	A