

LOCATION DRAWING

SECTION 2
TOWNSHIP 3 NORTH
RANGE 64 WEST

DATE: 11/18/2010

THIS MAP DOES NOT REPRESENT A BOUNDARY SURVEY

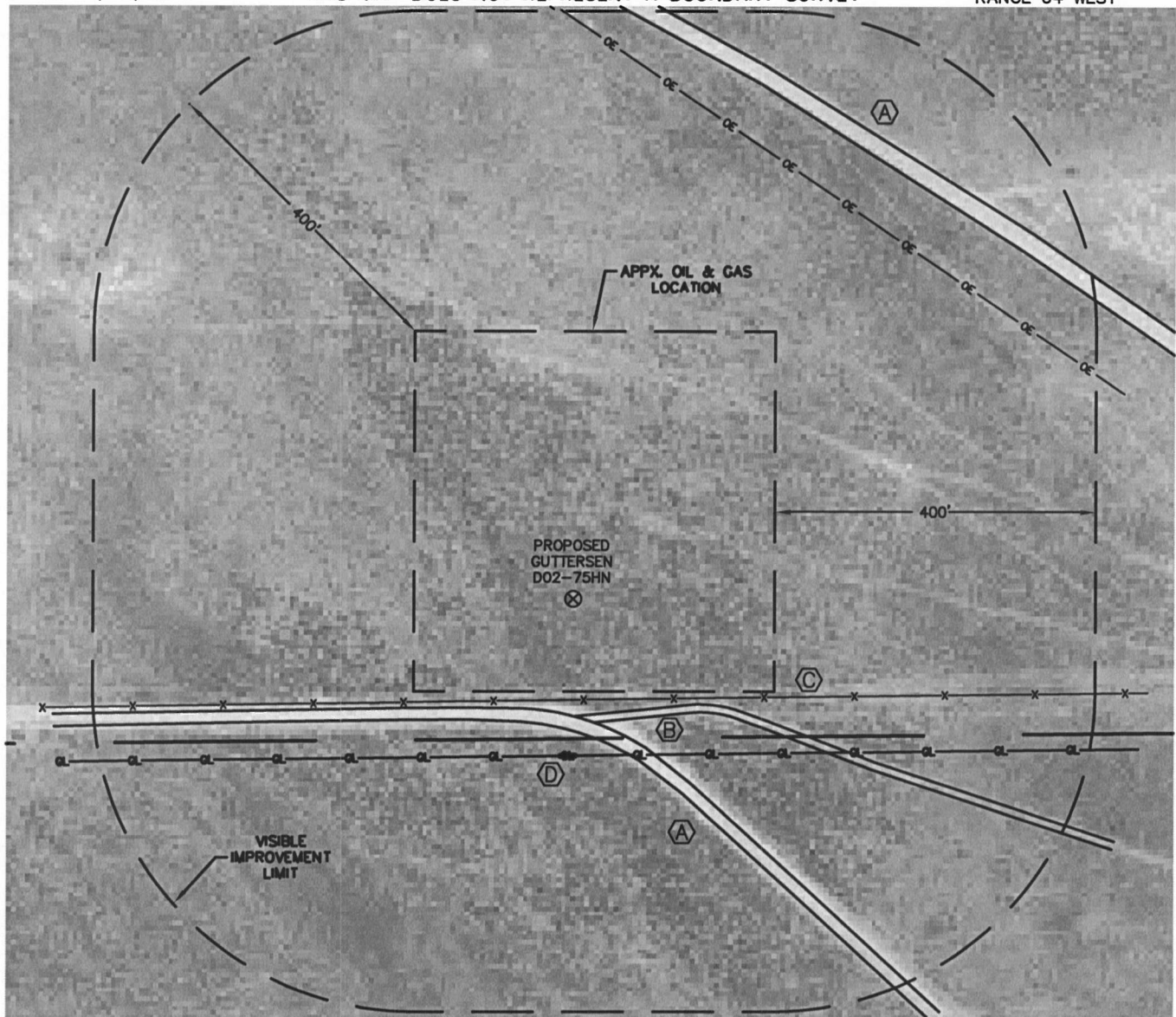

IMPROVEMENTS:

- (A) GRAVEL ROADS - 144' SOUTHWEST & 668' NORTHEAST
- (B) DIRT ROAD - 147' SOUTH
- (C) FENCE LINE - 126' SOUTH
- (D) BURIED GAS LINE - 196' SOUTH

THE NEAREST OVERHEAD POWER LINE IS 598' NORTHEAST.

NEW WELL DATA

ELEV = 4709', PDOP: 2.2

SW $\frac{1}{4}$ SE $\frac{1}{4}$ SEC 2

175' FSL, 2565' FEL

LAT: N 40.24763

LONG: W 104.51813

NEAREST PROP LINE: 175' SOUTH

NEAREST ACTIVE RAILROAD: MORE THAN
ONE MILE AWAY

NEAREST BUILDING: MORE THAN ONE MILE
AWAY

COUNTY ROAD NO. 57: 3660'+/-
NORTHWEST



A semi-circular scale with a vertical line at the center. The number 0 is on the left and 200 is on the right.

Scale: 1" = 200'

NOTE: The orientation of the oil & gas location as shown was determined by Noble Energy.

NOTICE: According to Colorado law you MUST commence any legal action based upon any defect in this W.L.C. within three years after you first discover such defect. In no event may any action based upon any defect in this W.L.C. be commenced more than ten years from this sold date of the certification shown herein.