

REFERENCE INFORMATION											
Co-ordinate (N/E) Reference: Well Ross 4-2-19, True North											
Vertical (TVD) Reference: WELL @ 5001.0ft (Original Well Elev)											
Section (VS) Reference: Slot - (0.0N, 0.0E)											
Measured Depth Reference: WELL @ 5001.0ft (Original Well Elev)											
Calculation Method:											
WELL DETAILS: Ross 4-2-19											
+N/-S		+E/-W		Northing		Ground Level: Easting		4988.0 Latitude		Longitude	Slot
SECTION DETAILS											
Sec	MD	Inc	Azi	TVD	+N/-S	+E/-W	DLeg	TFace	VSec	Target	
1	0.0	0.00	0.00	0.0	0.0	0.0	0.00	0.00	0.0		
2	850.0	0.00	0.00	850.0	0.0	0.0	0.00	0.00	0.0		
3	1820.3	19.41	70.22	1801.8	55.1	153.1	2.00	70.22	162.7		
4	6349.9	19.41	70.22	6074.2	564.3	1569.4	0.00	0.00	1667.7		
5	7320.2	0.00	0.00	7026.0	619.3	1722.5	2.00	180.00	1830.5		
6	8420.2	0.00	0.00	8126.0	619.3	1722.5	0.00	0.00	1830.5	Ross 4-2-19	

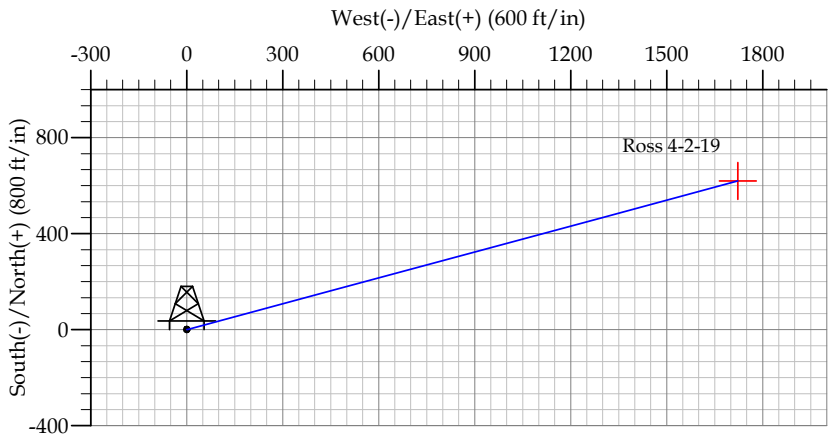

FORMATION TOP DETAILS		
TVDPath	MDPath	Formation
4246.0	4411.7	Sussex
4766.0	4963.0	Shannon
7251.0	7545.2	Niobrara
7541.0	7835.2	Codell
7976.0	8270.2	J Sand
8031.0	8325.2	A Marker
CASING DETAILS		
TVD	MD	Name Size
800.0	800.0	Surface 8.625
8126.0	8420.2	Production 4.500

# EnCana Corporation

## Planning Report - Geographic

<b>Database:</b>	EDM	<b>Local Co-ordinate Reference:</b>	Well Ross 4-2-19
<b>Company:</b>	DJ/Paradox/WTX	<b>TVD Reference:</b>	WELL @ 5001.0ft (Original Well Elev)
<b>Project:</b>	Wattenberg	<b>MD Reference:</b>	WELL @ 5001.0ft (Original Well Elev)
<b>Site:</b>	New Drills	<b>North Reference:</b>	True
<b>Well:</b>	Ross 4-2-19	<b>Survey Calculation Method:</b>	Minimum Curvature
<b>Wellbore:</b>	Wellbore #1		
<b>Design:</b>	Ross 4-2-19		

<b>Project</b>	Wattenberg,		
<b>Map System:</b>	US State Plane 1983	<b>System Datum:</b>	Mean Sea Level
<b>Geo Datum:</b>	North American Datum 1983		
<b>Map Zone:</b>	Colorado Northern Zone		

Site		New Drills				
Site Position:		Northing:	1,252,450.66ft	Latitude:	40° 1' 32.016 N	
From:	Lat/Long	Easting:	3,120,627.66ft	Longitude:	105° 4' 9.336 W	
Position Uncertainty:		ft	Slot Radius:	in	Grid Convergence:	0.28 °

Well	Ross 4-2-19					
Well Position	+N-S	36,492.9 ft	Northing:	1,288,966.66 ft	Latitude:	40° 7' 32.664 N
	+E-W	4,688.0 ft	Easting:	3,125,131.46 ft	Longitude:	105° 3' 9.072 W
Position Uncertainty		ft	Wellhead Elevation:	ft	Ground Level:	4,988.0 ft

<b>Wellbore</b>	Wellbore #1				
<b>Magnetics</b>	<b>Model Name</b>	<b>Sample Date</b>	<b>Declination (°)</b>	<b>Dip Angle (°)</b>	<b>Field Strength (nT)</b>
	IGRF200510	12/31/2009	9.15	66.84	53,127

<b>Design</b>	Ross 4-2-19				
<b>Audit Notes:</b>					
<b>Version:</b>	<b>Phase:</b>	PROTOTYPE		<b>Tie On Depth:</b>	0.0
<b>Vertical Section:</b>	<b>Depth From (TVD) (ft)</b>	<b>+N/-S (ft)</b>	<b>+E/-W (ft)</b>	<b>Direction (°)</b>	
	0.0	0.0	0.0	70.22	

<b>Plan Sections</b>										
Measured Depth (ft)	Inclination (°)	Azimuth (°)	Vertical Depth (ft)	+N/-S (ft)	+E/-W (ft)	Dogleg Rate (°/100ft)	Build Rate (°/100ft)	Turn Rate (°/100ft)	TFO (°)	Target
0.0	0.00	0.00	0.0	0.0	0.0	0.00	0.00	0.00	0.00	
850.0	0.00	0.00	850.0	0.0	0.0	0.00	0.00	0.00	0.00	
1,820.3	19.41	70.22	1,801.8	55.1	153.1	2.00	2.00	0.00	70.22	
6,349.9	19.41	70.22	6,074.2	564.3	1,569.4	0.00	0.00	0.00	0.00	
7,320.2	0.00	0.00	7,026.0	619.3	1,722.5	2.00	-2.00	0.00	180.00	
8,420.2	0.00	0.00	8,126.0	619.3	1,722.5	0.00	0.00	0.00	0.00	Ross 4-2-19

# EnCana Corporation

## Planning Report - Geographic

<b>Database:</b>	EDM	<b>Local Co-ordinate Reference:</b>	Well Ross 4-2-19
<b>Company:</b>	DJ/Paradox/WTX	<b>TVD Reference:</b>	WELL @ 5001.0ft (Original Well Elev)
<b>Project:</b>	Wattenberg	<b>MD Reference:</b>	WELL @ 5001.0ft (Original Well Elev)
<b>Site:</b>	New Drills	<b>North Reference:</b>	True
<b>Well:</b>	Ross 4-2-19	<b>Survey Calculation Method:</b>	Minimum Curvature
<b>Wellbore:</b>	Wellbore #1		
<b>Design:</b>	Ross 4-2-19		

Planned Survey									
Measured Depth (ft)	Inclination (°)	Azimuth (°)	Vertical Depth (ft)	+N/-S (ft)	+E/-W (ft)	Map Northing (ft)	Map Easting (ft)	Latitude	Longitude
0.0	0.00	0.00	0.0	0.0	0.0	1,288,966.66	3,125,131.46	40° 7' 32.664 N	105° 3' 9.072 W
800.0	0.00	0.00	800.0	0.0	0.0	1,288,966.66	3,125,131.46	40° 7' 32.664 N	105° 3' 9.072 W
Surface									
850.0	0.00	0.00	850.0	0.0	0.0	1,288,966.66	3,125,131.46	40° 7' 32.664 N	105° 3' 9.072 W
1,820.3	19.41	70.22	1,801.8	55.1	153.1	1,289,022.50	3,125,284.33	40° 7' 33.208 N	105° 3' 7.100 W
4,411.7	19.41	70.22	4,246.0	346.4	963.4	1,289,317.90	3,126,093.06	40° 7' 36.087 N	105° 2' 56.670 W
Sussex									
4,963.0	19.41	70.22	4,766.0	408.4	1,135.7	1,289,380.75	3,126,265.11	40° 7' 36.699 N	105° 2' 54.451 W
Shannon									
6,349.9	19.41	70.22	6,074.2	564.3	1,569.4	1,289,538.85	3,126,697.96	40° 7' 38.240 N	105° 2' 48.868 W
7,320.2	0.00	0.00	7,026.0	619.3	1,722.5	1,289,594.69	3,126,850.83	40° 7' 38.784 N	105° 2' 46.896 W
7,545.2	0.00	0.00	7,251.0	619.3	1,722.5	1,289,594.69	3,126,850.83	40° 7' 38.784 N	105° 2' 46.896 W
Niobrara									
7,835.2	0.00	0.00	7,541.0	619.3	1,722.5	1,289,594.69	3,126,850.83	40° 7' 38.784 N	105° 2' 46.896 W
Codell									
8,270.2	0.00	0.00	7,976.0	619.3	1,722.5	1,289,594.69	3,126,850.83	40° 7' 38.784 N	105° 2' 46.896 W
J Sand									
8,325.2	0.00	0.00	8,031.0	619.3	1,722.5	1,289,594.69	3,126,850.83	40° 7' 38.784 N	105° 2' 46.896 W
A Marker									
8,420.2	0.00	0.00	8,126.0	619.3	1,722.5	1,289,594.69	3,126,850.83	40° 7' 38.784 N	105° 2' 46.896 W
Production - Ross 4-2-19									

Design Targets										
Target Name	Dip Angle (°)	Dip Dir. (°)	TVD (ft)	+N/-S (ft)	+E/-W (ft)	Northing (ft)	Easting (ft)	Latitude	Longitude	
- hit/miss target										
- Shape										
Ross 4-2-19	0.00	0.00	8,126.0	619.3	1,722.5	1,289,594.69	3,126,850.83	40° 7' 38.784 N	105° 2' 46.896 W	
- plan hits target										
- Point										

Casing Points					
Measured Depth (ft)	Vertical Depth (ft)	Name	Casing Diameter (in)	Hole Diameter (in)	
800.0	800.0	Surface	8.625	12.250	
8,420.2	8,126.0	Production	4.500	7.785	

Formations						
Measured Depth (ft)	Vertical Depth (ft)	Name	Lithology	Dip (°)	Dip Direction (°)	
4,411.7	4,246.0	Sussex		0.00		
4,963.0	4,766.0	Shannon		0.00		
7,545.2	7,251.0	Niobrara		0.00		
7,835.2	7,541.0	Codell		0.00		
8,270.2	7,976.0	J Sand		0.00		
8,325.2	8,031.0	A Marker		0.00		

**EnCana Corporation**  
Planning Report - Geographic

<b>Database:</b>	EDM	<b>Local Co-ordinate Reference:</b>	Well Ross 4-2-19
<b>Company:</b>	DJ/Paradox/WTX	<b>TVD Reference:</b>	WELL @ 5001.0ft (Original Well Elev)
<b>Project:</b>	Wattenberg	<b>MD Reference:</b>	WELL @ 5001.0ft (Original Well Elev)
<b>Site:</b>	New Drills	<b>North Reference:</b>	True
<b>Well:</b>	Ross 4-2-19	<b>Survey Calculation Method:</b>	Minimum Curvature
<b>Wellbore:</b>	Wellbore #1		
<b>Design:</b>	Ross 4-2-19		