

KERR MCGEE OIL & GAS ONSHORE LP

Location: COLORADO Slot: SLOT#04 DRY CREEK 22-27 (1169'FNL & 1229'FWL)
 Field: WELD COUNTY (KERR MCGEE) Well: DRY CREEK 22-27
 Facility: SEC.27-T1N-R67W Wellbore: DRY CREEK 22-27 PWB

Plot reference wellpath is DRY CREEK 22-27 (REV-B.0) PWP

True vertical depths are referenced to XTREME 12 (RT)	Grid System: NAD83 / Lambert Colorado State Planes, Northern Zone (501), US feet
Measured depths are referenced to XTREME 12 (RT)	North Reference: True north
XTREME 12 (RT) to Mean Sea Level: 5023 feet	Scale: True distance
Mean Sea Level to Mud line (Facility: SEC.27-T1N-R67W): 0 feet	Depths are in feet
Coordinates are in feet referenced to Slot	Created by: nistale on 10/26/2010

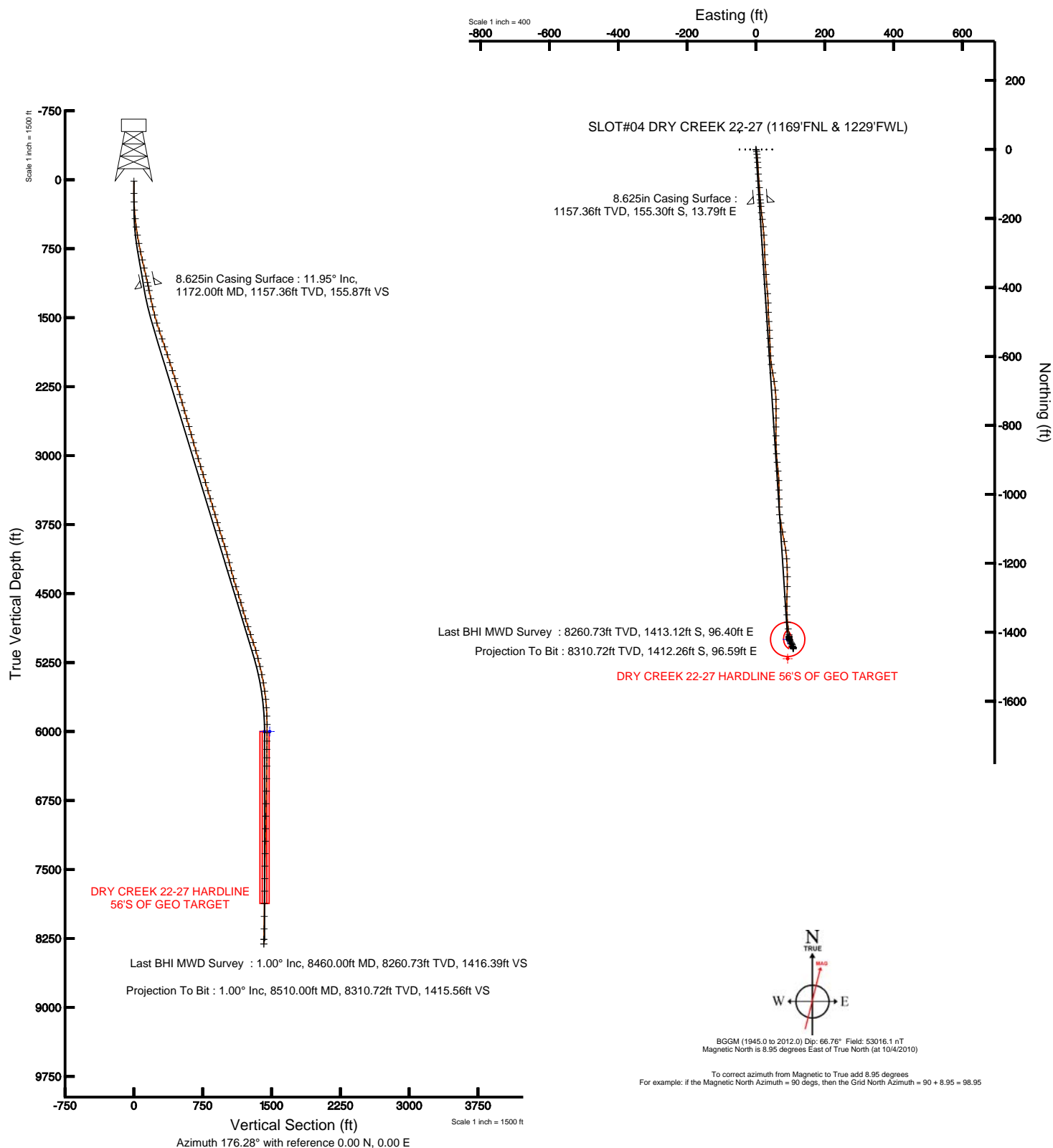



Actual Wellpath Report

DRY CREEK 22-27 AWB_awp

Page 1 of 5



INTEQ

REFERENCE WELLPATH IDENTIFICATION

Operator	KERR MCGEE OIL & GAS ONSHORE LP	Slot	SLOT#04 DRY CREEK 22-27 (1169'FNL & 1229'FWL)
Area	COLORADO	Well	DRY CREEK 22-27
Field	WELD COUNTY (KERR MCGEE)	Wellbore	DRY CREEK 22-27 AWB
Facility	SEC.27-T1N-R67W		

REPORT SETUP INFORMATION

Projection System	NAD83 / Lambert Colorado State Planes, Northern Zone (501), US feet	Software System	WellArchitect® 2.0
North Reference	True	User	Nistale
Scale	0.999964	Report Generated	10/26/2010 at 11:14:46 AM
Convergence at slot	0.40° East	Database/Source file	Denver Server/DRY_CREEK_22-27_AWB.xml

WELLPATH LOCATION

	Local coordinates		Grid coordinates		Geographic coordinates	
	North[ft]	East[ft]	Easting[USft]	Northing[USft]	Latitude	Longitude
Slot Location	0.00	47.61	3173145.59	1252968.94	40°01'34.068"N	104°52'54.192"W
Facility Reference Pt			3173097.99	1252968.61	40°01'34.068"N	104°52'54.804"W
Field Reference Pt			3197771.84	1268891.29	40°04'09.600"N	104°47'36.000"W

WELLPATH DATUM

Calculation method	Minimum curvature	XTREME 12 (RT) to Facility Vertical Datum	5023.00ft
Horizontal Reference Pt	Slot	XTREME 12 (RT) to Mean Sea Level	5023.00ft
Vertical Reference Pt	XTREME 12 (RT)	Facility Vertical Datum to Mud Line (Facility)	0.00ft
MD Reference Pt	XTREME 12 (RT)	Section Origin	N 0.00, E 0.00 ft
Field Vertical Reference	Mean Sea Level	Section Azimuth	176.28°



Actual Wellpath Report

DRY CREEK 22-27 AWB_awp

Page 2 of 5



INTEQ

REFERENCE WELLPATH IDENTIFICATION			
Operator	KERR MCGEE OIL & GAS ONSHORE LP	Slot	SLOT#04 DRY CREEK 22-27 (1169'FNL & 1229'FWL)
Area	COLORADO	Well	DRY CREEK 22-27
Field	WELD COUNTY (KERR MCGEE)	Wellbore	DRY CREEK 22-27 AWB
Facility	SEC.27-T1N-R67W		

WELLPATH DATA (89 stations) † = interpolated/extrapolated station								
MD [ft]	Inclination [°]	Azimuth [°]	TVD [ft]	Vert Sect [ft]	North [ft]	East [ft]	DLS [°/100ft]	Comments
0.00†	0.000	132.400	0.00	0.00	0.00	0.00	0.00	
15.00	0.000	132.400	15.00	0.00	0.00	0.00	0.00	
148.00	0.200	132.400	148.00	0.17	-0.16	0.17	0.15	
240.00	1.800	154.500	239.98	1.62	-1.57	0.91	1.76	
331.00	4.200	170.000	330.85	6.27	-6.14	2.11	2.76	
423.00	5.500	173.500	422.52	14.02	-13.84	3.19	1.45	
514.00	7.400	174.900	512.94	24.23	-24.01	4.21	2.09	
605.00	9.200	174.900	602.98	37.37	-37.09	5.37	1.98	
696.00	10.700	177.400	692.61	53.09	-52.78	6.40	1.71	
788.00	12.600	177.000	782.71	71.66	-71.34	7.32	2.07	
879.00	12.700	175.300	871.51	91.59	-91.22	8.65	0.42	
969.00	12.500	175.600	959.34	111.22	-110.79	10.21	0.23	
1060.00	13.100	176.000	1048.08	131.38	-130.89	11.69	0.67	
1130.00	12.600	174.500	1116.32	146.94	-146.41	12.97	0.86	
1220.00	11.200	175.600	1204.39	165.49	-164.89	14.58	1.58	
1311.00	12.400	174.900	1293.46	184.10	-183.44	16.13	1.33	
1401.00	12.500	170.700	1381.35	203.45	-202.68	18.56	1.01	
1492.00	14.800	174.900	1469.77	224.88	-223.97	21.19	2.75	
1583.00	16.700	175.600	1557.35	249.57	-248.59	23.23	2.10	
1674.00	18.500	177.700	1644.09	277.08	-276.05	24.81	2.10	
1765.00	18.800	178.400	1730.31	306.17	-305.14	25.80	0.41	
1855.00	18.200	175.600	1815.66	334.72	-333.65	27.28	1.19	
1946.00	18.600	176.300	1902.01	363.44	-362.30	29.31	0.50	
2037.00	18.000	174.900	1988.41	392.01	-390.79	31.49	0.82	
2128.00	16.900	174.600	2075.22	419.29	-417.96	33.99	1.21	
2219.00	17.600	178.800	2162.13	446.25	-444.89	35.52	1.57	
2309.00	17.600	178.400	2247.92	473.44	-472.09	36.19	0.13	
2400.00	16.700	174.600	2334.87	500.26	-498.86	37.80	1.58	
2491.00	15.600	178.100	2422.28	525.56	-524.11	39.44	1.61	
2582.00	14.800	179.100	2510.10	549.40	-547.96	40.02	0.93	
2672.00	17.100	175.600	2596.63	574.12	-572.65	41.22	2.77	
2763.00	15.900	178.100	2683.88	599.96	-598.45	42.66	1.53	
2854.00	16.200	171.800	2771.34	625.07	-623.47	44.88	1.94	
2945.00	15.600	169.600	2858.86	649.88	-648.07	48.90	0.93	
3036.00	16.300	170.700	2946.36	674.74	-672.71	53.18	0.84	
3126.00	16.600	174.600	3032.67	700.17	-697.97	56.43	1.27	
3217.00	17.500	177.000	3119.67	726.84	-724.58	58.37	1.26	
3308.00	17.500	181.300	3206.47	754.15	-751.92	58.77	1.42	
3399.00	16.900	179.500	3293.40	780.99	-778.83	58.58	0.88	
3490.00	16.100	182.000	3380.65	806.75	-804.67	58.25	1.18	
3581.00	16.800	178.400	3467.93	832.45	-830.42	58.18	1.36	
3671.00	17.000	179.500	3554.04	858.58	-856.58	58.66	0.42	
3762.00	16.000	174.600	3641.30	884.40	-882.37	59.95	1.88	
3853.00	15.800	175.600	3728.81	909.33	-907.21	62.08	0.37	
3944.00	17.100	173.900	3816.09	935.08	-932.87	64.46	1.52	



Actual Wellpath Report

DRY CREEK 22-27 AWB_awp

Page 3 of 5



INTEQ

REFERENCE WELLPATH IDENTIFICATION

Operator	KERR MCGEE OIL & GAS ONSHORE LP	Slot	SLOT#04 DRY CREEK 22-27 (1169'FNL & 1229'FWL)
Area	COLORADO	Well	DRY CREEK 22-27
Field	WELD COUNTY (KERR MCGEE)	Wellbore	DRY CREEK 22-27 AWB
Facility	SEC.27-T1N-R67W		

WELLPATH DATA (89 stations)

MD [ft]	Inclination [°]	Azimuth [°]	TVD [ft]	Vert Sect [ft]	North [ft]	East [ft]	DLS [°/100ft]	Comments
4034.00	18.300	176.700	3901.83	962.43	-960.13	66.68	1.63	
4125.00	17.000	180.200	3988.55	989.99	-987.70	67.45	1.84	
4216.00	15.600	177.400	4075.89	1015.50	-1013.23	67.96	1.76	
4307.00	14.500	182.600	4163.77	1039.06	-1036.83	68.00	1.91	
4397.00	14.700	172.800	4250.88	1061.66	-1059.42	68.92	2.75	
4488.00	15.900	168.900	4338.65	1085.55	-1083.11	72.77	1.74	
4579.00	18.100	171.400	4425.67	1112.00	-1109.32	77.28	2.55	
4670.00	17.900	167.900	4512.22	1139.92	-1136.97	82.33	1.21	
4760.00	15.800	172.400	4598.35	1165.83	-1162.64	86.85	2.75	
4851.00	15.400	176.000	4686.00	1190.27	-1186.98	89.33	1.15	
4942.00	16.700	177.400	4773.45	1215.43	-1212.09	90.76	1.49	
5033.00	18.000	178.700	4860.31	1242.55	-1239.21	91.68	1.49	
5123.00	18.900	183.000	4945.69	1270.92	-1267.67	91.23	1.81	
5214.00	19.000	180.900	5031.76	1300.33	-1297.20	90.23	0.76	
5305.00	16.700	180.200	5118.37	1328.14	-1325.09	89.95	2.54	
5396.00	14.800	177.300	5205.95	1352.81	-1349.78	90.45	2.26	
5486.00	12.900	174.900	5293.33	1374.35	-1371.27	91.88	2.21	
5577.00	11.800	172.100	5382.23	1393.78	-1390.61	94.07	1.38	
5668.00	9.900	171.000	5471.60	1410.85	-1407.55	96.57	2.10	
5759.00	8.800	169.200	5561.39	1425.55	-1422.12	99.10	1.25	
5849.00	5.900	163.000	5650.64	1436.89	-1433.30	101.74	3.34	
5940.00	3.600	151.400	5741.32	1444.03	-1440.29	104.47	2.73	
6031.00	3.200	151.700	5832.16	1448.93	-1445.03	107.05	0.44	
6122.00	1.100	167.500	5923.09	1452.11	-1448.12	108.44	2.38	
6213.00	1.500	9.700	6014.08	1451.81	-1447.80	108.83	2.80	
6304.00	0.900	11.800	6105.06	1449.96	-1445.93	109.18	0.66	
6394.00	0.400	18.200	6195.06	1448.99	-1444.94	109.42	0.56	
6485.00	0.300	281.400	6286.06	1448.63	-1444.59	109.28	0.58	
6576.00	0.700	316.300	6377.05	1448.15	-1444.14	108.67	0.53	
6712.00	1.000	339.400	6513.04	1446.37	-1442.43	107.68	0.33	
6848.00	1.400	340.500	6649.01	1443.64	-1439.75	106.70	0.29	
6984.00	1.400	344.300	6784.97	1440.42	-1436.58	105.70	0.07	
7120.00	1.200	331.000	6920.93	1437.50	-1433.74	104.56	0.27	
7256.00	1.300	325.300	7056.90	1434.89	-1431.23	102.99	0.12	
7392.00	1.300	324.600	7192.87	1432.26	-1428.70	101.22	0.01	
7528.00	1.100	321.200	7328.84	1429.88	-1426.42	99.51	0.16	
7664.00	0.900	338.700	7464.82	1427.79	-1424.41	98.30	0.27	
7800.00	0.600	334.500	7600.80	1426.11	-1422.77	97.61	0.22	
7936.00	0.700	354.900	7736.79	1424.62	-1421.30	97.23	0.18	
8072.00	0.900	344.700	7872.78	1422.74	-1419.45	96.87	0.18	
8210.00	0.900	353.500	8010.76	1420.60	-1417.32	96.46	0.10	
8346.00	1.000	355.800	8146.75	1418.34	-1415.08	96.25	0.08	
8460.00	1.000	12.500	8260.73	1416.39	-1413.12	96.40	0.25	Last BHI MWD Survey
8510.00	1.000	12.500	8310.72	1415.56	-1412.26	96.59	0.00	Projection To Bit



Actual Wellpath Report

DRY CREEK 22-27 AWB_awp

Page 4 of 5



INTEQ

REFERENCE WELLPATH IDENTIFICATION

Operator	KERR MCGEE OIL & GAS ONSHORE LP	Slot	SLOT#04 DRY CREEK 22-27 (1169'FNL & 1229'FWL)
Area	COLORADO	Well	DRY CREEK 22-27
Field	WELD COUNTY (KERR MCGEE)	Wellbore	DRY CREEK 22-27 AWB
Facility	SEC.27-T1N-R67W		

HOLE & CASING SECTIONS

Ref Wellbore: DRY CREEK 22-27 AWB Ref Wellpath: DRY CREEK 22-27 AWB_awp

String/Diameter	Start MD [ft]	End MD [ft]	Interval [ft]	Start TVD [ft]	End TVD [ft]	Start N/S [ft]	Start E/W [ft]	End N/S [ft]	End E/W [ft]
12.25in Open Hole	15.00	1172.00	1157.00	15.00	1157.36	0.00	0.00	-155.30	13.79
8.625in Casing Surface	15.00	1172.00	1157.00	15.00	1157.36	0.00	0.00	-155.30	13.79
7.875in Open Hole	1172.00	8520.00	7348.00	1157.36	NA	-155.30	13.79	NA	NA

TARGETS

Name	MD [ft]	TVD [ft]	North [ft]	East [ft]	Grid East [srv ft]	Grid North [srv ft]	Latitude	Longitude	Shape
DRY CREEK 22-27 GEO TARGET 50' RADIUS (2590'FNL & 1315'FWL, REV-1)		6000.00	-1420.72	92.42	3173247.92	1251548.95	40°01'20.028"N	104°52'53.004"W	circle
DRY CREEK 22-27 HARDLINE 56'S OF GEO TARGET		6000.00	-1476.72	92.42	3173248.30	1251492.96	40°01'19.475"N	104°52'53.004"W	point

WELLPATH COMPOSITION Ref Wellbore: DRY CREEK 22-27 AWB Ref Wellpath: DRY CREEK 22-27 AWB_awp

Start MD [ft]	End MD [ft]	Positional Uncertainty Model	Log Name/Comment	Wellbore
15.00	1130.00	NaviTrak (Standard)	BHi MWD SURVEYS 12.25 HOLE <0' - 1130'>	DRY CREEK 22-27 AWB
1130.00	8460.00	NaviTrak (Standard)	BHI MWD SURVEYS 7.875 HOLE <1220' - 8520'>	DRY CREEK 22-27 AWB
8460.00	8510.00	Blind Drilling (std)	Projection to bit	DRY CREEK 22-27 AWB



Actual Wellpath Report

DRY CREEK 22-27 AWB_awp

Page 5 of 5



INTEQ

REFERENCE WELLPATH IDENTIFICATION

Operator	KERR MCGEE OIL & GAS ONSHORE LP	Slot	SLOT#04 DRY CREEK 22-27 (1169'FNL & 1229'FWL)
Area	COLORADO	Well	DRY CREEK 22-27
Field	WELD COUNTY (KERR MCGEE)	Wellbore	DRY CREEK 22-27 AWB
Facility	SEC.27-T1N-R67W		

WELLPATH COMMENTS

MD [ft]	Inclination [°]	Azimuth [°]	TVD [ft]	Comment
8460.00	1.000	12.500	8260.73	Last BHI MWD Survey
8510.00	1.000	12.500	8310.72	Projection To Bit