

Lion Creek 13-06H

Section 6 T11N R64W

Weld County, CO

Surface Location

NAD 1927 (NADCON CONUS) Colorado North 501
 Ground Elevation: 5646.00 RIG @ 5668.00ft (TBD)
 Northing Easting Latitude Longitude
 587810.77 2253553.44 40° 56' 35.992 N 104° 34' 56.140 W

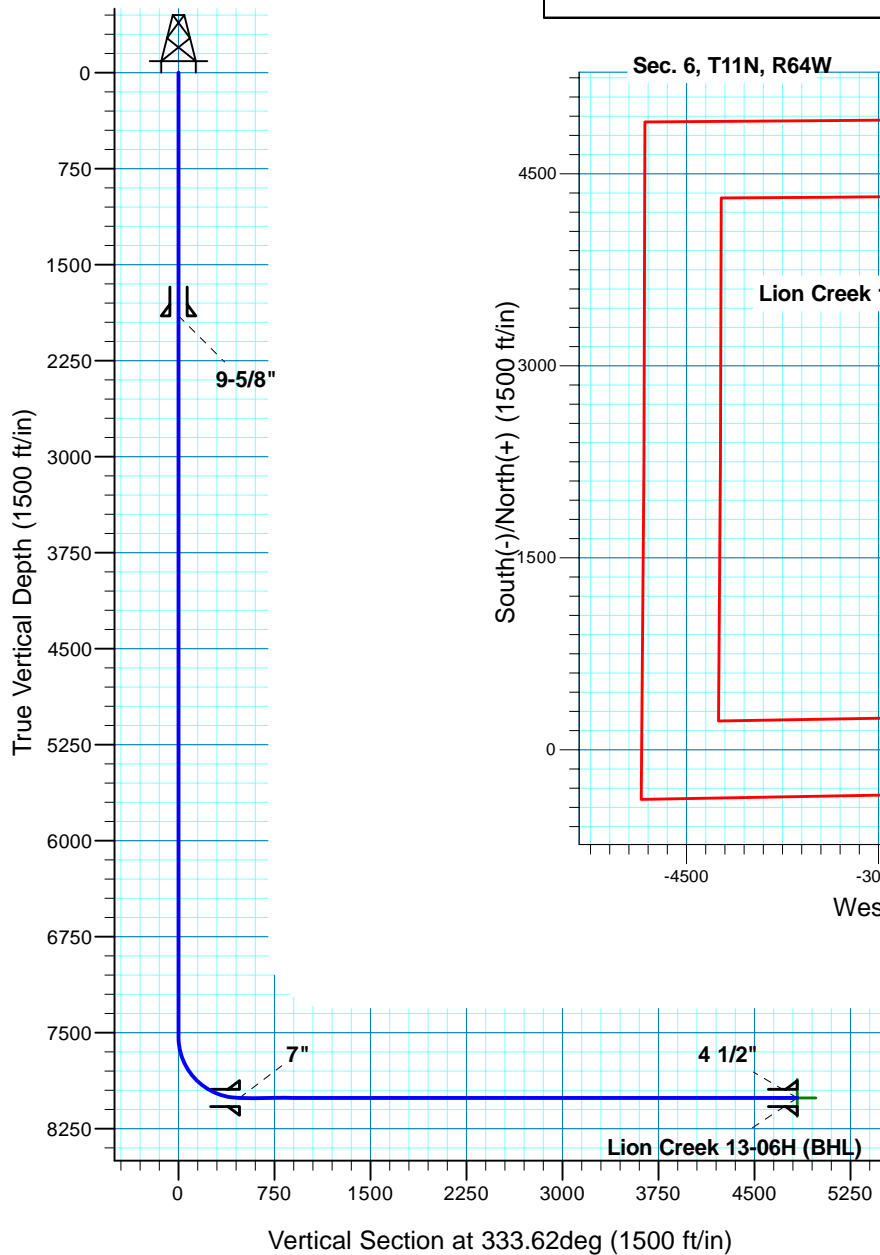

T M Azimuths to True North
 Magnetic North: 8.80°
 Magnetic Field
 Strength: 53475.4snT
 Dip Angle: 67.54°
 Date: 3/10/2011
 Model: IGRF200510

Project: DJ - Hereford Ranch
 Site: Lion Creek 13-06H
 Well: Lion Creek 13-06H
 Plan: APD Directional Plan

SECTION DETAILS

Sec	MD	Inc	Azi	TVD	+N/-S	+E/-W	DLeg	TFace	VSec	Target
1	0.00	0.00	0.00	0.00	0.00	0.00	0.00	0.00	0.00	
2	7532.53	0.00	0.00	7532.53	0.00	0.00	0.00	0.00	0.00	
3	8282.54	90.00	333.62	8010.00	427.74	-212.17	12.00	333.62	477.47	
4	12640.19	90.00	333.62	8010.00	4331.52	-2148.57	0.00	0.00	4835.12	Lion Creek 13-06H (BHL)

TARGET DETAILS

Name	TVD	+N/-S	+E/-W	Northing	Easting	Latitude	Longitude	Shape
Lion Creek 13-06H (BHL)	8010.00	4331.52	-2148.57	592119.81	2251360.16	40° 57' 18.788 N	104° 35' 24.140 W	Point

Denver Division- Colorado

DJ - Hereford Ranch

Lion Creek 13-06H

Lion Creek 13-06H

Original Wellbore

Plan: APD Directional Plan

Standard Planning Report

10 March, 2011

EOG Resources Inc

Planning Report

Database:	EDM	Local Co-ordinate Reference:	Site Lion Creek 13-06H
Company:	Denver Division- Colorado	TVD Reference:	RIG @ 5668.00ft (TBD)
Project:	DJ - Hereford Ranch	MD Reference:	RIG @ 5668.00ft (TBD)
Site:	Lion Creek 13-06H	North Reference:	True
Well:	Lion Creek 13-06H	Survey Calculation Method:	Minimum Curvature
Wellbore:	Original Wellbore		
Design:	APD Directional Plan		

Project	DJ - Hereford Ranch, Weld County		
Map System:	US State Plane 1927 (Exact solution)	System Datum:	Mean Sea Level
Geo Datum:	NAD 1927 (NADCON CONUS)		
Map Zone:	Colorado North 501		

Site	Lion Creek 13-06H		
Site Position:		Northing:	587,810.77 ft
From:	Lat/Long	Easting:	2,253,553.44 ft
Position Uncertainty:	0.00 ft	Slot Radius:	"
		Latitude:	40° 56' 35.992 N
		Longitude:	104° 34' 56.140 W
		Grid Convergence:	0.59 deg

Well	Lion Creek 13-06H		
Well Position	+N/-S	0.00 ft	Northing: 587,810.77 ft
	+E/-W	0.00 ft	Easting: 2,253,553.44 ft
Position Uncertainty	0.00 ft	Wellhead Elevation:	ft
		Latitude:	40° 56' 35.992 N
		Longitude:	104° 34' 56.140 W
		Ground Level:	5,646.00 ft

Wellbore	Original Wellbore				
Magnetics	Model Name	Sample Date	Declination (deg)	Dip Angle (deg)	Field Strength (nT)
	IGRF200510	3/10/2011	8.80	67.54	53,475

Design	APD Directional Plan				
Audit Notes:					
Version:	Phase:	PROTOTYPE	Tie On Depth:	0.00	
Vertical Section:	Depth From (TVD) (ft)	+N/-S (ft)	+E/-W (ft)	Direction (deg)	
	0.00	0.00	0.00	333.62	

Plan Sections										
Measured Depth (ft)	Inclination (deg)	Azimuth (deg)	Vertical Depth (ft)	+N/-S (ft)	+E/-W (ft)	Dogleg Rate (?/100ft)	Build Rate (?/100ft)	Turn Rate (?/100ft)	TFO (deg)	Target
0.00	0.00	0.00	0.00	0.00	0.00	0.00	0.00	0.00	0.00	
7,532.53	0.00	0.00	7,532.53	0.00	0.00	0.00	0.00	0.00	0.00	
8,282.54	90.00	333.62	8,010.00	427.74	-212.17	12.00	12.00	0.00	333.62	
12,640.19	90.00	333.62	8,010.00	4,331.52	-2,148.57	0.00	0.00	0.00	0.00	Lion Creek 13-06H

EOG Resources Inc

Planning Report

Database:	EDM	Local Co-ordinate Reference:	Site Lion Creek 13-06H
Company:	Denver Division- Colorado	TVD Reference:	RIG @ 5668.00ft (TBD)
Project:	DJ - Hereford Ranch	MD Reference:	RIG @ 5668.00ft (TBD)
Site:	Lion Creek 13-06H	North Reference:	True
Well:	Lion Creek 13-06H	Survey Calculation Method:	Minimum Curvature
Wellbore:	Original Wellbore		
Design:	APD Directional Plan		

Planned Survey

Measured Depth (ft)	Inclination (deg)	Azimuth (deg)	Vertical Depth (ft)	+N/-S (ft)	+E/-W (ft)	Vertical Section (ft)	Dogleg Rate (?/100ft)	Build Rate (?/100ft)	Turn Rate (?/100ft)
0.00	0.00	0.00	0.00	0.00	0.00	0.00	0.00	0.00	0.00
100.00	0.00	0.00	100.00	0.00	0.00	0.00	0.00	0.00	0.00
200.00	0.00	0.00	200.00	0.00	0.00	0.00	0.00	0.00	0.00
300.00	0.00	0.00	300.00	0.00	0.00	0.00	0.00	0.00	0.00
400.00	0.00	0.00	400.00	0.00	0.00	0.00	0.00	0.00	0.00
500.00	0.00	0.00	500.00	0.00	0.00	0.00	0.00	0.00	0.00
600.00	0.00	0.00	600.00	0.00	0.00	0.00	0.00	0.00	0.00
700.00	0.00	0.00	700.00	0.00	0.00	0.00	0.00	0.00	0.00
800.00	0.00	0.00	800.00	0.00	0.00	0.00	0.00	0.00	0.00
900.00	0.00	0.00	900.00	0.00	0.00	0.00	0.00	0.00	0.00
1,000.00	0.00	0.00	1,000.00	0.00	0.00	0.00	0.00	0.00	0.00
1,100.00	0.00	0.00	1,100.00	0.00	0.00	0.00	0.00	0.00	0.00
1,200.00	0.00	0.00	1,200.00	0.00	0.00	0.00	0.00	0.00	0.00
1,300.00	0.00	0.00	1,300.00	0.00	0.00	0.00	0.00	0.00	0.00
1,400.00	0.00	0.00	1,400.00	0.00	0.00	0.00	0.00	0.00	0.00
1,500.00	0.00	0.00	1,500.00	0.00	0.00	0.00	0.00	0.00	0.00
1,600.00	0.00	0.00	1,600.00	0.00	0.00	0.00	0.00	0.00	0.00
1,700.00	0.00	0.00	1,700.00	0.00	0.00	0.00	0.00	0.00	0.00
1,800.00	0.00	0.00	1,800.00	0.00	0.00	0.00	0.00	0.00	0.00
1,900.00	0.00	0.00	1,900.00	0.00	0.00	0.00	0.00	0.00	0.00
9-5/8"									
2,000.00	0.00	0.00	2,000.00	0.00	0.00	0.00	0.00	0.00	0.00
2,100.00	0.00	0.00	2,100.00	0.00	0.00	0.00	0.00	0.00	0.00
2,200.00	0.00	0.00	2,200.00	0.00	0.00	0.00	0.00	0.00	0.00
2,300.00	0.00	0.00	2,300.00	0.00	0.00	0.00	0.00	0.00	0.00
2,400.00	0.00	0.00	2,400.00	0.00	0.00	0.00	0.00	0.00	0.00
2,500.00	0.00	0.00	2,500.00	0.00	0.00	0.00	0.00	0.00	0.00
2,600.00	0.00	0.00	2,600.00	0.00	0.00	0.00	0.00	0.00	0.00
2,700.00	0.00	0.00	2,700.00	0.00	0.00	0.00	0.00	0.00	0.00
2,800.00	0.00	0.00	2,800.00	0.00	0.00	0.00	0.00	0.00	0.00
2,900.00	0.00	0.00	2,900.00	0.00	0.00	0.00	0.00	0.00	0.00
3,000.00	0.00	0.00	3,000.00	0.00	0.00	0.00	0.00	0.00	0.00
3,100.00	0.00	0.00	3,100.00	0.00	0.00	0.00	0.00	0.00	0.00
3,200.00	0.00	0.00	3,200.00	0.00	0.00	0.00	0.00	0.00	0.00
3,300.00	0.00	0.00	3,300.00	0.00	0.00	0.00	0.00	0.00	0.00
3,400.00	0.00	0.00	3,400.00	0.00	0.00	0.00	0.00	0.00	0.00
3,500.00	0.00	0.00	3,500.00	0.00	0.00	0.00	0.00	0.00	0.00
3,600.00	0.00	0.00	3,600.00	0.00	0.00	0.00	0.00	0.00	0.00
3,700.00	0.00	0.00	3,700.00	0.00	0.00	0.00	0.00	0.00	0.00
3,800.00	0.00	0.00	3,800.00	0.00	0.00	0.00	0.00	0.00	0.00
3,900.00	0.00	0.00	3,900.00	0.00	0.00	0.00	0.00	0.00	0.00
4,000.00	0.00	0.00	4,000.00	0.00	0.00	0.00	0.00	0.00	0.00
4,100.00	0.00	0.00	4,100.00	0.00	0.00	0.00	0.00	0.00	0.00
4,200.00	0.00	0.00	4,200.00	0.00	0.00	0.00	0.00	0.00	0.00
4,300.00	0.00	0.00	4,300.00	0.00	0.00	0.00	0.00	0.00	0.00
4,400.00	0.00	0.00	4,400.00	0.00	0.00	0.00	0.00	0.00	0.00
4,500.00	0.00	0.00	4,500.00	0.00	0.00	0.00	0.00	0.00	0.00
4,600.00	0.00	0.00	4,600.00	0.00	0.00	0.00	0.00	0.00	0.00
4,700.00	0.00	0.00	4,700.00	0.00	0.00	0.00	0.00	0.00	0.00
4,800.00	0.00	0.00	4,800.00	0.00	0.00	0.00	0.00	0.00	0.00
4,900.00	0.00	0.00	4,900.00	0.00	0.00	0.00	0.00	0.00	0.00
5,000.00	0.00	0.00	5,000.00	0.00	0.00	0.00	0.00	0.00	0.00
5,100.00	0.00	0.00	5,100.00	0.00	0.00	0.00	0.00	0.00	0.00

EOG Resources Inc

Planning Report

Database:	EDM	Local Co-ordinate Reference:	Site Lion Creek 13-06H
Company:	Denver Division- Colorado	TVD Reference:	RIG @ 5668.00ft (TBD)
Project:	DJ - Hereford Ranch	MD Reference:	RIG @ 5668.00ft (TBD)
Site:	Lion Creek 13-06H	North Reference:	True
Well:	Lion Creek 13-06H	Survey Calculation Method:	Minimum Curvature
Wellbore:	Original Wellbore		
Design:	APD Directional Plan		

Planned Survey

Measured Depth (ft)	Inclination (deg)	Azimuth (deg)	Vertical Depth (ft)	+N/-S (ft)	+E/-W (ft)	Vertical Section (ft)	Dogleg Rate (?/100ft)	Build Rate (?/100ft)	Turn Rate (?/100ft)
5,200.00	0.00	0.00	5,200.00	0.00	0.00	0.00	0.00	0.00	0.00
5,300.00	0.00	0.00	5,300.00	0.00	0.00	0.00	0.00	0.00	0.00
5,400.00	0.00	0.00	5,400.00	0.00	0.00	0.00	0.00	0.00	0.00
5,500.00	0.00	0.00	5,500.00	0.00	0.00	0.00	0.00	0.00	0.00
5,600.00	0.00	0.00	5,600.00	0.00	0.00	0.00	0.00	0.00	0.00
5,700.00	0.00	0.00	5,700.00	0.00	0.00	0.00	0.00	0.00	0.00
5,800.00	0.00	0.00	5,800.00	0.00	0.00	0.00	0.00	0.00	0.00
5,900.00	0.00	0.00	5,900.00	0.00	0.00	0.00	0.00	0.00	0.00
6,000.00	0.00	0.00	6,000.00	0.00	0.00	0.00	0.00	0.00	0.00
6,100.00	0.00	0.00	6,100.00	0.00	0.00	0.00	0.00	0.00	0.00
6,200.00	0.00	0.00	6,200.00	0.00	0.00	0.00	0.00	0.00	0.00
6,300.00	0.00	0.00	6,300.00	0.00	0.00	0.00	0.00	0.00	0.00
6,400.00	0.00	0.00	6,400.00	0.00	0.00	0.00	0.00	0.00	0.00
6,500.00	0.00	0.00	6,500.00	0.00	0.00	0.00	0.00	0.00	0.00
6,600.00	0.00	0.00	6,600.00	0.00	0.00	0.00	0.00	0.00	0.00
6,700.00	0.00	0.00	6,700.00	0.00	0.00	0.00	0.00	0.00	0.00
6,800.00	0.00	0.00	6,800.00	0.00	0.00	0.00	0.00	0.00	0.00
6,900.00	0.00	0.00	6,900.00	0.00	0.00	0.00	0.00	0.00	0.00
7,000.00	0.00	0.00	7,000.00	0.00	0.00	0.00	0.00	0.00	0.00
7,100.00	0.00	0.00	7,100.00	0.00	0.00	0.00	0.00	0.00	0.00
7,200.00	0.00	0.00	7,200.00	0.00	0.00	0.00	0.00	0.00	0.00
7,300.00	0.00	0.00	7,300.00	0.00	0.00	0.00	0.00	0.00	0.00
7,400.00	0.00	0.00	7,400.00	0.00	0.00	0.00	0.00	0.00	0.00
7,500.00	0.00	0.00	7,500.00	0.00	0.00	0.00	0.00	0.00	0.00
7,532.53	0.00	0.00	7,532.53	0.00	0.00	0.00	0.00	0.00	0.00
7,600.00	8.10	333.62	7,599.78	4.26	-2.11	4.76	12.00	12.00	0.00
7,700.00	20.10	333.62	7,696.59	26.04	-12.92	29.07	12.00	12.00	0.00
7,800.00	32.10	333.62	7,786.23	65.37	-32.43	72.98	12.00	12.00	0.00
7,900.00	44.10	333.62	7,864.78	120.55	-59.79	134.56	12.00	12.00	0.00
8,000.00	56.10	333.62	7,928.82	189.14	-93.82	211.13	12.00	12.00	0.00
8,100.00	68.10	333.62	7,975.53	268.17	-133.02	299.34	12.00	12.00	0.00
8,200.00	80.10	333.62	8,002.88	354.16	-175.68	395.34	12.00	12.00	0.00
8,282.54	90.00	333.62	8,010.00	427.74	-212.17	477.47	12.00	12.00	0.00
7"									
8,300.00	90.00	333.62	8,010.00	443.38	-219.93	494.93	0.00	0.00	0.00
8,400.00	90.00	333.62	8,010.00	532.96	-264.37	594.93	0.00	0.00	0.00
8,500.00	90.00	333.62	8,010.00	622.55	-308.80	694.93	0.00	0.00	0.00
8,600.00	90.00	333.62	8,010.00	712.13	-353.24	794.93	0.00	0.00	0.00
8,700.00	90.00	333.62	8,010.00	801.72	-397.68	894.93	0.00	0.00	0.00
8,800.00	90.00	333.62	8,010.00	891.30	-442.12	994.93	0.00	0.00	0.00
8,900.00	90.00	333.62	8,010.00	980.89	-486.55	1,094.93	0.00	0.00	0.00
9,000.00	90.00	333.62	8,010.00	1,070.47	-530.99	1,194.93	0.00	0.00	0.00
9,100.00	90.00	333.62	8,010.00	1,160.06	-575.43	1,294.93	0.00	0.00	0.00
9,200.00	90.00	333.62	8,010.00	1,249.64	-619.86	1,394.93	0.00	0.00	0.00
9,300.00	90.00	333.62	8,010.00	1,339.22	-664.30	1,494.93	0.00	0.00	0.00
9,400.00	90.00	333.62	8,010.00	1,428.81	-708.74	1,594.93	0.00	0.00	0.00
9,500.00	90.00	333.62	8,010.00	1,518.39	-753.17	1,694.93	0.00	0.00	0.00
9,600.00	90.00	333.62	8,010.00	1,607.98	-797.61	1,794.93	0.00	0.00	0.00
9,700.00	90.00	333.62	8,010.00	1,697.56	-842.05	1,894.93	0.00	0.00	0.00
9,800.00	90.00	333.62	8,010.00	1,787.15	-886.48	1,994.93	0.00	0.00	0.00
9,900.00	90.00	333.62	8,010.00	1,876.73	-930.92	2,094.93	0.00	0.00	0.00
10,000.00	90.00	333.62	8,010.00	1,966.32	-975.36	2,194.93	0.00	0.00	0.00
10,100.00	90.00	333.62	8,010.00	2,055.90	-1,019.79	2,294.93	0.00	0.00	0.00

EOG Resources Inc

Planning Report

Database:	EDM	Local Co-ordinate Reference:	Site Lion Creek 13-06H
Company:	Denver Division- Colorado	TVD Reference:	RIG @ 5668.00ft (TBD)
Project:	DJ - Hereford Ranch	MD Reference:	RIG @ 5668.00ft (TBD)
Site:	Lion Creek 13-06H	North Reference:	True
Well:	Lion Creek 13-06H	Survey Calculation Method:	Minimum Curvature
Wellbore:	Original Wellbore		
Design:	APD Directional Plan		

Planned Survey

Measured Depth (ft)	Inclination (deg)	Azimuth (deg)	Vertical Depth (ft)	+N/-S (ft)	+E/-W (ft)	Vertical Section (ft)	Dogleg Rate (?/100ft)	Build Rate (?/100ft)	Turn Rate (?/100ft)
10,200.00	90.00	333.62	8,010.00	2,145.48	-1,064.23	2,394.93	0.00	0.00	0.00
10,300.00	90.00	333.62	8,010.00	2,235.07	-1,108.67	2,494.93	0.00	0.00	0.00
10,400.00	90.00	333.62	8,010.00	2,324.65	-1,153.10	2,594.93	0.00	0.00	0.00
10,500.00	90.00	333.62	8,010.00	2,414.24	-1,197.54	2,694.93	0.00	0.00	0.00
10,600.00	90.00	333.62	8,010.00	2,503.82	-1,241.98	2,794.93	0.00	0.00	0.00
10,700.00	90.00	333.62	8,010.00	2,593.41	-1,286.41	2,894.93	0.00	0.00	0.00
10,800.00	90.00	333.62	8,010.00	2,682.99	-1,330.85	2,994.93	0.00	0.00	0.00
10,900.00	90.00	333.62	8,010.00	2,772.58	-1,375.29	3,094.93	0.00	0.00	0.00
11,000.00	90.00	333.62	8,010.00	2,862.16	-1,419.72	3,194.93	0.00	0.00	0.00
11,100.00	90.00	333.62	8,010.00	2,951.74	-1,464.16	3,294.93	0.00	0.00	0.00
11,200.00	90.00	333.62	8,010.00	3,041.33	-1,508.60	3,394.93	0.00	0.00	0.00
11,300.00	90.00	333.62	8,010.00	3,130.91	-1,553.03	3,494.93	0.00	0.00	0.00
11,400.00	90.00	333.62	8,010.00	3,220.50	-1,597.47	3,594.93	0.00	0.00	0.00
11,500.00	90.00	333.62	8,010.00	3,310.08	-1,641.91	3,694.93	0.00	0.00	0.00
11,600.00	90.00	333.62	8,010.00	3,399.67	-1,686.35	3,794.93	0.00	0.00	0.00
11,700.00	90.00	333.62	8,010.00	3,489.25	-1,730.78	3,894.93	0.00	0.00	0.00
11,800.00	90.00	333.62	8,010.00	3,578.84	-1,775.22	3,994.93	0.00	0.00	0.00
11,900.00	90.00	333.62	8,010.00	3,668.42	-1,819.66	4,094.93	0.00	0.00	0.00
12,000.00	90.00	333.62	8,010.00	3,758.00	-1,864.09	4,194.93	0.00	0.00	0.00
12,100.00	90.00	333.62	8,010.00	3,847.59	-1,908.53	4,294.93	0.00	0.00	0.00
12,200.00	90.00	333.62	8,010.00	3,937.17	-1,952.97	4,394.93	0.00	0.00	0.00
12,300.00	90.00	333.62	8,010.00	4,026.76	-1,997.40	4,494.93	0.00	0.00	0.00
12,400.00	90.00	333.62	8,010.00	4,116.34	-2,041.84	4,594.93	0.00	0.00	0.00
12,500.00	90.00	333.62	8,010.00	4,205.93	-2,086.28	4,694.93	0.00	0.00	0.00
12,600.00	90.00	333.62	8,010.00	4,295.51	-2,130.71	4,794.93	0.00	0.00	0.00
12,640.19	90.00	333.62	8,010.00	4,331.52	-2,148.57	4,835.12	0.00	0.00	0.00

4 1/2" - Lion Creek 13-06H (BHL)

Targets

Target Name	Dip Angle (deg)	Dip Dir. (deg)	TVD (ft)	+N/-S (ft)	+E/-W (ft)	Northing (ft)	Easting (ft)	Latitude	Longitude
- hit/miss target									
- Shape									
Lion Creek 13-06H (B	0.00	0.00	8,010.00	4,331.52	-2,148.57	592,119.81	2,251,360.16	40° 57' 18.788 N	104° 35' 24.140 W
- plan hits target center									
- Point									

Casing Points

Measured Depth (ft)	Vertical Depth (ft)	Name	Casing Diameter (")	Hole Diameter (")
1,900.00	1,900.00	9-5/8"	9-5/8	13-1/2
8,282.54	8,010.00	7"	7	8-3/4
12,640.19	8,010.00	4 1/2"	4-1/2	6