

FND 3.25" AC  
PLS #37929

S 89°53'54" E 5256.74'

S00°13'53"W  
5336.49'

FOUND 3.25" AC  
PLS #26600

PROTRACTED  
POSITION  
PER G.L.O. MAP  
DATED 1/20/1871

N 00°17'01" E 5322.73'

24

S 00°13'53" W 5336.49'  
(BASIS OF BEARINGS)

T 11 N  
R 54 W  
LOGAN  
COUNTY

SWSW

658'

666'

NAD 83  
LAT = 40.90795°N  
LON = 103.36025°W  
P.D.O.P. = 2.1  
GPS OPERATOR= C.VANMATRE

PROTRACTED  
PER G.L.O. MAP  
DATED 1/20/1871

N 89°44'54" W 5261.57'

S00°13'53"W  
5336.49'

PROTRACTED  
POSITION  
PER G.L.O. MAP  
DATED 1/20/1871

FOUND #6 REBAR  
SET 3.25" AC  
PLS #37929

WELL: MAX 14-24 TO BE LOCATED 658' FWL AND 666' FSL IN SECTION 24, TOWNSHIP 11 NORTH, RANGE 54 WEST OF THE 6TH P.M.  
LOCATION FALLS IN: NATURAL GROUND GROUND ELEVATION = 4281' IMPROVEMENTS: NONE WITHIN 200' OF LOCATION

**LEGEND:**

- SECTION CORNER (AS NOTED)
- ▼ PROPOSED WELL LOCATION

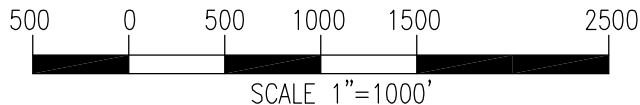

**NOTES:**

1. THIS SURVEY WAS DONE BY GPS METHODS AND CONFORMS TO THE MINIMUM STANDARDS AS SET BY THE C.O.G.C.C. RULE NO. 215.
2. ELEVATIONS SHOWN AT THE WELL HEAD, AS WELL AS HORIZONTAL CONTROL, ARE BASED ON GPS-RTK VALUES DERIVED FROM DOING 2-HOUR STATIC GPS SESSIONS AND REDUCTIONS USING O.P.U.S. SOLUTIONS.  
VERTICAL = NAVD88 HORIZONTAL = NAD83/92
3. THE BEARINGS AS SHOWN HEREON ARE BASED ON GPS OBSERVATIONS BETWEEN THE MONUMENTS SHOWN HEREON AS FOUND IN THE FIELD DATE BELOW.
4. DISTANCES SHOWN ARE AT GROUND LEVEL, AS MEASURED IN THE FIELD, WITH TIES TO WELLS MEASURED AT A PERPENDICULAR TO SECTION LINES.

I, RICHARD B. GABRIEL, A LICENSED PROFESSIONAL LAND SURVEYOR IN THE STATE OF COLORADO DO HEREBY CERTIFY TO:

**SINGLETREE RESOURCES / DOUD BTS** THAT THE SURVEY AND WELL LOCATION CERTIFICATE SHOWN HEREON WAS DONE BY ME OR UNDER MY DIRECT SUPERVISION AND THAT THE DRAWING SHOWN HEREON ACCURATELY DEPICTS THE PROPOSED LOCATION OF THE WELL **MAX 14-24**.  
THIS CERTIFICATE DOES NOT REPRESENT A LAND SURVEY PLAT OR IMPROVEMENT SURVEY PLAT AS DEFINED BY C.R.S. 38-51-102 AND CANNOT BE RELIED UPON TO DETERMINE OWNERSHIP.

RICHARD B. GABRIEL P.L.S. #37929  
COLORADO LICENSED PROFESSIONAL LAND SURVEYOR  
FOR AND ON BEHALF OF POWER SURVEYING CO., INC.

NOTICE: ACCORDING TO COLORADO LAW YOU MUST COMMENCE ANY LEGAL ACTION BASED UPON ANY DEFECT IN THIS SURVEY WITHIN THREE YEARS AFTER YOU FIRST DISCOVER SUCH DEFECT. IN NO EVENT MAY ANY ACTION BASED ON ANY DEFECT IN THIS SURVEY BE COMMENCED MORE THAN TEN YEARS FROM THIS SAID DATE OF THIS CERTIFICATION SHOWN HEREON.

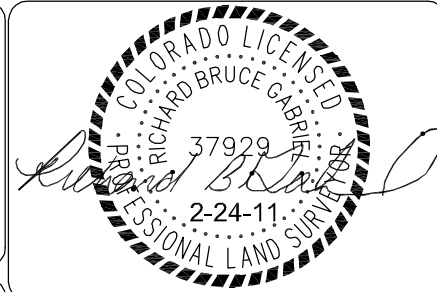

**POWER**™  
Surveying Company, Inc.  
Established 1948

120 W. 84TH AVENUE PH. 303-702-1617  
THORNTON, COLORADO 80260 FAX. 303-702-1488  
WWW.POWERSURVEYING.COM

DATE OF FIELD WORK: 2-23-2011  
DATE OF COMPLETION: 2-24-11  
PROJECT NUMBER: 501-11-018A