

# VISIBLE IMPROVEMENTS PRATT 41-29D

SECTION 29  
TOWNSHIP 1 NORTH  
RANGE 68 WEST

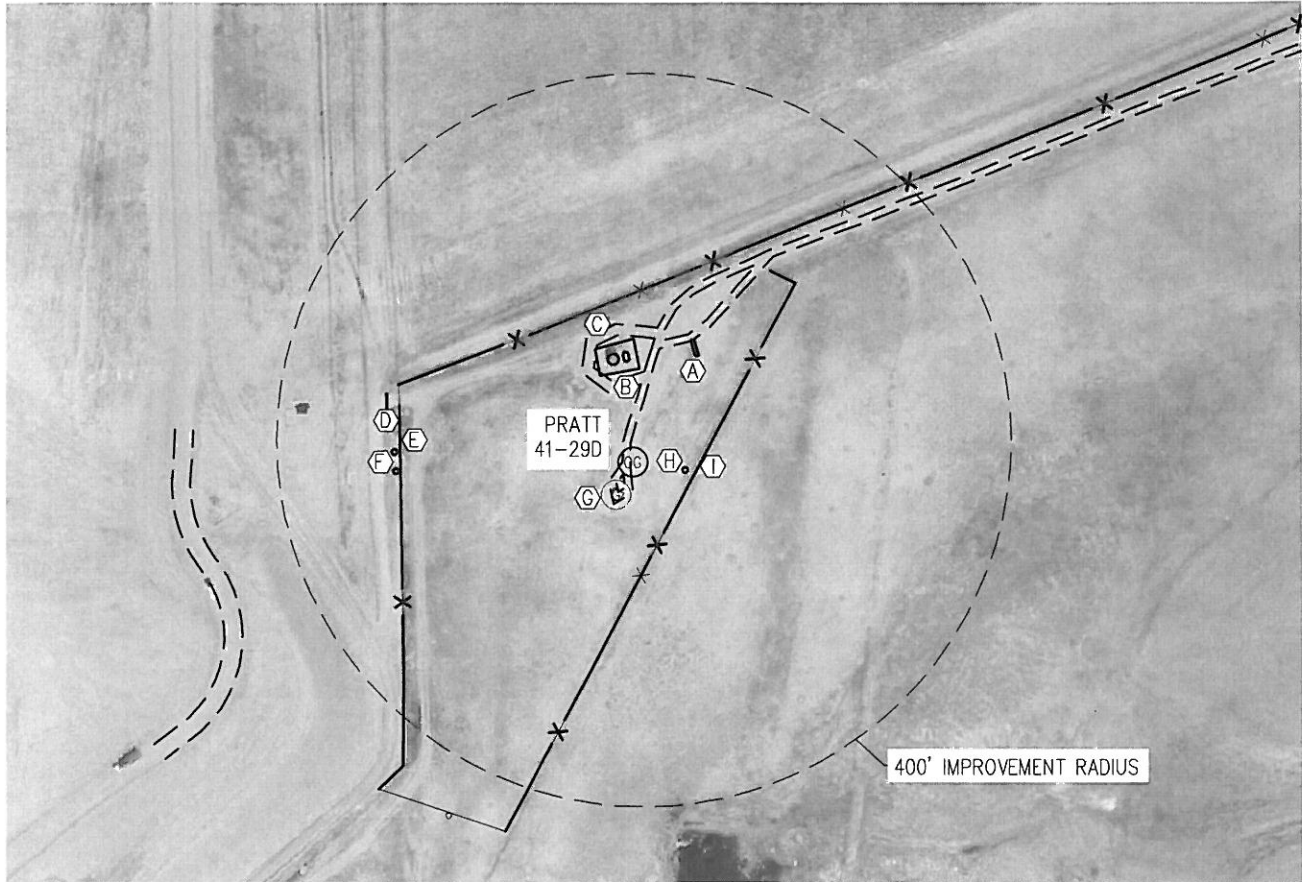

## IMPROVEMENTS:

- (A) EXISTING SEPARATOR: 134' NE
- (B) EXISTING TANK BATTERY: 99' N
- (C) EXISTING FENCE: 171' NW
- (D) EXISTING CULVERT: 275' W
- (E) EXISTING FENCE: 254' W
- (F) EXISTING MONITORING WELLS: 259' W
- (G) EXISTING WELL (M.E. DRIER NO. 1): 40' SW
- (H) EXISTING MONITORING WELL: 57' S
- (I) EXISTING FENCE: 65' SE

## NOTE

The size, type and location of underground utilities shown hereon are approximate, and are based on markings made by utility locate companies. It is not guaranteed that all utilities have been located. It shall be the responsibility of the contractor to verify the existence of all underground utilities in the area of the work before commencing new construction.

