

CONSTRUCTION LAYOUT DRAWING

1 of 3

PAD 350'X425' ELEV=5125.0'			
DISTURBED AREA=4.7± ACRES			
ESTIMATED DIRT QUANTITIES			
CUTx10%	FILL	TOPSOIL	EXCESS
8,800	5,800	2,980	20
NOTE: VOLUMES IN CUBIC YARDS. TOPSOIL INCLUDED IN VOLUMES AT A DEPTH OF 6". TRENCH NOT INCLUDED IN TOTAL EXCESS.			

VEGETATION:
DISTURBED GRASSLAND

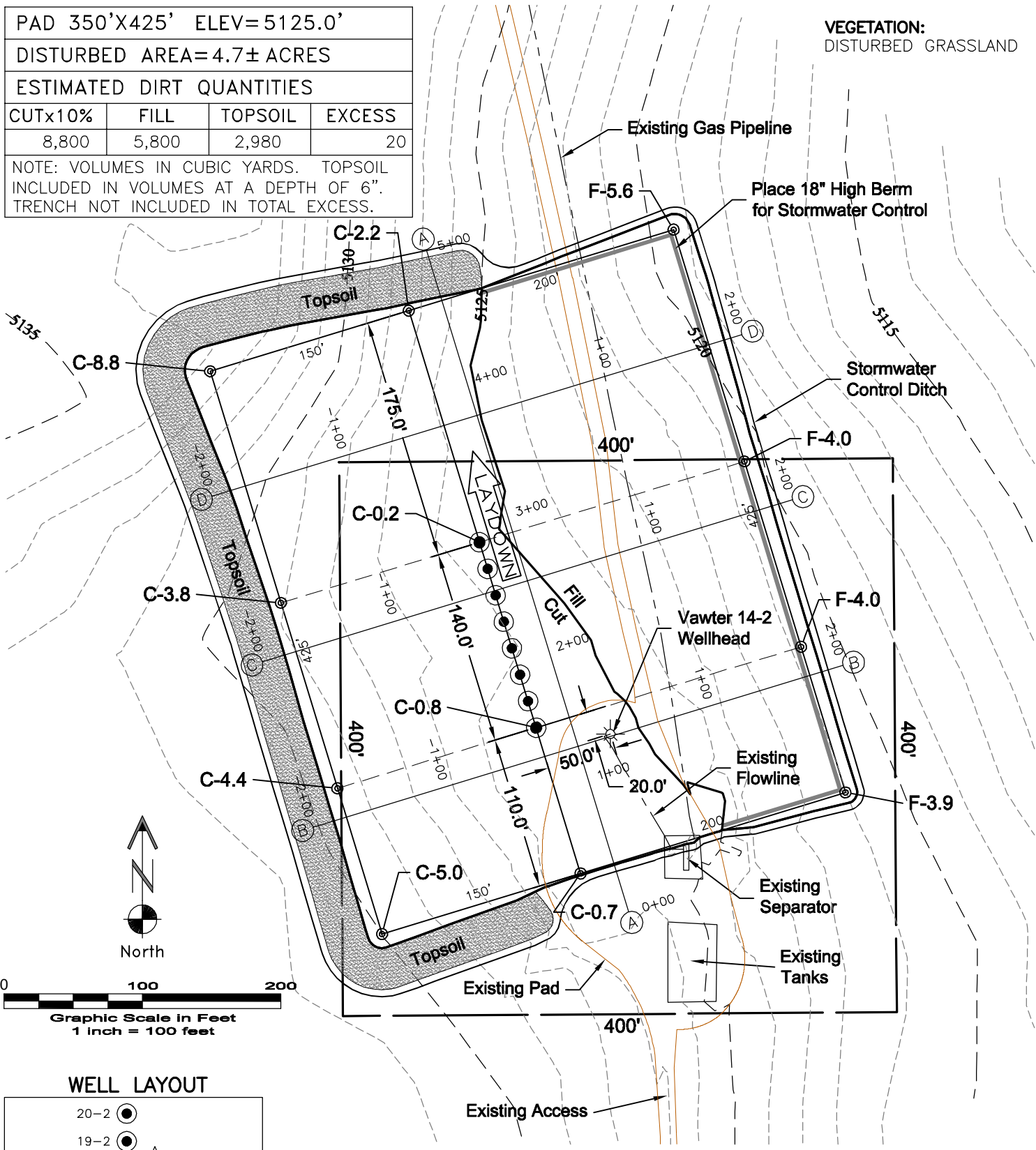

WELL LAYOUT

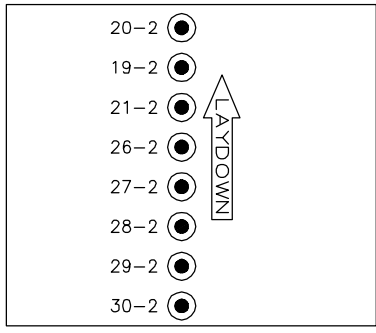

1/31/11

GEO SURV
LAND SURVEYING AND MAPPING
LAFAYETTE - WINTER PARK
Ph 303 666 0379 Fx 303 665 6320

ENPROP, INC.
VAWTER 14-2 PAD

SE1/4 SW1/4 SEC. 2 T1N R66W
6th PM WELD COUNTY COLORADO

DWG: G:\GEO SURV\Weld\North\Enprop Inc\Wawter 14-2 Pad\F2A.dwg USER: MTC DATE: Jan 31, 2011 2:06pm

CONSTRUCTION LAYOUT DRAWING

2 of 3

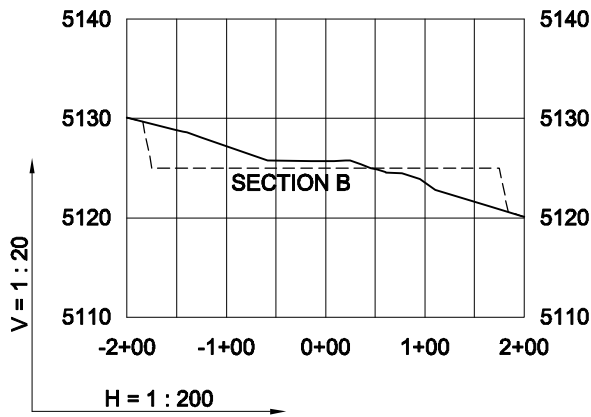
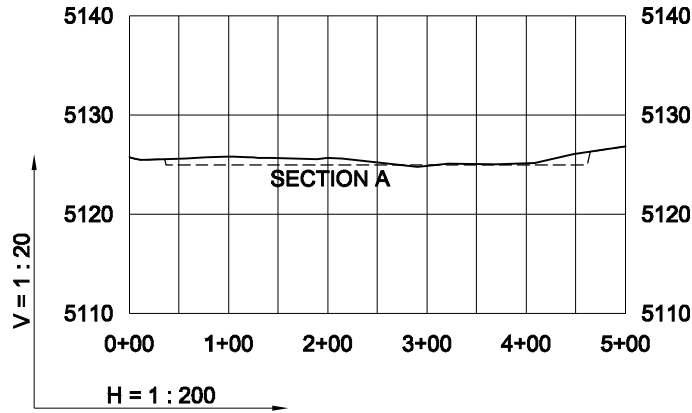

----- Existing Ground
 _____ Proposed Grade

GEO SURV

LAND SURVEYING AND MAPPING
 LAFAYETTE - WINTER PARK
 Ph 303 666 0379 Fx 303 665 6320

ENPROP, INC.
VAWTER 14-2 PAD

SE1/4 SW1/4 SEC. 2 T1N R66W
6th PM WELD COUNTY COLORADO

1/31/11

DWG: G:\GEO SURV\Weld\North\Enprop 14-2 Pad\Wawter 14-2 F2A.dwg USER: MTC DATE: Jan 31, 2011 2:06pm

CONSTRUCTION LAYOUT DRAWING

3 of 3

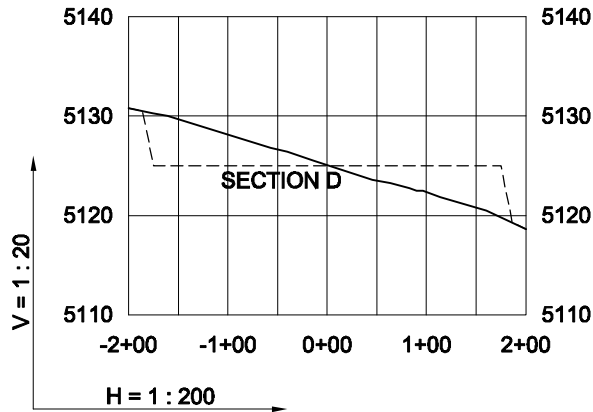
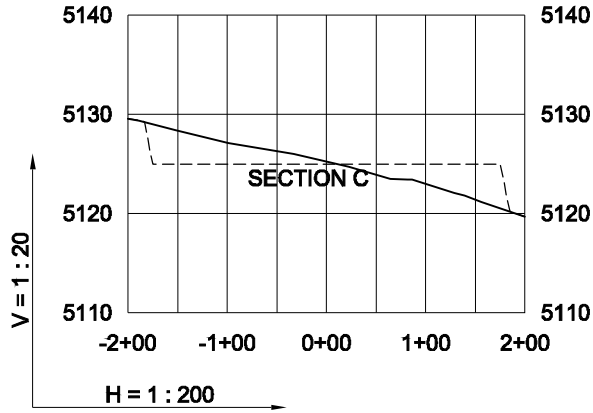

1/31/11

----- Existing Ground
 _____ Proposed Grade

GEO SURV

LAND SURVEYING AND MAPPING
 LAFAYETTE - WINTER PARK
 Ph 303 666 0379 Fx 303 665 6320

ENPROP, INC.
VAWTER 14-2 PAD

SE1/4 SW1/4 SEC. 2 T1N R66W
6th PM WELD COUNTY COLORADO