

ACCESS ROAD - TOPO

PART OF THE SW1/4, SEC 32, TOWNSHIP 7 NORTH, RANGE 66 WEST, 6TH P.M.

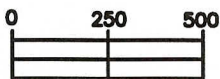
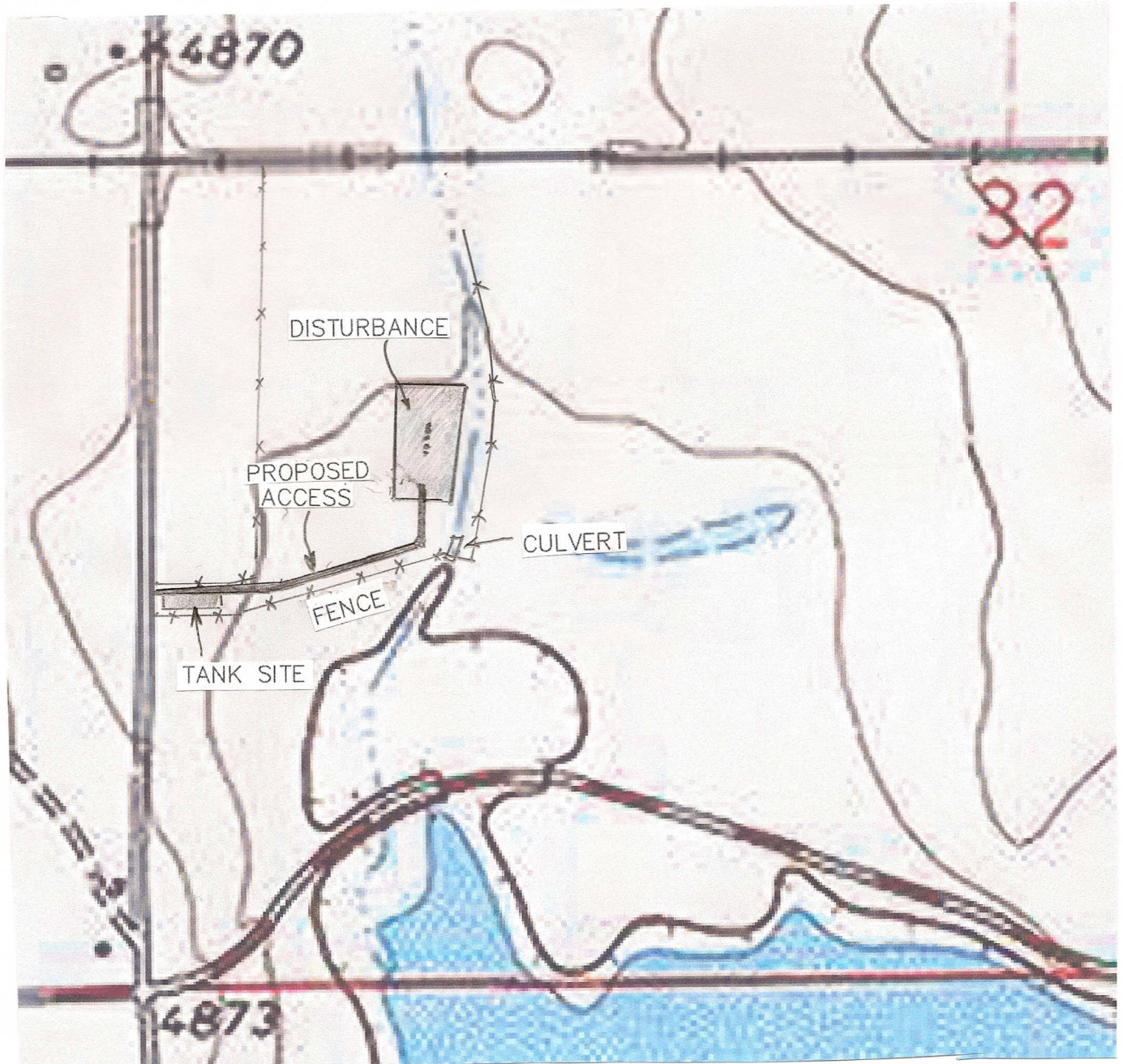

SCALE 1" = 500'

PREPARED BY:

HORSESHOE SURVEYING, LLC
PO BOX 150458
LAKEWOOD, CO 80215
(720)872-0196

DRAWING DATE:

3-1-11

FIELD DATE:

12-10-10

BY:

TGC

WELL NAME:

(5 WELL PAD)

NELSON 13-32D, 23-32D, 14-32D, 24-32D, 32BD

LOCATION:

WELD COUNTY, CO

SW1/4, SEC. 32, T7N, R66W, 6TH P.M.