



Lat40°, LLC

1635 Foxtrail Drive, Suite 325

Loveland, CO 80538



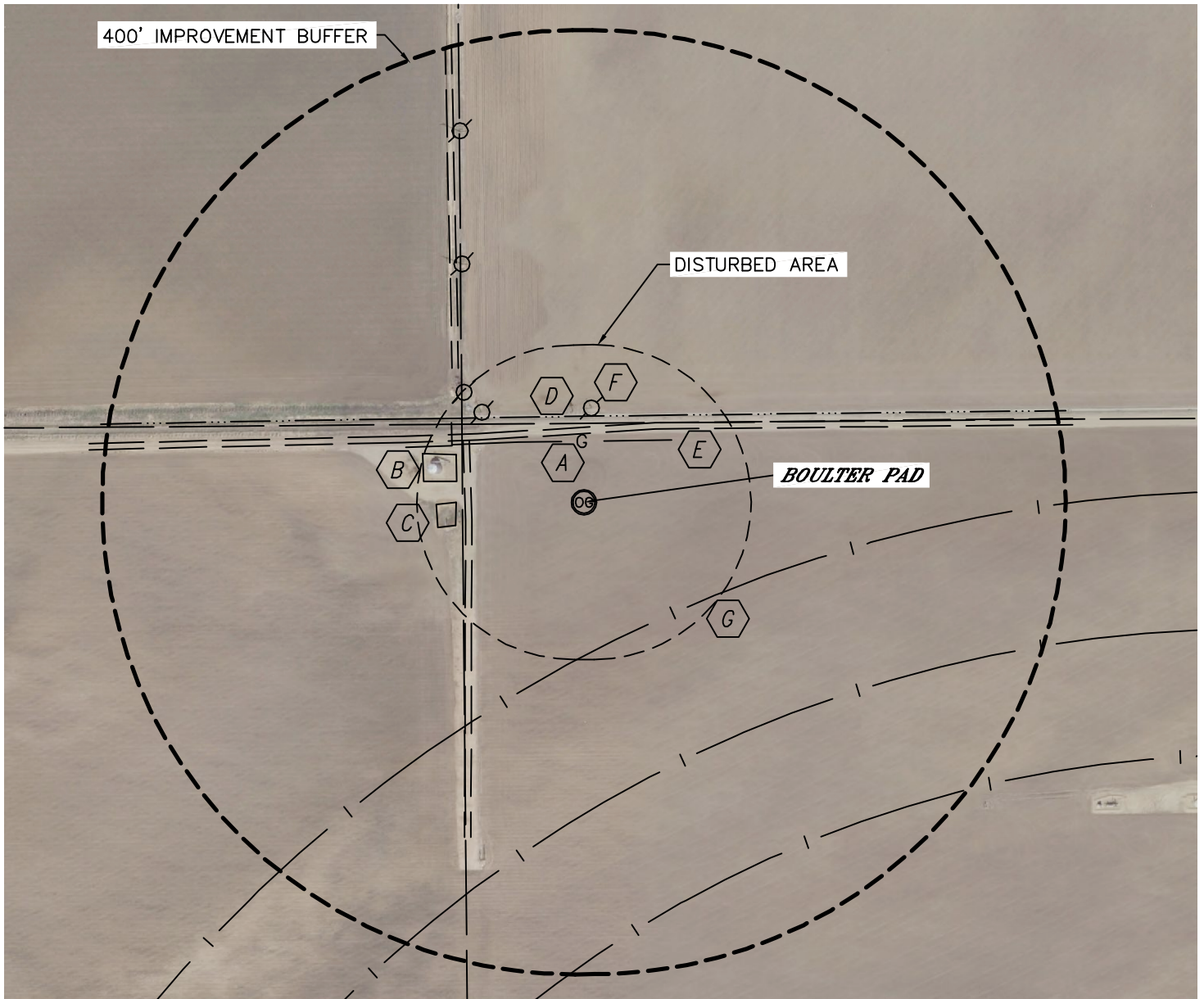

LOCATION DRAWING

BOULTER PAD

SECTION: 27
TOWNSHIP: 5N
RANGE: 65W

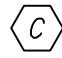
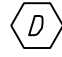

IMPROVEMENTS:

- | | |
|---|-----------------------------------|
|  A | GAS LINE 78' N |
|  B | TANK BATTERY (NOBLE) 164' W |
|  C | DRY POND 162' W |
|  D | IRRIGATION DITCH 109' N |
|  E | FIELD ROAD 87' N, 143' W, 236' NW |

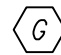
- | | |
|--|---|
|  F | POWER POLES (NO WIRES) 120' N,
173', 207', 340', 498' NW |
|  G | IRRIGATION PIVOT TRACK
175', 350', 510' SE |

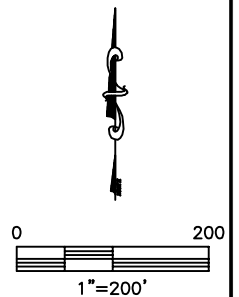

NEAREST: BUILDING 1100' N, PUBLIC ROAD 1260' N,
ABOVE GROUND UTILITY 1170' E, RAILROAD 3570' SE, PROPERTY LINE 100' N