

T 6 S

R 97 W

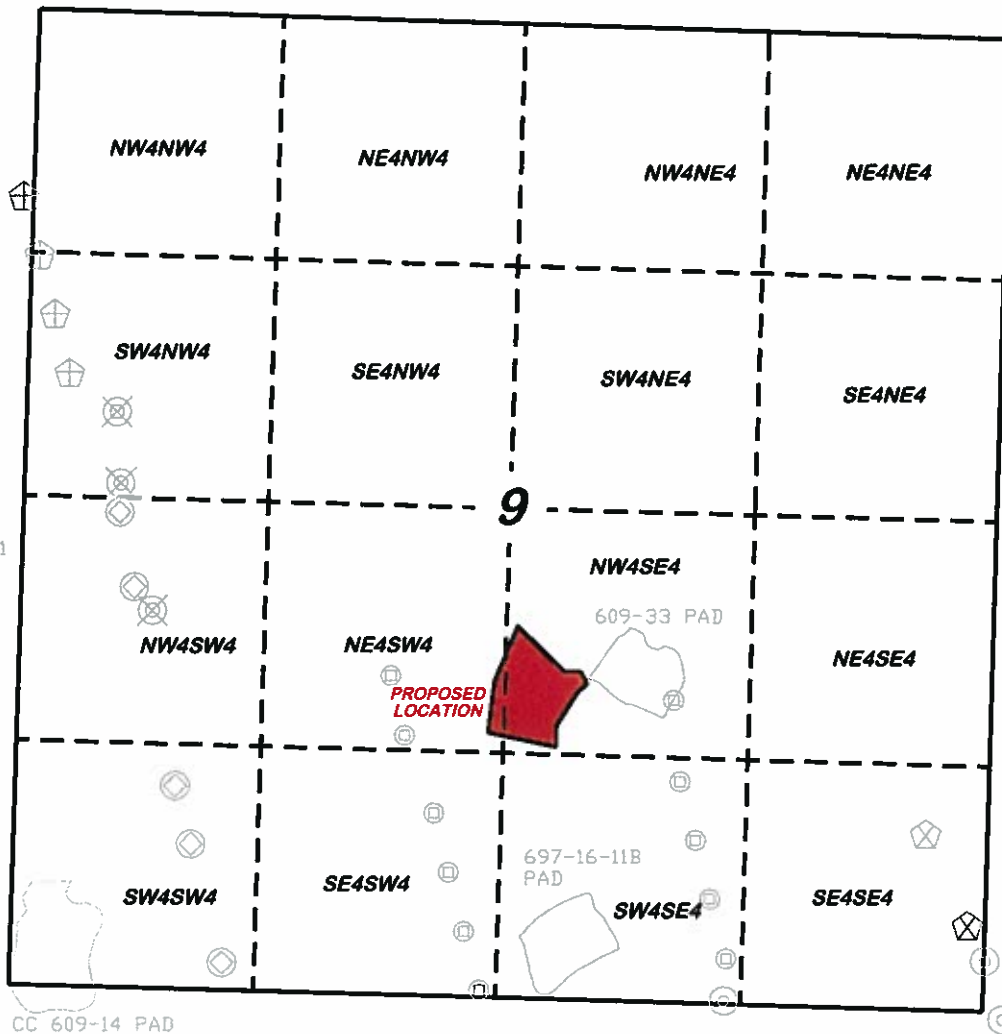

LEGEND:

- ⊙ APPROX. BOTTOM HOLE LOCATION FOR 609-14 PAD
- ⊙ APPROX. BOTTOM HOLE LOCATION FOR 697-16-11B PAD
- ⊙ APPROX. BOTTOM HOLE LOCATION FOR 608-43-31 PAD
- ⊙ APPROX. BOTTOM HOLE LOCATION FOR 697-16-16 PAD
- ⊙ APPROX. BOTTOM HOLE LOCATION FOR 608-41 PAD
- ⊙ APPROX. BOTTOM HOLE LOCATION FOR 697-15-01 PAD

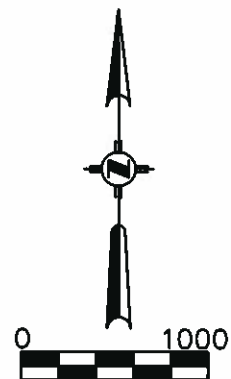

DRG RIFFIN & ASSOCIATES, INC.
 (307) 362-5028 1414 ELK ST., ROCK SPRINGS, WY 82901

DRAWN: 12/13/10 - DEH	SCALE: 1" = 1000'
REVISED: N/A	DRG JOB No. 18232
EXHIBIT 7	

MULTI-WELL PLAN

**OXY USA WTP LP
 CUTTINGS RECLAMATION AREA
 NWSE SECTION 9, T. 6 S., R. 97 W., 6th P.M.,
 GARFIELD COUNTY, COLORADO**