

February 3, 2011



Crawford Properties LLC
0060 El Jebel Road
Unit 105
El Jebel, CO 81623

Antero Resources
1625 17th Street
Denver, Colorado 80202
Office 303.357.7310
Fax 303.357.7315

RE: Proposed Oil and Gas Operations: Rule 305/306 Advance Notice and Consultation
Well Pad: Burckle A Pad
Surface location: NWSE of Section 16, T6S, R92W, 6th P.M.
Garfield County, Colorado

Crawford Properties LLC:

You are the surface owner of lands on which Antero Resources Piceance Corporation intends to drill the subject wells.

Rules 305 and 306 of the Rules and Regulations to the Colorado Oil and Gas Conservation Commission ("COGCC") requires the operator to consult and give notice to the surface owner of potential oil and gas operations, such notice to contain the following information:

- (1) The estimated date that operations for which notice is being given are to commence: **As soon as 3/15/2011 but dependent upon rig availability and market conditions.**
- (2) the name of the operator with address and contact person:
Antero Resources Piceance Corporation
Contact: David Stricklin, Cell# 303-618-7366
- (3) a legal description of the quarter quarter section within which operations will be conducted:
See legal description above
- (4) a statement that the surface owner is responsible for notifying affected tenants of the proposed operations: **"With respect to notices given under this Rule 305, it shall be the responsibility of the notified surface owner to give notice of the proposed operation to the tenant, farmer, lessee, or other party that may own or have an interest in any crops or surface improvements that could be affected by such proposed operation."**
- (5) information with regard to the consultation notice requirement set forth in COGCC Rule 306:
See Attachment
- (6) a copy of the COGCC's information brochure for surface owners: **See Attached Brochure**

Please review the attached document, "Waiver or Request for Consultation" and return the signed and executed document to my attention in the enclosed self-addressed stamped envelope.

If you have any questions, please call me at (303) 357-6412 or David Stricklin at (303) 618-7366.

Regards,

Hannah Knopping
Permit Representative

Enclosures

**WAIVER AND REQUEST FOR CONSULTATION FORM
RULE 305 AND 306**

Crawford Properties LLC
0060 El Jebel Road
Unit 105
El Jebel, CO 81623

RE: Proposed Oil and Gas Operations: Rule 305/306 Advance Notice and Consultation
Well Pad: Burckle A Pad
Surface location: NWSE of Section 16, T6S, R92W, 6th P.M.
Garfield County, Colorado

30-DAY NOTICE WAIVER

The undersigned **waives** OR **does not waive** (PLEASE CIRCLE ONE) the 30-day notice period for drilling operations on the above captioned location.

REQUEST FOR CONSULTATION MEETING

The undersigned **requests** OR **does not request** (PLEASE CIRCLE ONE) a consultation meeting.

Preferred date, time and location of meeting, if applicable: _____

Telephone number: _____

DESIGNATED REPRESENTATIVE /AGENT (if applicable)

The undersigned names the below designated representative for surface consultation with respect to operations for drilling from the above location.

Name: _____

Address: _____

Telephone Number: _____

SURFACE OWNER(S) SIGNATURE

Crawford Properties LLC

By: _____ Date: _____
Title: _____

By: _____ Date: _____
Title: _____

BURCKLE A2

Facilities and Construction Layout Drawing

Section 16, Township 6 South, Range 92 West

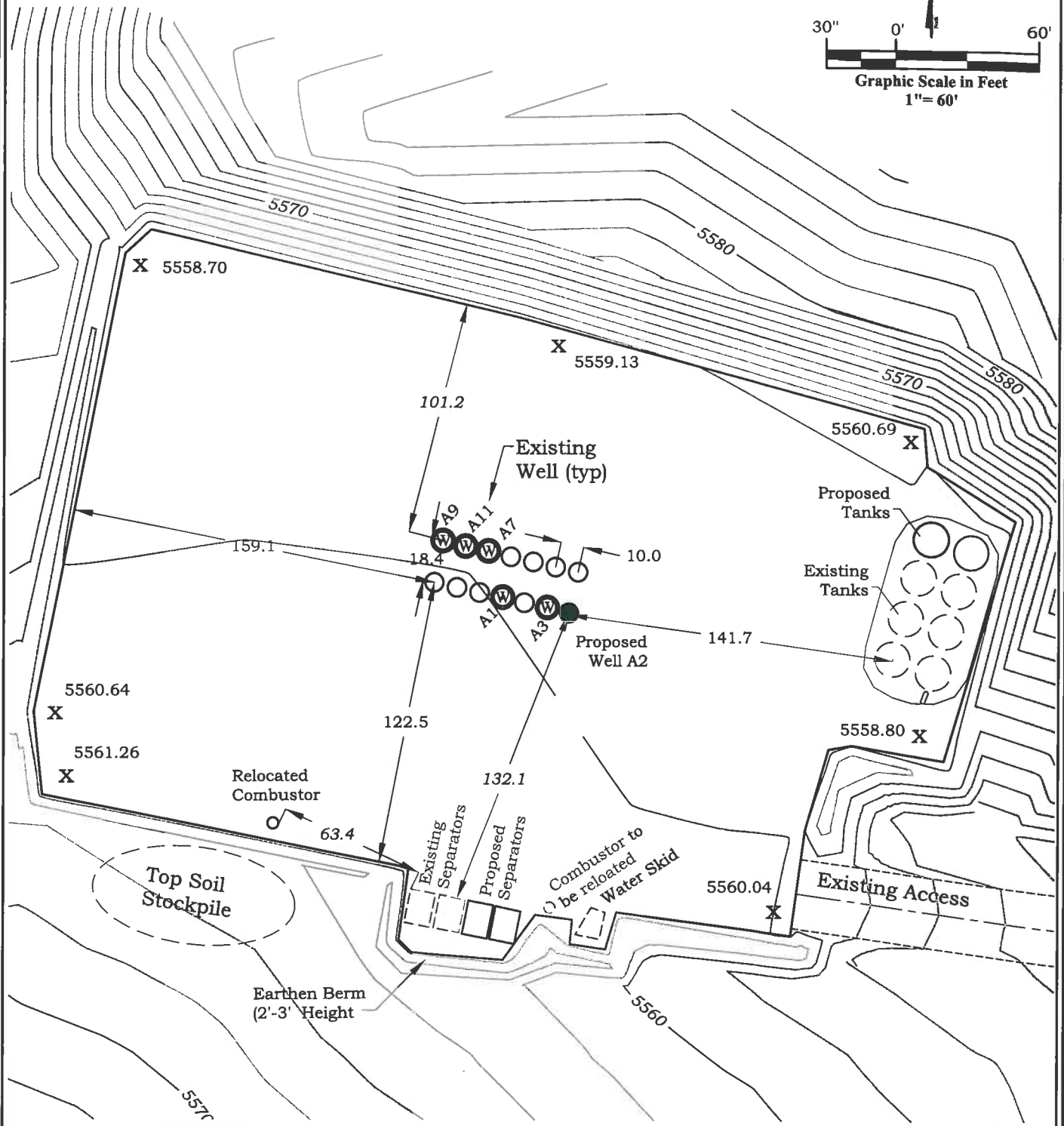
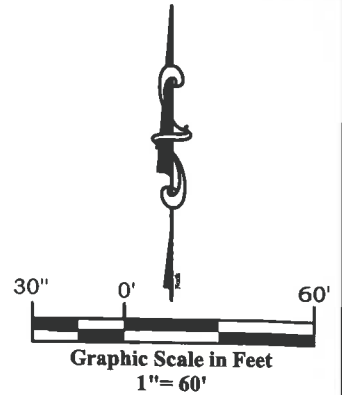

River Valley Survey, Inc.
110 East 3rd. Street, Suite 213
Rifle, Colorado 81650
Ph: 970-379-7846

Project: BURCKLE A PAD

Field Date: 01-04-11

Date: 01-18-11

Scale: 1" = 60'

Sheet: 4 of 11

**Well Location Plat
Prepared For Antero Resources**

Situate In:
NW1/4SE1/4 Section 16, T6S.,
R. 92 W. of the 6th P.M., Garfield
County, Colorado



BURCKLE A PAD

Access and Vicinity Map

Section 16, Township 6 South, Range 92 West

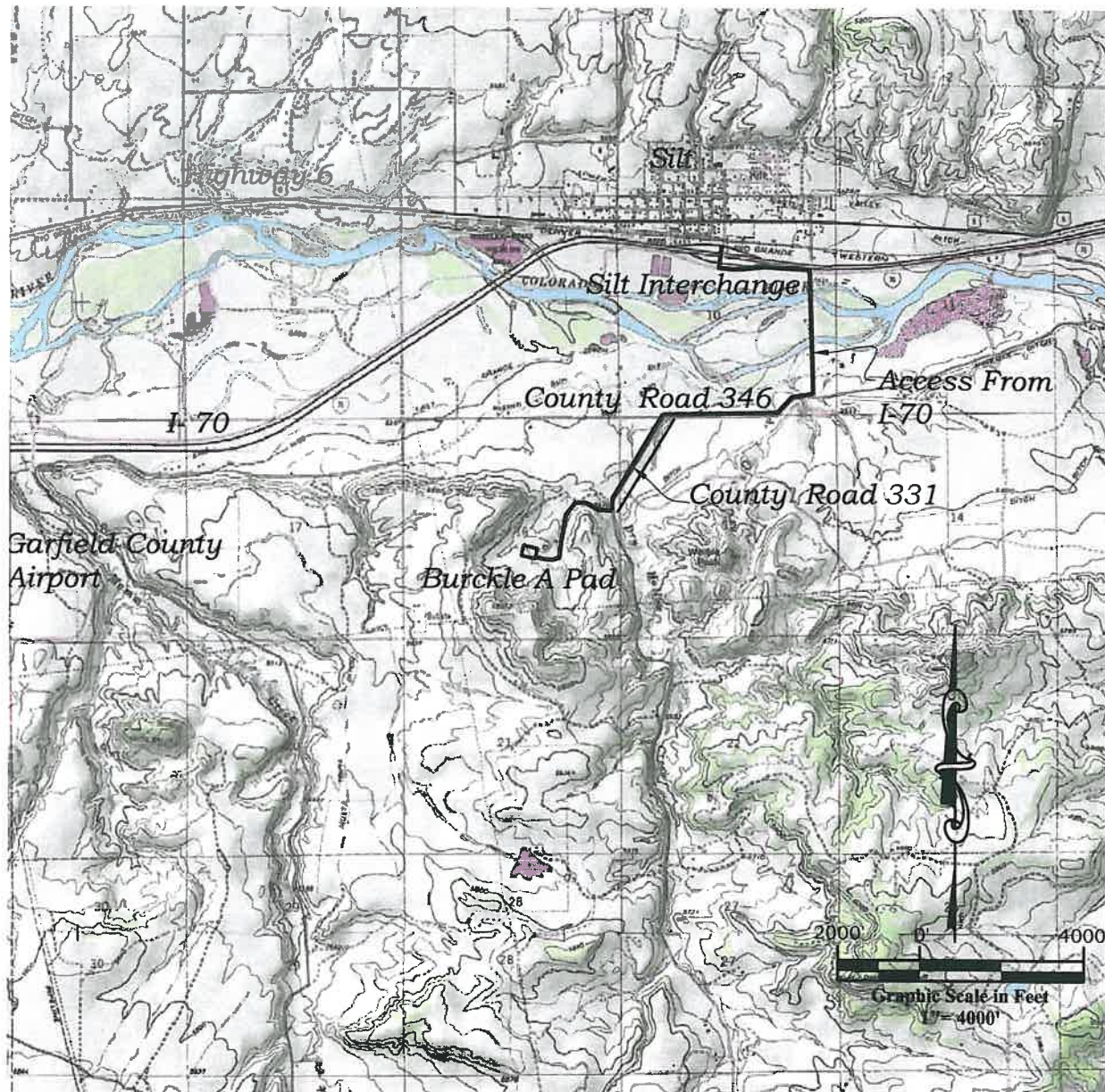

ACCESS:

FROM I-70 SILT EXIT 97 PROCEED SOUTHERLY ALONG HIGHWAY OVERPASS 0.1 MILES TO THE FRONTAGE ROAD. TURN RIGHT AND PROCEED EAST ALONG FRONTAGE ROAD 0.42 MILES TO STILLWATER BLVD. TURN RIGHT AND PROCEED SOUTH ALONG STILLWATER BLVD 0.57 MILES TO COUNTY ROAD 346. TURN RIGHT AND PROCEED WEST ALONG COUNTY ROAD 346 0.73 MILES TO THE INTERSECTION WITH COUNTY ROAD 331. TURN LEFT ONTO COUNTY ROAD 331 AND PROCEED SOUTHERLY 0.55 MILES TO THE BURCKLE ACCESS ROAD. TURN RIGHT AND PROCEED 0.56 MILES TO THE BURCKLE A PAD.



River Valley Survey, Inc.
110 East 3rd. Street, Suite 213
Rifle, Colorado 81650
Ph: 970-379-7846

Project: BURCKLE A PAD

Field Date: 01-04-11

Scale: 1" = 4000'





Date: 01-18-11

Sheet: 11 of 11

**Well Location Plat
Prepared For Antero Resources**

Situate In:
NW1/4SE1/4 Section 16, T6S.,
R. 92 W. of the 6th P.M., Garfield
County, Colorado



 UNITED STATES POSTAL SERVICE®		Click-N-Ship®	
		<small>usps.com</small> 9410 8036 9930 0015 5308 39 0067 5000 0528 1623 \$6.75 US POSTAGE Signature Confirmation  <small>Commercial Base Pricing</small> 02/03/11 0 lb 5 oz Mailed from 80202 071V00552026	
USPS PRIORITY MAIL®			
0005 HANNAH KNOPPING ANTERO RESOURCES 1625 17TH ST STE 300 DENVER CO 80202-5986			
SHIP TO: CRAWFORD PROPERTIES LLC 60 EL JEBEL RD UNIT 105 EL JEBEL CO 81623-9842			
ZIP - e/ USPS SIGNATURE CONFIRMATION™  420 81623 9410 8036 9930 0015 5308 39 Electronic Rate Approved #038555749			

Cut on dotted line.

Instructions

- Each Click-N-Ship® label is unique. Labels are to be used as printed and used only once. DO NOT PHOTO COPY OR ALTER LABEL.
- Place your label so it does not wrap around the edge of the package.
- Adhere your label to the package. A self-adhesive label is recommended. If tape or glue is used, DO NOT TAPE OVER BARCODE. Be sure all edges are secure.
- To mail your package with PC Postage®, you may schedule a Carrier Pickup online, hand to your letter carrier, take to a Post Office™, or drop in a USPS collection box.
- Mail your package on the "Ship Date" you selected when creating this label.

Online Label Record (Label 1 of 1)

Signature Confirmation™ Number:
9410 8036 9930 0015 5308 39

Paid Online

Transaction #:	189570511	Priority Mail® Postage:	\$4.80
Print Date:	02/03/2011	Signature Confirmation:	\$1.95
Ship Date:	02/03/2011	(Electronic Rate)	
Weight:	0 lb 5 oz	Total:	\$6.75

From: HANNAH KNOPPING
ANTERO RESOURCES
1625 17TH ST STE 300
DENVER CO 80202-5986

To: CRAWFORD PROPERTIES LLC
60 EL JEBEL RD
UNIT 105
EL JEBEL CO 81623-9842

* Commercial Base Pricing Priority Mail rates apply. Signature Confirmation service electronic fee required. Delivery information is not available by phone for the electronic rate. Refunds for unused postage paid labels can be requested online 10 days from the print date. A copy of the recipient's signature will be faxed or mailed upon request by visiting the web site listed below or calling 1-800-222-1811.



UNITED STATES POSTAL SERVICE®

Thank you for shipping with the United States Postal Service!
Check the status of your shipment on the Track & Confirm page at usps.com