

# BURCKLE A2

## Facilities and Construction Layout Drawing

### Section 16, Township 6 South, Range 92 West

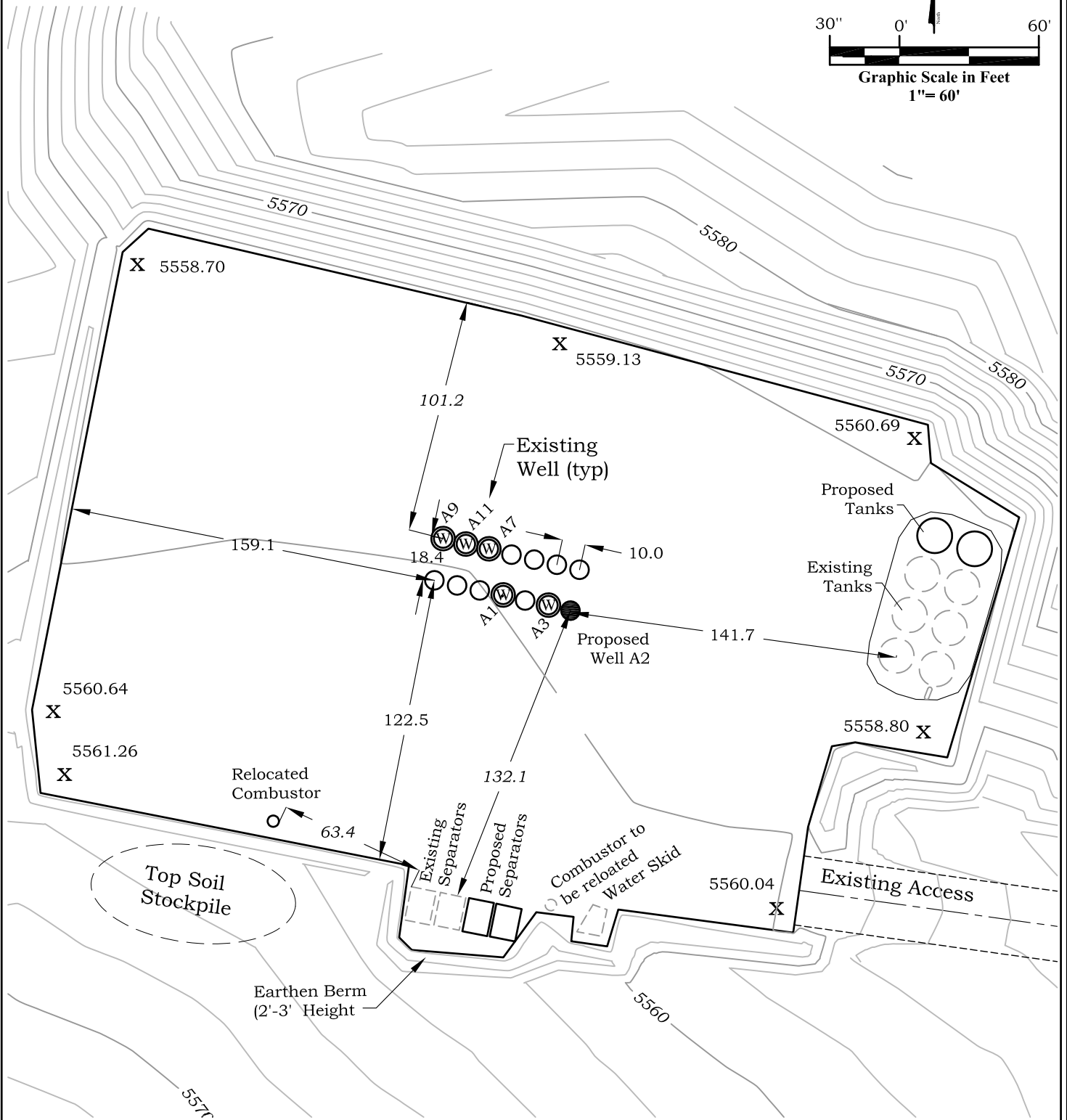
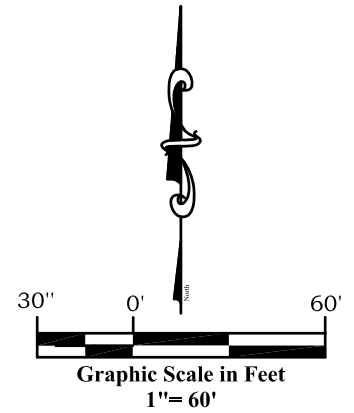

**River Valley Survey, Inc.**  
110 East 3rd. Street, Suite 213  
Rifle, Colorado 81650  
Ph: 970-379-7846

**Project: BURCKLE A PAD**

**Field Date: 01-04-11**

**Date: 01-18-11**

**Scale: 1" = 60'**

**Sheet: 4 of 11**

**Well Location Plat  
Prepared For Antero Resources**

**Situate In:**  
NW1/4SE1/4 Section 16, T6S.,  
R. 92 W. of the 6th P.M., Garfield  
County, Colorado



# BURCKLE A PAD

## Pad Cross-Sections

Section 16, Township 6 South, Range 92 West

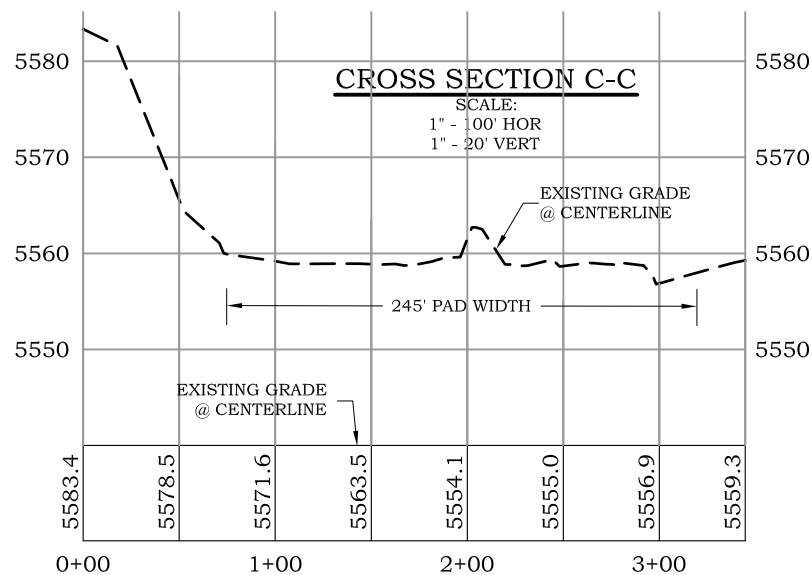
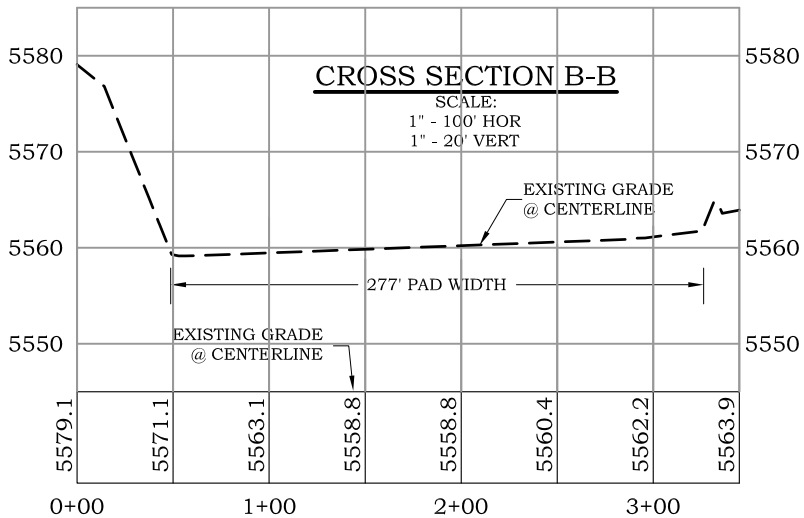
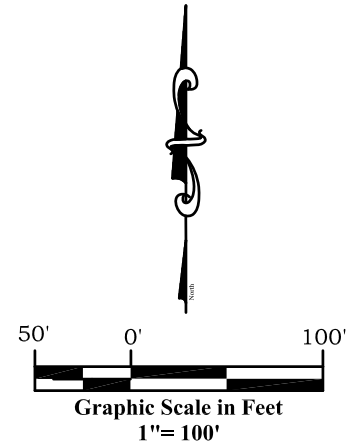
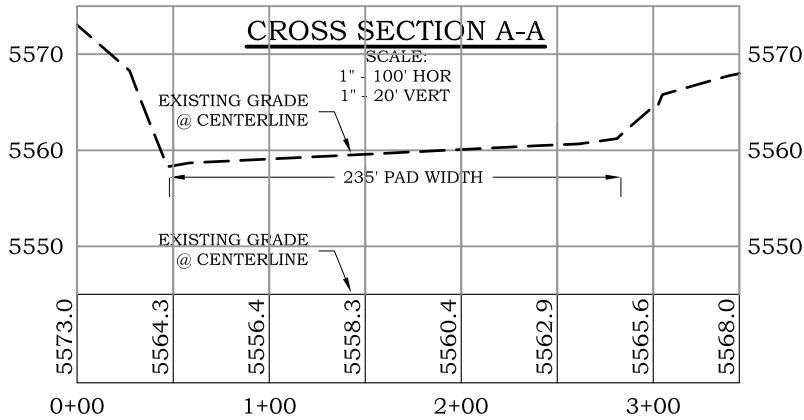

**TOTAL PAD GRADING**

0 cu. yd. CUT

0 cu. yd. FILL

PAD EARTHWORK IS COMPLETE



**River Valley Survey, Inc.**  
110 East 3rd. Street, Suite 213  
Rifle, Colorado 81650  
Ph: 970-379-7846

**Project: BURCKLE A PAD**

**Field Date: 01-04-11**

**Date: 01-18-11**

**Scale: 1" = 100'**

**Sheet: 6 of 11**

**Well Location Plat**  
**Prepared For Antero Resources**

**Situate In:**  
NW1/4SE1/4 Section 16, T6S.,  
R. 92 W. of the 6th P.M., Garfield  
County, Colorado

