

Well Name: **Talon View 11-9**
 Surface Location: Talon View 18-9 Pad Sec.9-T1S-R67W
 North American Datum 1983 , US State Plane 1983 , Colorado Northern Zone
 Ground Elevation: 5156.0

+N/-S	+E/-W	Northing	Easting	Latitude	Longitude	Slot
0.0	0.0	1236937.89	3168529.83	39° 58' 55.956 N	104° 53' 54.924 W	

 Original Well Elev WELL @ 5171.0ft (Original Well Elev)

Anadarko, Adams County CO

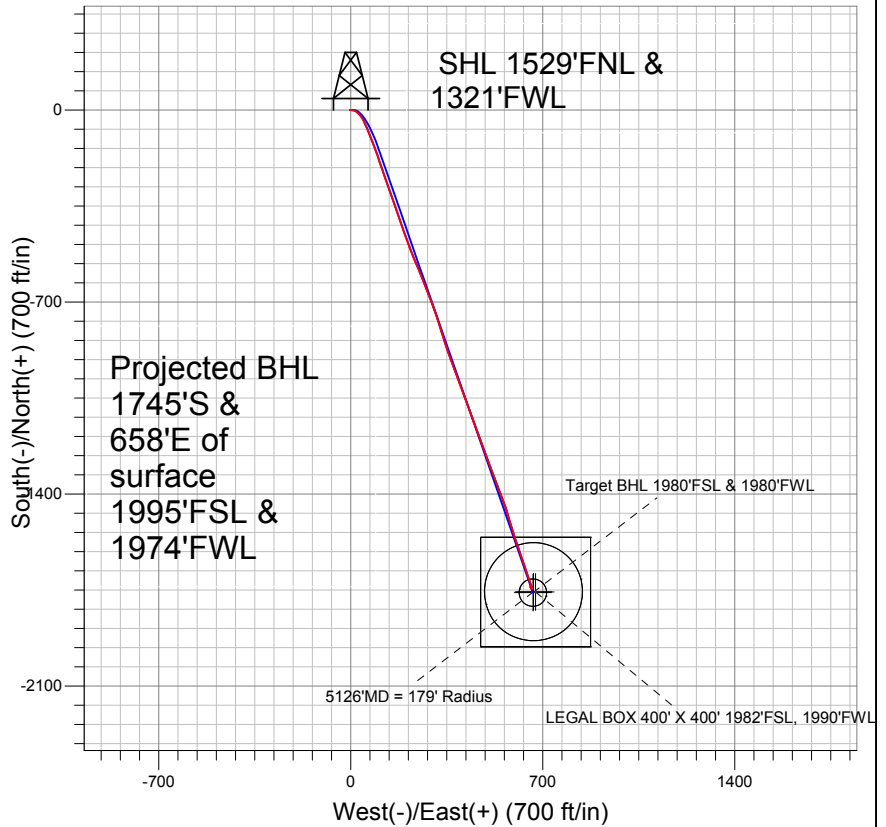

LEGEND

- Talon View 11-9, Wellbore #1, Plan #1 (9-15-10) V0
- Wellbore #1
- Survey #1

Final Survey Plot

Projected Final Survey -
 8810'MD & 8477'TVD @ 1865' VS
 1.0 deg Inc 170.6 deg AZ

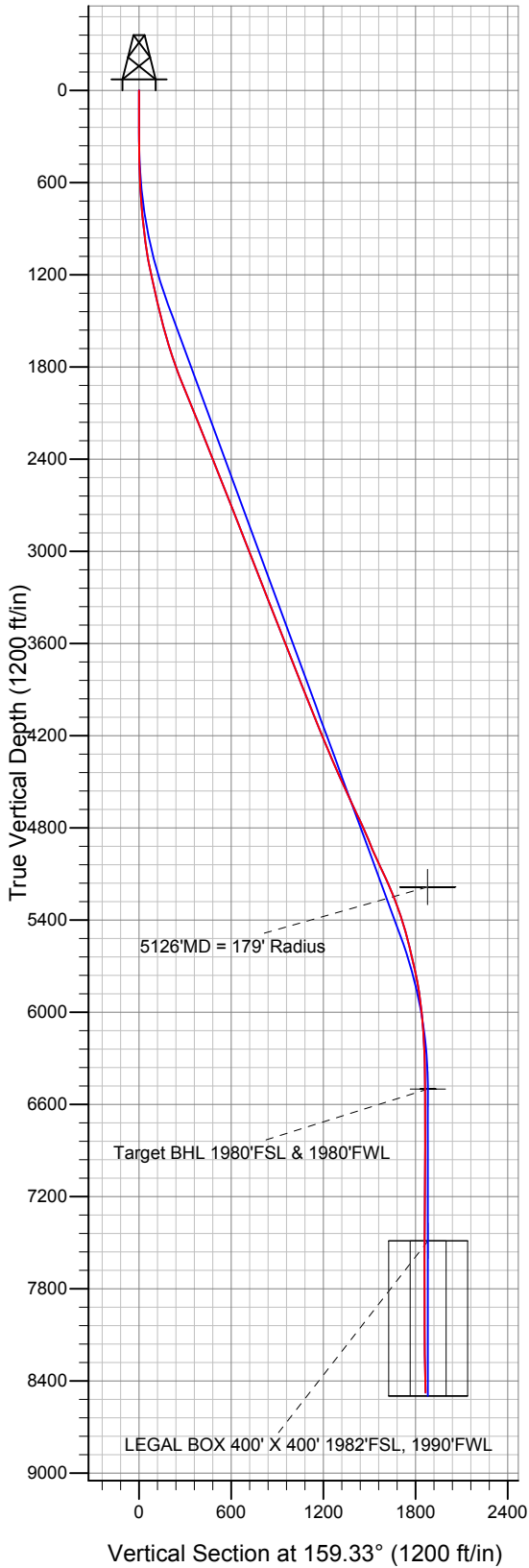

Project: SEC.9-T1S-R67W
 Site: Talon View 18-9 Pad Sec.9-T1S-R67W
 Well: Talon View 11-9
 Plan: Wellbore #1



Directional

Anadarko, Adams County CO

SEC.9-T1S-R67W

Talon View 18-9 Pad Sec.9-T1S-R67W

Talon View 11-9

Wellbore #1

Survey: Survey #1

Standard Survey Report

20 October, 2010

Company:	Anadarko, Adams County CO	Local Co-ordinate Reference:	Well Talon View 11-9
Project:	SEC.9-T1S-R67W	TVD Reference:	WELL @ 5171.0ft (Original Well Elev)
Site:	Talon View 18-9 Pad Sec.9-T1S-R67W	MD Reference:	WELL @ 5171.0ft (Original Well Elev)
Well:	Talon View 11-9	North Reference:	True
Wellbore:	Wellbore #1	Survey Calculation Method:	Minimum Curvature
Design:	Wellbore #1	Database:	Landmark

Project	SEC.9-T1S-R67W, Adams County, Colorado		
Map System:	US State Plane 1983	System Datum:	Mean Sea Level
Geo Datum:	North American Datum 1983		Using Well Reference Point
Map Zone:	Colorado Northern Zone		Using geodetic scale factor

Site	Talon View 18-9 Pad Sec.9-T1S-R67W				
Site Position:		Northing:	1,236,908.77 ft	Latitude:	39° 58' 55.668 N
From:	Lat/Long	Easting:	3,168,530.03 ft	Longitude:	104° 53' 54.924 W
Position Uncertainty:	0.0 ft	Slot Radius:	"	Grid Convergence:	0.39 °

Well	Talon View 11-9					
Well Position	+N/-S	0.0 ft	Northing:	1,236,937.89 ft	Latitude:	39° 58' 55.956 N
	+E/-W	0.0 ft	Easting:	3,168,529.83 ft	Longitude:	104° 53' 54.924 W
Position Uncertainty		0.0 ft	Wellhead Elevation:	ft	Ground Level:	5,156.0 ft

Wellbore	Wellbore #1				
Magnetics	Model Name	Sample Date	Declination (°)	Dip Angle (°)	Field Strength (nT)
	IGRF2010	10/14/2010	8.99	66.71	52,964

Design	Wellbore #1				
Audit Notes:					
Version:	1.0	Phase:	ACTUAL	Tie On Depth:	0.0
Vertical Section:	Depth From (TVD) (ft)	+N/-S (ft)	+E/-W (ft)	Direction (°)	
	0.0	0.0	0.0	159.33	

Survey Program	Date	10/20/2010			
From (ft)	To (ft)	Survey (Wellbore)	Tool Name	Description	
115.0	8,810.0	Survey #1 (Wellbore #1)			

Survey										
Measured Depth (ft)	Inclination (°)	Azimuth (°)	Vertical Depth (ft)	+N/-S (ft)	+E/-W (ft)	Vertical Section (ft)	Dogleg Rate (°/100ft)	Build Rate (°/100ft)	Turn Rate (°/100ft)	
0.0	0.00	0.00	0.0	0.0	0.0	0.0	0.00	0.00	0.00	
115.0	0.60	255.00	115.0	-0.2	-0.6	-0.1	0.52	0.52	0.00	
177.0	0.30	230.00	177.0	-0.3	-1.0	0.0	0.57	-0.48	-40.32	
270.0	1.10	88.60	270.0	-0.5	-0.3	0.3	1.45	0.86	-152.04	
365.0	1.50	90.00	365.0	-0.5	1.8	1.1	0.42	0.42	1.47	
455.0	2.50	90.50	454.9	-0.5	5.0	2.2	1.11	1.11	0.56	
545.0	3.80	101.70	544.8	-1.1	9.9	4.5	1.59	1.44	12.44	
634.0	4.80	115.50	633.5	-3.3	16.1	8.8	1.61	1.12	15.51	
721.0	5.00	126.50	720.2	-7.1	22.4	14.6	1.10	0.23	12.64	
812.0	5.80	135.30	810.8	-12.7	28.9	22.1	1.26	0.88	9.67	
902.0	6.70	143.10	900.3	-20.2	35.2	31.3	1.37	1.00	8.67	
993.0	7.90	149.10	990.5	-29.8	41.6	42.6	1.56	1.32	6.59	
1,081.0	9.50	153.00	1,077.5	-41.5	48.0	55.7	1.94	1.82	4.43	

Company:	Anadarko, Adams County CO	Local Co-ordinate Reference:	Well Talon View 11-9
Project:	SEC.9-T1S-R67W	TVD Reference:	WELL @ 5171.0ft (Original Well Elev)
Site:	Talon View 18-9 Pad Sec.9-T1S-R67W	MD Reference:	WELL @ 5171.0ft (Original Well Elev)
Well:	Talon View 11-9	North Reference:	True
Wellbore:	Wellbore #1	Survey Calculation Method:	Minimum Curvature
Design:	Wellbore #1	Database:	Landmark

Survey										
Measured Depth (ft)	Inclination (°)	Azimuth (°)	Vertical Depth (ft)	+N/-S (ft)	+E/-W (ft)	Vertical Section (ft)	Dogleg Rate (°/100ft)	Build Rate (°/100ft)	Turn Rate (°/100ft)	
1,170.0	11.40	156.80	1,165.0	-56.1	54.8	71.8	2.27	2.13	4.27	
1,261.0	13.10	157.60	1,254.0	-73.9	62.3	91.1	1.88	1.87	0.88	
1,394.0	12.80	157.60	1,383.6	-101.4	73.7	120.9	0.23	-0.23	0.00	
1,482.0	14.00	159.40	1,469.2	-120.4	81.1	141.3	1.44	1.36	2.05	
1,571.0	15.20	160.10	1,555.3	-141.5	88.9	163.7	1.36	1.35	0.79	
1,662.0	16.80	161.00	1,642.8	-165.1	97.2	188.8	1.78	1.76	0.99	
1,750.0	18.40	161.20	1,726.7	-190.3	105.8	215.4	1.82	1.82	0.23	
1,841.0	19.90	161.40	1,812.6	-218.6	115.4	245.2	1.65	1.65	0.22	
1,929.0	21.50	160.60	1,894.9	-248.0	125.5	276.3	1.85	1.82	-0.91	
2,018.0	21.90	159.90	1,977.6	-278.9	136.7	309.2	0.54	0.45	-0.79	
2,108.0	22.00	159.50	2,061.1	-310.5	148.3	342.9	0.20	0.11	-0.44	
2,199.0	22.20	162.40	2,145.4	-342.9	159.5	377.1	1.22	0.22	3.19	
2,290.0	21.80	162.40	2,229.8	-375.3	169.8	411.1	0.44	-0.44	0.00	
2,379.0	21.80	159.90	2,312.4	-406.6	180.5	444.2	1.04	0.00	-2.81	
2,468.0	22.50	160.30	2,394.9	-438.2	191.9	477.7	0.80	0.79	0.45	
2,558.0	21.80	159.80	2,478.2	-470.1	203.5	511.6	0.81	-0.78	-0.56	
2,647.0	21.90	157.60	2,560.8	-500.9	215.5	544.7	0.93	0.11	-2.47	
2,735.0	21.80	159.20	2,642.5	-531.4	227.6	577.5	0.69	-0.11	1.82	
2,824.0	21.00	157.10	2,725.4	-561.5	239.6	610.0	1.24	-0.90	-2.36	
2,914.0	21.80	158.90	2,809.2	-592.0	251.9	642.8	1.15	0.89	2.00	
3,005.0	21.60	157.80	2,893.7	-623.2	264.3	676.4	0.50	-0.22	-1.21	
3,094.0	21.40	159.10	2,976.5	-653.6	276.3	709.0	0.58	-0.22	1.46	
3,184.0	20.80	157.00	3,060.5	-683.6	288.4	741.4	1.07	-0.67	-2.33	
3,273.0	20.70	161.70	3,143.7	-713.1	299.5	772.9	1.87	-0.11	5.28	
3,362.0	21.50	160.00	3,226.8	-743.4	310.1	805.0	1.13	0.90	-1.91	
3,451.0	22.10	162.80	3,309.4	-774.7	320.6	838.0	1.35	0.67	3.15	
3,540.0	21.90	163.50	3,391.9	-806.6	330.3	871.2	0.37	-0.22	0.79	
3,630.0	21.00	161.20	3,475.7	-837.9	340.2	904.1	1.37	-1.00	-2.56	
3,720.0	20.60	161.90	3,559.8	-868.3	350.3	936.0	0.52	-0.44	0.78	
3,811.0	21.40	159.40	3,644.8	-899.0	361.1	968.6	1.32	0.88	-2.75	
3,901.0	22.80	161.40	3,728.2	-930.9	372.5	1,002.5	1.77	1.56	2.22	
3,991.0	21.80	158.30	3,811.4	-963.0	384.2	1,036.6	1.72	-1.11	-3.44	
4,080.0	21.40	159.20	3,894.2	-993.5	396.1	1,069.4	0.58	-0.45	1.01	
4,171.0	20.90	159.80	3,979.1	-1,024.3	407.6	1,102.2	0.60	-0.55	0.66	
4,261.0	22.20	160.00	4,062.8	-1,055.3	419.0	1,135.3	1.45	1.44	0.22	
4,352.0	22.90	160.00	4,146.8	-1,088.1	430.9	1,170.2	0.77	0.77	0.00	
4,440.0	22.50	159.10	4,228.0	-1,119.9	442.8	1,204.1	0.60	-0.45	-1.02	
4,529.0	22.60	160.30	4,310.2	-1,151.9	454.6	1,238.2	0.53	0.11	1.35	
4,617.0	23.60	160.50	4,391.1	-1,184.5	466.2	1,272.8	1.14	1.14	0.23	
4,706.0	24.00	160.70	4,472.6	-1,218.3	478.1	1,308.7	0.46	0.45	0.22	
4,794.0	24.60	159.30	4,552.8	-1,252.4	490.5	1,344.9	0.95	0.68	-1.59	
4,884.0	25.00	158.50	4,634.5	-1,287.6	504.1	1,382.6	0.58	0.44	-0.89	
4,971.0	25.60	160.50	4,713.1	-1,322.4	517.1	1,419.8	1.20	0.69	2.30	
5,062.0	24.20	160.10	4,795.7	-1,358.5	530.0	1,458.1	1.55	-1.54	-0.44	
5,152.0	22.70	157.70	4,878.2	-1,391.9	542.9	1,493.9	1.98	-1.67	-2.67	
5,239.0	23.20	159.30	4,958.3	-1,423.4	555.3	1,527.8	0.92	0.57	1.84	
5,330.0	24.90	162.00	5,041.4	-1,458.4	567.6	1,564.9	2.22	1.87	2.97	
5,420.0	25.20	164.10	5,123.0	-1,494.9	578.7	1,602.9	1.04	0.33	2.33	
5,507.0	23.40	163.20	5,202.3	-1,529.2	588.7	1,638.6	2.11	-2.07	-1.03	
5,598.0	20.50	160.90	5,286.7	-1,561.6	599.2	1,672.6	3.32	-3.19	-2.53	
5,686.0	18.50	160.50	5,369.6	-1,589.3	608.9	1,701.9	2.28	-2.27	-0.45	
5,777.0	16.40	161.60	5,456.4	-1,615.1	617.8	1,729.2	2.34	-2.31	1.21	
5,866.0	14.20	162.40	5,542.3	-1,637.5	625.0	1,752.7	2.48	-2.47	0.90	
5,955.0	13.40	162.60	5,628.7	-1,657.7	631.4	1,773.9	0.90	-0.90	0.22	

Company:	Anadarko, Adams County CO	Local Co-ordinate Reference:	Well Talon View 11-9
Project:	SEC.9-T1S-R67W	TVD Reference:	WELL @ 5171.0ft (Original Well Elev)
Site:	Talon View 18-9 Pad Sec.9-T1S-R67W	MD Reference:	WELL @ 5171.0ft (Original Well Elev)
Well:	Talon View 11-9	North Reference:	True
Wellbore:	Wellbore #1	Survey Calculation Method:	Minimum Curvature
Design:	Wellbore #1	Database:	Landmark

Survey										
Measured Depth (ft)	Inclination (°)	Azimuth (°)	Vertical Depth (ft)	+N/-S (ft)	+E/-W (ft)	Vertical Section (ft)	Dogleg Rate (°/100ft)	Build Rate (°/100ft)	Turn Rate (°/100ft)	
6,046.0	12.50	160.80	5,717.4	-1,677.1	637.8	1,794.2	1.08	-0.99	-1.98	
6,134.0	10.40	159.40	5,803.6	-1,693.5	643.7	1,811.7	2.41	-2.39	-1.59	
6,224.0	8.00	158.80	5,892.4	-1,706.9	648.9	1,826.1	2.67	-2.67	-0.67	
6,313.0	6.90	162.50	5,980.7	-1,717.8	652.7	1,837.6	1.35	-1.24	4.16	
6,402.0	4.60	160.90	6,069.2	-1,726.3	655.5	1,846.5	2.59	-2.58	-1.80	
6,490.0	3.40	161.40	6,157.0	-1,732.1	657.5	1,852.7	1.36	-1.36	0.57	
6,580.0	2.20	161.70	6,246.9	-1,736.3	658.9	1,857.1	1.33	-1.33	0.33	
6,669.0	1.50	156.50	6,335.9	-1,739.0	659.9	1,859.9	0.81	-0.79	-5.84	
6,758.0	1.00	158.40	6,424.8	-1,740.7	660.6	1,861.9	0.56	-0.56	2.13	
6,849.0	0.60	142.60	6,515.8	-1,741.9	661.2	1,863.1	0.50	-0.44	-17.36	
6,937.0	0.20	121.20	6,603.8	-1,742.3	661.6	1,863.7	0.48	-0.45	-24.32	
7,027.0	0.10	313.40	6,693.8	-1,742.3	661.7	1,863.7	0.33	-0.11	-186.44	
7,118.0	0.10	300.10	6,784.8	-1,742.2	661.6	1,863.6	0.03	0.00	-14.62	
7,208.0	0.60	318.60	6,874.8	-1,741.8	661.2	1,863.1	0.56	0.56	20.56	
7,298.0	0.50	308.20	6,964.8	-1,741.3	660.6	1,862.3	0.16	-0.11	-11.56	
7,389.0	0.60	310.30	7,055.8	-1,740.7	659.9	1,861.6	0.11	0.11	2.31	
7,479.0	0.40	301.80	7,145.8	-1,740.2	659.3	1,860.9	0.24	-0.22	-9.44	
7,657.0	0.60	292.20	7,323.8	-1,739.5	657.9	1,859.8	0.12	0.11	-5.39	
7,747.0	0.70	288.60	7,413.8	-1,739.2	656.9	1,859.1	0.12	0.11	-4.00	
7,927.0	0.40	226.20	7,593.8	-1,739.3	655.4	1,858.7	0.35	-0.17	-34.67	
8,017.0	0.35	183.00	7,683.8	-1,739.8	655.2	1,859.0	0.31	-0.06	-48.00	
8,198.0	0.40	70.80	7,864.8	-1,740.1	655.7	1,859.6	0.34	0.03	-61.99	
8,289.0	0.53	53.50	7,955.8	-1,739.8	656.4	1,859.5	0.21	0.14	-19.01	
8,379.0	0.36	65.90	8,045.8	-1,739.4	657.0	1,859.3	0.22	-0.19	13.78	
8,559.0	0.90	170.60	8,225.8	-1,740.6	657.7	1,860.7	0.58	0.30	58.17	
8,649.0	1.00	170.60	8,315.8	-1,742.0	658.0	1,862.1	0.11	0.11	0.00	
8,810.0	1.00	170.60	8,476.7	-1,744.8	658.4	1,864.9	0.00	0.00	0.00	

Checked By: _____ Approved By: _____ Date: _____