

EOG RESOURCES, INC.
FISCUS MESA #15-17H
SECTION 17, T9N, R58W, 6th P.M.

PROCEED IN A NORTHERLY DIRECTION FROM RAYMER, COLORADO ALONG COUNTY ROAD 129 APPROXIMATELY 3.7 MILES TO THE JUNCTION OF THIS ROAD AND COUNTY ROAD 127 ½ TO THE NORTHWEST; TURN LEFT AND PROCEED IN A NORTHWESTERLY, THEN NORTHERLY DIRECTION APPROXIMATELY 2.3 MILES TO THE JUNCTION OF THIS ROAD AND COUNTY ROAD 127 TO THE NORTHWEST; TURN LEFT AND PROCEED IN A NORTHWESTERLY, THEN NORTHERLY DIRECTION APPROXIMATELY 1.6 MILES TO BEGINNING OF THE PROPOSED ACCESS FOR THE #27-29H TO THE WEST; FOLLOW ROAD FLAGS IN A WESTERLY, THEN NORTHERLY DIRECTION APPROXIMATELY 15,259' TO THE BEGINNING OF THE PROPOSED ACCESS FOR THE #17-19H TO THE NORTH, FOLLOW ROAD FLAGS IN A NORTHERLY DIRECTION APPROXIMATELY 990' TO BEGINNING OF THE PROPOSED ACCESS FOR THE #19-21H TO THE NORTH; FOLLOW ROAD FLAGS IN A NORTHERLY, THEN EASTERLY DIRECTION APPROXIMATELY 6,932' TO THE BEGINNING OF THE PROPOSED ACCESS TO THE NORTH; FOLLOW ROAD FLAGS IN A NORTHERLY, THEN NORTHEASTERLY DIRECTION APPROXIMATELY 383' TO THE PROPOSED LOCATION.

TOTAL DISTANCE FROM RAYMER, COLORADO TO THE PROPOSED LOCATION IS APPROXIMATELY 12.1 MILES.

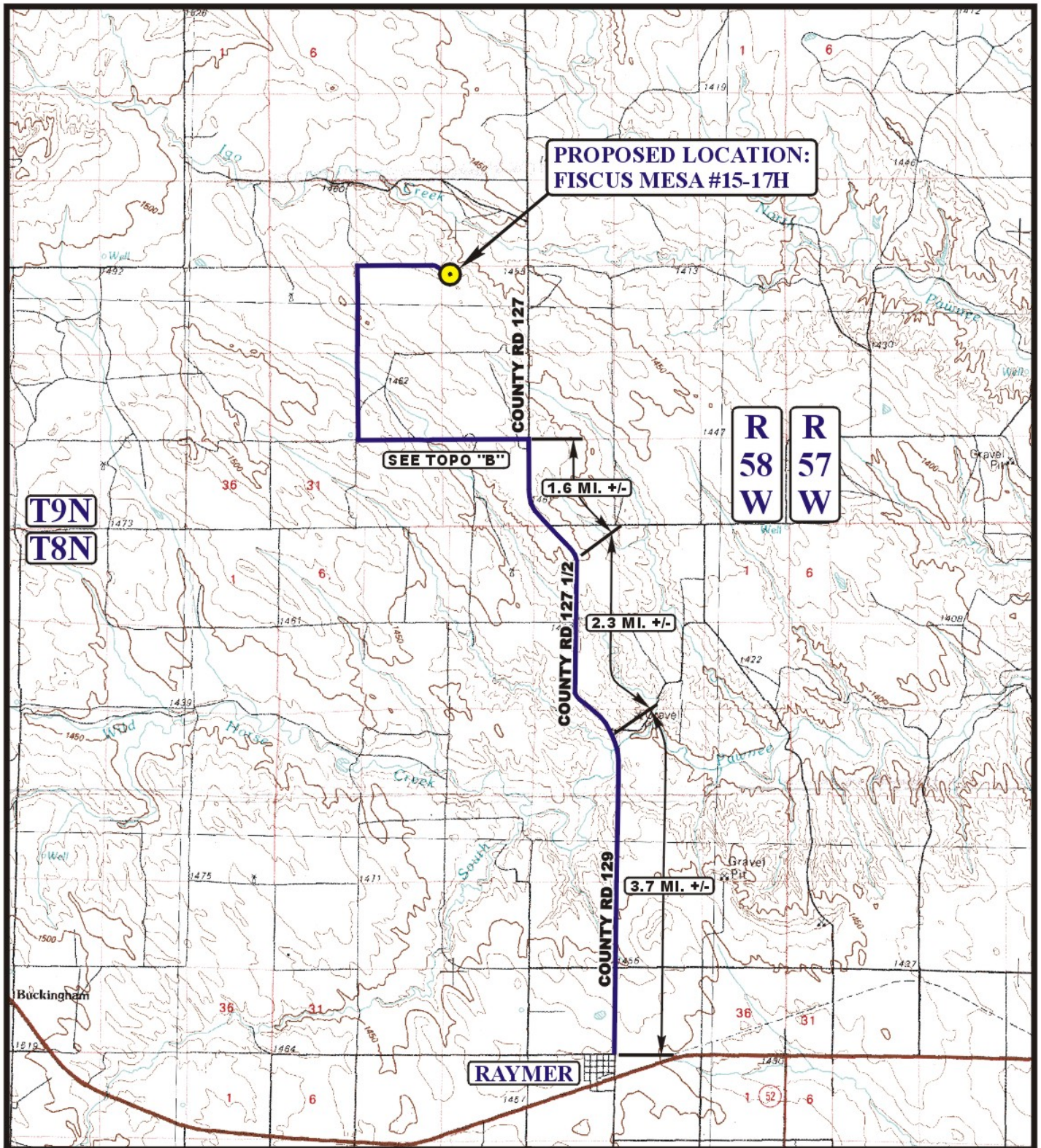

LEGEND:

PROPOSED LOCATION



EOG RESOURCES, INC.

FISCUS MESA #15-17H
SECTION 17, T9N, R58W, 6th P.M.
501' FSL 2412' FWL



Utah Engineering & Land Surveying
85 South 200 East Vernal, Utah 84078
(435) 789-1017 * FAX (435) 789-1813

ACCESS ROAD
MAP

11 08 10
MONTH DAY YEAR

SCALE: 1:100,000

DRAWN BY: Z.L.

REVISED: 00-00-00



