

Jackson Draw 21-30H

Section 30 T9N R61W

Weld County, CO

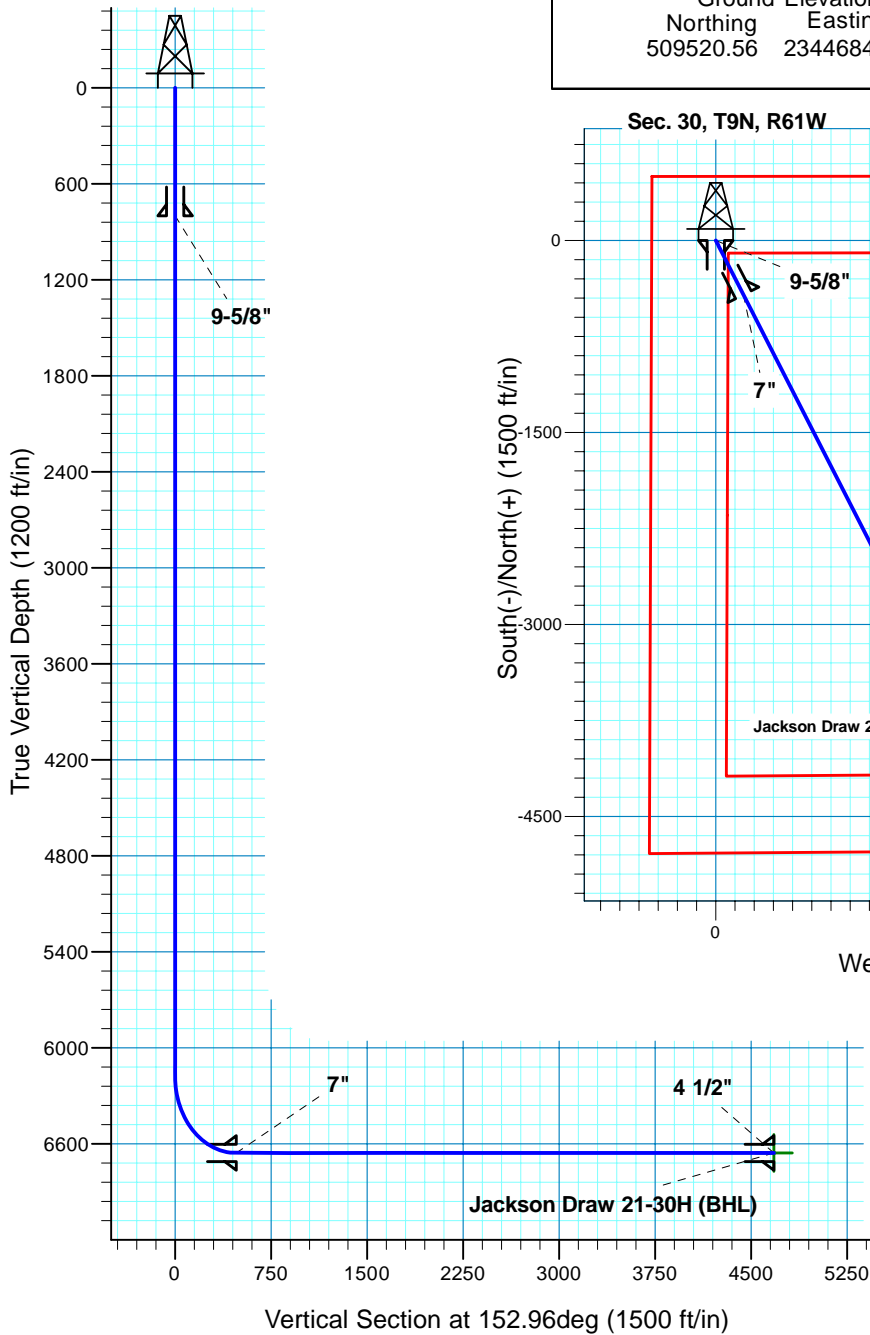

Surface Location				
NAD 1927 (NADCON CONUS) Colorado North 501				
Ground Elevation: 4978.00 RIG @ 5000.00ft (TBD)				
Northing	Easting	Latitude	Longitude	
509520.56	2344684.69	40° 43' 31.490 N	104° 15' 23.119 W	

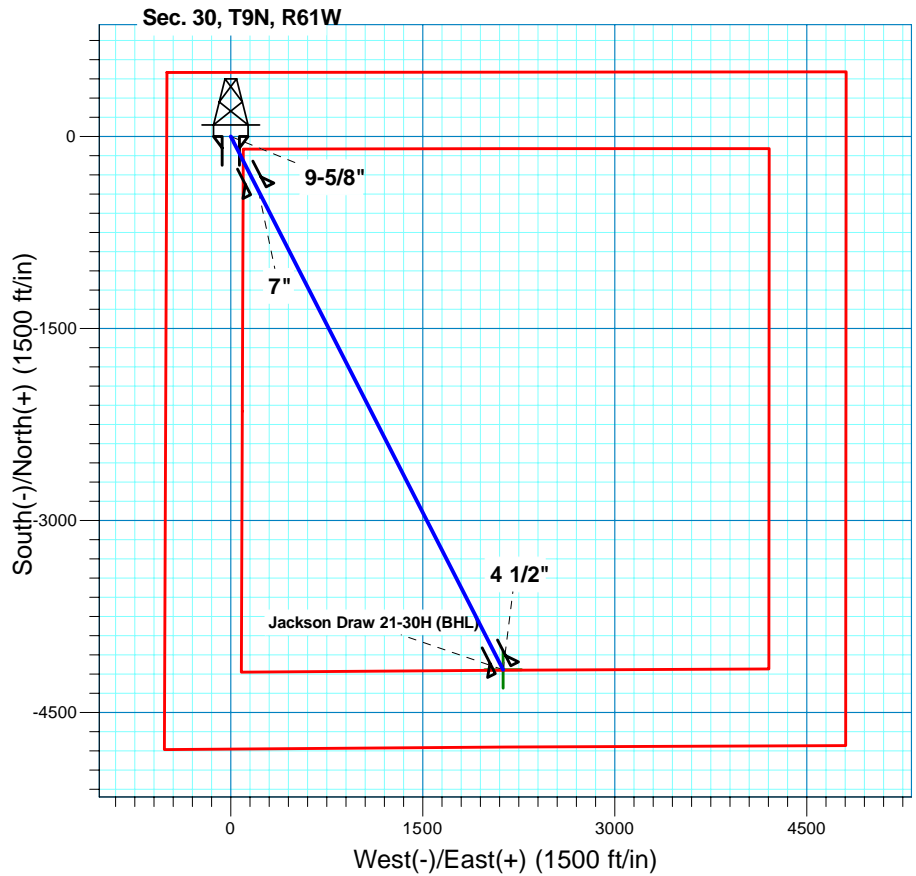

T M

Azimuths to True North
Magnetic North: 8.63°

Magnetic Field
Strength: 53420.1nT
Dip Angle: 67.42°
Date: 1/4/2011
Model: IGRF200510

Project: DJ - Hereford Ranch
Site: Jackson Draw 21-30H
Well: Jackson Draw 21-30H
Plan: APD Directional Plan

SECTION DETAILS

Sec	MD	Inc	Azi	TVD	+N/-S	+E/-W	DLeg	TFace	VSec	Target
1	0.00	0.00	0.00	0.00	0.00	0.00	0.00	0.00	0.00	
2	6179.53	0.00	0.00	6179.53	0.00	0.00	0.00	0.00	0.00	
3	6929.54	90.00	152.96	6657.00	-425.26	217.09	12.00	152.96	477.47	
4	11129.87	90.00	152.96	6657.00	-4166.30	2126.90	0.00	0.00	4677.80	Jackson Draw 21-30H (BHL)

TARGET DETAILS

Name	TVD	+N/-S	+E/-W	Northing	Easting	Latitude	Longitude	Shape Point
Jackson Draw 21-30H (BHL)	6657.00	-4166.30	2126.90	505384.51	2346869.80	40° 42' 50.321 N	104° 14' 55.500 W	

Denver Division- Colorado

**DJ - Hereford Ranch
Jackson Draw 21-30H
Jackson Draw 21-30H
Original Wellbore**

Plan: APD Directional Plan

Standard Planning Report

04 January, 2011

EOG Resources Inc

Planning Report

Database:	EDM	Local Co-ordinate Reference:	Site Jackson Draw 21-30H
Company:	Denver Division- Colorado	TVD Reference:	RIG @ 5000.00ft (TBD)
Project:	DJ - Hereford Ranch	MD Reference:	RIG @ 5000.00ft (TBD)
Site:	Jackson Draw 21-30H	North Reference:	True
Well:	Jackson Draw 21-30H	Survey Calculation Method:	Minimum Curvature
Wellbore:	Original Wellbore		
Design:	APD Directional Plan		

Project	DJ - Hereford Ranch, Weld County		
Map System:	US State Plane 1927 (Exact solution)	System Datum:	Mean Sea Level
Geo Datum:	NAD 1927 (NADCON CONUS)		
Map Zone:	Colorado North 501		

Site		Jackson Draw 21-30H			
Site Position:		Northing:	509,520.56 ft	Latitude:	40° 43' 31.490 N
From:	Lat/Long	Easting:	2,344,684.69 ft	Longitude:	104° 15' 23.119 W
Position Uncertainty:	0.00 ft	Slot Radius:	"	Grid Convergence:	0.80 deg

Well	Jackson Draw 21-30H					
Well Position	+N/-S	0.00 ft	Northing:	509,520.56 ft	Latitude:	40° 43' 31.490 N
	+E/-W	0.00 ft	Easting:	2,344,684.69 ft	Longitude:	104° 15' 23.119 W
Position Uncertainty		0.00 ft	Wellhead Elevation:	ft	Ground Level:	4,978.00 ft

Wellbore	Original Wellbore				
Magnetics	Model Name	Sample Date	Declination (deg)	Dip Angle (deg)	Field Strength (nT)
	IGRF200510	1/4/2011	8.63	67.42	53,420

Design	APD Directional Plan			
Audit Notes:				
Version:	Phase:	PROTOTYPE	Tie On Depth:	0.00
Vertical Section:	Depth From (TVD) (ft)	+N/-S (ft)	+E/-W (ft)	Direction (deg)
	0.00	0.00	0.00	152.96

Plan Sections										
Measured Depth (ft)	Inclination (deg)	Azimuth (deg)	Vertical Depth (ft)	+N/-S (ft)	+E/-W (ft)	Dogleg Rate (?/100ft)	Build Rate (?/100ft)	Turn Rate (?/100ft)	TFO (deg)	Target
0.00	0.00	0.00	0.00	0.00	0.00	0.00	0.00	0.00	0.00	
6,179.53	0.00	0.00	6,179.53	0.00	0.00	0.00	0.00	0.00	0.00	
6,929.54	90.00	152.96	6,657.00	-425.26	217.09	12.00	12.00	0.00	152.96	
11,129.87	90.00	152.96	6,657.00	-4,166.30	2,126.90	0.00	0.00	0.00	0.00	Jackson Draw 21-3

EOG Resources Inc

Planning Report

Database:	EDM	Local Co-ordinate Reference:	Site Jackson Draw 21-30H
Company:	Denver Division- Colorado	TVD Reference:	RIG @ 5000.00ft (TBD)
Project:	DJ - Hereford Ranch	MD Reference:	RIG @ 5000.00ft (TBD)
Site:	Jackson Draw 21-30H	North Reference:	True
Well:	Jackson Draw 21-30H	Survey Calculation Method:	Minimum Curvature
Wellbore:	Original Wellbore		
Design:	APD Directional Plan		

Planned Survey									
Measured Depth (ft)	Inclination (deg)	Azimuth (deg)	Vertical Depth (ft)	+N/-S (ft)	+E/-W (ft)	Vertical Section (ft)	Dogleg Rate (?/100ft)	Build Rate (?/100ft)	Turn Rate (?/100ft)
0.00	0.00	0.00	0.00	0.00	0.00	0.00	0.00	0.00	0.00
100.00	0.00	0.00	100.00	0.00	0.00	0.00	0.00	0.00	0.00
200.00	0.00	0.00	200.00	0.00	0.00	0.00	0.00	0.00	0.00
300.00	0.00	0.00	300.00	0.00	0.00	0.00	0.00	0.00	0.00
400.00	0.00	0.00	400.00	0.00	0.00	0.00	0.00	0.00	0.00
500.00	0.00	0.00	500.00	0.00	0.00	0.00	0.00	0.00	0.00
600.00	0.00	0.00	600.00	0.00	0.00	0.00	0.00	0.00	0.00
700.00	0.00	0.00	700.00	0.00	0.00	0.00	0.00	0.00	0.00
800.00	0.00	0.00	800.00	0.00	0.00	0.00	0.00	0.00	0.00
9-5/8"									
900.00	0.00	0.00	900.00	0.00	0.00	0.00	0.00	0.00	0.00
1,000.00	0.00	0.00	1,000.00	0.00	0.00	0.00	0.00	0.00	0.00
1,100.00	0.00	0.00	1,100.00	0.00	0.00	0.00	0.00	0.00	0.00
1,200.00	0.00	0.00	1,200.00	0.00	0.00	0.00	0.00	0.00	0.00
1,300.00	0.00	0.00	1,300.00	0.00	0.00	0.00	0.00	0.00	0.00
1,400.00	0.00	0.00	1,400.00	0.00	0.00	0.00	0.00	0.00	0.00
1,500.00	0.00	0.00	1,500.00	0.00	0.00	0.00	0.00	0.00	0.00
1,600.00	0.00	0.00	1,600.00	0.00	0.00	0.00	0.00	0.00	0.00
1,700.00	0.00	0.00	1,700.00	0.00	0.00	0.00	0.00	0.00	0.00
1,800.00	0.00	0.00	1,800.00	0.00	0.00	0.00	0.00	0.00	0.00
1,900.00	0.00	0.00	1,900.00	0.00	0.00	0.00	0.00	0.00	0.00
2,000.00	0.00	0.00	2,000.00	0.00	0.00	0.00	0.00	0.00	0.00
2,100.00	0.00	0.00	2,100.00	0.00	0.00	0.00	0.00	0.00	0.00
2,200.00	0.00	0.00	2,200.00	0.00	0.00	0.00	0.00	0.00	0.00
2,300.00	0.00	0.00	2,300.00	0.00	0.00	0.00	0.00	0.00	0.00
2,400.00	0.00	0.00	2,400.00	0.00	0.00	0.00	0.00	0.00	0.00
2,500.00	0.00	0.00	2,500.00	0.00	0.00	0.00	0.00	0.00	0.00
2,600.00	0.00	0.00	2,600.00	0.00	0.00	0.00	0.00	0.00	0.00
2,700.00	0.00	0.00	2,700.00	0.00	0.00	0.00	0.00	0.00	0.00
2,800.00	0.00	0.00	2,800.00	0.00	0.00	0.00	0.00	0.00	0.00
2,900.00	0.00	0.00	2,900.00	0.00	0.00	0.00	0.00	0.00	0.00
3,000.00	0.00	0.00	3,000.00	0.00	0.00	0.00	0.00	0.00	0.00
3,100.00	0.00	0.00	3,100.00	0.00	0.00	0.00	0.00	0.00	0.00
3,200.00	0.00	0.00	3,200.00	0.00	0.00	0.00	0.00	0.00	0.00
3,300.00	0.00	0.00	3,300.00	0.00	0.00	0.00	0.00	0.00	0.00
3,400.00	0.00	0.00	3,400.00	0.00	0.00	0.00	0.00	0.00	0.00
3,500.00	0.00	0.00	3,500.00	0.00	0.00	0.00	0.00	0.00	0.00
3,600.00	0.00	0.00	3,600.00	0.00	0.00	0.00	0.00	0.00	0.00
3,700.00	0.00	0.00	3,700.00	0.00	0.00	0.00	0.00	0.00	0.00
3,800.00	0.00	0.00	3,800.00	0.00	0.00	0.00	0.00	0.00	0.00
3,900.00	0.00	0.00	3,900.00	0.00	0.00	0.00	0.00	0.00	0.00
4,000.00	0.00	0.00	4,000.00	0.00	0.00	0.00	0.00	0.00	0.00
4,100.00	0.00	0.00	4,100.00	0.00	0.00	0.00	0.00	0.00	0.00
4,200.00	0.00	0.00	4,200.00	0.00	0.00	0.00	0.00	0.00	0.00
4,300.00	0.00	0.00	4,300.00	0.00	0.00	0.00	0.00	0.00	0.00
4,400.00	0.00	0.00	4,400.00	0.00	0.00	0.00	0.00	0.00	0.00
4,500.00	0.00	0.00	4,500.00	0.00	0.00	0.00	0.00	0.00	0.00
4,600.00	0.00	0.00	4,600.00	0.00	0.00	0.00	0.00	0.00	0.00
4,700.00	0.00	0.00	4,700.00	0.00	0.00	0.00	0.00	0.00	0.00
4,800.00	0.00	0.00	4,800.00	0.00	0.00	0.00	0.00	0.00	0.00
4,900.00	0.00	0.00	4,900.00	0.00	0.00	0.00	0.00	0.00	0.00
5,000.00	0.00	0.00	5,000.00	0.00	0.00	0.00	0.00	0.00	0.00
5,100.00	0.00	0.00	5,100.00	0.00	0.00	0.00	0.00	0.00	0.00

EOG Resources Inc

Planning Report

Database:	EDM	Local Co-ordinate Reference:	Site Jackson Draw 21-30H
Company:	Denver Division- Colorado	TVD Reference:	RIG @ 5000.00ft (TBD)
Project:	DJ - Hereford Ranch	MD Reference:	RIG @ 5000.00ft (TBD)
Site:	Jackson Draw 21-30H	North Reference:	True
Well:	Jackson Draw 21-30H	Survey Calculation Method:	Minimum Curvature
Wellbore:	Original Wellbore		
Design:	APD Directional Plan		

Planned Survey

Measured Depth (ft)	Inclination (deg)	Azimuth (deg)	Vertical Depth (ft)	+N/-S (ft)	+E/-W (ft)	Vertical Section (ft)	Dogleg Rate (?/100ft)	Build Rate (?/100ft)	Turn Rate (?/100ft)
5,200.00	0.00	0.00	5,200.00	0.00	0.00	0.00	0.00	0.00	0.00
5,300.00	0.00	0.00	5,300.00	0.00	0.00	0.00	0.00	0.00	0.00
5,400.00	0.00	0.00	5,400.00	0.00	0.00	0.00	0.00	0.00	0.00
5,500.00	0.00	0.00	5,500.00	0.00	0.00	0.00	0.00	0.00	0.00
5,600.00	0.00	0.00	5,600.00	0.00	0.00	0.00	0.00	0.00	0.00
5,700.00	0.00	0.00	5,700.00	0.00	0.00	0.00	0.00	0.00	0.00
5,800.00	0.00	0.00	5,800.00	0.00	0.00	0.00	0.00	0.00	0.00
5,900.00	0.00	0.00	5,900.00	0.00	0.00	0.00	0.00	0.00	0.00
6,000.00	0.00	0.00	6,000.00	0.00	0.00	0.00	0.00	0.00	0.00
6,100.00	0.00	0.00	6,100.00	0.00	0.00	0.00	0.00	0.00	0.00
6,179.53	0.00	0.00	6,179.53	0.00	0.00	0.00	0.00	0.00	0.00
6,200.00	2.46	152.96	6,199.99	-0.39	0.20	0.44	12.00	12.00	0.00
6,300.00	14.46	152.96	6,298.73	-13.46	6.87	15.12	12.00	12.00	0.00
6,400.00	26.46	152.96	6,392.25	-44.53	22.73	50.00	12.00	12.00	0.00
6,500.00	38.46	152.96	6,476.48	-92.24	47.09	103.57	12.00	12.00	0.00
6,600.00	50.46	152.96	6,547.72	-154.51	78.88	173.48	12.00	12.00	0.00
6,700.00	62.46	152.96	6,602.88	-228.60	116.70	256.67	12.00	12.00	0.00
6,800.00	74.46	152.96	6,639.54	-311.30	158.92	349.51	12.00	12.00	0.00
6,900.00	86.46	152.96	6,656.09	-398.97	203.67	447.95	12.00	12.00	0.00
6,929.54	90.00	152.96	6,657.00	-425.26	217.10	477.47	12.00	12.00	0.00
7"									
7,000.00	90.00	152.96	6,657.00	-488.02	249.13	547.93	0.00	0.00	0.00
7,100.00	90.00	152.96	6,657.00	-577.08	294.60	647.93	0.00	0.00	0.00
7,200.00	90.00	152.96	6,657.00	-666.15	340.07	747.93	0.00	0.00	0.00
7,300.00	90.00	152.96	6,657.00	-755.21	385.54	847.93	0.00	0.00	0.00
7,400.00	90.00	152.96	6,657.00	-844.28	431.00	947.93	0.00	0.00	0.00
7,500.00	90.00	152.96	6,657.00	-933.34	476.47	1,047.93	0.00	0.00	0.00
7,600.00	90.00	152.96	6,657.00	-1,022.41	521.94	1,147.93	0.00	0.00	0.00
7,700.00	90.00	152.96	6,657.00	-1,111.48	567.41	1,247.93	0.00	0.00	0.00
7,800.00	90.00	152.96	6,657.00	-1,200.54	612.88	1,347.93	0.00	0.00	0.00
7,900.00	90.00	152.96	6,657.00	-1,289.61	658.34	1,447.93	0.00	0.00	0.00
8,000.00	90.00	152.96	6,657.00	-1,378.67	703.81	1,547.93	0.00	0.00	0.00
8,100.00	90.00	152.96	6,657.00	-1,467.74	749.28	1,647.93	0.00	0.00	0.00
8,200.00	90.00	152.96	6,657.00	-1,556.80	794.75	1,747.93	0.00	0.00	0.00
8,300.00	90.00	152.96	6,657.00	-1,645.87	840.22	1,847.93	0.00	0.00	0.00
8,400.00	90.00	152.96	6,657.00	-1,734.93	885.68	1,947.93	0.00	0.00	0.00
8,500.00	90.00	152.96	6,657.00	-1,824.00	931.15	2,047.93	0.00	0.00	0.00
8,600.00	90.00	152.96	6,657.00	-1,913.07	976.62	2,147.93	0.00	0.00	0.00
8,700.00	90.00	152.96	6,657.00	-2,002.13	1,022.09	2,247.93	0.00	0.00	0.00
8,800.00	90.00	152.96	6,657.00	-2,091.20	1,067.55	2,347.93	0.00	0.00	0.00
8,900.00	90.00	152.96	6,657.00	-2,180.26	1,113.02	2,447.93	0.00	0.00	0.00
9,000.00	90.00	152.96	6,657.00	-2,269.33	1,158.49	2,547.93	0.00	0.00	0.00
9,100.00	90.00	152.96	6,657.00	-2,358.39	1,203.96	2,647.93	0.00	0.00	0.00
9,200.00	90.00	152.96	6,657.00	-2,447.46	1,249.43	2,747.93	0.00	0.00	0.00
9,300.00	90.00	152.96	6,657.00	-2,536.52	1,294.89	2,847.93	0.00	0.00	0.00
9,400.00	90.00	152.96	6,657.00	-2,625.59	1,340.36	2,947.93	0.00	0.00	0.00
9,500.00	90.00	152.96	6,657.00	-2,714.66	1,385.83	3,047.93	0.00	0.00	0.00
9,600.00	90.00	152.96	6,657.00	-2,803.72	1,431.30	3,147.93	0.00	0.00	0.00
9,700.00	90.00	152.96	6,657.00	-2,892.79	1,476.77	3,247.93	0.00	0.00	0.00
9,800.00	90.00	152.96	6,657.00	-2,981.85	1,522.23	3,347.93	0.00	0.00	0.00
9,900.00	90.00	152.96	6,657.00	-3,070.92	1,567.70	3,447.93	0.00	0.00	0.00
10,000.00	90.00	152.96	6,657.00	-3,159.98	1,613.17	3,547.93	0.00	0.00	0.00
10,100.00	90.00	152.96	6,657.00	-3,249.05	1,658.64	3,647.93	0.00	0.00	0.00

EOG Resources Inc

Planning Report

Database:	EDM	Local Co-ordinate Reference:	Site Jackson Draw 21-30H
Company:	Denver Division- Colorado	TVD Reference:	RIG @ 5000.00ft (TBD)
Project:	DJ - Hereford Ranch	MD Reference:	RIG @ 5000.00ft (TBD)
Site:	Jackson Draw 21-30H	North Reference:	True
Well:	Jackson Draw 21-30H	Survey Calculation Method:	Minimum Curvature
Wellbore:	Original Wellbore		
Design:	APD Directional Plan		

Planned Survey

Measured Depth (ft)	Inclination (deg)	Azimuth (deg)	Vertical Depth (ft)	+N/-S (ft)	+E/-W (ft)	Vertical Section (ft)	Dogleg Rate (?/100ft)	Build Rate (?/100ft)	Turn Rate (?/100ft)
10,200.00	90.00	152.96	6,657.00	-3,338.11	1,704.11	3,747.93	0.00	0.00	0.00
10,300.00	90.00	152.96	6,657.00	-3,427.18	1,749.57	3,847.93	0.00	0.00	0.00
10,400.00	90.00	152.96	6,657.00	-3,516.24	1,795.04	3,947.93	0.00	0.00	0.00
10,500.00	90.00	152.96	6,657.00	-3,605.31	1,840.51	4,047.93	0.00	0.00	0.00
10,600.00	90.00	152.96	6,657.00	-3,694.38	1,885.98	4,147.93	0.00	0.00	0.00
10,700.00	90.00	152.96	6,657.00	-3,783.44	1,931.45	4,247.93	0.00	0.00	0.00
10,800.00	90.00	152.96	6,657.00	-3,872.51	1,976.91	4,347.93	0.00	0.00	0.00
10,900.00	90.00	152.96	6,657.00	-3,961.57	2,022.38	4,447.93	0.00	0.00	0.00
11,000.00	90.00	152.96	6,657.00	-4,050.64	2,067.85	4,547.93	0.00	0.00	0.00
11,100.00	90.00	152.96	6,657.00	-4,139.70	2,113.32	4,647.93	0.00	0.00	0.00
11,129.87	90.00	152.96	6,657.00	-4,166.30	2,126.90	4,677.80	0.00	0.00	0.00
Jackson Draw 21-30H (BHL)									

Targets

Target Name

- hit/miss target	Dip Angle (deg)	Dip Dir. (deg)	TVD (ft)	+N/-S (ft)	+E/-W (ft)	Northing (ft)	Easting (ft)	Latitude	Longitude
- Shape									
Jackson Draw 21-30H	0.00	0.00	6,657.00	-4,166.30	2,126.90	505,384.51	2,346,869.80	40° 42' 50.321 N	104° 14' 55.500 W
- plan hits target center									
- Point									

Casing Points

Measured Depth (ft)	Vertical Depth (ft)	Name	Casing Diameter (")	Hole Diameter (")
800.00	800.00	9-5/8"	9-5/8	13-1/2
6,929.54	6,657.00	7"	7	8-3/4
11,129.87	6,657.00	4 1/2"	4-1/2	6-1/4