

EXISTING DISTURBANCE AREA:

4.4 ACRES±

PAD GRADE: 7226.5'

PIT BOTTOM: 7218.5'

2A ATTACHMENT

8A

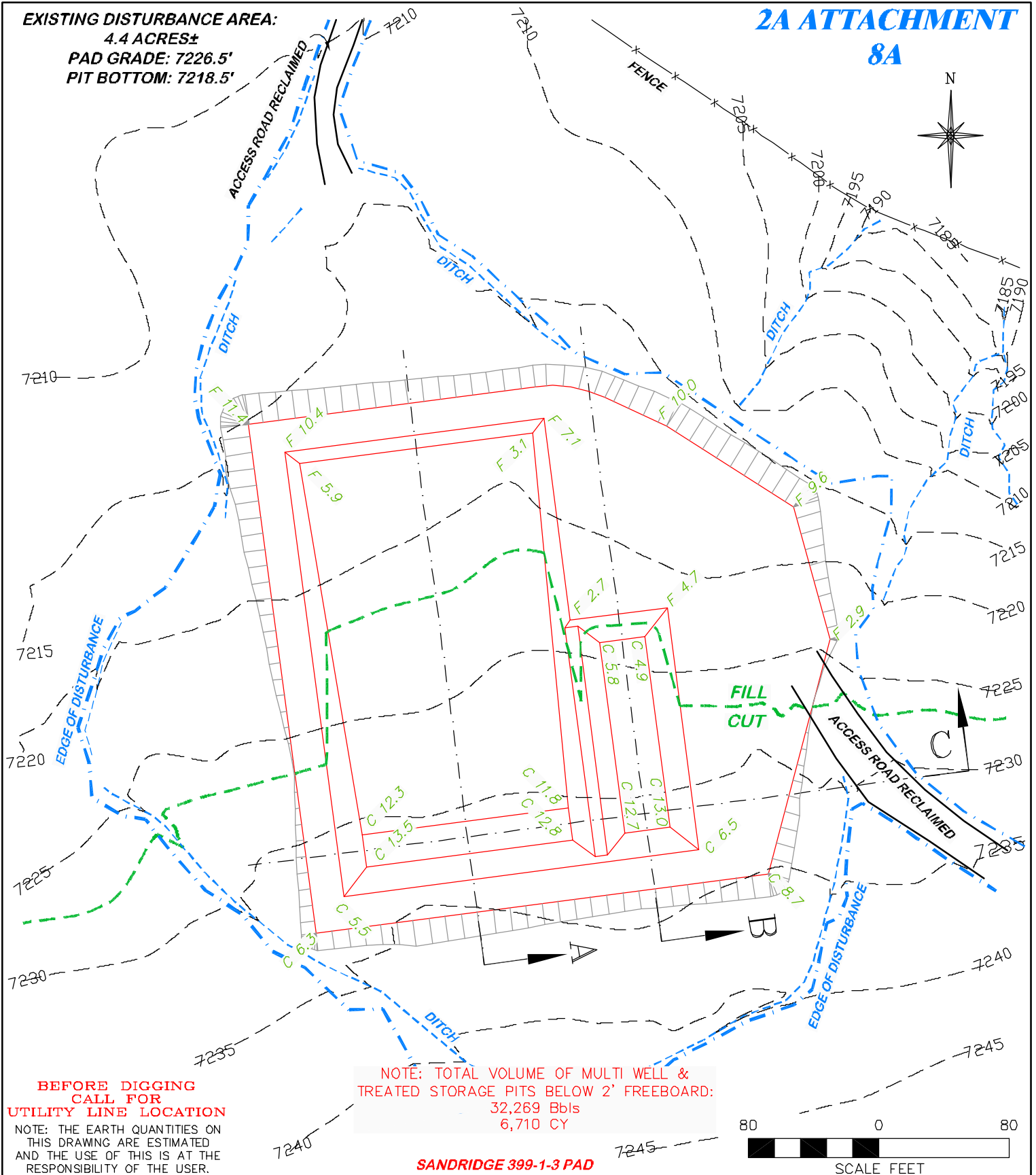

**BEFORE DIGGING
CALL FOR
UTILITY LINE LOCATION**

NOTE: THE EARTH QUANTITIES ON
THIS DRAWING ARE ESTIMATED
AND THE USE OF THIS IS AT THE
RESPONSIBILITY OF THE USER.

NOTE: TOTAL VOLUME OF MULTI WELL &
TREATED STORAGE PITS BELOW 2' FREEBOARD:
32,269 Bbbls
6,710 CY

SANDRIDGE 399-1-3 PAD

80 0 80
SCALE FEET



DRG RIFFIN & ASSOCIATES, INC.
1414 ELK ST., ROCK SPRINGS, WY 82901

(307) 362-5028

DRAWN: 7/29/10 - DEH

SCALE: 1" = 80'

REVISED: N/A

DRG JOB No. 17957

EXHIBIT 2

CONSTRUCTION LAYOUT DRAWING 1 OF 2

**WILLIAMS PRODUCTION RMT COMPANY
SANDRIDGE 399-1-3 MULTI WELL PIT
SWNW, SECTION 1, 13S, R99W, 6th P.M.
RIO BLANCO COUNTY, COLORADO**

PAD GRADE: 7226.5'
PIT BOTTOM: 7218.5'

ESTIMATED EARTHWORK

ITEM	CUT	FILL	TOPSOIL	EXCESS
TOTALS	12,341 CY	9,962 CY	2,019 CY	360 CY

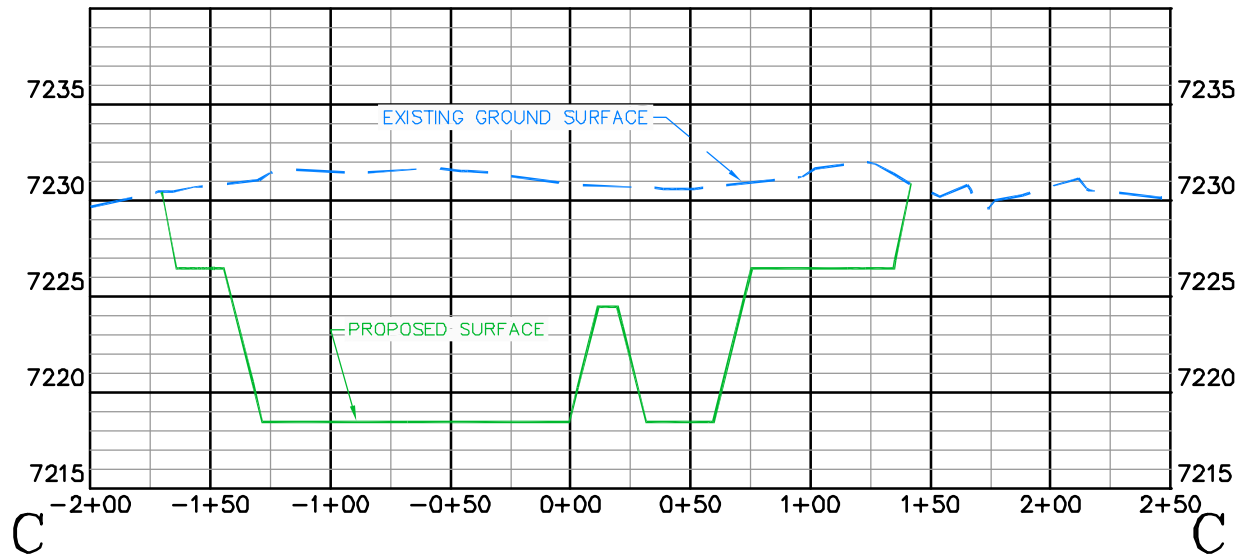
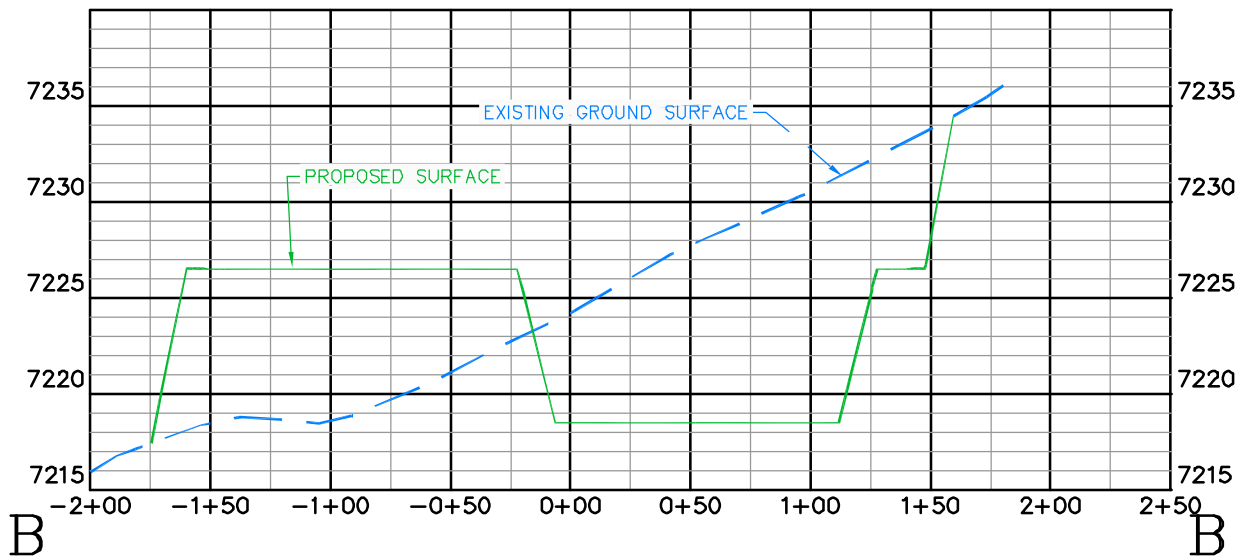
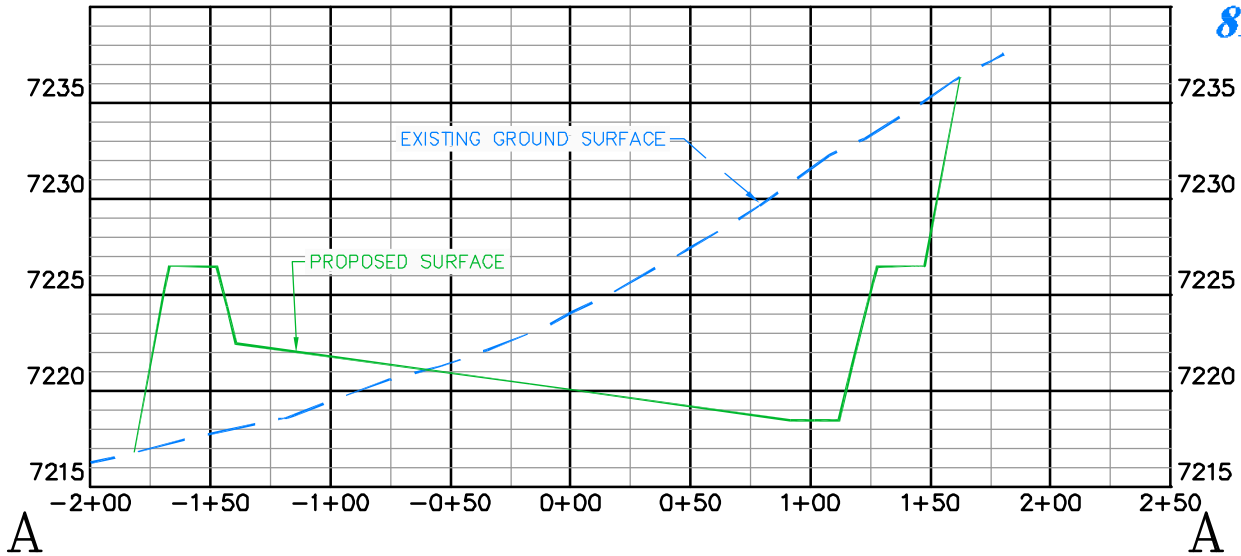

SANDRIDGE 399-1-3 PAD



RIFFIN & ASSOCIATES, INC.
1414 ELK ST., ROCK SPRINGS, WY 82901

(307) 362-5028

DRAWN: 7/29/10 - DEH

HORZ. 1" = 80' VERT. 1" = 10'

REVISED: N/A

DRG JOB No. 17957

EXHIBIT 3

CONSTRUCTION LAYOUT DRAWING 2 OF 2

WILLIAMS PRODUCTION RMT COMPANY
SANDRIDGE 399-1-3 MULTI WELL PIT
SWNW, SECTION 1, T3S, R99W, 6th P.M.
RIO BLANCO COUNTY, COLORADO

PAD GRADE: 7226.5'
PIT BOTTOM: 7218.5'