



# **WEXPRO COMPANY**

**COLORADO (MOFFAT COUNTY)  
SEC. 8 TWP. 11N RGE. 97W 6th P.M.  
B.W. MUSSER #44**

**ORIGINAL WELLBORE**

**09 December, 2010**

**Plan: PROPOSAL #1**



Project: COLORADO (MOFFAT COUNTY)  
Site: SEC. 8 TWP. 11N RGE. 97W 6th P.M.  
Well: B.W. MUSSER #44  
Wellbore: ORIGINAL WELLBORE  
Design: PROPOSAL #1

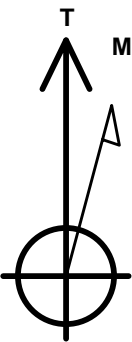
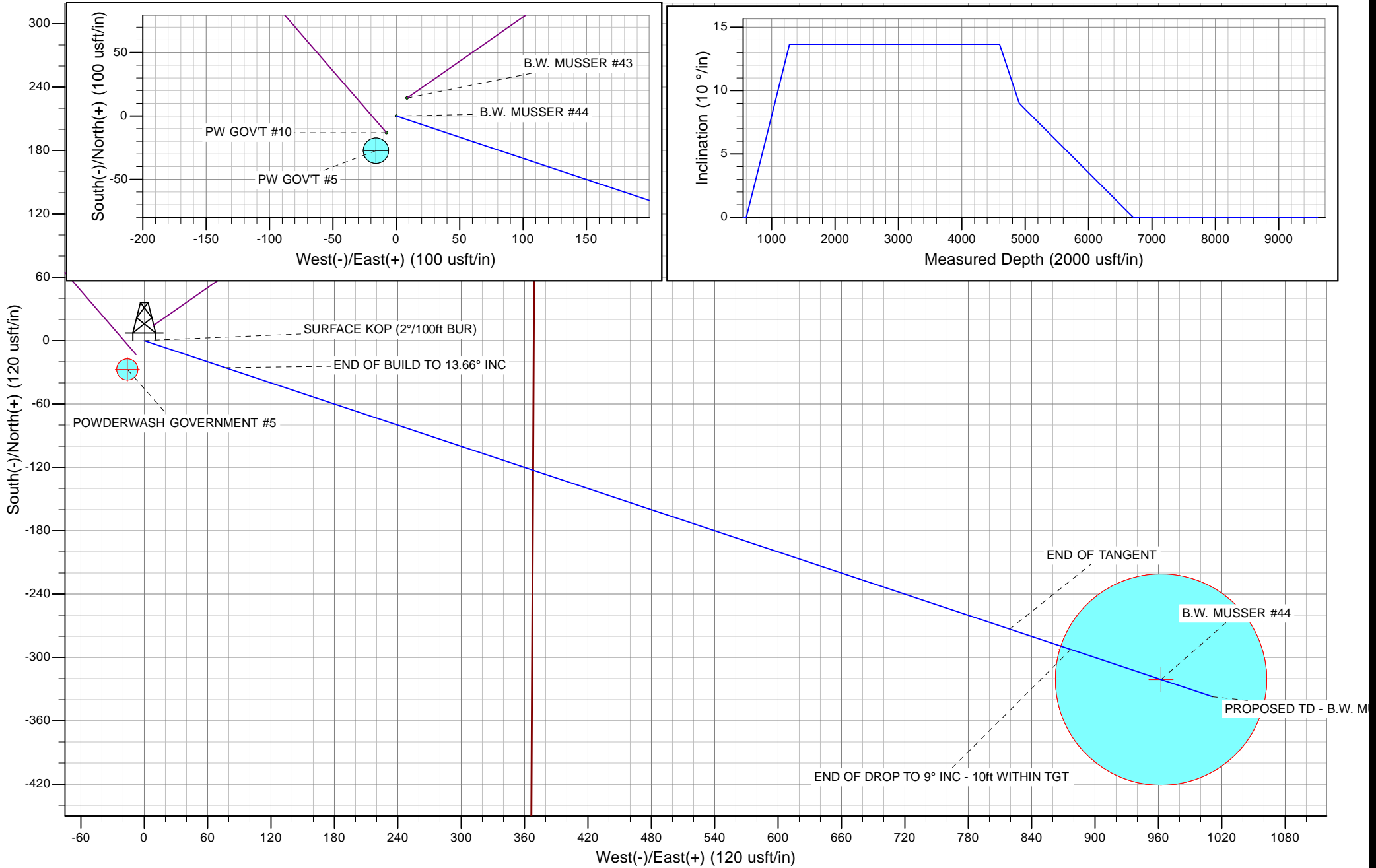
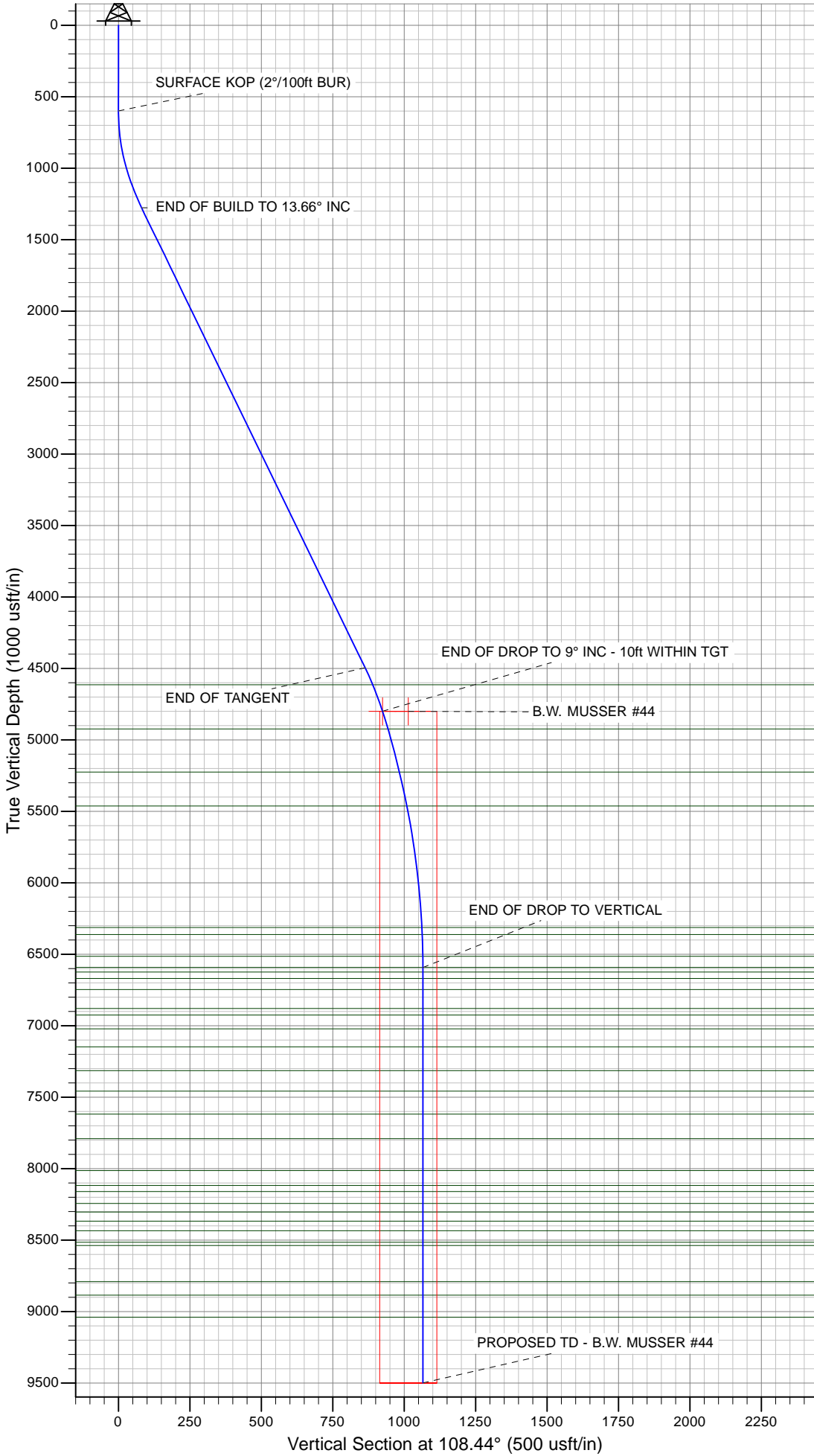

Azimuths to True North  
Magnetic North: 10.75°  
  
Magnetic Field  
Strength: 53023.2snT  
Dip Angle: 66.87°  
Date: 09/12/2010  
Model: IGRF2010

ANNOTATIONS								Annotation	
TVD	MD	Inc	Azi	+N/-S	+E/-W	VSect			
600.0	600.0	0.00	0.00	0.0	0.0	0.0			SURFACE KOP (2°/100ft BUR)
1276.7	1283.2	13.66	108.44	-25.6	76.9	81.1			END OF BUILD TO 13.66° INC
4495.2	4595.4	13.66	108.44	-273.1	819.2	863.5			END OF TANGENT
4800.0	4906.3	9.00	108.44	-292.5	877.1	924.6			EOD TO 9° INC - 10ft WITHIN TGT
6592.6	6706.3	0.00	0.00	-337.1	1011.0	1065.7			END OF DROP TO VERTICAL
9500.0	9613.7	0.00	0.00	-337.1	1011.0	1065.7			PROPOSED TD - B.W. MUSSER #44

# Planning Report

<b>Database:</b>	EDM_5000_1_7	<b>Local Co-ordinate Reference:</b>	Well B.W. MUSSER #44
<b>Company:</b>	WEXPRO COMPANY	<b>TVD Reference:</b>	KB-EST @ 6785.0usft (Original Well Elev)
<b>Project:</b>	COLORADO (MOFFAT COUNTY)	<b>MD Reference:</b>	KB-EST @ 6785.0usft (Original Well Elev)
<b>Site:</b>	SEC. 8 TWP. 11N RGE. 97W 6th P.M.	<b>North Reference:</b>	True
<b>Well:</b>	B.W. MUSSER #44	<b>Survey Calculation Method:</b>	Minimum Curvature
<b>Wellbore:</b>	ORIGINAL WELLBORE		
<b>Design:</b>	PROPOSAL #1		

<b>Project</b>	COLORADO (MOFFAT COUNTY)		
<b>Map System:</b>	US State Plane 1983	<b>System Datum:</b>	Mean Sea Level
<b>Geo Datum:</b>	North American Datum 1983		
<b>Map Zone:</b>	Colorado Northern Zone		Using geodetic scale factor

<b>Site</b>	SEC. 8 TWP. 11N RGE. 97W 6th P.M.		
<b>Site Position:</b>		<b>Northing:</b>	1,592,772.28 usft
<b>From:</b>	Lat/Long	<b>Easting:</b>	2,224,268.54 usft
<b>Position Uncertainty:</b>	0.0 usft	<b>Slot Radius:</b>	13-3/16"
		<b>Latitude:</b>	40° 55' 36.530 N
		<b>Longitude:</b>	108° 18' 27.259 W
		<b>Grid Convergence:</b>	-1.81 °

<b>Well</b>	B.W. MUSSER #44		
<b>Well Position</b>	<b>+N-S</b>	27.3 usft	<b>Northing:</b>
	<b>+E-W</b>	16.0 usft	<b>Easting:</b>
<b>Position Uncertainty</b>		0.0 usft	<b>Wellhead Elevation:</b>
			<b>Latitude:</b>
			<b>Longitude:</b>
			<b>Ground Level:</b>

<b>Wellbore</b>	ORIGINAL WELLBORE				
<b>Magnetics</b>	<b>Model Name</b>	<b>Sample Date</b>	<b>Declination (°)</b>	<b>Dip Angle (°)</b>	<b>Field Strength (nT)</b>
	IGRF2010	09/12/2010	10.75	66.87	53,023

<b>Design</b>	PROPOSAL #1				
---------------	-------------	--	--	--	--

<b>Audit Notes:</b>					
<b>Version:</b>	<b>Phase:</b>	PROTOTYPE	<b>Tie On Depth:</b>	0.0	
<b>Vertical Section:</b>	<b>Depth From (TVD) (usft)</b>	<b>+N-S (usft)</b>	<b>+E-W (usft)</b>	<b>Direction (°)</b>	
	4,800.0	0.0	0.0	108.44	

<b>Plan Sections</b>											
MD (usft)	Inc (°)	Azi (°)	Vertical Depth	SS (usft)	+N-S (usft)	+E-W (usft)	Dogleg Rate (°/100usft)	Build Rate (°/100usft)	Turn Rate (°/100usft)	TFO (°)	Target
0.0	0.00	0.00	0.0	-6,785.0	0.0	0.0	0.00	0.00	0.00	0.00	
600.0	0.00	0.00	600.0	-6,185.0	0.0	0.0	0.00	0.00	0.00	0.00	
1,283.2	13.66	108.44	1,276.7	-5,508.3	-25.6	76.9	2.00	2.00	0.00	108.44	
4,595.4	13.66	108.44	4,495.2	-2,289.8	-273.1	819.2	0.00	0.00	0.00	0.00	
4,906.3	9.00	108.44	4,800.0	-1,985.0	-292.5	877.1	1.50	-1.50	0.00	180.00	10ft WITHIN B.W. N
6,706.3	0.00	0.00	6,592.6	-192.4	-337.1	1,011.0	0.50	-0.50	0.00	180.00	
9,613.7	0.00	0.00	9,500.0	2,715.0	-337.1	1,011.0	0.00	0.00	0.00	0.00	

# Planning Report

<b>Database:</b>	EDM_5000_1_7	<b>Local Co-ordinate Reference:</b>	Well B.W. MUSSER #44
<b>Company:</b>	WEXPRO COMPANY	<b>TVD Reference:</b>	KB-EST @ 6785.0usft (Original Well Elev)
<b>Project:</b>	COLORADO (MOFFAT COUNTY)	<b>MD Reference:</b>	KB-EST @ 6785.0usft (Original Well Elev)
<b>Site:</b>	SEC. 8 TWP. 11N RGE. 97W 6th P.M.	<b>North Reference:</b>	True
<b>Well:</b>	B.W. MUSSER #44	<b>Survey Calculation Method:</b>	Minimum Curvature
<b>Wellbore:</b>	ORIGINAL WELLBORE		
<b>Design:</b>	PROPOSAL #1		

## Planned Survey

MD (usft)	Inc (°)	Azi (°)	TVD (usft)	SS (usft)	+N/-S (usft)	+E/-W (usft)	Vertical Section (usft)	Dogleg Rate (°/100usft)	Build Rate (°/100usft)	Turn Rate (°/100usft)
<b>SURFACE KOP (2°/100ft BUR)</b>										
600.0	0.00	0.00	600.0	6,185.00	0.0	0.0	0.0	0.00	0.00	0.00
700.0	2.00	108.44	700.0	6,085.02	-0.6	1.7	1.7	2.00	2.00	0.00
800.0	4.00	108.44	799.8	5,985.16	-2.2	6.6	7.0	2.00	2.00	0.00
900.0	6.00	108.44	899.5	5,885.55	-5.0	14.9	15.7	2.00	2.00	0.00
1,000.0	8.00	108.44	998.7	5,786.30	-8.8	26.4	27.9	2.00	2.00	0.00
1,100.0	10.00	108.44	1,097.5	5,687.53	-13.8	41.3	43.5	2.00	2.00	0.00
1,200.0	12.00	108.44	1,195.6	5,589.38	-19.8	59.4	62.6	2.00	2.00	0.00
<b>END OF BUILD TO 13.66° INC</b>										
1,283.2	13.66	108.44	1,276.7	5,508.25	-25.6	76.9	81.1	2.00	2.00	0.00
1,300.0	13.66	108.44	1,293.1	5,491.93	-26.9	80.7	85.0	0.00	0.00	0.00
1,400.0	13.66	108.44	1,390.2	5,394.76	-34.4	103.1	108.7	0.00	0.00	0.00
1,500.0	13.66	108.44	1,487.4	5,297.59	-41.8	125.5	132.3	0.00	0.00	0.00
1,600.0	13.66	108.44	1,584.6	5,200.42	-49.3	147.9	155.9	0.00	0.00	0.00
1,700.0	13.66	108.44	1,681.7	5,103.25	-56.8	170.3	179.5	0.00	0.00	0.00
1,800.0	13.66	108.44	1,778.9	5,006.08	-64.3	192.7	203.2	0.00	0.00	0.00
1,900.0	13.66	108.44	1,876.1	4,908.91	-71.7	215.1	226.8	0.00	0.00	0.00
2,000.0	13.66	108.44	1,973.3	4,811.74	-79.2	237.6	250.4	0.00	0.00	0.00
2,100.0	13.66	108.44	2,070.4	4,714.58	-86.7	260.0	274.0	0.00	0.00	0.00
2,200.0	13.66	108.44	2,167.6	4,617.41	-94.2	282.4	297.7	0.00	0.00	0.00
2,300.0	13.66	108.44	2,264.8	4,520.24	-101.6	304.8	321.3	0.00	0.00	0.00
2,400.0	13.66	108.44	2,361.9	4,423.07	-109.1	327.2	344.9	0.00	0.00	0.00
2,500.0	13.66	108.44	2,459.1	4,325.90	-116.6	349.6	368.5	0.00	0.00	0.00
2,600.0	13.66	108.44	2,556.3	4,228.73	-124.0	372.0	392.1	0.00	0.00	0.00
2,700.0	13.66	108.44	2,653.4	4,131.56	-131.5	394.4	415.8	0.00	0.00	0.00
2,800.0	13.66	108.44	2,750.6	4,034.39	-139.0	416.8	439.4	0.00	0.00	0.00
2,900.0	13.66	108.44	2,847.8	3,937.22	-146.5	439.2	463.0	0.00	0.00	0.00
3,000.0	13.66	108.44	2,945.0	3,840.05	-153.9	461.7	486.6	0.00	0.00	0.00
3,100.0	13.66	108.44	3,042.1	3,742.88	-161.4	484.1	510.3	0.00	0.00	0.00
3,200.0	13.66	108.44	3,139.3	3,645.71	-168.9	506.5	533.9	0.00	0.00	0.00
3,300.0	13.66	108.44	3,236.5	3,548.54	-176.3	528.9	557.5	0.00	0.00	0.00
3,400.0	13.66	108.44	3,333.6	3,451.37	-183.8	551.3	581.1	0.00	0.00	0.00
3,500.0	13.66	108.44	3,430.8	3,354.20	-191.3	573.7	604.8	0.00	0.00	0.00
3,600.0	13.66	108.44	3,528.0	3,257.03	-198.8	596.1	628.4	0.00	0.00	0.00
3,700.0	13.66	108.44	3,625.1	3,159.86	-206.2	618.5	652.0	0.00	0.00	0.00
3,800.0	13.66	108.44	3,722.3	3,062.69	-213.7	640.9	675.6	0.00	0.00	0.00
3,900.0	13.66	108.44	3,819.5	2,965.52	-221.2	663.3	699.2	0.00	0.00	0.00
4,000.0	13.66	108.44	3,916.7	2,868.35	-228.7	685.8	722.9	0.00	0.00	0.00
4,100.0	13.66	108.44	4,013.8	2,771.18	-236.1	708.2	746.5	0.00	0.00	0.00
4,200.0	13.66	108.44	4,111.0	2,674.01	-243.6	730.6	770.1	0.00	0.00	0.00
4,300.0	13.66	108.44	4,208.2	2,576.84	-251.1	753.0	793.7	0.00	0.00	0.00
4,400.0	13.66	108.44	4,305.3	2,479.67	-258.5	775.4	817.4	0.00	0.00	0.00
4,500.0	13.66	108.44	4,402.5	2,382.50	-266.0	797.8	841.0	0.00	0.00	0.00
<b>END OF TANGENT</b>										
4,595.4	13.66	108.44	4,495.2	2,289.79	-273.1	819.2	863.5	0.00	0.00	0.00
4,600.0	13.60	108.44	4,499.7	2,285.33	-273.5	820.2	864.6	1.50	-1.50	0.00
4,700.0	12.10	108.44	4,597.2	2,187.84	-280.5	841.3	886.8	1.50	-1.50	0.00
<b>A-4-G SD</b>										
4,717.2	11.84	108.44	4,614.0	2,171.00	-281.6	844.7	890.4	1.50	-1.50	0.00
4,800.0	10.60	108.44	4,695.2	2,089.79	-286.7	860.0	906.5	1.50	-1.50	0.00
4,900.0	9.10	108.44	4,793.7	1,991.27	-292.1	876.2	923.6	1.50	-1.50	0.00
<b>END OF DROP TO 9° INC - 10ft WITHIN TGT</b>										
4,906.3	9.00	108.44	4,800.0	1,985.00	-292.5	877.1	924.6	1.50	-1.50	0.00
5,000.0	8.53	108.44	4,892.6	1,892.44	-297.0	890.7	938.9	0.50	-0.50	0.00

# Planning Report

<b>Database:</b>	EDM_5000_1_7	<b>Local Co-ordinate Reference:</b>	Well B.W. MUSSER #44
<b>Company:</b>	WEXPRO COMPANY	<b>TVD Reference:</b>	KB-EST @ 6785.0usft (Original Well Elev)
<b>Project:</b>	COLORADO (MOFFAT COUNTY)	<b>MD Reference:</b>	KB-EST @ 6785.0usft (Original Well Elev)
<b>Site:</b>	SEC. 8 TWP. 11N RGE. 97W 6th P.M.	<b>North Reference:</b>	True
<b>Well:</b>	B.W. MUSSER #44	<b>Survey Calculation Method:</b>	Minimum Curvature
<b>Wellbore:</b>	ORIGINAL WELLBORE		
<b>Design:</b>	PROPOSAL #1		

## Planned Survey

MD (usft)	Inc (°)	Azi (°)	TVD (usft)	SS (usft)	+N/-S (usft)	+E/-W (usft)	Vertical Section (usft)	Dogleg Rate (°/100usft)	Build Rate (°/100usft)	Turn Rate (°/100usft)
<b>(BIG WATER SD)</b>										
5,030.8	8.38	108.44	4,923.0	1,862.00	-298.4	895.0	943.4	0.50	-0.50	0.00
5,100.0	8.03	108.44	4,991.5	1,793.48	-301.5	904.3	953.3	0.50	-0.50	0.00
5,200.0	7.53	108.44	5,090.6	1,694.41	-305.8	917.2	966.8	0.50	-0.50	0.00
5,300.0	7.03	108.44	5,189.8	1,595.21	-309.8	929.2	979.5	0.50	-0.50	0.00
<b>A-4-H SD</b>										
5,335.5	6.85	108.44	5,225.0	1,560.00	-311.2	933.3	983.8	0.50	-0.50	0.00
5,400.0	6.53	108.44	5,289.1	1,495.91	-313.6	940.4	991.3	0.50	-0.50	0.00
5,500.0	6.03	108.44	5,388.5	1,396.51	-317.0	950.8	1,002.2	0.50	-0.50	0.00
<b>FORT UNION FORMATION</b>										
5,573.9	5.66	108.44	5,462.0	1,323.00	-319.4	957.9	1,009.8	0.50	-0.50	0.00
5,600.0	5.53	108.44	5,488.0	1,297.02	-320.2	960.3	1,012.3	0.50	-0.50	0.00
5,700.0	5.03	108.44	5,587.6	1,197.45	-323.1	969.1	1,021.5	0.50	-0.50	0.00
5,800.0	4.53	108.44	5,687.2	1,097.80	-325.8	977.0	1,029.9	0.50	-0.50	0.00
5,900.0	4.03	108.44	5,786.9	998.08	-328.1	984.1	1,037.3	0.50	-0.50	0.00
6,000.0	3.53	108.44	5,886.7	898.29	-330.2	990.3	1,043.9	0.50	-0.50	0.00
6,100.0	3.03	108.44	5,986.5	798.46	-332.0	995.7	1,049.6	0.50	-0.50	0.00
6,200.0	2.53	108.44	6,086.4	698.58	-333.5	1,000.4	1,054.5	0.50	-0.50	0.00
6,300.0	2.03	108.44	6,186.3	598.66	-334.8	1,004.1	1,058.5	0.50	-0.50	0.00
6,400.0	1.53	108.44	6,286.3	498.70	-335.8	1,007.1	1,061.6	0.50	-0.50	0.00
<b>L.F.U. ALLEN 8A</b>										
6,425.7	1.40	108.44	6,312.0	473.00	-336.0	1,007.7	1,062.2	0.50	-0.50	0.00
<b>L.F.U. ALLEN 8B</b>										
6,474.7	1.16	108.44	6,361.0	424.00	-336.3	1,008.7	1,063.3	0.50	-0.50	0.00
6,500.0	1.03	108.44	6,386.3	398.73	-336.5	1,009.2	1,063.8	0.50	-0.50	0.00
6,600.0	0.53	108.44	6,486.3	298.74	-336.9	1,010.5	1,065.2	0.50	-0.50	0.00
<b>L.F.U. ALLEN 8E</b>										
6,627.7	0.39	108.44	6,514.0	271.00	-337.0	1,010.7	1,065.4	0.50	-0.50	0.00
6,700.0	0.03	108.44	6,586.3	198.74	-337.1	1,011.0	1,065.7	0.50	-0.50	0.00
<b>L.F.U. ALLEN 8E1</b>										
6,704.7	0.01	108.44	6,591.0	194.00	-337.1	1,011.0	1,065.7	0.50	-0.50	0.00
<b>END OF DROP TO VERTICAL</b>										
6,706.3	0.00	0.00	6,592.6	192.39	-337.1	1,011.0	1,065.7	0.50	-0.50	0.00
<b>L.F.U. ALLEN 8F</b>										
6,737.7	0.00	0.00	6,624.0	161.00	-337.1	1,011.0	1,065.7	0.00	0.00	0.00
<b>L.F.U. ALLEN 8G</b>										
6,782.7	0.00	0.00	6,669.0	116.00	-337.1	1,011.0	1,065.7	0.00	0.00	0.00
6,800.0	0.00	0.00	6,686.3	98.74	-337.1	1,011.0	1,065.7	0.00	0.00	0.00
<b>L.F.U. ALLEN 8H</b>										
6,859.7	0.00	0.00	6,746.0	39.00	-337.1	1,011.0	1,065.7	0.00	0.00	0.00
6,900.0	0.00	0.00	6,786.3	-1.26	-337.1	1,011.0	1,065.7	0.00	0.00	0.00
<b>L.F.U. ALLEN 9A</b>										
6,992.7	0.00	0.00	6,879.0	-94.00	-337.1	1,011.0	1,065.7	0.00	0.00	0.00
7,000.0	0.00	0.00	6,886.3	-101.26	-337.1	1,011.0	1,065.7	0.00	0.00	0.00
<b>L.F.U. ALLEN 9B</b>										
7,038.7	0.00	0.00	6,925.0	-140.00	-337.1	1,011.0	1,065.7	0.00	0.00	0.00
7,100.0	0.00	0.00	6,986.3	-201.26	-337.1	1,011.0	1,065.7	0.00	0.00	0.00
<b>L.F.U. ALLEN 9C</b>										
7,134.7	0.00	0.00	7,021.0	-236.00	-337.1	1,011.0	1,065.7	0.00	0.00	0.00
7,200.0	0.00	0.00	7,086.3	-301.26	-337.1	1,011.0	1,065.7	0.00	0.00	0.00
<b>L.F.U. ALLEN 11</b>										
7,260.7	0.00	0.00	7,147.0	-362.00	-337.1	1,011.0	1,065.7	0.00	0.00	0.00

# Planning Report

<b>Database:</b>	EDM_5000_1_7	<b>Local Co-ordinate Reference:</b>	Well B.W. MUSSER #44
<b>Company:</b>	WEXPRO COMPANY	<b>TVD Reference:</b>	KB-EST @ 6785.0usft (Original Well Elev)
<b>Project:</b>	COLORADO (MOFFAT COUNTY)	<b>MD Reference:</b>	KB-EST @ 6785.0usft (Original Well Elev)
<b>Site:</b>	SEC. 8 TWP. 11N RGE. 97W 6th P.M.	<b>North Reference:</b>	True
<b>Well:</b>	B.W. MUSSER #44	<b>Survey Calculation Method:</b>	Minimum Curvature
<b>Wellbore:</b>	ORIGINAL WELLBORE		
<b>Design:</b>	PROPOSAL #1		

## Planned Survey

MD (usft)	Inc (°)	Azi (°)	TVD (usft)	SS (usft)	+N/-S (usft)	+E/-W (usft)	Vertical Section (usft)	Dogleg Rate (°/100usft)	Build Rate (°/100usft)	Turn Rate (°/100usft)
7,300.0	0.00	0.00	7,186.3	-401.26	-337.1	1,011.0	1,065.7	0.00	0.00	0.00
7,400.0	0.00	0.00	7,286.3	-501.26	-337.1	1,011.0	1,065.7	0.00	0.00	0.00
<b>L.F.U. ALLEN 11A</b>										
<b>7,427.7</b>	<b>0.00</b>	<b>0.00</b>	<b>7,314.0</b>	<b>-529.00</b>	<b>-337.1</b>	<b>1,011.0</b>	<b>1,065.7</b>	<b>0.00</b>	<b>0.00</b>	<b>0.00</b>
7,500.0	0.00	0.00	7,386.3	-601.26	-337.1	1,011.0	1,065.7	0.00	0.00	0.00
<b>L.F.U. ALLEN 11B</b>										
<b>7,570.7</b>	<b>0.00</b>	<b>0.00</b>	<b>7,457.0</b>	<b>-672.00</b>	<b>-337.1</b>	<b>1,011.0</b>	<b>1,065.7</b>	<b>0.00</b>	<b>0.00</b>	<b>0.00</b>
7,600.0	0.00	0.00	7,486.3	-701.26	-337.1	1,011.0	1,065.7	0.00	0.00	0.00
7,700.0	0.00	0.00	7,586.3	-801.26	-337.1	1,011.0	1,065.7	0.00	0.00	0.00
<b>L.F.U. ALLEN 11C</b>										
<b>7,731.7</b>	<b>0.00</b>	<b>0.00</b>	<b>7,618.0</b>	<b>-833.00</b>	<b>-337.1</b>	<b>1,011.0</b>	<b>1,065.7</b>	<b>0.00</b>	<b>0.00</b>	<b>0.00</b>
7,800.0	0.00	0.00	7,686.3	-901.26	-337.1	1,011.0	1,065.7	0.00	0.00	0.00
7,900.0	0.00	0.00	7,786.3	-1,001.26	-337.1	1,011.0	1,065.7	0.00	0.00	0.00
<b>L.F.U. 4600</b>										
<b>7,903.7</b>	<b>0.00</b>	<b>0.00</b>	<b>7,790.0</b>	<b>-1,005.00</b>	<b>-337.1</b>	<b>1,011.0</b>	<b>1,065.7</b>	<b>0.00</b>	<b>0.00</b>	<b>0.00</b>
8,000.0	0.00	0.00	7,886.3	-1,101.26	-337.1	1,011.0	1,065.7	0.00	0.00	0.00
8,100.0	0.00	0.00	7,986.3	-1,201.26	-337.1	1,011.0	1,065.7	0.00	0.00	0.00
<b>L.F.U. ALLEN 10A</b>										
<b>8,126.7</b>	<b>0.00</b>	<b>0.00</b>	<b>8,013.0</b>	<b>-1,228.00</b>	<b>-337.1</b>	<b>1,011.0</b>	<b>1,065.7</b>	<b>0.00</b>	<b>0.00</b>	<b>0.00</b>
8,200.0	0.00	0.00	8,086.3	-1,301.26	-337.1	1,011.0	1,065.7	0.00	0.00	0.00
<b>L.F.U. ALLEN 10B</b>										
<b>8,230.7</b>	<b>0.00</b>	<b>0.00</b>	<b>8,117.0</b>	<b>-1,332.00</b>	<b>-337.1</b>	<b>1,011.0</b>	<b>1,065.7</b>	<b>0.00</b>	<b>0.00</b>	<b>0.00</b>
<b>L.F.U. ALLEN 10C</b>										
<b>8,273.7</b>	<b>0.00</b>	<b>0.00</b>	<b>8,160.0</b>	<b>-1,375.00</b>	<b>-337.1</b>	<b>1,011.0</b>	<b>1,065.7</b>	<b>0.00</b>	<b>0.00</b>	<b>0.00</b>
8,300.0	0.00	0.00	8,186.3	-1,401.26	-337.1	1,011.0	1,065.7	0.00	0.00	0.00
<b>L.F.U. ALLEN 6</b>										
<b>8,356.7</b>	<b>0.00</b>	<b>0.00</b>	<b>8,243.0</b>	<b>-1,458.00</b>	<b>-337.1</b>	<b>1,011.0</b>	<b>1,065.7</b>	<b>0.00</b>	<b>0.00</b>	<b>0.00</b>
8,400.0	0.00	0.00	8,286.3	-1,501.26	-337.1	1,011.0	1,065.7	0.00	0.00	0.00
<b>L.F.U. ALLEN 6A</b>										
<b>8,416.7</b>	<b>0.00</b>	<b>0.00</b>	<b>8,303.0</b>	<b>-1,518.00</b>	<b>-337.1</b>	<b>1,011.0</b>	<b>1,065.7</b>	<b>0.00</b>	<b>0.00</b>	<b>0.00</b>
<b>L.F.U. ALLEN 6B</b>										
<b>8,480.7</b>	<b>0.00</b>	<b>0.00</b>	<b>8,367.0</b>	<b>-1,582.00</b>	<b>-337.1</b>	<b>1,011.0</b>	<b>1,065.7</b>	<b>0.00</b>	<b>0.00</b>	<b>0.00</b>
8,500.0	0.00	0.00	8,386.3	-1,601.26	-337.1	1,011.0	1,065.7	0.00	0.00	0.00
<b>L.F.U. ALLEN 6C</b>										
<b>8,547.7</b>	<b>0.00</b>	<b>0.00</b>	<b>8,434.0</b>	<b>-1,649.00</b>	<b>-337.1</b>	<b>1,011.0</b>	<b>1,065.7</b>	<b>0.00</b>	<b>0.00</b>	<b>0.00</b>
8,600.0	0.00	0.00	8,486.3	-1,701.26	-337.1	1,011.0	1,065.7	0.00	0.00	0.00
<b>L.F.U. ALLEN 6D</b>										
<b>8,628.7</b>	<b>0.00</b>	<b>0.00</b>	<b>8,515.0</b>	<b>-1,730.00</b>	<b>-337.1</b>	<b>1,011.0</b>	<b>1,065.7</b>	<b>0.00</b>	<b>0.00</b>	<b>0.00</b>
<b>L.F.U. ALLEN 6E</b>										
<b>8,650.7</b>	<b>0.00</b>	<b>0.00</b>	<b>8,537.0</b>	<b>-1,752.00</b>	<b>-337.1</b>	<b>1,011.0</b>	<b>1,065.7</b>	<b>0.00</b>	<b>0.00</b>	<b>0.00</b>
8,700.0	0.00	0.00	8,586.3	-1,801.26	-337.1	1,011.0	1,065.7	0.00	0.00	0.00
8,800.0	0.00	0.00	8,686.3	-1,901.26	-337.1	1,011.0	1,065.7	0.00	0.00	0.00
8,900.0	0.00	0.00	8,786.3	-2,001.26	-337.1	1,011.0	1,065.7	0.00	0.00	0.00
<b>L.F.U. ALLEN 6G</b>										
<b>8,903.7</b>	<b>0.00</b>	<b>0.00</b>	<b>8,790.0</b>	<b>-2,005.00</b>	<b>-337.1</b>	<b>1,011.0</b>	<b>1,065.7</b>	<b>0.00</b>	<b>0.00</b>	<b>0.00</b>
<b>L.F.U. ALLEN 6H</b>										
<b>8,998.7</b>	<b>0.00</b>	<b>0.00</b>	<b>8,885.0</b>	<b>-2,100.00</b>	<b>-337.1</b>	<b>1,011.0</b>	<b>1,065.7</b>	<b>0.00</b>	<b>0.00</b>	<b>0.00</b>
9,000.0	0.00	0.00	8,886.3	-2,101.26	-337.1	1,011.0	1,065.7	0.00	0.00	0.00
9,100.0	0.00	0.00	8,986.3	-2,201.26	-337.1	1,011.0	1,065.7	0.00	0.00	0.00
<b>L.F.U. ALLEN 6K</b>										
<b>9,152.7</b>	<b>0.00</b>	<b>0.00</b>	<b>9,039.0</b>	<b>-2,254.00</b>	<b>-337.1</b>	<b>1,011.0</b>	<b>1,065.7</b>	<b>0.00</b>	<b>0.00</b>	<b>0.00</b>
9,200.0	0.00	0.00	9,086.3	-2,301.26	-337.1	1,011.0	1,065.7	0.00	0.00	0.00

# Planning Report

<b>Database:</b>	EDM_5000_1_7	<b>Local Co-ordinate Reference:</b>	Well B.W. MUSSER #44
<b>Company:</b>	WEXPRO COMPANY	<b>TVD Reference:</b>	KB-EST @ 6785.0usft (Original Well Elev)
<b>Project:</b>	COLORADO (MOFFAT COUNTY)	<b>MD Reference:</b>	KB-EST @ 6785.0usft (Original Well Elev)
<b>Site:</b>	SEC. 8 TWP. 11N RGE. 97W 6th P.M.	<b>North Reference:</b>	True
<b>Well:</b>	B.W. MUSSER #44	<b>Survey Calculation Method:</b>	Minimum Curvature
<b>Wellbore:</b>	ORIGINAL WELLBORE		
<b>Design:</b>	PROPOSAL #1		

Planned Survey										
MD (usft)	Inc (°)	Azi (°)	TVD (usft)	SS (usft)	+N/-S (usft)	+E/-W (usft)	Vertical Section (usft)	Dogleg Rate (°/100usft)	Build Rate (°/100usft)	Turn Rate (°/100usft)
9,300.0	0.00	0.00	9,186.3	-2,401.26	-337.1	1,011.0	1,065.7	0.00	0.00	0.00
9,400.0	0.00	0.00	9,286.3	-2,501.26	-337.1	1,011.0	1,065.7	0.00	0.00	0.00
9,500.0	0.00	0.00	9,386.3	-2,601.26	-337.1	1,011.0	1,065.7	0.00	0.00	0.00
9,600.0	0.00	0.00	9,486.3	-2,701.26	-337.1	1,011.0	1,065.7	0.00	0.00	0.00
<b>PROPOSED TD - B.W. MUSSER #44</b>										
<b>9,613.7</b>	<b>0.00</b>	<b>0.00</b>	<b>9,500.0</b>	<b>-2,715.00</b>	<b>-337.1</b>	<b>1,011.0</b>	<b>1,065.7</b>	<b>0.00</b>	<b>0.00</b>	<b>0.00</b>

Formations						
MD (usft)	TVD (usft)	Name	Lithology	Dip (°)	Dip Direction (°)	
4,717.2	4,614.0	A-4-G SD				
5,030.8	4,923.0	(BIG WATER SD)				
5,335.5	5,225.0	A-4-H SD				
5,573.9	5,462.0	FORT UNION FORMATION				
6,425.7	6,312.0	L.F.U. ALLEN 8A				
6,474.7	6,361.0	L.F.U. ALLEN 8B				
6,627.7	6,514.0	L.F.U. ALLEN 8E				
6,704.7	6,591.0	L.F.U. ALLEN 8E1				
6,737.7	6,624.0	L.F.U. ALLEN 8F				
6,782.7	6,669.0	L.F.U. ALLEN 8G				
6,859.7	6,746.0	L.F.U. ALLEN 8H				
6,992.7	6,879.0	L.F.U. ALLEN 9A				
7,038.7	6,925.0	L.F.U. ALLEN 9B				
7,134.7	7,021.0	L.F.U. ALLEN 9C				
7,260.7	7,147.0	L.F.U. ALLEN 11				
7,427.7	7,314.0	L.F.U. ALLEN 11A				
7,570.7	7,457.0	L.F.U. ALLEN 11B				
7,731.7	7,618.0	L.F.U. ALLEN 11C				
7,903.7	7,790.0	L.F.U 4600				
8,126.7	8,013.0	L.F.U. ALLEN 10A				
8,230.7	8,117.0	L.F.U. ALLEN 10B				
8,273.7	8,160.0	L.F.U. ALLEN 10C				
8,356.7	8,243.0	L.F.U. ALLEN 6				
8,416.7	8,303.0	L.F.U. ALLEN 6A				
8,480.7	8,367.0	L.F.U. ALLEN 6B				
8,547.7	8,434.0	L.F.U. ALLEN 6C				
8,628.7	8,515.0	L.F.U. ALLEN 6D				
8,650.7	8,537.0	L.F.U. ALLEN 6E				
8,903.7	8,790.0	L.F.U. ALLEN 6G				
8,998.7	8,885.0	L.F.U. ALLEN 6H				
9,152.7	9,039.0	L.F.U. ALLEN 6K				

## Planning Report

<b>Database:</b>	EDM_5000_1_7	<b>Local Co-ordinate Reference:</b>	Well B.W. MUSSER #44
<b>Company:</b>	WEXPRO COMPANY	<b>TVD Reference:</b>	KB-EST @ 6785.0usft (Original Well Elev)
<b>Project:</b>	COLORADO (MOFFAT COUNTY)	<b>MD Reference:</b>	KB-EST @ 6785.0usft (Original Well Elev)
<b>Site:</b>	SEC. 8 TWP. 11N RGE. 97W 6th P.M.	<b>North Reference:</b>	True
<b>Well:</b>	B.W. MUSSER #44	<b>Survey Calculation Method:</b>	Minimum Curvature
<b>Wellbore:</b>	ORIGINAL WELLBORE		
<b>Design:</b>	PROPOSAL #1		

Plan Annotations				
MD (usft)	TVD (usft)	Local Coordinates		Comment
		+N/-S (usft)	+E/-W (usft)	
600.0	600.0	0.0	0.0	SURFACE KOP (2°/100ft BUR)
1,283.2	1,276.7	-25.6	76.9	END OF BUILD TO 13.66° INC
4,595.4	4,495.2	-273.1	819.2	END OF TANGENT
4,906.3	4,800.0	-292.5	877.1	END OF DROP TO 9° INC - 10ft WITHIN TGT
6,706.3	6,592.6	-337.1	1,011.0	END OF DROP TO VERTICAL
9,613.7	9,500.0	-337.1	1,011.0	PROPOSED TD - B.W. MUSSER #44