

MESA ENERGY PARTNERS, LLC

SURFACE DISTURBANCE AREA FOR

BDU 15-10-199

SECTION 15, T1S, R99W, 6th P.M.
NW 1/4 SE 1/4

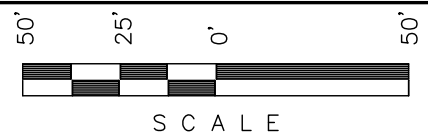

Sheet 7 of 11

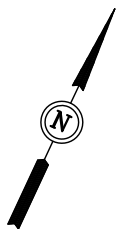

SCALE: 1" = 50'
DATE: 03-27-09
Drawn By: C.H.
REV: 04-09-09
REV: 04-17-09
REV: 05-14-09 C.H.
Revised: 07-07-09 D.R.B.
Revised: 09-22-09 D.R.B.
Revised: 12-17-10 D.R.B.

LINE	DIRECTION	LENGTH
L1	S57°27'34"E	23.77'
L2	N69°01'12"E	121.78'
L3	N66°37'30"E	150.63'
L4	S72°47'29"E	23.52'
L5	S29°42'15"E	144.49'
L6	S41°21'19"E	51.59'
L7	S85°40'19"E	44.41'
L8	S47°56'59"E	36.49'
L9	S19°21'38"E	48.70'
L10	S15°27'18"W	36.39'
L11	S15°45'11"E	44.60'
L12	S08°45'33"E	17.77'
L13	S03°56'12"W	46.19'
L14	S35°23'55"W	15.04'
L15	S64°13'40"W	68.46'
L16	S06°42'09"W	31.42'
L17	S53°56'18"W	54.20'
L18	N32°09'19"W	42.84'
L19	S68°21'46"W	49.68'
L20	S57°29'43"W	37.77'
L21	S58°51'46"W	49.11'
L22	S70°33'57"W	36.82'
L23	N69°03'35"W	36.44'
L24	N62°02'11"W	52.38'
L25	N42°32'03"W	24.78'
L26	N29°52'17"W	29.19'
L27	N02°56'13"E	22.69'
L28	N23°01'50"W	98.80'
L29	N41°39'49"W	33.61'
L30	N31°09'53"W	28.10'
L31	N23°43'38"W	55.22'
L32	N21°40'32"W	41.35'
L33	N02°45'37"W	54.62'
L34	N30°42'16"E	62.44'



FRAC. PIT
Total Pit Capacity
W/2' of Freeboard
= 3,810 Bbls. ±
Total Pit Volume
= 1,050 Cu. Yds.

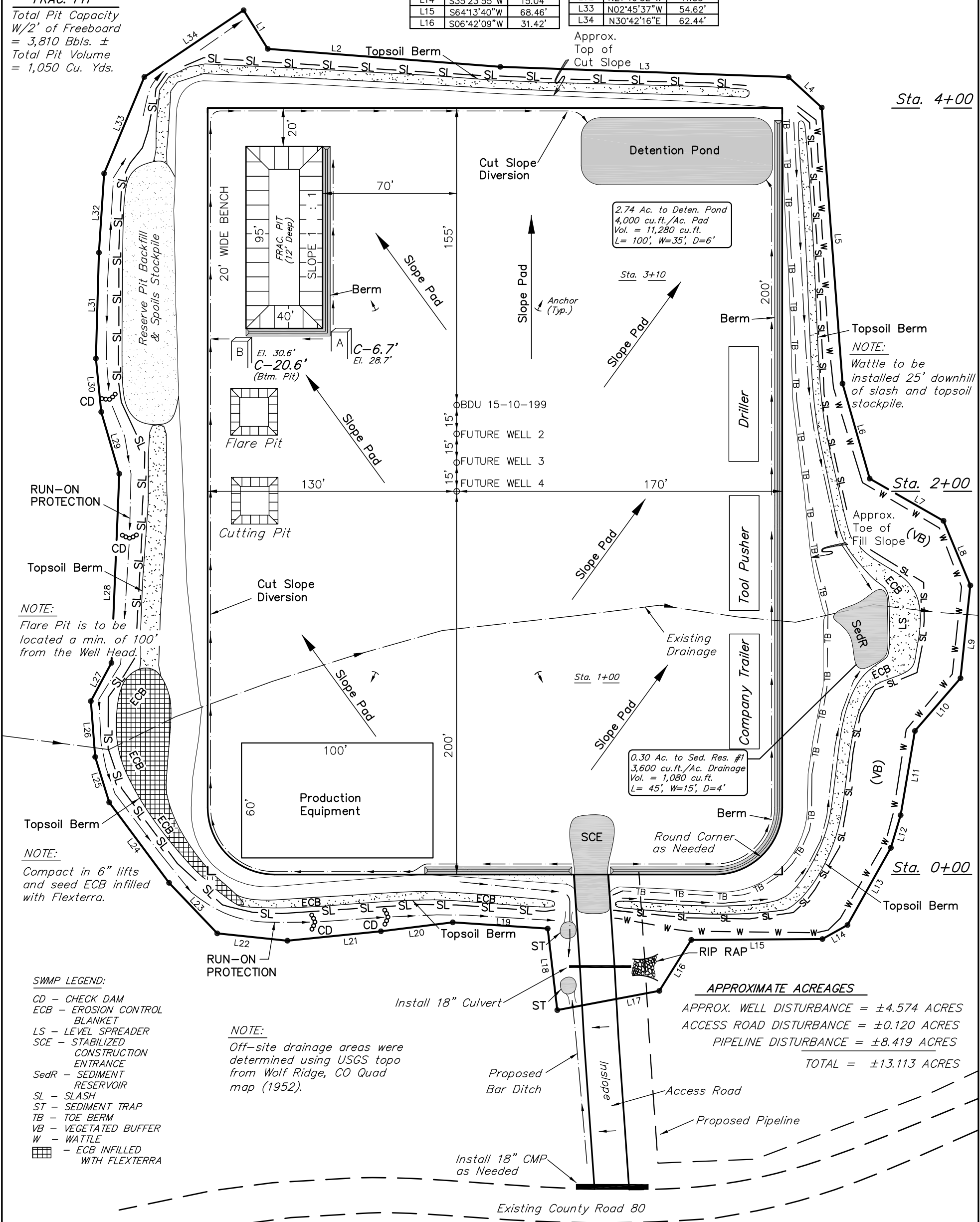

NOTE:
Flare Pit is to be located a min. of 100' from the Well Head.

NOTE:
Compact in 6" lifts and seed ECB infilled with Flexterra.

- SWMP LEGEND:**
- CD - CHECK DAM
 - ECB - EROSION CONTROL BLANKET
 - LS - LEVEL SPREADER
 - SCE - STABILIZED CONSTRUCTION ENTRANCE
 - SedR - SEDIMENT RESERVOIR
 - SL - SLASH
 - ST - SEDIMENT TRAP
 - TB - TOE BERM
 - VB - VEGETATED BUFFER
 - W - WATTLE
 - ECB INFILLED WITH FLEXTERRA

NOTE:
Off-site drainage areas were determined using USGS topo from Wolf Ridge, CO Quad map (1952).

APPROXIMATE ACREAGES
APPROX. WELL DISTURBANCE = ±4.574 ACRES
ACCESS ROAD DISTURBANCE = ±0.120 ACRES
PIPELINE DISTURBANCE = ±8.419 ACRES
TOTAL = ±13.113 ACRES