

WEXPRO COMPANY  
CONSTRUCTION LAYOUT FOR  
CARL ALLEN #40 & #41  
SECTION 28, T12N, R97W, 6th P.M.  
SW 1/4 SW 1/4

FIGURE #1

SCALE: 1" = 50'  
DATE: 09-02-10  
DRAWN BY: C.H.  
REVISED: 01-14-11 S.L.

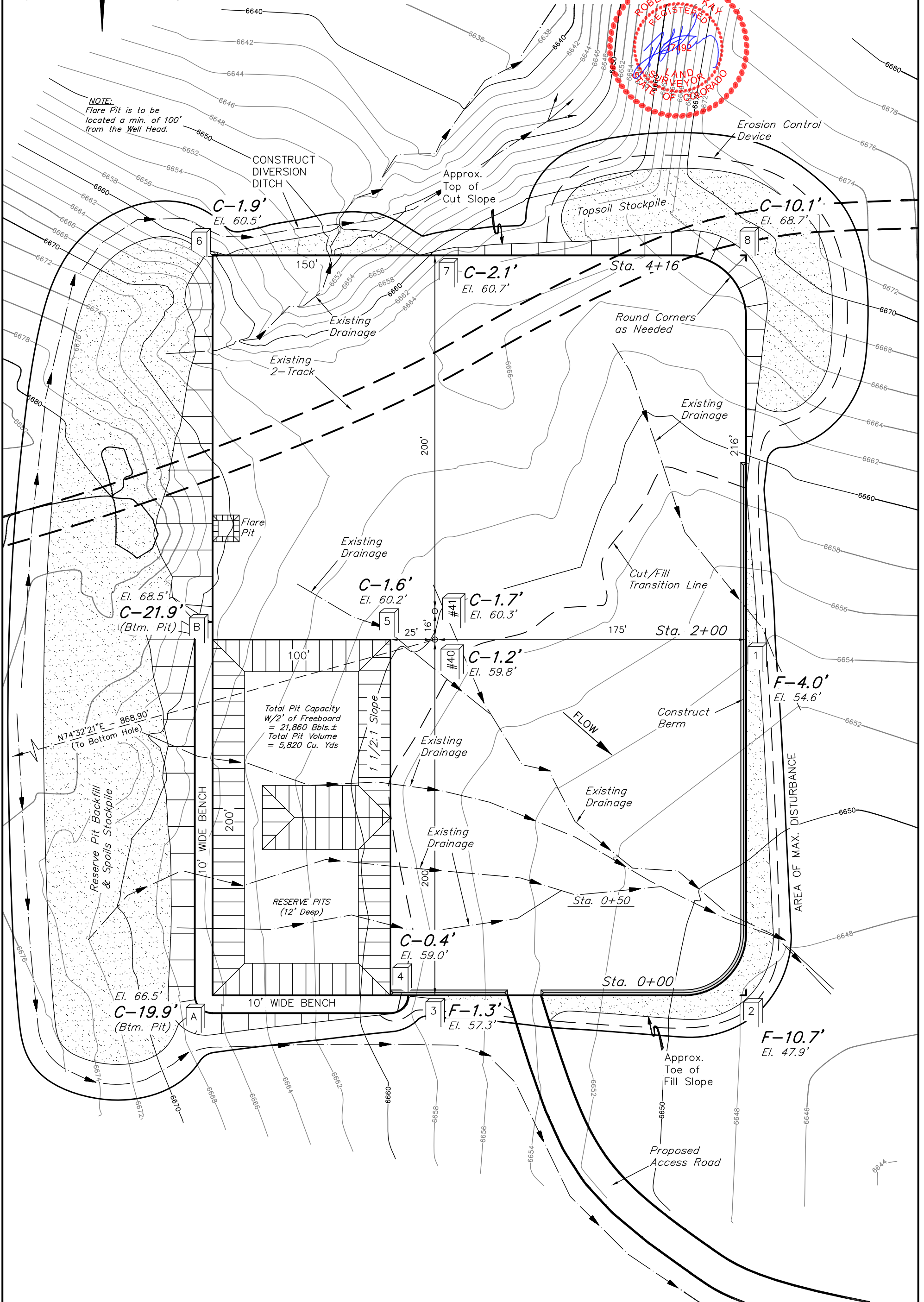
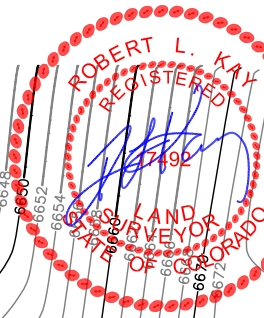
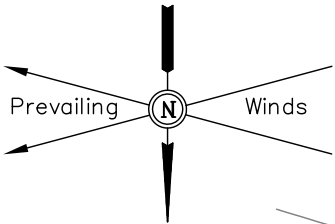

Elev. Ungraded Ground At #40 Loc. Stake = 6659.8'  
FINISHED GRADE ELEV. AT #40 LOC. STAKE = 6658.6'

UINTAH ENGINEERING & LAND SURVEYING  
85 So. 200 East \* Vernal, Utah 84078 \* (435) 789-1017

1" = 20'  
X-Section  
Scale  
1" = 50'  
DATE: 09-02-10  
DRAWN BY: C.H.  
REVISED: 01-14-11 S.L.

WEXPRO COMPANY  
CONSTRUCTION LAYOUT CROSS SECTION FOR  
CARL ALLEN #40 & #41  
SECTION 28, T12N, R97W, 6th P.M.  
SW 1/4 SW 1/4

FIGURE #2

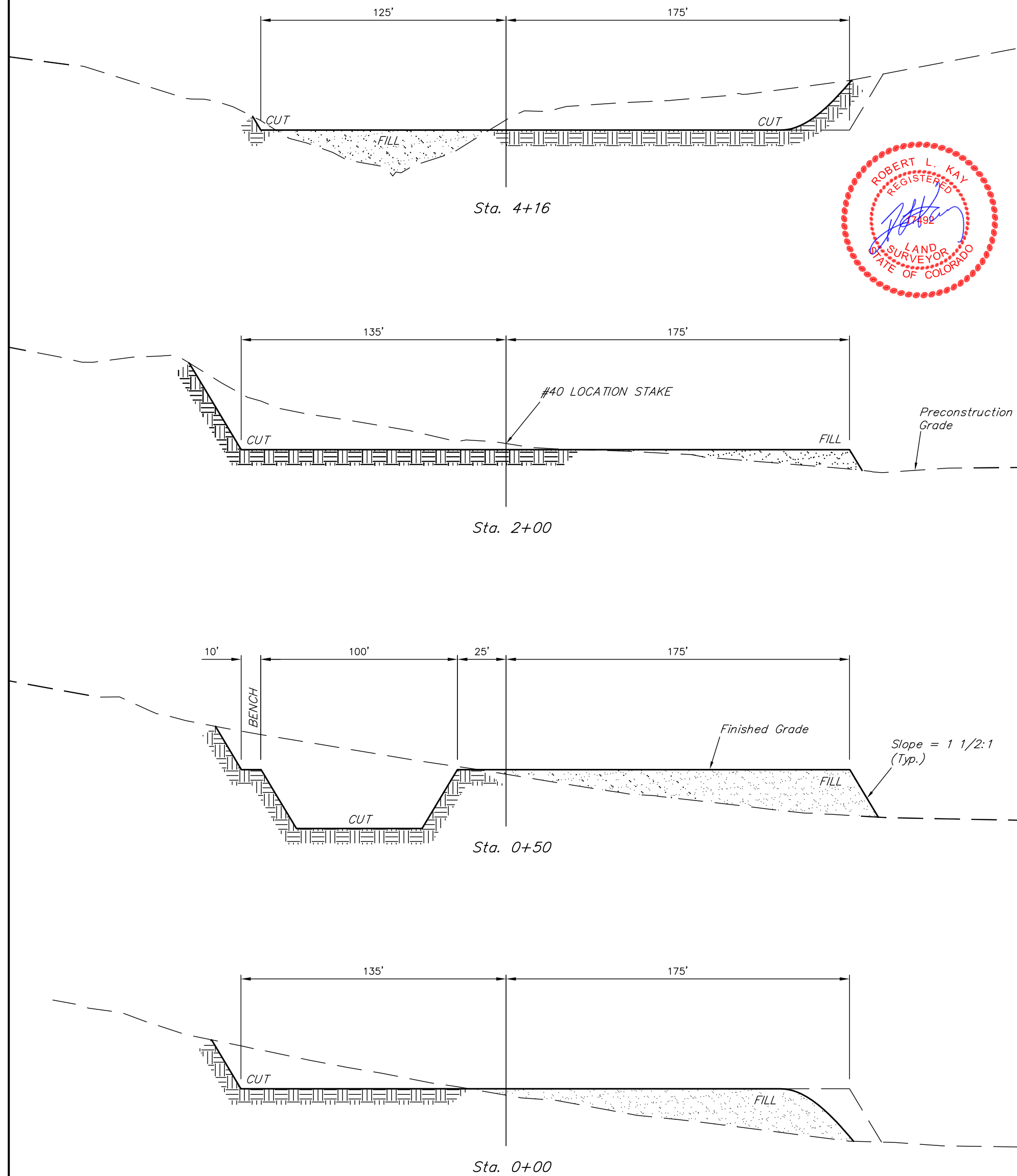

NOTE:  
Topsoil should not be  
Stripped Below Finished  
Grade on Substructure Area.

\* NOTE:  
FILL QUANTITY INCLUDES  
5% FOR COMPACTION

APPROXIMATE YARDAGES

(6") Topsoil Stripping = 2,770 Cu. Yds.  
Remaining Location = 20,530 Cu. Yds.  
TOTAL CUT = 23,300 CU.YDS.  
FILL = 8,880 CU.YDS.

EXCESS MATERIAL = 14,420 Cu. Yds.  
Topsoil & Pit Backfill = 5,680 Cu. Yds.  
(1/2 Pit Vol.)  
EXCESS UNBALANCE = 8,740 Cu. Yds.  
(After Interim Rehabilitation)

APPROXIMATE ACREAGES  
WELL SITE DISTURBANCE = ± 4.828 ACRES  
ACCESS ROAD DISTURBANCE = ± 0.247 ACRES  
TOTAL = ± 5.075 ACRES

UINTAH ENGINEERING & LAND SURVEYING  
85 So. 200 East \* Vernal, Utah 84078 \* (435) 789-1017