

**WEXPRO COMPANY**  
**CARL ALLEN #40 & #41**  
LOCATED IN MOFFAT COUNTY, COLORADO  
SECTION 28, T12N, R97W, 6th P.M.

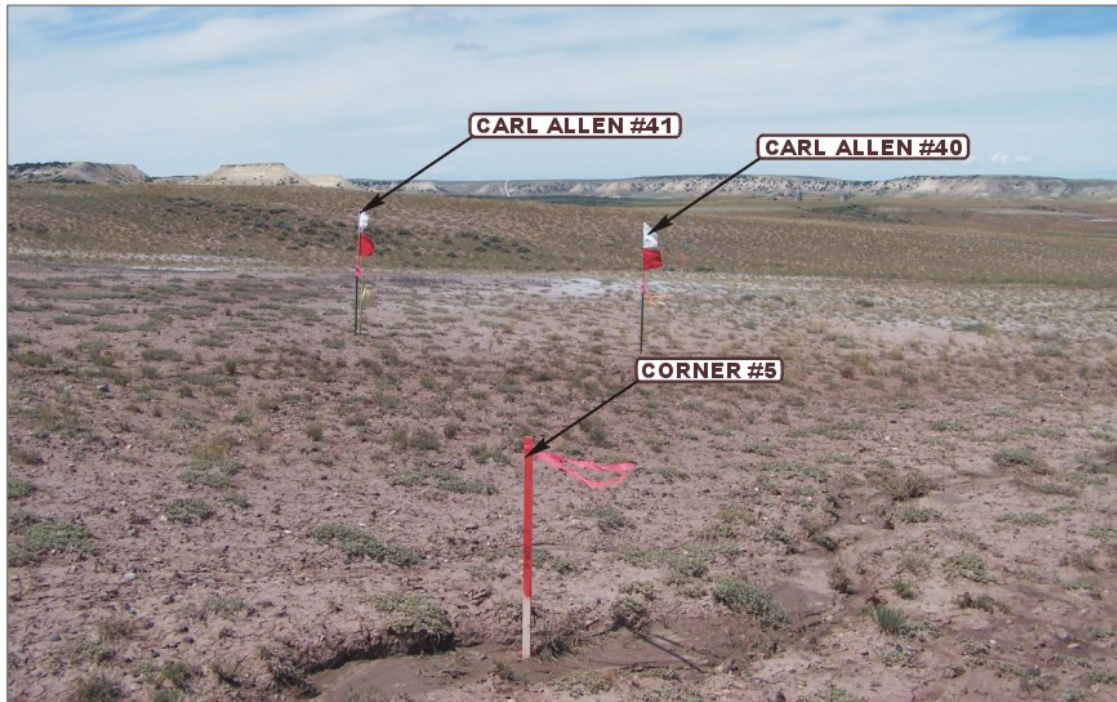

PHOTO: VIEW FROM CORNER #5 TO LOCATION STAKE

CAMERA ANGLE: WESTERLY



PHOTO: VIEW FROM BEGINNING OF PROPOSED ACCESS

CAMERA ANGLE: EASTERLY



**UELS** Uintah Engineering & Land Surveying  
85 South 200 East Vernal, Utah 84078  
(435) 789-1017 \* FAX (435) 789-1813

**LOCATION PHOTOS**

**08** **23** **10**  
MONTH DAY YEAR

TAKEN BY: D.K.

DRAWN BY: J.J.

REVISED: 00-00-00

PHOTO  
**P1**



**WEXPRO COMPANY**  
**CARL ALLEN #40 & #41**  
LOCATED IN MOFFAT COUNTY, COLORADO  
SECTION 28, T12N, R97W, 6th P.M.



PHOTO: VIEW FROM LOCATION STAKE

CAMERA ANGLE: NORTHERLY

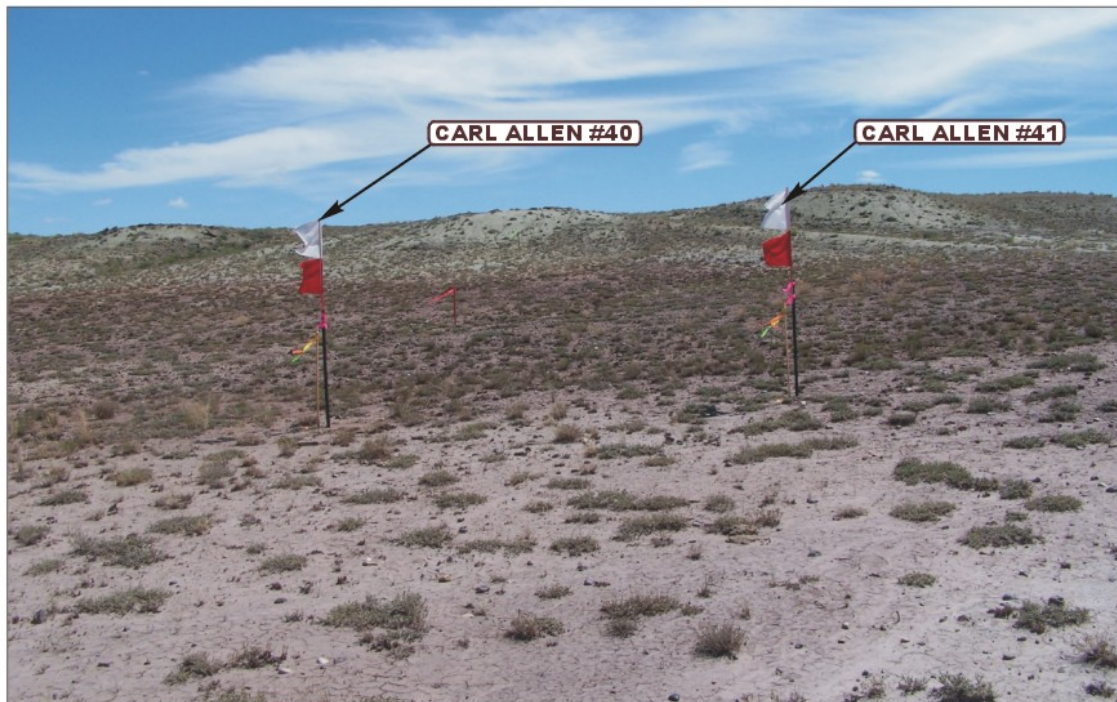

PHOTO: VIEW FROM LOCATION STAKE

CAMERA ANGLE: EASTERLY



**UELS** Uintah Engineering & Land Surveying  
85 South 200 East Vernal, Utah 84078  
(435) 789-1017 \* FAX (435) 789-1813

**LOCATION PHOTOS**

**08** **23** **10**  
MONTH DAY YEAR

TAKEN BY: D.K.

DRAWN BY: J.J.

REVISED: 00-00-00

PHOTO  
**P2**



**WEXPRO COMPANY**  
**CARL ALLEN #40 & #41**  
LOCATED IN MOFFAT COUNTY, COLORADO  
SECTION 28, T12N, R97W, 6th P.M.



PHOTO: VIEW FROM LOCATION STAKE

CAMERA ANGLE: SOUTHERLY

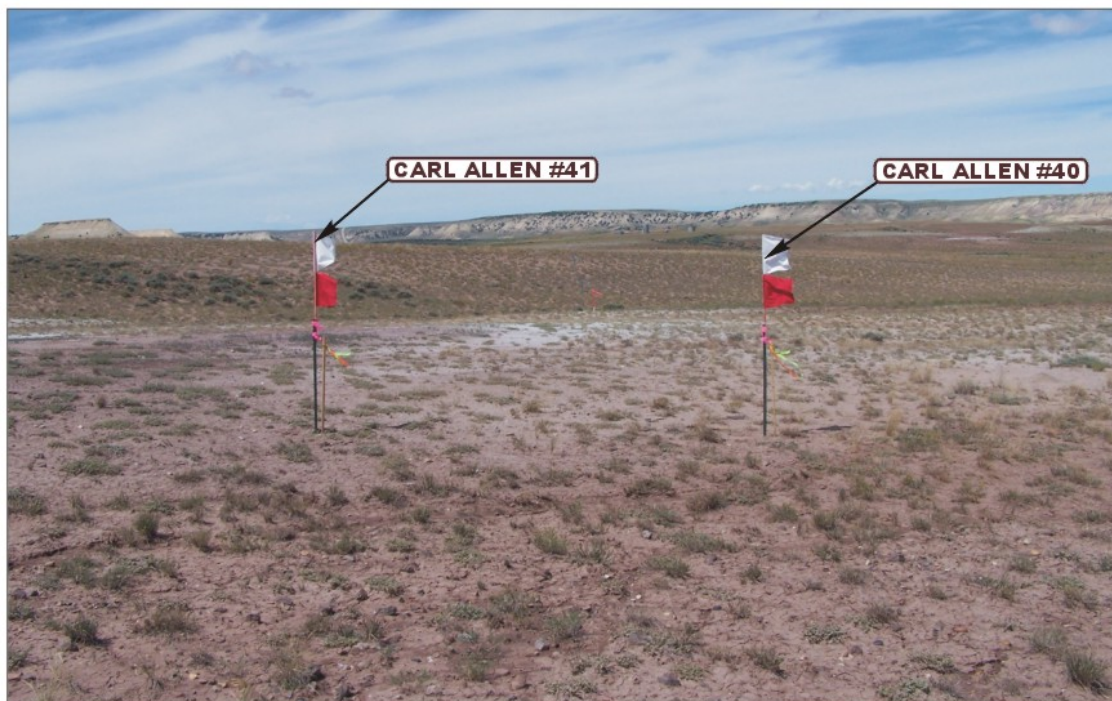

PHOTO: VIEW FROM LOCATION STAKE

CAMERA ANGLE: WESTERLY



**UELS** Uintah Engineering & Land Surveying  
85 South 200 East Vernal, Utah 84078  
(435) 789-1017 \* FAX (435) 789-1813

**LOCATION PHOTOS**

**08** **23** **10**  
MONTH DAY YEAR

PHOTO  
**P3**

TAKEN BY: D.K.

DRAWN BY: J.J.

REVISED: 00-00-00