

EOG RESOURCES, INC.  
TREE CREEK #11-28H  
SECTION 28, T10N, R65W, 6<sup>th</sup> P.M.

PROCEED IN A SOUTHERLY DIRECTION FROM CHEYENNE, WYOMING ALONG HIGHWAY 85 APPROXIMATELY 23.5 MILES TO THE JUNCTION OF THIS ROAD AND CR 114 TO THE EAST; TURN LEFT AND PROCEED IN AN EASTERLY DIRECTION APPROXIMATELY 8.0 MILES TO THE JUNCTION OF THIS ROAD AND CR 45 TO THE SOUTH; TURN RIGHT AND PROCEED IN A SOUTHERLY DIRECTION APPROXIMATELY 2.0 MILES TO THE JUNCTION OF THIS ROAD AND CR 110 TO THE WEST; TURN RIGHT AND PROCEED IN A WESTERLY DIRECTION APPROXIMATELY 1.0 MILES TO THE JUNCTION OF THIS ROAD AND CR 43 TO NORTH; TURN RIGHT AND PROCEED IN A NORTHERLY DIRECTION APPROXIMATELY 1.0 MILES TO THE BEGINNING OF THE PROPOSED ACCESS ROAD TO THE NORTHWEST; FOLLOW ROAD FLAGS IN A NORTHWESTERLY DIRECTION APPROXIMATELY 720' TO THE PROPOSED LOCATION.

TOTAL DISTANCE FROM CHEYENNE, WYOMING TO THE PROPOSED LOCATION IS APPROXIMATELY 35.6 MILES.

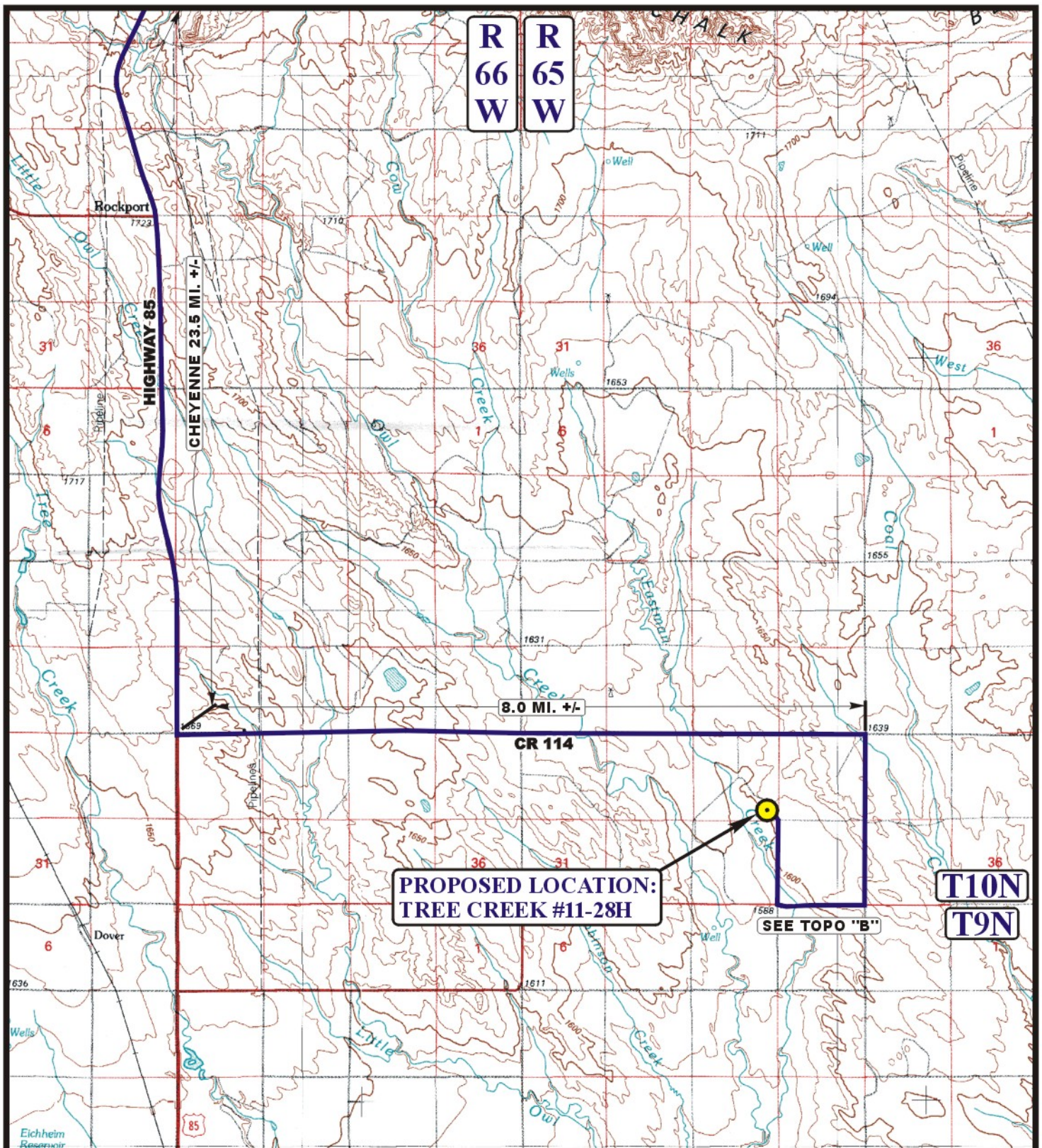

# LEGEND:

PROPOSED LOCATION



Uintah Engineering & Land Surveying  
 85 South 200 East Vernal, Utah 84078  
 (435) 789-1017 \* FAX (435) 789-1813



EOG RESOURCES, INC.

TREE CREEK #11-28H  
 SECTION 28, T10N, R65W, 6th P.M.  
 600' FSL 700' FEL

ACCESS ROAD  
 MAP

11 10 10  
 MONTH DAY YEAR

SCALE: 1:100,000

DRAWN BY: J.J.

REVISED: 00-00-00





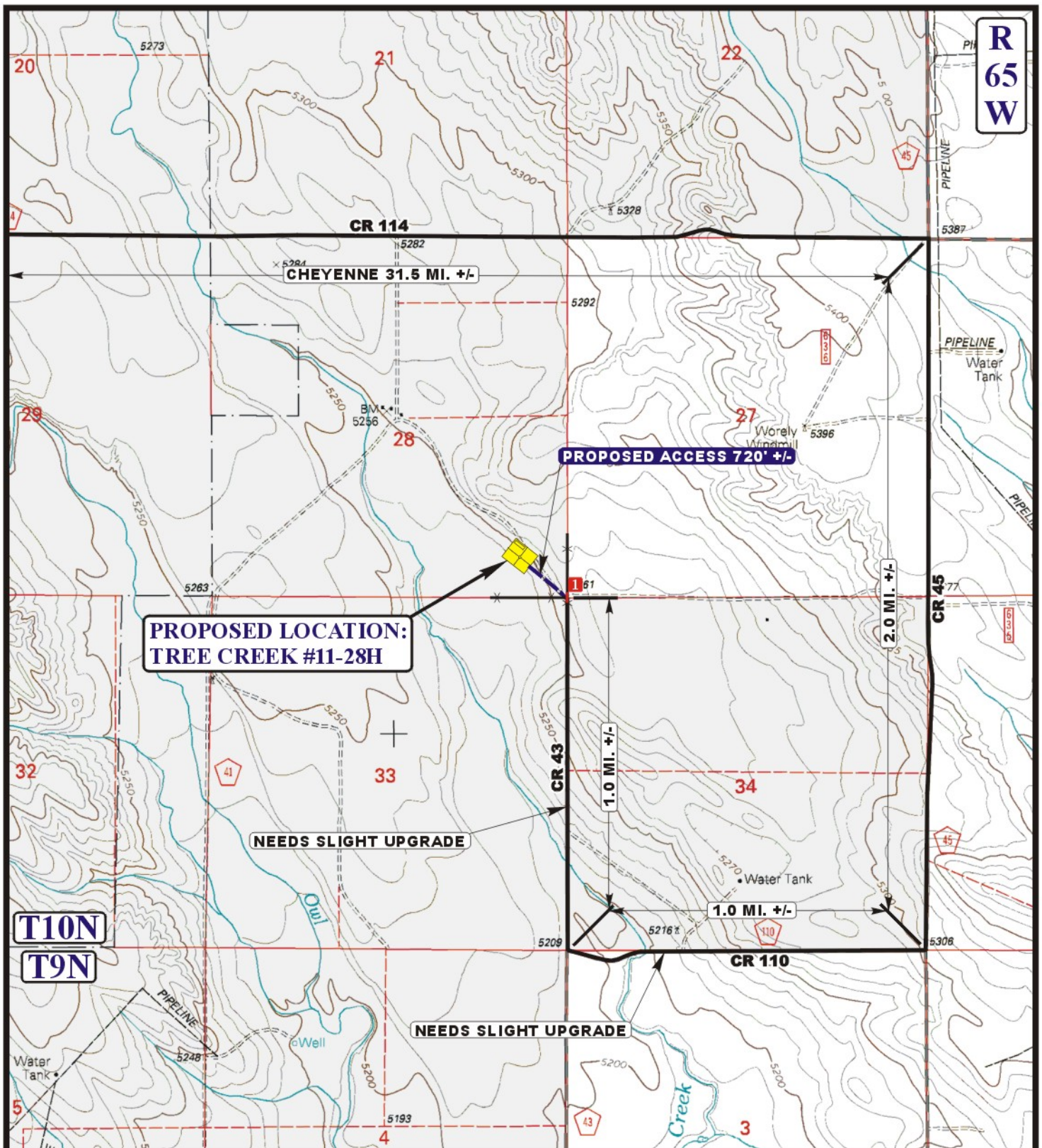

# **LEGEND:**

- EXISTING ROAD
- PROPOSED ACCESS ROAD
- EXISTING FENCE
- INSTALL CATTLEGUARD



**Utah Engineering & Land Surveying**  
 85 South 200 East Vernal, Utah 84078  
 (435) 789-1017 \* FAX (435) 789-1813



**EOG RESOURCES, INC.**

**TREE CREEK #11-28H**  
**SECTION 28, T10N, R65W, 6th P.M.**  
**600' FSL 700' FEL**

**ACCESS ROAD**  
**MAP**

**11** **10** **10**  
 MONTH DAY YEAR

SCALE: 1" = 2000' DRAWN BY: J.J. REVISED: 00-00-00

**B**  
**TOPO**