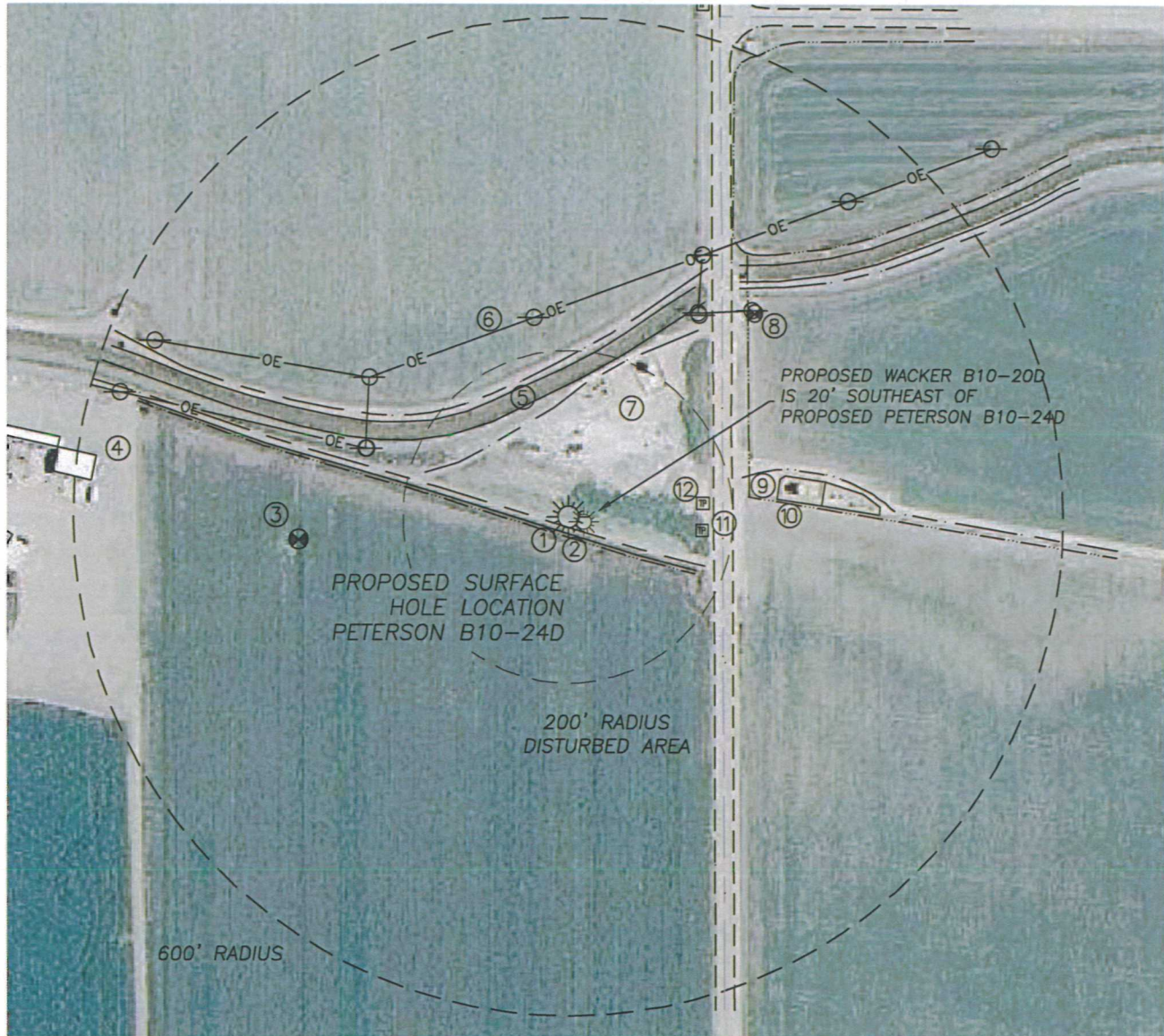

LOCATION DRAWING

WACKER B10-20D & PETERSON B10-24D

SECTION 10, TOWNSHIP 5 NORTH, RANGE 64 WEST OF THE 6TH PRINCIPAL MERIDIAN

IMPROVEMENTS

1. FIELD ROAD:	12'± SW
2. IRRIG. DITCH:	23'± SW
3. WELL-TREBOR B10-11:	342'± W
4. BUILDING:	575'± W
5. TOP CANAL:	145'± NW
	165'± NW
6. O.H. UTILITY:	240'± NW
7. PROD. FACILITY:	165'± NE
8. IRRIG. WELL & PUMP:	333'± NE
9. CONC. DITCH:	220'± NE
10. PROD. FACILITY:	255'± NE
11. EDGE WCR 55½:	176'± E
12. TELE. PED.:	156'± E

DISTANCE TO NEAREST:

BUILDING:	575'± W
PUBLIC ROAD:	176'± E
ABOVE GRND UTILITY:	240'± NW
RAILROAD:	5280'±
PROP. LINE:	155'± NW

