



Physical Address: 401 Arapahoe St.
Mail to: Box 384 Kiowa, CO 80117
Ph. 303-621-8672 - Fax 303-621-2717
www.highprairiesurvey.com

Job # 10218-EHT 1-34

Inv # 1390

High Prairie Surveying of Kiowa, Colorado has in accordance with a request from **Mull Drilling Co.** has determined the location of **EHT 1-34** to be 605 feet FSL, and 1200 feet FEL, (90° off Section lines) of SECTION 34, Township 17s, Range 45w of the 6th Principal Meridian, Kiowa County, Colorado.

Date: Staked on January 5, 2011 drawn on January 7, 2011.

Re: Staked by Keith Westfall
Drawn: Drawn by Elijah Frane

Access Road Map

34

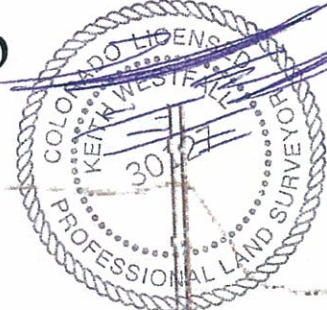

MULL DRILLING CO.
SE 1/4 SEC. 34-17S-45W
EHT 1-34
KIOWA, Co., COLORADO



C.R. 59

4006

Proposed Route

