

Map Unit Description

Weld County, Colorado, Southern Part

47 Olney fine sandy loam, 1 to 3 percent slopes

Setting

Elevation: 4600 to 5200 feet
Mean annual precipitation: 11 to 15 inches
Mean annual air temperature: 46 to 54 degrees F
Frost-free period: 125 to 175 days

Composition

Olney and similar soils: 85 percent
Minor components: 1 percent

Description of Olney

Setting

Landform: Plains
Down-slope shape: Linear
Across-slope shape: Linear
Parent material: Mixed deposit outwash

Properties and Qualities

Slope: 1 to 3 percent
Drainage class: Well drained
Capacity of the most limiting layer to transmit water (Ksat): Moderately high or high (0.57 to 2.00 in/hr)
Frequency of flooding: None
Frequency of ponding: None
Calcium carbonate maximum: 15 percent
Gypsum maximum: 0 percent
Available water capacity: Moderate (about 7.0 inches)

Interpretive Groups

Land capability classification (irrigated): 3e
Land capability (non irrigated): 4c
Ecological site: Sandy Plains (R067BY024CO)

Typical Profile

0 to 10 inches: fine sandy loam
10 to 20 inches: sandy clay loam
20 to 25 inches: sandy clay loam
25 to 60 inches: fine sandy loam

Minor Components

Aquic haplustolls

Percent of map unit: 1 percent
Landform: Swales

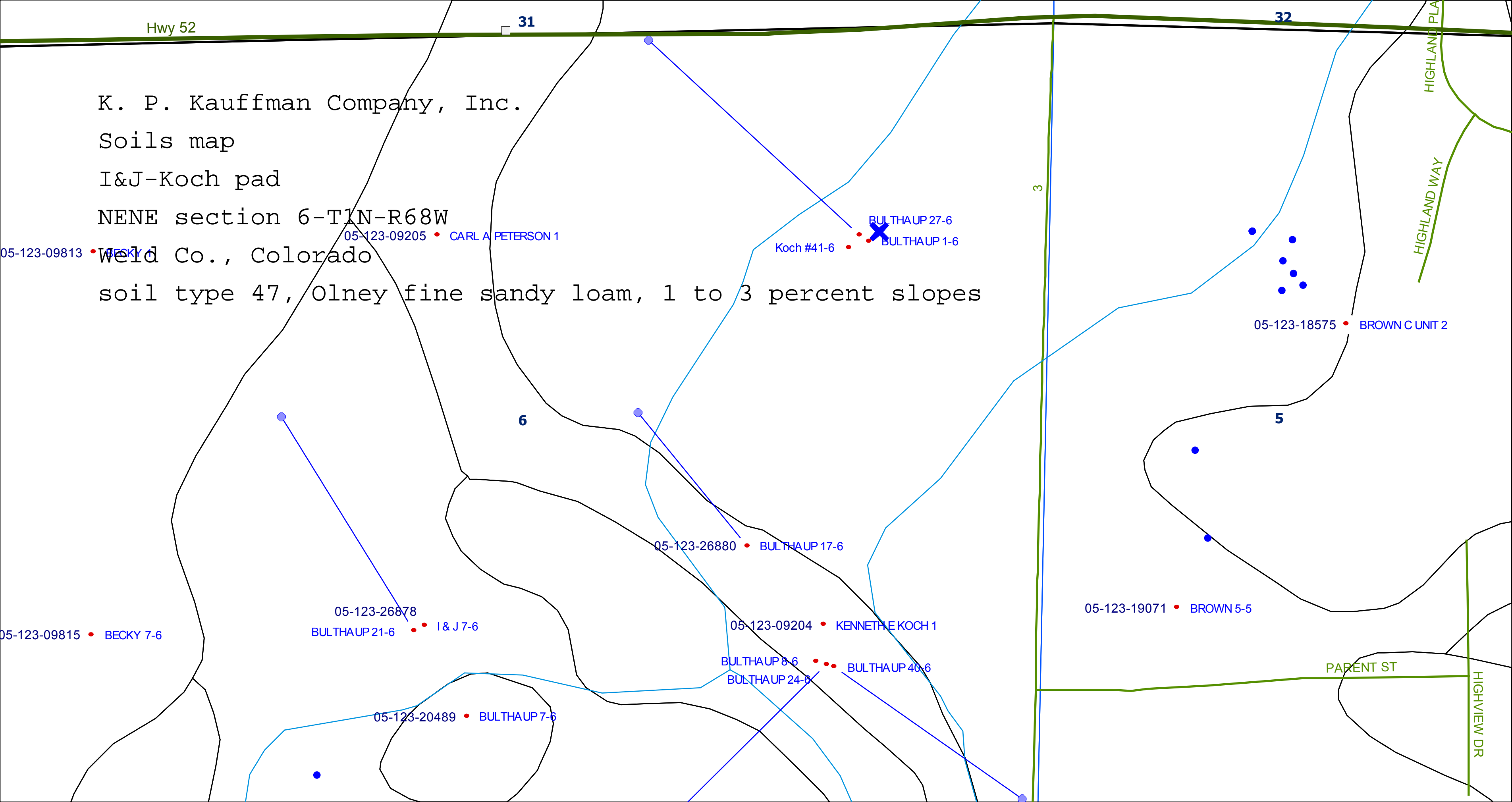

Hwy 52

31

32

HIGHLAND PL

HIGHLAND WAY

K. P. Kauffman Company, Inc.

Soils map

I&J-Koch pad

NENE section 6-T1N-R68W

Weld Co., Colorado

soil type 47, Olney fine sandy loam, 1 to 3 percent slopes

05-123-09813

BECKY 1

05-123-09205

CARL A PETERSON 1

Koch #41-6

BULHAUP 27-6

BULHAUP 1-6

05-123-18575

BROWN C UNIT 2

6

5

05-123-26880

BULHAUP 17-6

05-123-26878

BULHAUP 21-6

I & J 7-6

05-123-09815

BECKY 7-6

05-123-09204

KENNETH E KOCH 1

05-123-19071

BROWN 5-5

BULHAUP 8-6

BULHAUP 24-6

BULHAUP 40-6

05-123-20489

BULHAUP 7-6

PARENT ST

HIGHVIEW DR