

APPROXIMATE DISTURBANCE AREA: 4.7 ACRES±
 1.2% GRADE ON A SOUTHEASTERLY SLOPE
 UNGRADED ELEVATION: 4738.4'
 FINISHED ELEVATION: 4737.4'

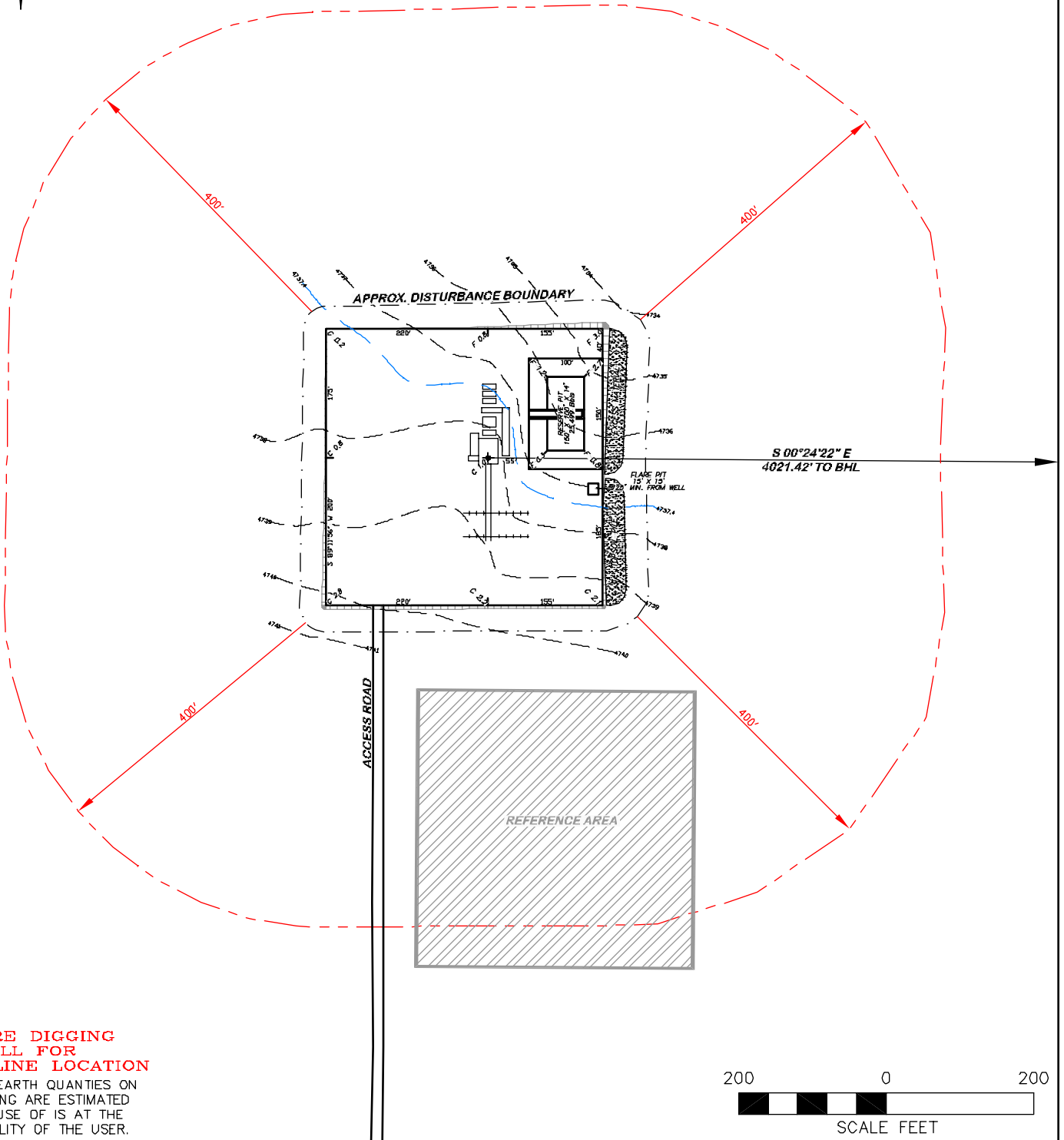

**BEFORE DIGGING
 CALL FOR
 UTILITY LINE LOCATION**

NOTE: THE EARTH QUANTITIES ON
 THIS DRAWING ARE ESTIMATED
 AND THE USE OF IS AT THE
 RESPONSIBILITY OF THE USER.



RIFFIN & ASSOCIATES, INC.
 1414 ELK ST., ROCK SPRINGS, WY 82901

(307) 362-5028

DRAWN: 12/28/10 - JMB

SCALE: 1" = 200'

REVISED: NA

DRG JOB No. 18251

EXHIBIT 2D

LOCATION DRAWING

CHESAPEAKE ENERGY, LLC.
HOFF 6-62 15-1H
SECTION 15, T6N, R62W

UNGRADED ELEVATION: 4738.4'
FINISHED ELEVATION: 4737.4'