

ORIGIN OF CONTROL:
COLORADO STATE PLAN CENTRAL ZONE NAD83,
U.S. SURVEY FEET
CONTOUR INTERVAL: 5'

Proposed Pad Area: 2.51 Acres
Proposed Pad Elevation: 8240.0
(Cut & Fill Slopes: 2:1)

Well Pad Disturbance: 3.42 Acres
Access Road Disturbance: 4.52 Acres
Stockpiles & Buffer Area: 2.69 Acres
Total Disturbed Area: 10.63 Acres

CUTTINGS TRENCH:
13' TOTAL DEPTH
1.5:1 SIDE SLOPES
(INCLUDES 2' FREEBOARD)

WELL PAD CC 697-17B ESTIMATED EARTHWORK QUANTITIES

ITEM	CUT	FILL	TOPSOIL	EXCESS
PAD	62,124	6,880	2,757	55,244
ROAD	3,014	18,335	3,642	-15,321
PIT	6,294			6,294
TOTALS	71,432	25,215	6,399	46,217

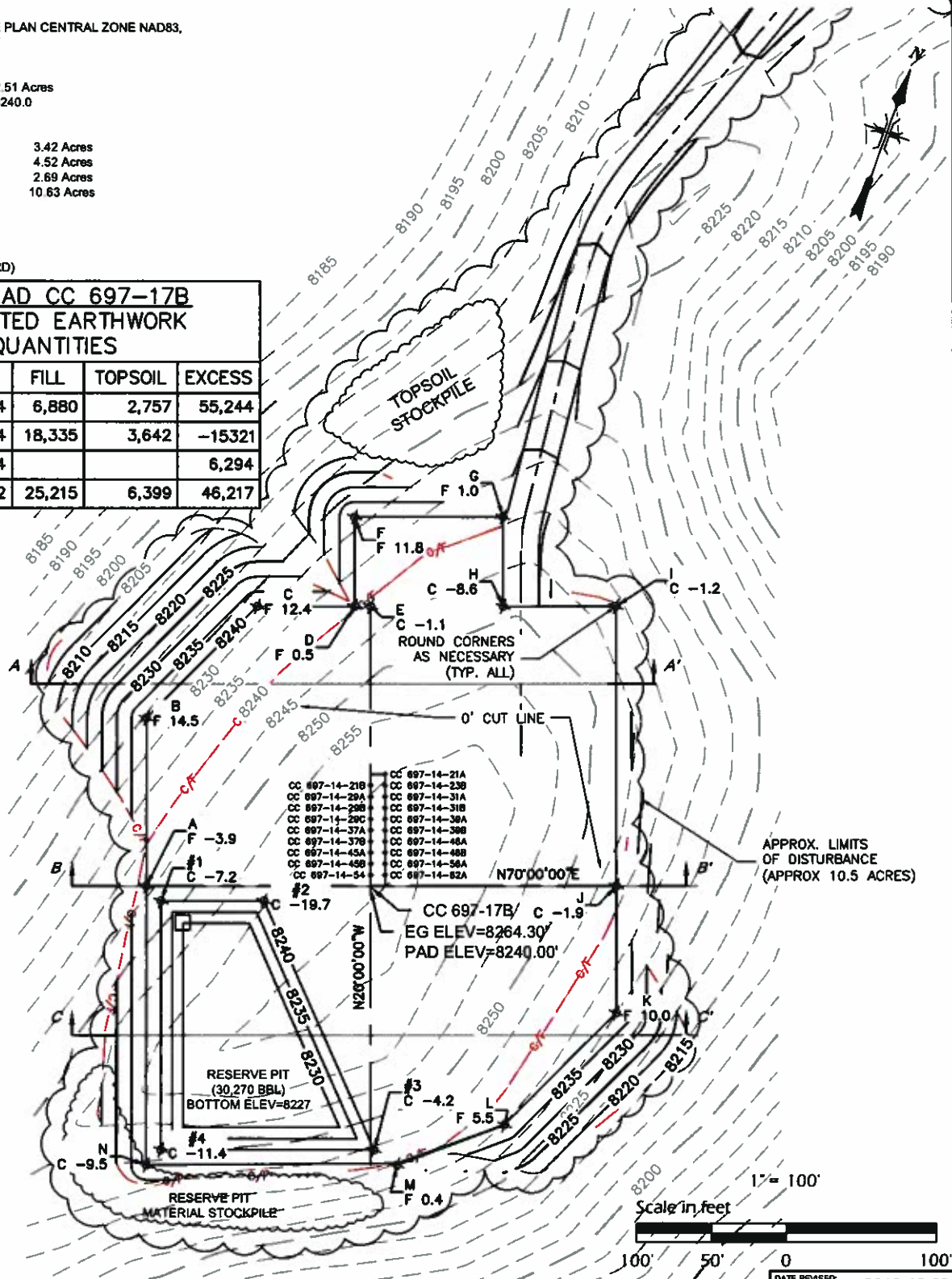

DEL-MONT CONSULTANTS IS PROVIDING GRADING DESIGN FOR THIS PROJECT THAT PROVIDES DIMENSIONS AND VOLUME INFORMATION FOR CONSTRUCTION.



DEL-MONT CONSULTANTS, INC.
ENGINEERING • SURVEYING • PLANNING
10000 Delmont Ave., Suite 100, Denver, CO 80231 • (303) 555-1000 • www.delmont.com



SECTION 17, T6S, R97W, 6TH PM
CONSTRUCTION LAYOUT
PAD GRADING PLAN
WELL PAD 697-17B
GARFIELD COUNTY
OXY USA WTP LP

DMC JOB NO: 10080
DATE ISSUED: 2010-11-23
DATE SURVEYED: 2008-11-06
PLAT: 2 of 9

DESIGNED BY: MGW
SCALE: AS NOTED
CHECKED BY: K. SHEPHERD
FILE NAME: 10080C_001-17B

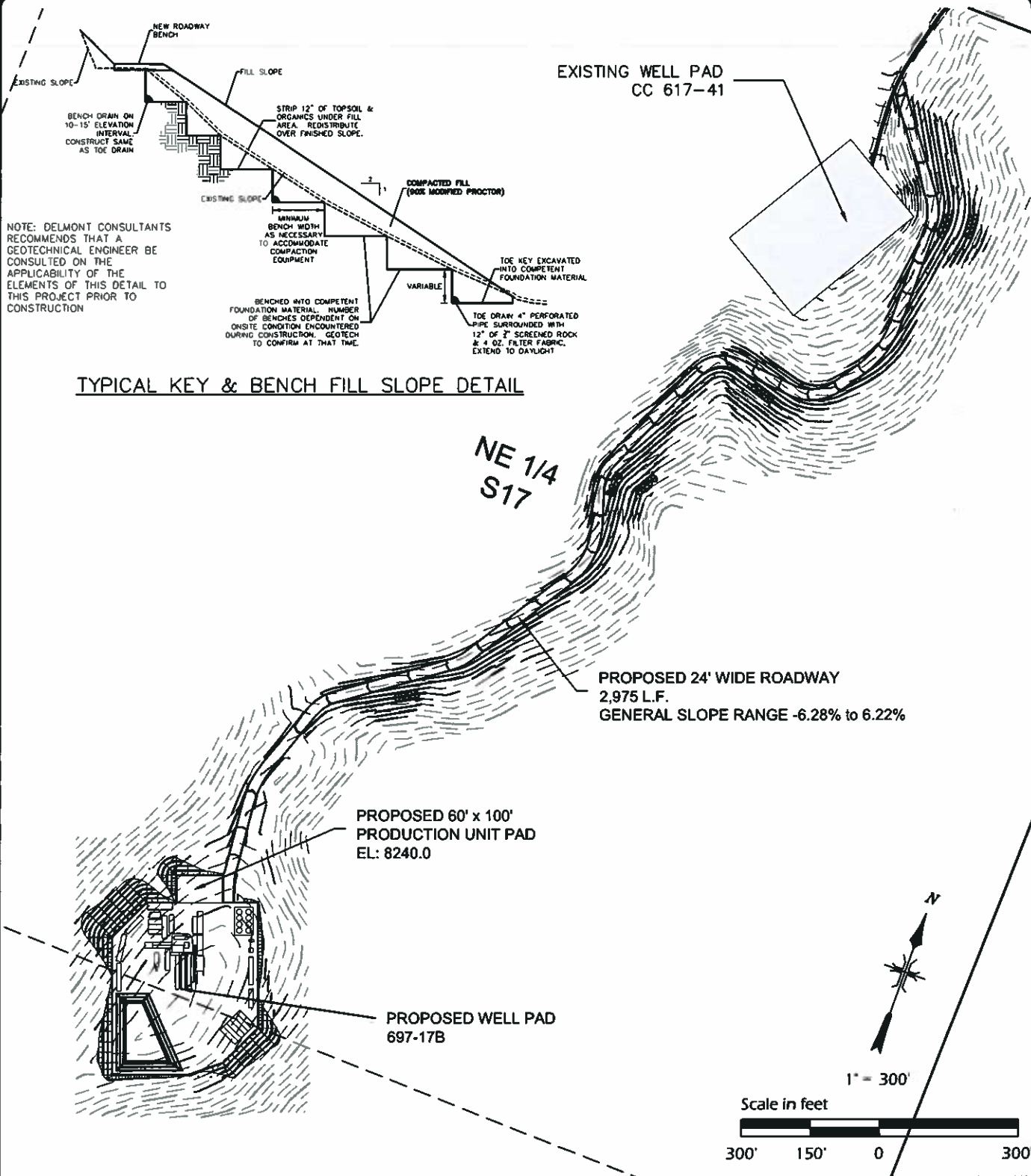

TYPICAL KEY & BENCH FILL SLOPE DETAIL

DEL-MONT CONSULTANTS IS PROVIDING GRADING DESIGN FOR THIS PROJECT THAT PROVIDES DIMENSIONS AND VOLUME INFORMATION FOR CONSTRUCTION.			
DEL-MONT CONSULTANTS, INC. <small>ENGINEERING • SURVEYING • PLANNING</small> <small>10000 C. 697-17B</small>			
DESIGNED BY:	MGW	SCALE:	AS NOTED
CHECKED BY:	K. SHEPHERD	FILE NAME:	10080C_697-17B
SECTION 17, T6S, R97W. 6TH PM CONSTRUCTION LAYOUT ROAD PLAN & DETAILS WELL PAD 697-17B GARFIELD COUNTY OXY USA WTP LP			
DMC JOB NO:		10080	
DATE ISSUED:		2010-11-23	
DATE SURVEYED:		2008-11-06	
PLAT:		2A of 9	