

KINDER MORGAN CO2 COMPANY, LP
YD-2
949.6' FSL & 289.3' FWL record
Section 15, T.37 N., R.18 W., NMPM
Montezuma County, CO
6525.5' grd. el. record

Notes:

Distances/dimensions are perpendicular
to section/aliquot lines.

GPS was corrected with Aztec, NM CORS,
operator was R.J. Caffey CO LS 36562



KNOW ALL MEN BY THESE PRESENTS that I, GERALD G. HUDDLESTON,
do hereby certify that this plat was prepared from the record
well location plat, GLO survey plat and down hole information
and does not represent an actual survey by me.

date of plat : 12/16/' 10

S 90°00' 00" W 5298.70' **

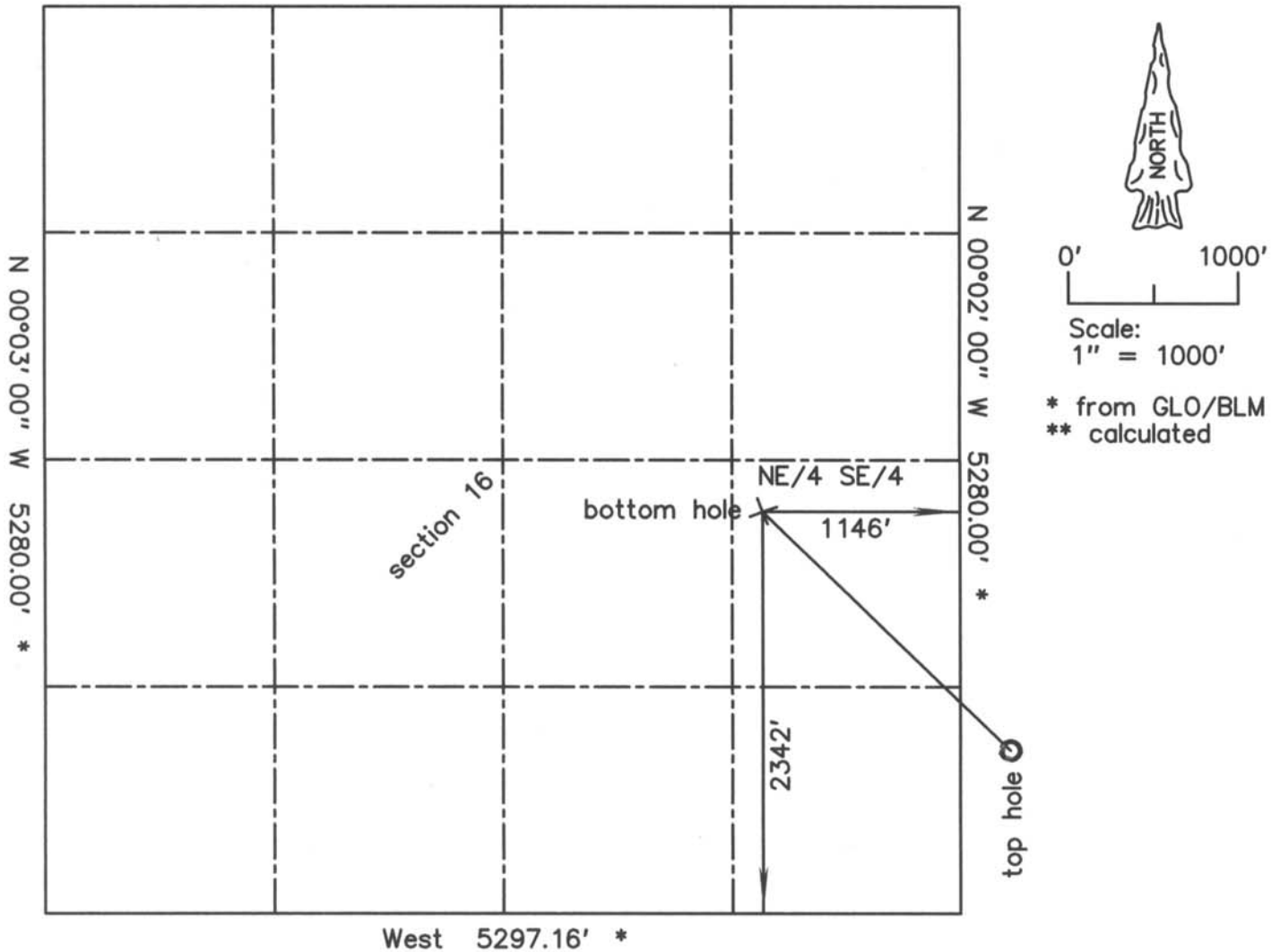

KINDER MORGAN CO2 COMPANY, LP
YD-2 bottom hole
2342' FSL & 1146' FEL
Section 16, T.37 N., R.18 W., NMPM
Montezuma County, CO

Notes:

Distances/dimensions are perpendicular to section/aliquot lines.



date of plat : 12/16/' 10

KNOW ALL MEN BY THESE PRESENTS that I, GERALD G. HUDDLESTON, do hereby certify that this plat was prepared from the record well location plat, GLO survey plat and down hole information and does not represent an actual survey by me.