

PLOTTED: THU 12/09/10 12:24PM  
 DRAWN BY: COODER MCCARY  
 DRAWING: E-597-7\_1\_LDD-597-7-DWG-597-7-WELL-PADS-REV-4.DWG

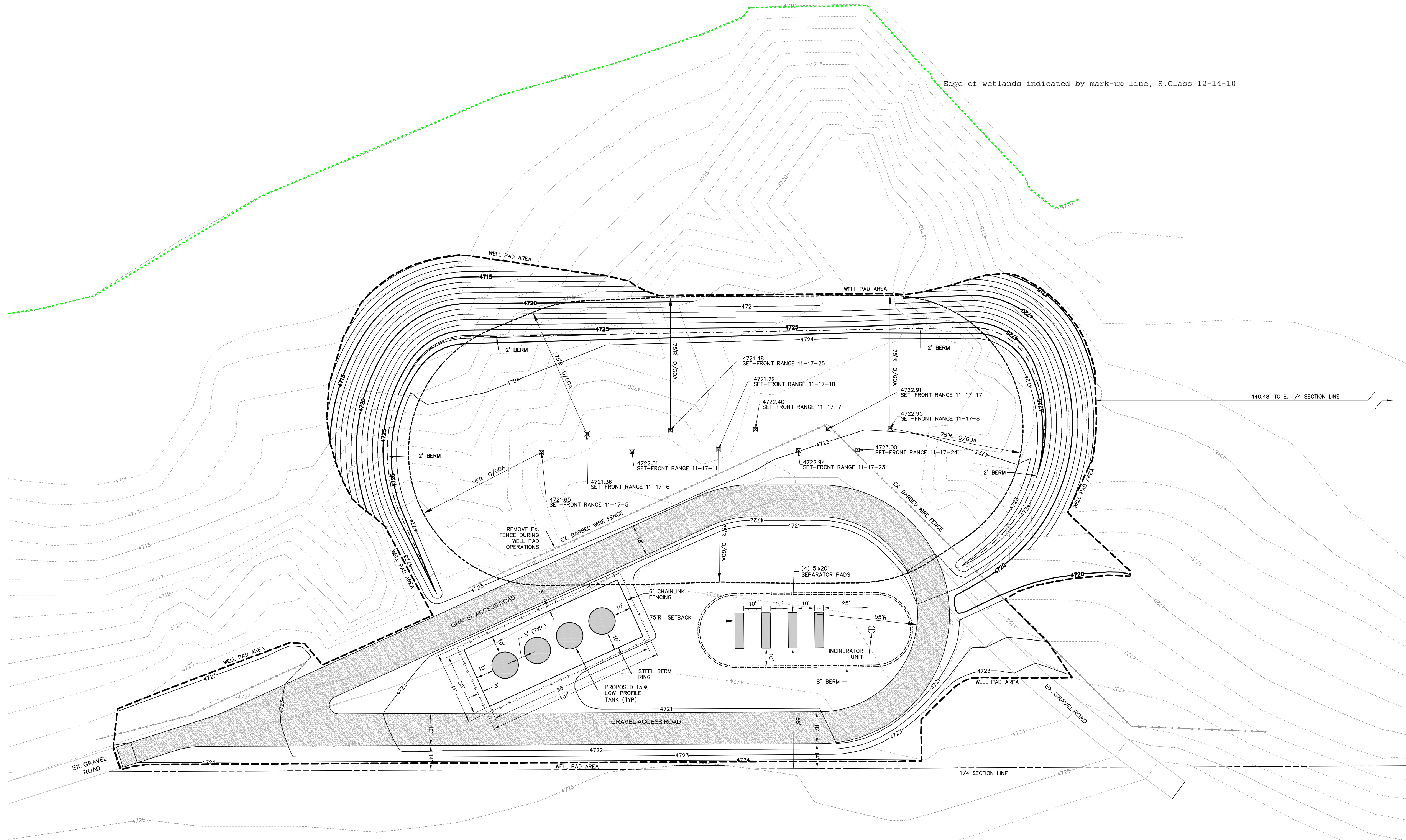

WELL PAD LOCATION

IN THE NE1/4 OF THE SW1/4  
OF SECTION 17, T4N, R66W  
OF THE 6TH P.M., COUNTY  
OF WELD, STATE OF COLORADO.

WELL PAD AREA

2.579 ACRES (112,351.193 SQ. FEET)

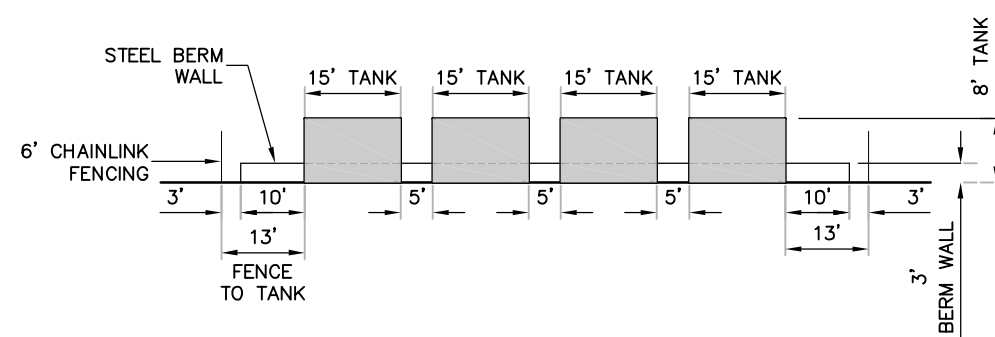

TANK AREA CROSS-SECTION

SCALE: 1"=30'

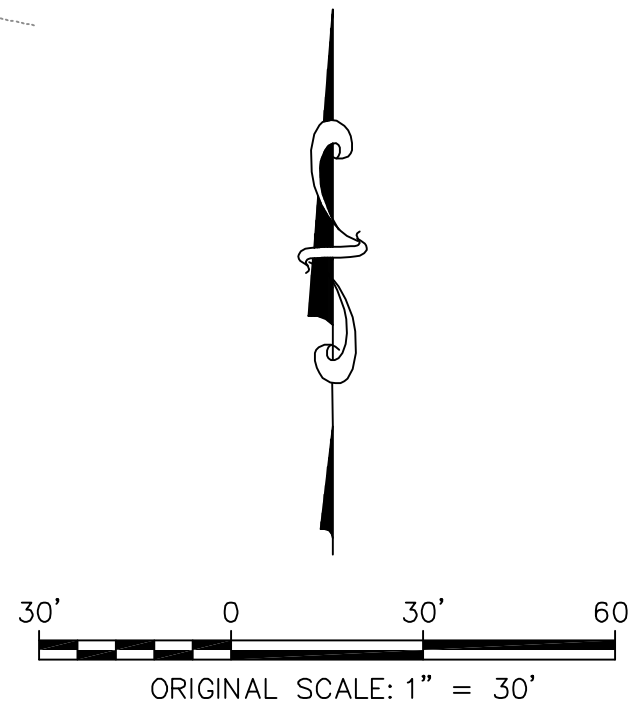

REVISIONS		NO.	DESCRIPTION	DATE	BY
		1.	REVISED LOCATION OF INCINERATOR & SEPARATORS	10/07/10	CM
		2.	REVISED GRADING, ADDED BERMS	10/14/10	CM
		3.	ADDED GRADING PLAN & CROSS-SECTIONS	11/09/10	CM
		4.	REVISED PAD LAYOUT, ACCESS ROAD, GRADING & SECTIONS	12/09/10	CM

ENGINEERING

PLANNING

SURVEYING

1880 Leffland Circle, Suite A

Longmont, CO 80501

P 303.682.1131

F 303.682.1149

CIVILARTS

K. P. KAUFMANN COMPANY, INC.

FRONT RANGE

11-17-SERIES

CONCEPTUAL WELL PAD LAYOUT

DATE: 12.09.2010

DRAWN BY: CM

CHECKED BY: PB

JOB NO: 597-7

EX-A

1 OF 2



