

KERR MCGEE OIL & GAS ONSHORE LP

Location: COLORADO Slot: SLOT#12 KERR-MCGEE 14-3 (1666'FSL & 1149'FWL)
 Field: WELD COUNTY (KERR MCGEE) Well: KERR-MCGEE 14-3
 Facility: SEC.03-T1N-R68W Wellbore: KERR-MCGEE 14-3 PWB

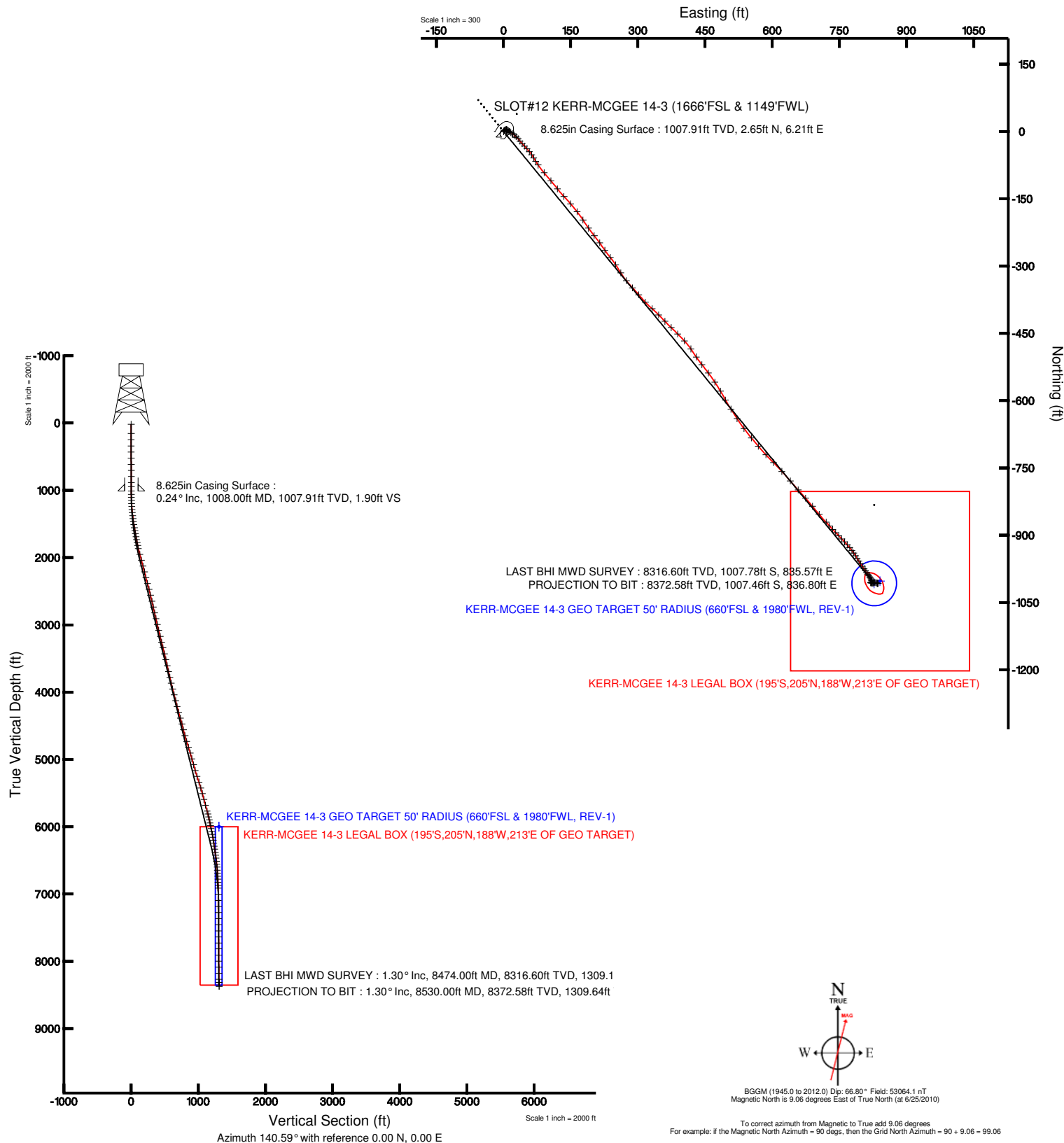

Plot reference wellpath is KERR-MCGEE 14-3 (REV-B.0) PWP	
True vertical depths are referenced to XTREME 8 (RT)	Grid System: NAD83 / Lambert Colorado State Planes, Northern Zone (501), US feet
Measured depths are referenced to XTREME 8 (RT)	North Reference: True north
XTREME 8 (RT) to Mean Sea Level: 5059 feet	Scale: True distance
Mean Sea Level to Mud line (Facility: SEC.03-T1N-R68W): 0 feet	Depths are in feet
Coordinates are in feet referenced to Slot	Created by: bensjacj on 8/18/2010





Actual Wellpath Report

KERR-MCGEE 14-3 AWP

Page 1 of 6



INTEQ

REFERENCE WELLPATH IDENTIFICATION

Operator	KERR MCGEE OIL & GAS ONSHORE LP	Slot	SLOT#12 KERR-MCGEE 14-3 (1666'FSL & 1149'FWL)
Area	COLORADO	Well	KERR-MCGEE 14-3
Field	WELD COUNTY (KERR MCGEE)	Wellbore	KERR-MCGEE 14-3 AWB
Facility	SEC.03-T1N-R68W		

REPORT SETUP INFORMATION

Projection System	NAD83 / Lambert Colorado State Planes, Northern Zone (501), US feet	Software System	WellArchitect® 2.0
North Reference	True	User	Bensjacj
Scale	0.999961	Report Generated	8/18/2010 at 2:07:59 PM
Convergence at slot	0.33° East	Database/Source file	WA_Denver/KERR-MCGEE_14-3_AWB.xml

WELLPATH LOCATION

	Local coordinates		Grid coordinates		Geographic coordinates	
	North[ft]	East[ft]	Easting[USft]	Northing[USft]	Latitude	Longitude
Slot Location	-39.34	-29.10	3141362.26	1271517.99	40°04'39.367"N	104°59'41.402"W
Facility Reference Pt			3141391.14	1271557.49	40°04'39.756"N	104°59'41.028"W
Field Reference Pt			3197771.84	1268891.29	40°04'09.600"N	104°47'36.000"W

WELLPATH DATUM

Calculation method	Minimum curvature	XTREME 8 (RT) to Facility Vertical Datum	5059.00ft
Horizontal Reference Pt	Slot	XTREME 8 (RT) to Mean Sea Level	5059.00ft
Vertical Reference Pt	XTREME 8 (RT)	Facility Vertical Datum to Mud Line (Facility)	0.00ft
MD Reference Pt	XTREME 8 (RT)	Section Origin	N 0.00, E 0.00 ft
Field Vertical Reference	Mean Sea Level	Section Azimuth	140.59°



Actual Wellpath Report

KERR-MCGEE 14-3 AWP

Page 2 of 6



INTEQ

REFERENCE WELLPATH IDENTIFICATION

Operator	KERR MCGEE OIL & GAS ONSHORE LP	Slot	SLOT#12 KERR-MCGEE 14-3 (1666'FSL & 1149'FWL)
Area	COLORADO	Well	KERR-MCGEE 14-3
Field	WELD COUNTY (KERR MCGEE)	Wellbore	KERR-MCGEE 14-3 AWP
Facility	SEC.03-T1N-R68W		

WELLPATH DATA (119 stations) † = interpolated/extrapolated station

MD [ft]	Inclination [°]	Azimuth [°]	TVD [ft]	Vert Sect [ft]	North [ft]	East [ft]	DLS [°/100ft]	Comments
0.00†	0.000	16.800	0.00	0.00	0.00	0.00	0.00	
17.00	0.000	16.800	17.00	0.00	0.00	0.00	0.00	
152.00	0.500	16.800	152.00	-0.33	0.56	0.17	0.37	
245.00	0.900	17.200	244.99	-0.96	1.65	0.50	0.43	
338.00	1.100	51.300	337.98	-1.35	2.91	1.42	0.66	
431.00	1.400	71.300	430.96	-0.93	3.83	3.19	0.56	
521.00	1.200	67.400	520.93	-0.27	4.54	5.10	0.24	
612.00	0.500	79.700	611.92	0.20	4.98	6.37	0.79	
702.00	0.600	154.300	701.92	0.85	4.63	6.96	0.75	
793.00	0.400	214.000	792.92	1.40	3.93	6.99	0.58	
883.00	0.500	202.100	882.91	1.68	3.31	6.67	0.15	
945.00	0.400	230.500	944.91	1.81	2.92	6.40	0.39	
1059.00	0.300	137.000	1058.91	2.10	2.45	6.29	0.45	
1104.00	1.300	99.600	1103.91	2.61	2.28	6.88	2.39	
1150.00	2.400	115.600	1149.88	3.87	1.77	8.26	2.62	
1195.00	3.300	111.400	1194.82	5.86	0.89	10.32	2.05	
1240.00	4.200	117.700	1239.73	8.51	-0.34	12.98	2.20	
1285.00	4.800	121.200	1284.59	11.80	-2.08	16.05	1.47	
1330.00	6.000	125.100	1329.39	15.85	-4.41	19.59	2.79	
1375.00	6.900	129.300	1374.10	20.76	-7.48	23.60	2.26	
1421.00	7.600	131.100	1419.74	26.47	-11.23	28.03	1.60	
1466.00	8.200	139.800	1464.31	32.62	-15.63	32.35	2.97	
1512.00	9.100	143.400	1509.79	39.53	-21.06	36.63	2.28	
1557.00	9.700	137.000	1554.18	46.87	-26.69	41.34	2.68	
1602.00	10.000	137.000	1598.52	54.55	-32.32	46.59	0.67	
1647.00	10.700	140.200	1642.79	62.63	-38.39	51.93	2.01	
1693.00	10.800	138.800	1687.98	71.21	-44.91	57.50	0.61	
1738.00	10.600	145.500	1732.20	79.54	-51.49	62.62	2.80	
1782.00	11.200	150.000	1775.41	87.79	-58.53	67.05	2.37	
1827.00	12.100	148.600	1819.48	96.77	-66.34	71.70	2.10	
1872.00	12.900	144.800	1863.41	106.45	-74.47	77.05	2.55	
1963.00	14.900	140.200	1951.75	128.29	-91.76	90.39	2.51	
2052.00	15.500	139.100	2037.63	151.62	-109.54	105.50	0.75	
2141.00	14.800	142.700	2123.54	174.87	-127.57	120.18	1.32	
2232.00	13.800	135.600	2211.73	197.30	-144.58	134.82	2.22	
2321.00	14.900	140.500	2297.95	219.31	-160.99	149.52	1.84	
2410.00	14.900	140.900	2383.96	242.20	-178.70	164.02	0.12	
2500.00	14.400	147.200	2471.04	264.89	-197.09	177.38	1.85	
2590.00	13.900	144.800	2558.31	286.79	-215.33	189.67	0.86	
2681.00	13.000	140.900	2646.81	307.92	-232.20	202.43	1.40	
2771.00	12.600	144.400	2734.58	327.84	-248.04	214.53	0.97	
2860.00	13.600	145.500	2821.26	347.95	-264.56	226.11	1.16	
2949.00	12.700	140.200	2907.93	368.16	-280.70	238.30	1.69	
3038.00	13.600	147.200	2994.60	388.34	-297.01	250.23	2.05	
3128.00	14.100	147.600	3081.98	409.73	-315.16	261.83	0.57	



Actual Wellpath Report

KERR-MCGEE 14-3 AWP

Page 3 of 6



INTEQ

REFERENCE WELLPATH IDENTIFICATION

Operator	KERR MCGEE OIL & GAS ONSHORE LP	Slot	SLOT#12 KERR-MCGEE 14-3 (1666'FSL & 1149'FWL)
Area	COLORADO	Well	KERR-MCGEE 14-3
Field	WELD COUNTY (KERR MCGEE)	Wellbore	KERR-MCGEE 14-3 AWB
Facility	SEC.03-T1N-R68W		

WELLPATH DATA (119 stations)

MD [ft]	Inclination [°]	Azimuth [°]	TVD [ft]	Vert Sect [ft]	North [ft]	East [ft]	DLS [°/100ft]	Comments
3218.00	13.500	142.000	3169.39	431.12	-332.70	274.18	1.63	
3307.00	13.600	136.000	3255.92	451.93	-348.41	287.84	1.58	
3395.00	14.100	139.500	3341.36	472.96	-364.01	301.99	1.11	
3486.00	13.800	137.400	3429.68	494.88	-380.42	316.54	0.65	
3576.00	13.200	130.400	3517.20	515.72	-394.99	331.63	1.93	
3667.00	12.700	135.600	3605.88	535.91	-408.87	346.54	1.39	
3756.00	13.200	136.000	3692.62	555.78	-423.17	360.44	0.57	
3845.00	12.500	133.900	3779.39	575.48	-437.16	374.44	0.95	
3935.00	13.400	135.300	3867.10	595.54	-451.32	388.80	1.06	
4025.00	14.700	136.300	3954.41	617.31	-466.99	404.02	1.47	
4114.00	15.000	146.000	4040.45	640.04	-484.71	418.27	2.81	
4203.00	13.200	146.000	4126.76	661.62	-502.68	430.39	2.02	
4292.00	14.300	141.300	4213.21	682.73	-519.68	442.95	1.76	
4382.00	16.400	143.400	4300.00	706.54	-538.56	457.47	2.41	
4472.00	15.700	146.200	4386.49	731.35	-558.88	471.82	1.16	
4562.00	14.700	149.700	4473.34	754.74	-578.86	484.36	1.51	
4652.00	14.900	151.100	4560.36	777.39	-598.85	495.71	0.46	
4741.00	15.900	146.900	4646.16	800.76	-619.08	507.90	1.68	
4831.00	16.800	146.900	4732.52	825.94	-640.30	521.74	1.00	
4921.00	17.600	143.000	4818.50	852.47	-662.07	537.03	1.56	
5012.00	16.400	140.900	4905.52	879.06	-683.03	553.41	1.48	
5101.00	15.800	139.100	4991.03	903.74	-701.93	569.27	0.88	
5192.00	16.300	137.700	5078.49	928.88	-720.74	585.97	0.69	
5282.00	15.300	133.900	5165.09	953.29	-738.32	603.03	1.60	
5373.00	19.400	138.400	5251.93	980.33	-757.96	621.72	4.74	
5463.00	17.400	139.100	5337.33	1008.72	-779.31	640.46	2.24	
5554.00	16.700	137.700	5424.33	1035.38	-799.26	658.17	0.89	
5643.00	15.700	139.100	5509.79	1060.19	-817.82	674.66	1.21	
5733.00	14.900	139.500	5596.60	1083.93	-835.83	690.15	0.90	
5822.00	15.300	140.500	5682.53	1107.11	-853.59	705.05	0.54	
5912.00	15.200	136.700	5769.36	1130.76	-871.34	720.69	1.12	
5957.00	14.300	138.300	5812.88	1142.20	-879.78	728.44	2.20	
6001.00	12.700	137.000	5855.66	1152.46	-887.38	735.35	3.70	
6046.00	12.300	136.300	5899.59	1162.17	-894.46	742.04	0.95	
6091.00	12.800	136.000	5943.52	1171.92	-901.51	748.81	1.12	
6135.00	13.000	137.000	5986.41	1181.72	-908.63	755.57	0.68	
6178.00	11.700	135.600	6028.41	1190.89	-915.29	761.92	3.10	
6223.00	11.200	138.100	6072.52	1199.80	-921.80	768.03	1.57	
6267.00	10.900	140.500	6115.70	1208.23	-928.19	773.53	1.25	
6310.00	10.000	144.100	6157.99	1216.02	-934.35	778.31	2.58	
6354.00	8.900	145.000	6201.39	1223.23	-940.24	782.50	2.52	
6399.00	8.900	148.000	6245.85	1230.15	-946.04	786.34	1.03	
6444.00	8.900	148.300	6290.31	1237.05	-951.95	790.01	0.10	
6489.00	9.400	147.220	6334.74	1244.15	-958.00	793.83	1.17	
6535.00	9.100	146.000	6380.14	1251.51	-964.18	797.90	0.78	



Actual Wellpath Report

KERR-MCGEE 14-3 AWP

Page 4 of 6



INTEQ

REFERENCE WELLPATH IDENTIFICATION

Operator	KERR MCGEE OIL & GAS ONSHORE LP	Slot	SLOT#12 KERR-MCGEE 14-3 (1666'FSL & 1149'FWL)
Area	COLORADO	Well	KERR-MCGEE 14-3
Field	WELD COUNTY (KERR MCGEE)	Wellbore	KERR-MCGEE 14-3 AWP
Facility	SEC.03-T1N-R68W		

WELLPATH DATA (119 stations)

MD [ft]	Inclination [°]	Azimuth [°]	TVD [ft]	Vert Sect [ft]	North [ft]	East [ft]	DLS [°/100ft]	Comments
6580.00	8.200	145.100	6424.62	1258.25	-969.76	801.73	2.02	
6625.00	7.400	145.500	6469.21	1264.33	-974.78	805.20	1.78	
6670.00	6.800	145.800	6513.86	1269.87	-979.37	808.34	1.34	
6714.00	6.000	145.100	6557.59	1274.76	-983.41	811.12	1.83	
6759.00	5.300	144.800	6602.37	1279.18	-987.04	813.67	1.56	
6804.00	4.500	144.100	6647.20	1283.01	-990.17	815.90	1.78	
6849.00	4.000	145.500	6692.08	1286.34	-992.89	817.82	1.13	
6894.00	3.700	145.800	6736.98	1289.35	-995.39	819.53	0.67	
6939.00	3.200	150.700	6781.90	1292.03	-997.68	820.96	1.29	
6984.00	2.500	155.300	6826.84	1294.22	-999.67	821.98	1.64	
7030.00	1.900	165.500	6872.81	1295.88	-1001.32	822.60	1.55	
7073.00	2.000	171.100	6915.78	1297.17	-1002.75	822.89	0.50	
7163.00	1.200	240.000	7005.75	1298.37	-1004.77	822.32	2.14	
7254.00	1.000	248.500	7096.74	1297.97	-1005.54	820.75	0.28	
7344.00	0.400	149.300	7186.73	1298.04	-1006.10	820.18	1.26	
7435.00	0.400	79.400	7277.73	1298.51	-1006.31	820.66	0.50	
7525.00	0.400	89.200	7367.73	1298.85	-1006.25	821.28	0.08	
7616.00	0.600	130.400	7458.72	1299.52	-1006.56	821.96	0.44	
7706.00	1.100	91.000	7548.72	1300.55	-1006.88	823.18	0.82	
7796.00	0.900	77.300	7638.70	1301.42	-1006.74	824.74	0.34	
7887.00	0.300	100.500	7729.70	1301.93	-1006.62	825.67	0.70	
7975.00	0.900	76.600	7817.69	1302.41	-1006.50	826.57	0.72	
8066.00	1.000	75.200	7908.68	1303.05	-1006.14	828.03	0.11	
8156.00	1.100	91.700	7998.66	1303.95	-1005.96	829.65	0.35	
8247.00	1.100	95.900	8089.65	1305.14	-1006.08	831.39	0.09	
8336.00	0.900	130.700	8178.63	1306.44	-1006.62	832.77	0.71	
8426.00	1.600	115.600	8268.61	1308.27	-1007.62	834.44	0.85	
8474.00	1.300	75.500	8316.60	1309.11	-1007.78	835.57	2.15	LAST BHI MWD SURVEY
8530.00	1.300	75.500	8372.58	1309.64	-1007.46	836.80	0.00	PROJECTION TO BIT

HOLE & CASING SECTIONS Ref Wellbore: KERR-MCGEE 14-3 AWP Ref Wellpath: KERR-MCGEE 14-3 AWP

String/Diameter	Start MD [ft]	End MD [ft]	Interval [ft]	Start TVD [ft]	End TVD [ft]	Start N/S [ft]	Start E/W [ft]	End N/S [ft]	End E/W [ft]
12.25in Open Hole	17.00	1008.00	991.00	17.00	1007.91	0.00	0.00	2.65	6.21
8.625in Casing Surface	17.00	1008.00	991.00	17.00	1007.91	0.00	0.00	2.65	6.21
7.875in Open Hole	1008.00	8530.00	7522.00	1007.91	8372.58	2.65	6.21	-1007.46	836.80



Actual Wellpath Report

KERR-MCGEE 14-3 AWP

Page 5 of 6



INTEQ

REFERENCE WELLPATH IDENTIFICATION

Operator	KERR MCGEE OIL & GAS ONSHORE LP	Slot	SLOT#12 KERR-MCGEE 14-3 (1666'FSL & 1149'FWL)
Area	COLORADO	Well	KERR-MCGEE 14-3
Field	WELD COUNTY (KERR MCGEE)	Wellbore	KERR-MCGEE 14-3 AWB
Facility	SEC.03-T1N-R68W		

TARGETS

Name	MD [ft]	TVD [ft]	North [ft]	East [ft]	Grid East [srv ft]	Grid North [srv ft]	Latitude	Longitude	Shape
KERR-MCGEE 14-3 GEO TARGET 50' RADIUS (660'FSL & 1980'FWL, REV-1)		6000.00	-1007.62	828.10	3142196.05	1270515.14	40°04'29.410"N	104°59'30.750"W	circle
KERR-MCGEE 14-3 LEGAL BOX (195'S,205'N,188'W,213'E OF GEO TARGET)		6000.00	-1002.62	841.10	3142209.03	1270520.21	40°04'29.459"N	104°59'30.583"W	square

WELLPATH COMPOSITION Ref Wellbore: KERR-MCGEE 14-3 AWB Ref Wellpath: KERR-MCGEE 14-3 AWP

Start MD [ft]	End MD [ft]	Positional Uncertainty Model	Log Name/Comment	Wellbore
17.00	8474.00	NaviTrak (Standard)	BHI MWD SURVEYS <152-8474>	KERR-MCGEE 14-3 AWB
8474.00	8530.00	Blind Drilling (std)	Projection to bit	KERR-MCGEE 14-3 AWB



Actual Wellpath Report

KERR-MCGEE 14-3 AWP

Page 6 of 6



INTEQ

REFERENCE WELLPATH IDENTIFICATION

Operator	KERR MCGEE OIL & GAS ONSHORE LP	Slot	SLOT#12 KERR-MCGEE 14-3 (1666'FSL & 1149'FWL)
Area	COLORADO	Well	KERR-MCGEE 14-3
Field	WELD COUNTY (KERR MCGEE)	Wellbore	KERR-MCGEE 14-3 AWB
Facility	SEC.03-T1N-R68W		

WELLPATH COMMENTS

MD [ft]	Inclination [°]	Azimuth [°]	TVD [ft]	Comment
8474.00	1.300	75.500	8316.60	LAST BHI MWD SURVEY
8530.00	1.300	75.500	8372.58	PROJECTION TO BIT