

APPROXIMATE DISTURBANCE AREA: 4.7 ACRES±
1.4% GRADE ON A WESTERLY SLOPE
UNGRADED ELEVATION: 4982.5'
FINISHED ELEVATION: 4982.0'

2.6 MILES SOUTHERLY TO DUTCH GIRL LAKE

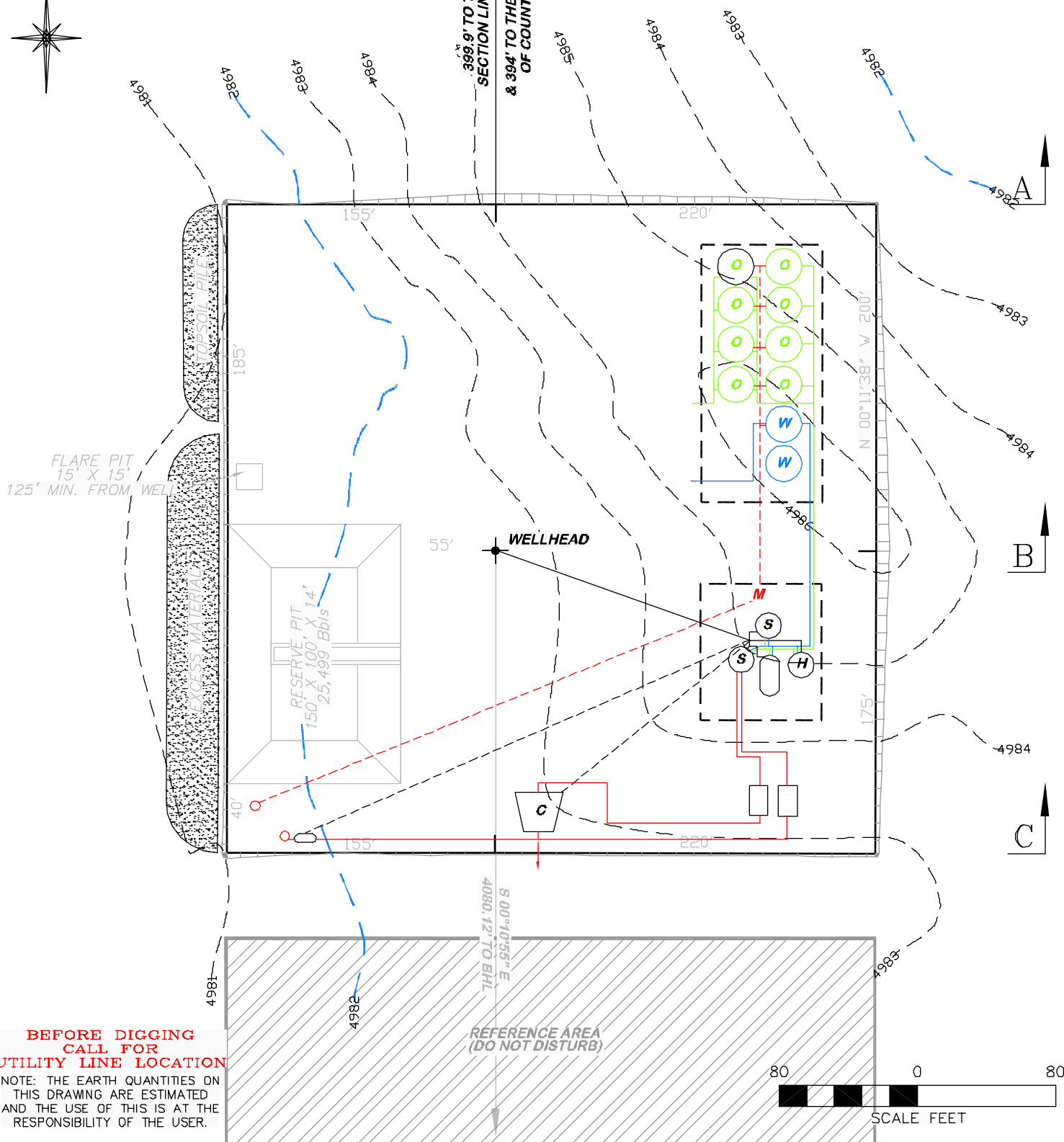

399.9' TO THE NORTH
 SECTION LINE OF SEC. 36
 & 394' TO THE CENTERLINE
 OF COUNTY ROAD 88



FLARE PIT
 15' X 15'
 125' MIN. FROM WELL

EXCESS MATERIAL

RESERVE PIT
 150' X 100' X 14'
 25,499 Bbls

WELLHEAD

REFERENCE AREA
 (DO NOT DISTURB)

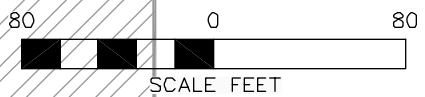

**BEFORE DIGGING
 CALL FOR
 UTILITY LINE LOCATION**
 NOTE: THE EARTH QUANTITIES ON
 THIS DRAWING ARE ESTIMATED
 AND THE USE OF THIS IS AT THE
 RESPONSIBILITY OF THE USER.

DRG RIFFIN & ASSOCIATES, INC.
 (307) 362-5028 1414 ELK ST., ROCK SPRINGS, WY 82901

PLOT PLAN
CHESAPEAKE ENERGY CORPORATION
STATE 8-61 36-1H
SECTION 36, T8N, R61W

DRAWN: 11/23/10 - KRH	SCALE: 1" = 80'
REVISED: N/A	DRG JOB No. 18168
	EXHIBIT 2E

UNGRADED ELEVATION: 4982.5'
FINISHED ELEVATION: 4982.0'

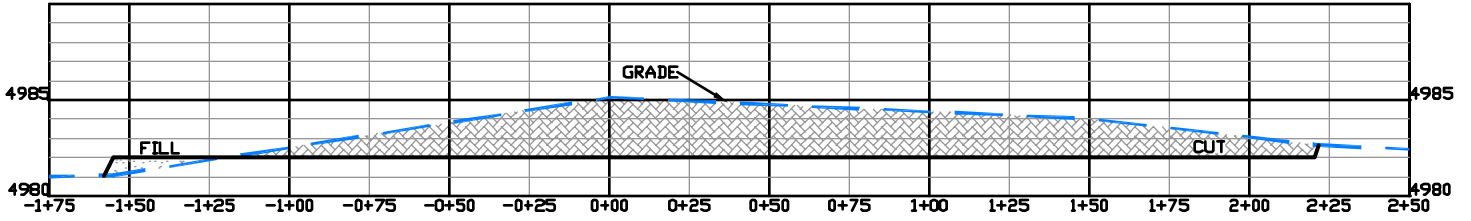

A

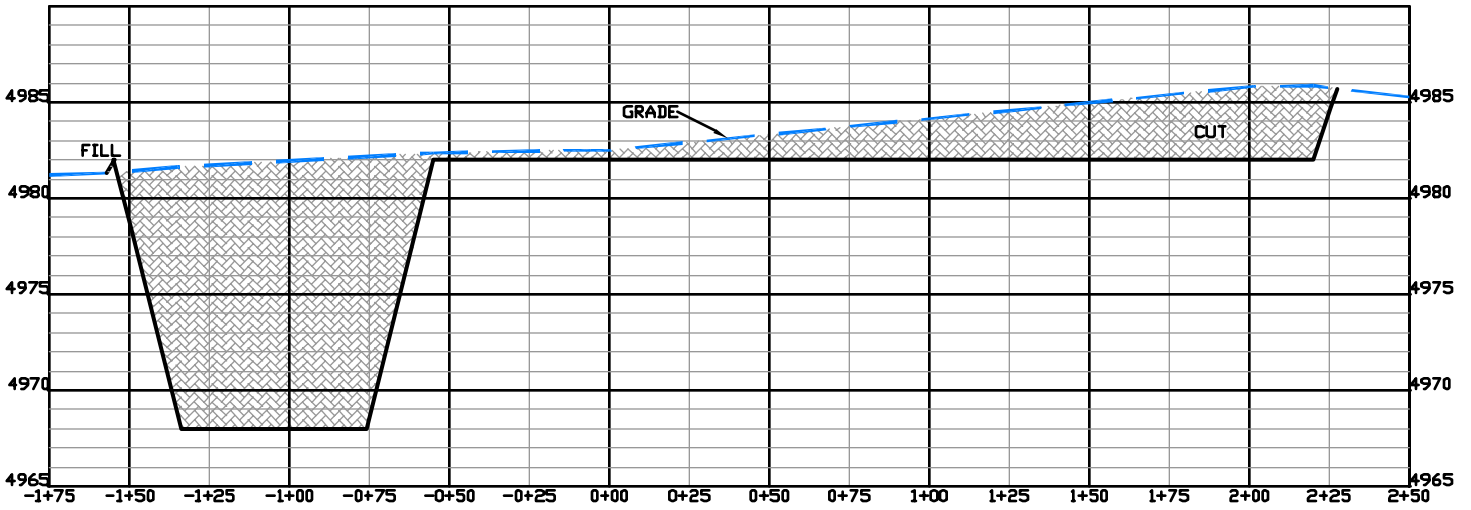

B

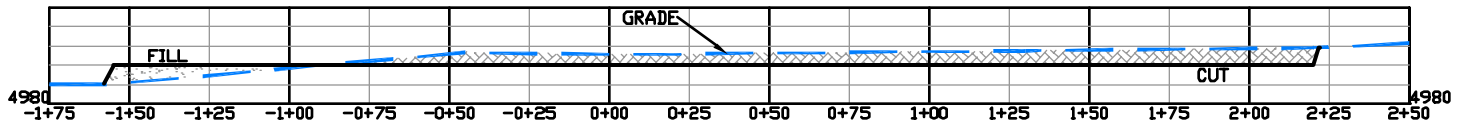

C



RIFFIN & ASSOCIATES, INC.
1414 ELK ST., ROCK SPRINGS, WY 82901

(307) 382-5028

DRAWN: 10/21/10 - MMM

HORZ. 1" = 60' VERT. 1" = 10'

REVISED: 10/22/10 - KRH

DRG JOB No. 18168

REVISED WELL NAME

EXHIBIT 3

CONSTRUCTION LAYOUT DRAWING 3 OF 3

**CHESAPEAKE ENERGY CORPORATION
STATE 8-61 36-1H
SECTION 36, T8N, R61W**

UNGRADED ELEVATION: 4982.5'
FINISHED ELEVATION: 4982.0'