

APPROXIMATE DISTURBANCE AREA: 4.7 ACRES±
1.0% GRADE ON A NORTHEASTERLY SLOPE
UNGRADED ELEVATION: 4907.4'
FINISHED ELEVATION: 4906.9'

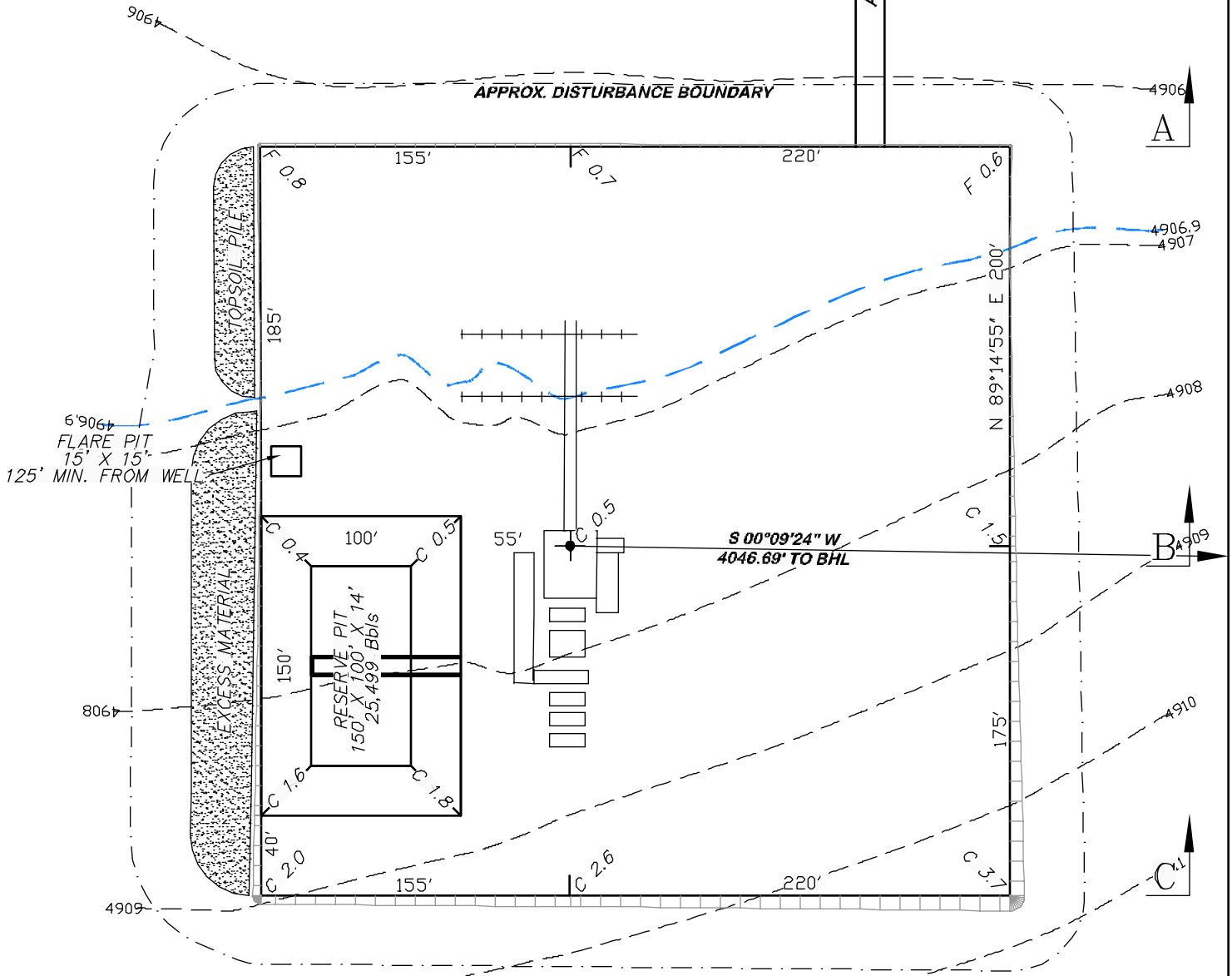

ACCESS ROAD



**BEFORE DIGGING
 CALL FOR
 UTILITY LINE LOCATION**

NOTE: THE EARTH QUANTITIES ON THIS DRAWING ARE ESTIMATED AND THE USE OF THIS IS AT THE RESPONSIBILITY OF THE USER.

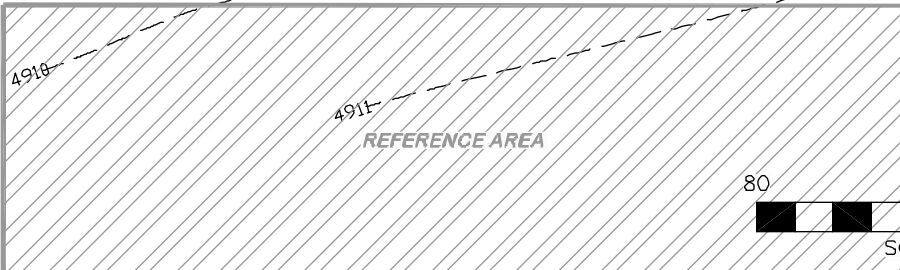

CHESAPEAKE ENERGY CORPORATION
STATE 8-60 16-1H
SECTION 16, T8N, R60W
ESTIMATED EARTHWORK

		ITEM	CUT	FILL	TOPSOIL	EXCESS
DRAWN: 10/22/10 - MMM	SCALE: 1" = 80'	PAD	4910 CY	466 CY	2605 CY	1839 CY
REVISED: NA	DRG JOB No. 18171	PIT	5635 CY			5635 CY
	EXHIBIT 2	TOTALS	10545 CY	466 CY	2605 CY	7474 CY